

serial ident.-no.

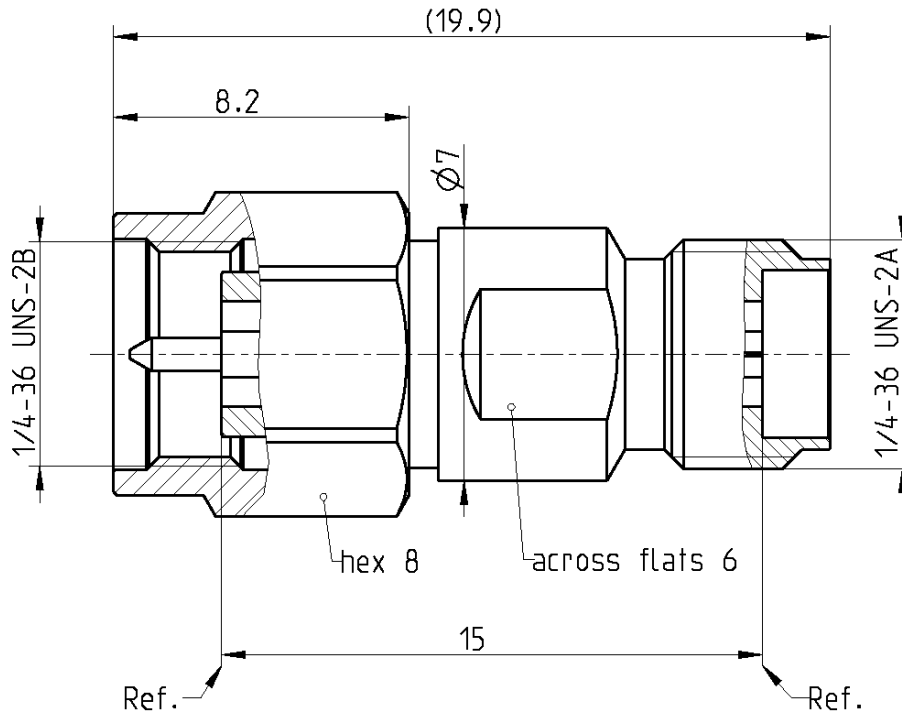
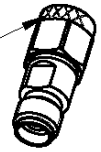

All dimensions are in mm; tolerances according to ISO 2768 m-H

Interface

Mechanically compatible with RPC-3.50 and SMA

Documents

N/A

Material and plating

Connector parts

Center contact
Outer contact
Coupling nut

Material

Beryllium copper
Brass
Stainless steel

Plating

Gold, min. 1.27 μm , over chemical nickel
Gold, min. 1.27 μm , over chemical nickel
Passivated

Electrical data

Impedance	50 Ω ± 0.40 Ω
Frequency	0.3 GHz to 40 GHz
Return loss	≥ 38 dB, 0.3 GHz to 4 GHz ≥ 30 dB, 4 GHz to 40 GHz
Insertion loss	≤ 0.075 dB at 40 GHz
Center contact resistance	≤ 3.0 mΩ
Outer contact resistance	≤ 2.0 mΩ

Mechanical data

Mating cycles	≥ 500
Coupling test torque	1.70 Nm
Recommended torque	0.80 Nm to 1.10 Nm
Airline dimensions:	
- Outer diameter	2.9235 mm ± 0.005 mm
- Inner diameter	1.2700 mm ± 0.005 mm
- Length outer contact	15.00 mm + 0.02 mm
- Length center contact	15.00 mm – 0.02 mm
- Difference (outer/center-contact)	max. 0.04 mm

Environmental data

Temperature range	-40°C to +85°C
Thermal shock	MIL-STD-202, Method 107, Condition B
Corrosion	MIL-STD-202, Method 101, Condition B
Vibration	MIL-STD-202, Method 204, Condition D
Shock	MIL-STD-202, Method 213, Condition I
Moisture resistance	MIL-STD-202, Method 106
2002/95/EC (RoHS)	compliant

Tooling

N/A

Suitable cables

N/A

Packing

Standard	1 pce in box
Weight	4.0 g/pce

While the information has been carefully compiled to the best of our knowledge, nothing is intended as representation or warranty on our part and no statement herein shall be construed as recommendation to infringe existing patents. In the effort to improve our products, we reserve the right to make changes judged to be necessary.

Draft	Date	Approved	Date	Rev.	Engineering change number	Name	Date
Herbert Babinger	06/12/04	Armin Maiwaelder	11/05/07	e00	07-0277	Manuela Fuehrich	10/05/07
Rosenberger Hochfrequenztechnik GmbH & Co. KG P.O.Box 1260 D-84526 Tittmoning Germany www.rosenberger.de					Tel.: +49 8684 18-0 Fax: +49 8684 18-499 email: info@rosenberger.de		Page 2 / 2