

REV	DESCRIPTION	BY DATE	APPD
F	ER33316	KPL 06/14/11	JSC

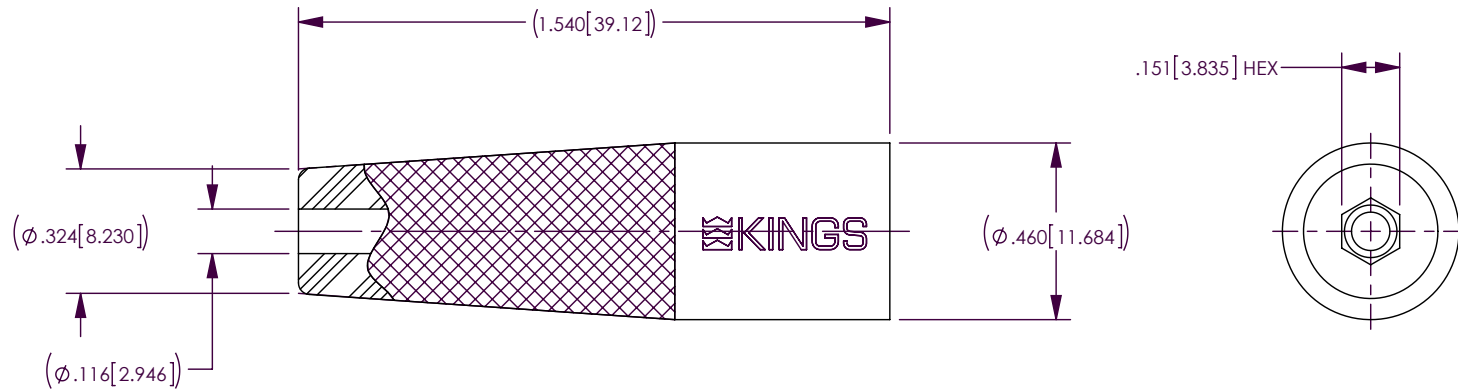

- NOTES:
1. MATERIAL: RUBBER, BUNA N.
 2. BOOT FOR RG-174 CABLE ASSY.
 3. DIMENSIONS ARE IN INCHES [MM].

-10	BLACK
-9	WHITE
-8	GREY
-7	VIOLET
-6	BLUE
-5	GREEN
-4	YELLOW
-3	ORANGE
-2	RED
-1	BROWN
DASH NO.	COLOR

PER ASME Y14.5M-1994
UNLESS OTHERWISE SPECIFIED:
DIMENSIONS ARE IN INCHES [MM]
TOLERANCES:
DECIMAL: .XX [X.X] ± .01 [0.3]
.XXX [X.XX] ± .004 [0.13]
.XXXX [X.XXX] ± .XXXX
ANGLES: ± 1° SCALE: 6:1

KINGS
by WINCHESTER Winchester Electronics Corporation
62 Barnes Industrial Road North
Wallingford, Connecticut 06492

CUSTOMER SALES DRAWING		THIRD ANGLE	
DRAWN	DATE	APPROVED	DATE
JLA	03/07/05	XXX	XX/XX/XX
APPROVED	DATE	APPROVED	DATE
JLA	03/07/05	XXX	XX/XX/XX

BOOT FOR RG174 CABLE		A	SD1-8575 QD	SHT	OF	REV
			1	1	F	