

## General Description

Delta BNC connectors are compact, economical, 50Ω impedance connectors with two-stud bayonet coupling. They are best suited for use with cables in the range of .150" to .250" diameter, but are available for other cables from .090" to over .75" diameter. M39012 QPL BNC connectors and M55339 QPL BNC adapters are also included in this section. Our extensive line of BNC receptacles includes configurations for virtually any packaging requirement, and we can supply any adapter or accessory you may need to complete your system design. Adapters between BNC and other series are shown starting page 176.

As with our other connector series, Delta's customer-driven design results in BNC series connectors with practical and unique features that make your design and assembly process easier. Some of these include:

- Heli-Grip cable connectors for fast, reliable assembly to flexible cable without special tooling.
- PressMount receptacles (page 27) mount securely in a single round hole, saving space on your components and reducing your housing fabrication costs.
- Panel receptacles with flange sizes to match the same hole pattern as standard SMA or type N connectors, letting you drill one hole pattern and mount BNC, N, SMA, TNC, or 7/16 series connectors as needed.
- Isolated ground receptacles (see page 25).
- 75Ω impedance BNC connectors (see page 31) for matched-impedance applications.

Our BNC series product line is still growing, so please call if you don't see what you need.

## BNC Configurations

|  |    |   |    |
|--|----|---|----|
| Straight Cable Plugs .....                   | 2  | Bulkhead Jack Receptacles .....         | 13 |
| Right Angle Cable Plugs .....                | 4  | Bulkhead Plug Receptacles .....         | 14 |
| Straight Cable Jacks .....                   | 6  | Printed-Circuit Board Receptacles ..... | 15 |
| Bulkhead Cable Jacks .....                   | 7  | Stripline Receptacles .....             | 15 |
| Panel Cable Jacks .....                      | 9  | PressMount Receptacles .....            | 16 |
| Panel Jack Receptacles (square flange) ..... | 11 | Resistive Terminations .....            | 17 |
| Right Angle Panel Jack Receptacles .....     | 12 | Dust Caps .....                         | 17 |
| Panel Plug Receptacles .....                 | 12 | In-Series Adapters .....                | 18 |

## BNC Specifications\*

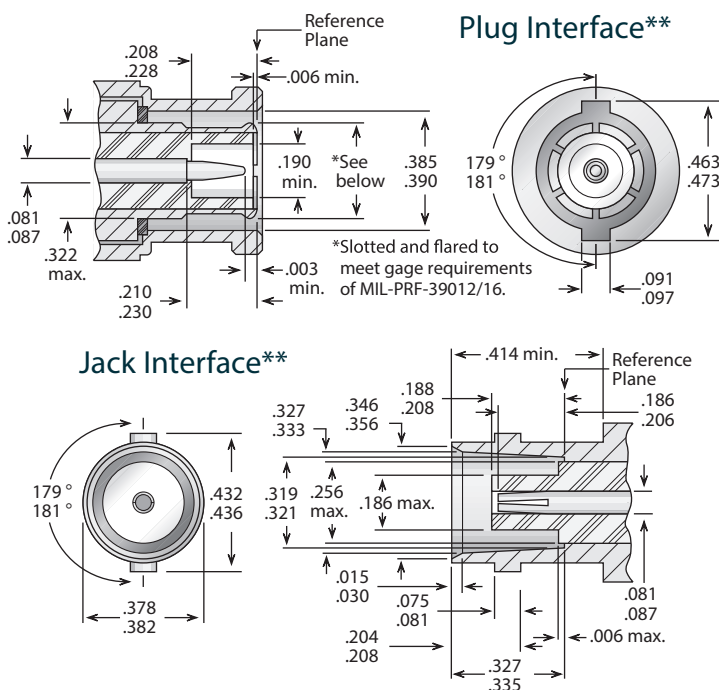

\*\*Some proportions altered to illustrate detail.

### Electrical:

Nominal Impedance: 50 ohms.  
 Frequency Range: DC-4 GHz.  
 Voltage Rating: 500 volts RMS.  
 Dielectric Withstanding Voltage: 1,500 VRMS.  
 Insulation Resistance: 5,000 megohms.

### Materials/Finishes:

Insulators: Teflon per ASTM D1710.  
 Male Contacts: Brass per ASTM B16.  
 Female Contacts: Beryllium Copper per ASTM B196.  
 Contact Plating: Silver - ASTM-B700  
 Gold - MIL-DTL-45204.

Gaskets: Silicone rubber per ZZ-R-765, Class II, Grade 50.

Other Metal Parts: Brass per ASTM B16

Plated: Silver - ASTM B700

Nickel - AMS-QQ-N-290.

All other specifications are in accordance with the latest issues of MIL-PRF-39012, or MIL-A-55339, or other applicable MIL specifications, and interfaces are in accordance with MIL-STD-348.

\*These specifications are typical and may not apply to all connectors. Detailed specifications for individual connectors are available on request.

## Straight Plug - Military Clamp For Flexible Cable

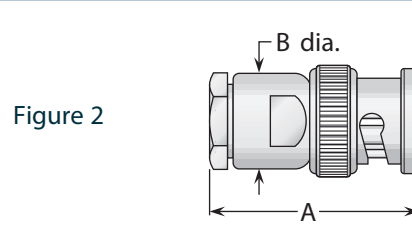
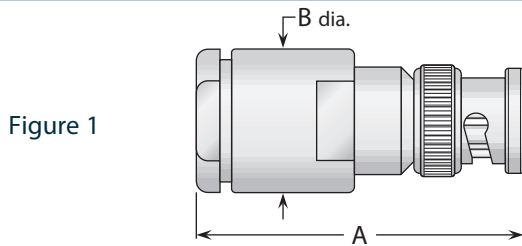

| Cable Group | Figure | Dimensions |      | Plating |            | Delta P/N       | Assembly Procedure/<br>Trim Code |
|-------------|--------|------------|------|---------|------------|-----------------|----------------------------------|
|             |        | A          | B    | Body    | Contact    |                 |                                  |
| 1           | 1      | 1.16       | .560 | Nickel  | Silver     | 1001001N000-001 | C/06                             |
| 2, 3        | 1      | 1.66       | .750 | Nickel  | Silver     | UG-959A/U       | A/01                             |
| 2, 3        | 1      | 1.66       | .750 | Silver  | Gold (C)   | M39012/16-0225  | A/01                             |
| 5, 6        | 2      | 1.03       | .440 | Nickel  | Silver     | UG-88/U         | C/04                             |
| 5, 6        | 2      | 1.06       | .500 | Nickel  | Silver     | UG-88C/U        | A/17                             |
| 5, 6        | 2      | 1.06       | .500 | Nickel  | Silver     | UG-88E/U        | A/17                             |
| 5, 6        | 2      | 1.06       | .500 | Nickel  | Gold (C)   | 1001015N001-000 | A/17                             |
| 5, 6        | 2      | 1.06       | .500 | Silver  | Gold (C)   | M39012/16-0101  | A/17                             |
| 7           | 2      | 1.03       | .440 | Nickel  | Silver     | UG-260/U        | C/04                             |
| 7           | 2      | 1.06       | .500 | Nickel  | Silver     | UG-260B/U       | A/17                             |
| 7           | 2      | 1.06       | .500 | Nickel  | Silver     | UG-260D/U       | A/17                             |
| 7           | 2      | 1.06       | .500 | Nickel  | Silver (C) | 1001021N001-000 | A/17                             |
| 7           | 2      | 1.06       | .500 | Silver  | Gold (C)   | M39012/16-0102  | A/17                             |
| 8A          | 2      | 1.06       | .500 | Nickel  | Silver     | UG-1033C/U      | A/17                             |
| 8A          | 2      | 1.06       | .500 | Nickel  | Silver (C) | 1001029N001-000 | A/17                             |
| 8A          | 2      | 1.06       | .500 | Silver  | Gold (C)   | M39012/16-0103  | A/17                             |
| 8B          | 2      | 1.06       | .500 | Nickel  | Silver     | 1001043N000-000 | A/17                             |
| 8B          | 2      | 1.06       | .500 | Nickel  | Silver (C) | 1001043N001-000 | A/17                             |
| 9           | 2      | 1.06       | .500 | Nickel  | Silver     | 1001036N000-000 | A/18                             |
| 9           | 2      | 1.06       | .500 | Nickel  | Silver (C) | 1001036N001-000 | A/18                             |
| 9           | 2      | 1.06       | .500 | Silver  | Gold (C)   | M39012/16-0220  | A/37                             |
| 11          | 2      | 1.06       | .500 | Nickel  | Silver     | 1001038N000-000 | A/18                             |
| 22          | 2      | 1.06       | .500 | Silver  | Gold (C)   | M39012/16-0118  | A/17                             |
| 23          | 2      | 1.06       | .500 | Silver  | Gold (C)   | M39012/16-0111  | A/17                             |
| 25          | 2      | 1.06       | .500 | Nickel  | Silver     | 1001132N000-000 | A/17                             |

## Straight Plug - Solder Clamp For Semi-Rigid Cable

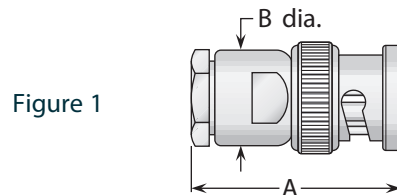

| Cable Group | Figure | Dimensions |      | Plating |         | Delta P/N       | Assembly Procedure/<br>Trim Code |
|-------------|--------|------------|------|---------|---------|-----------------|----------------------------------|
|             |        | A          | B    | Body    | Contact |                 |                                  |
| 13          | 1      | 1.06       | .500 | Nickel* | Silver  | 1001031N003-000 | F/08                             |
| 14          | 1      | 1.06       | .500 | Nickel* | Silver  | 1001025N003-000 | F/07                             |

\* Solder ferrule is gold plated.

- See page 209 for cable groups.
- Assembly procedures start on page 210.
- (C) in contact plating column indicates captive contact.
- See page 6 for alternate body plating information.

## Straight Plug - Heli-Grip® For Flexible Cable

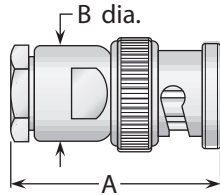
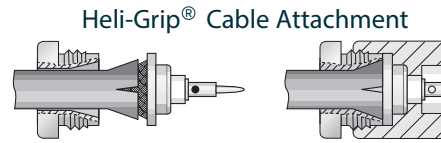

Figure 1



These connectors have captivated contacts and allow rapid, easy assembly—simply trim the cable, slide into the cone/insulator/contact assembly (left), solder the center conductor to the contact, and screw body assembly (right) onto cable assembly.

| Cable Group       | Figure | Dimensions |      | Plating |            | Delta P/N       | Assembly Procedure/<br>Trim Code |
|-------------------|--------|------------|------|---------|------------|-----------------|----------------------------------|
|                   |        | A          | B    | Body    | Contact    |                 |                                  |
| 5, 6 <sup>§</sup> | 1      | 1.06       | .500 | Nickel  | Silver (C) | 1001018N005-000 | E/03                             |
| RG-223            | 1      | 1.06       | .500 | Nickel  | Silver (C) | 1001015N005-003 | E/03                             |
| 7                 | 1      | 1.06       | .500 | Nickel  | Silver (C) | 1001019N005-000 | E/03                             |
| 8A                | 1      | 1.06       | .500 | Nickel  | Silver (C) | 1001029N005-001 | E/03                             |
| 8B                | 1      | 1.06       | .500 | Nickel  | Silver (C) | 1001043N005-000 | E/03                             |
| 9                 | 1      | 1.06       | .500 | Nickel  | Silver (C) | 1001037N005-000 | E/03                             |
| 10                | 1      | 1.06       | .500 | Nickel  | Silver (C) | 1001100N005-000 | E/03                             |
| 11                | 1      | 1.06       | .500 | Nickel  | Silver (C) | 1001038N005-000 | E/03                             |

<sup>§</sup>Except RG-223/U.

## Straight Plug - Crimp Type For Flexible Cable

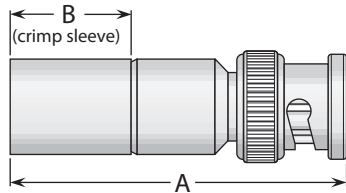

Figure 1

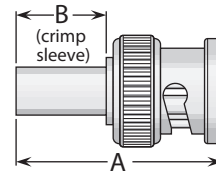

Figure 2

| Cable Group | Figure | Dimensions |      | Plating |            | Delta P/N         | Assembly Procedure/<br>Trim Code |
|-------------|--------|------------|------|---------|------------|-------------------|----------------------------------|
|             |        | A          | B    | Body    | Contact    |                   |                                  |
| 3A, 4       | 1      | 1.72       | .630 | Nickel  | Gold (C)   | 1003005N000-000   | B/11                             |
| 5           | 2      | 1.09       | .500 | Nickel  | Gold       | 1003017N000-000   | B/18                             |
| 5           | 2      | 1.10       | .500 | Nickel  | Gold (C)   | 1003017N00E-002   | B/19                             |
| 6           | 2      | 1.09       | .500 | Nickel  | Gold       | 1003013N000-000   | B/18                             |
| 6           | 2      | 1.10       | .500 | Nickel  | Gold (C)   | 1003013N00E-000   | B/19                             |
| 7           | 2      | 1.09       | .500 | Nickel  | Gold       | 1003020N000-002   | B/18                             |
| 7           | 2      | 1.10       | .500 | Nickel  | Gold (C)   | 1003019N00E-002   | B/19                             |
| 7           | 2      | 1.05       | .410 | Nickel  | Silver     | 1003020N000-005 * | ***                              |
| 7           | 2      | 1.05       | .410 | Nickel  | Gold       | 1003020N000-006 * | ***                              |
| 7           | 2      | 1.05       | .500 | Nickel  | Silver (C) | 1003020N001-005 * | ***                              |
| 7           | 2      | 1.05       | .500 | Nickel  | Gold (C)   | 1003020N001-009 * | ***                              |
| 9           | 2      | .940       | .310 | Nickel  | Silver (C) | 1003037N000-000   | B/20                             |

\* Crimp center contact.

- See page 209 for cable groups.
- Assembly procedures start on page 210.
- (C) in contact plating column indicates captive contact.
- See page 6 for alternate body plating information.
- \*\*\*Contact factory for cable assembly instructions.

## Right Angle Plug - Military Clamp For Flexible Cable

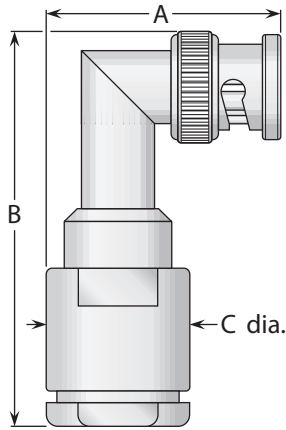

Figure 1

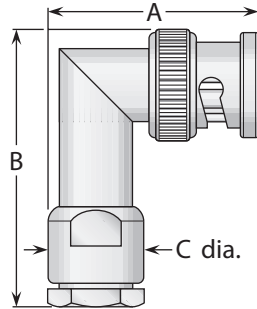

Figure 2

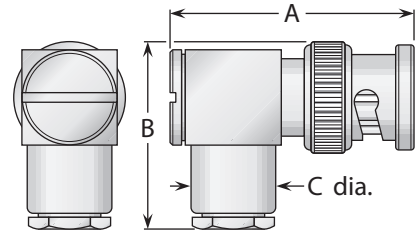

Figure 3

| Cable Group | Figure | Dimensions |      |      | Plating |            | Delta P/N       | Assembly Procedure/<br>Trim Code |
|-------------|--------|------------|------|------|---------|------------|-----------------|----------------------------------|
|             |        | A          | B    | C    | Body    | Contact    |                 |                                  |
| 1           | 1      | 1.23       | 1.92 | .750 | Nickel  | Gold       | 1004001N000-000 | A/07                             |
| 2,3         | 1      | 1.23       | 1.92 | .750 | Nickel  | Silver     | 1004004N000-000 | A/07                             |
| 5,6         | 2      | 1.09       | 1.61 | .500 | Nickel  | Silver     | UG-913/U        | A/17                             |
| 5,6         | 2      | 1.09       | 1.61 | .500 | Nickel  | Silver     | UG-913A/U       | A/17                             |
| 5,6         | 2      | 1.09       | 1.61 | .500 | Nickel  | Silver (C) | 1004015N001-000 | A/17                             |
| 5,6         | 2      | 1.09       | 1.61 | .500 | Silver  | Gold (C)   | M39012/20-0101  | A/17                             |
| 5,6         | 3      | 1.25       | 1.06 | .440 | Nickel  | Silver (C) | 1005014N000-000 | C/05                             |
| 7           | 2      | 1.09       | 1.61 | .500 | Nickel  | Silver     | 1004021N000-000 | A/17                             |
| 7           | 2      | 1.09       | 1.61 | .500 | Nickel  | Silver (C) | 1004021N001-000 | A/17                             |
| 7           | 2      | 1.09       | 1.61 | .500 | Silver  | Gold (C)   | M39012/20-0102  | A/17                             |
| 7           | 3      | 1.25       | 1.06 | .440 | Nickel  | Silver (C) | 1005021N000-001 | C/05                             |
| 8A          | 3      | 1.25       | 1.06 | .440 | Nickel  | Silver (C) | 1005029N000-000 | C/05                             |
| 8B          | 2      | 1.09       | 1.61 | .500 | Nickel  | Silver     | 1004043N000-000 | A/17                             |
| 9           | 2      | 1.09       | 1.61 | .500 | Nickel  | Silver     | 1004036N000-000 | A/18                             |
| 9           | 3      | 1.25       | 1.06 | .440 | Nickel  | Silver (C) | 1005036N000-000 | C/05                             |
| 22          | 2      | 1.09       | 1.61 | .500 | Silver  | Gold (C)   | M39012/20-0108  | A/17                             |

## Right Angle Plug - Solder Clamp For Semi-Rigid Cable

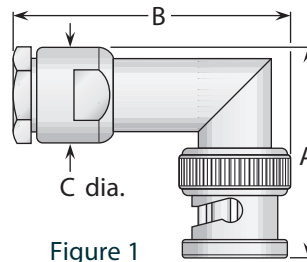

Figure 1

| Cable Group | Figure | Dimensions |      |      | Plating |         | Delta P/N       | Assembly Procedure/<br>Trim Code |
|-------------|--------|------------|------|------|---------|---------|-----------------|----------------------------------|
|             |        | A          | B    | C    | Body    | Contact |                 |                                  |
| 13          | 1      | 1.09       | 1.61 | .500 | Nickel* | Silver  | 1004031N003-000 | F/08                             |
| 14          | 1      | 1.09       | 1.61 | .500 | Nickel* | Silver  | 1004025N003-000 | F/07                             |

\* Solder ferrule is gold plated.

- See page 209 for cable groups.
- Assembly procedures start on page 210.
- (C) in contact plating column indicates captive contact.
- See page 6 for alternate body plating information.

## Right Angle Plug - Heli-Grip® For Flexible Cable

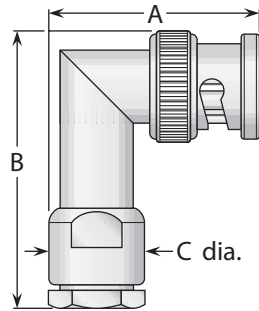
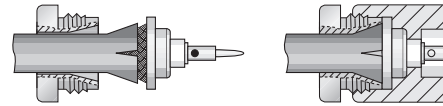

Figure 1

### Heli-Grip® Cable Attachment



These connectors have captivated contacts and allow rapid, easy assembly—simply trim the cable, slide into the cone/insulator/contact assembly (left), solder the center conductor to the contact, and screw body assembly (right) onto cable assembly.

| Cable Group       | Figure | Dimensions |      |      | Plating |            | Delta P/N       | Assembly Procedure/<br>Trim Code |
|-------------------|--------|------------|------|------|---------|------------|-----------------|----------------------------------|
|                   |        | A          | B    | C    | Body    | Contact    |                 |                                  |
| 5, 6 <sup>§</sup> | 1      | 1.09       | 1.61 | .500 | Nickel  | Silver (C) | 1004018N005-000 | E/03                             |
| RG-223            | 1      | 1.09       | 1.61 | .500 | Nickel  | Silver (C) | 1004015N005-000 | E/03                             |
| 7                 | 1      | 1.09       | 1.61 | .500 | Nickel  | Silver (C) | 1004019N005-000 | E/03                             |
| 8A                | 1      | 1.09       | 1.61 | .500 | Nickel  | Silver (C) | 1004029N005-000 | E/03                             |
| 8B                | 1      | 1.09       | 1.61 | .500 | Nickel  | Silver (C) | 1004043N005-000 | E/03                             |
| 9                 | 1      | 1.09       | 1.61 | .500 | Nickel  | Silver (C) | 1004037N005-000 | E/03                             |
| 10                | 1      | 1.09       | 1.61 | .500 | Nickel  | Silver (C) | 1004100N005-000 | E/03                             |
| 11                | 1      | 1.09       | 1.61 | .500 | Nickel  | Silver (C) | 1004038N005-000 | E/03                             |

<sup>§</sup>Except RG-223/U.

## Right Angle Plug - Crimp Type For Flexible Cable

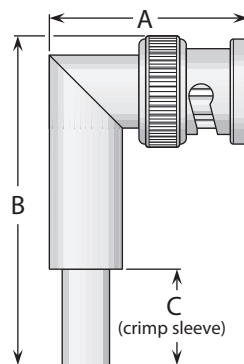

Figure 1

| Cable Group | Figure | Dimensions |      |      | Plating |          | Delta P/N       | Assembly Procedure/<br>Trim Code |
|-------------|--------|------------|------|------|---------|----------|-----------------|----------------------------------|
|             |        | A          | B    | C    | Body    | Contact  |                 |                                  |
| 5           | 1      | 1.03       | 1.71 | .500 | Nickel  | Gold (C) | 1007017N000-003 | B/02                             |
| 6           | 1      | 1.03       | 1.71 | .500 | Nickel  | Silver   | 1007015N000-000 | B/02                             |
| 7           | 1      | 1.03       | 1.71 | .500 | Nickel  | Gold     | 1007019N000-001 | B/02                             |

- See page 209 for cable groups.
- Assembly procedures start on page 210.
- (C) in contact plating column indicates captive contact.
- See page 6 for alternate body plating information.

## Straight Jacks - For Flexible & Semi-Rigid Cable

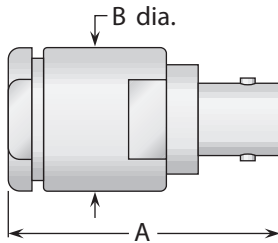

Figure 1

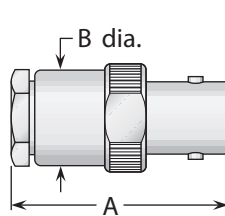

Figure 2

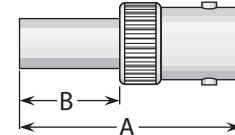
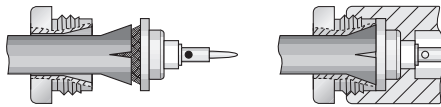

Figure 3

### Heli-Grip® Cable Attachment



These connectors have captivated contacts and allow rapid, easy assembly—simply trim the cable, slide into the cone/insulator/contact assembly (left), solder the center conductor to the contact, and screw body assembly (right) onto cable assembly.

### Military Clamp For Flexible Cable

| Cable Group | Figure | Dimensions |      | Plating |            | Delta P/N       | Assembly Procedure/<br>Trim Code |
|-------------|--------|------------|------|---------|------------|-----------------|----------------------------------|
|             |        | A          | B    | Body    | Contact    |                 |                                  |
| 2, 3        | 1      | 1.75       | .750 | Nickel  | Silver     | 1008004N000-000 | A/20                             |
| 5, 6        | 2      | 1.16       | .500 | Nickel  | Silver     | UG-89C/U        | A/17                             |
| 5, 6        | 2      | 1.16       | .500 | Nickel  | Gold (C)   | 1008015N001-000 | A/17                             |
| 5, 6        | 2      | 1.16       | .500 | Silver  | Gold (C)   | M39012/17-0101  | A/17                             |
| 7           | 2      | 1.16       | .500 | Nickel  | Silver     | UG-261C/U       | A/17                             |
| 7           | 2      | 1.16       | .500 | Nickel  | Silver (C) | 1008021N001-000 | A/17                             |
| 7           | 2      | 1.16       | .500 | Silver  | Gold (C)   | M39012/17-0102  | A/17                             |
| 8A          | 2      | 1.16       | .500 | Silver  | Gold (C)   | M39012/17-0103  | A/17                             |
| 9           | 2      | 1.16       | .500 | Nickel  | Silver     | 1008036N000-000 | A/18                             |
| 9           | 2      | 1.16       | .500 | Nickel  | Silver (C) | 1008036N001-000 | A/18                             |
| 11          | 2      | 1.16       | .500 | Nickel  | Silver     | 1008038N000-000 | A/18                             |
| 22          | 2      | 1.16       | .500 | Silver  | Gold (C)   | M39012/17-0118  | A/17                             |
| 23          | 2      | 1.16       | .500 | Silver  | Gold (C)   | M39012/17-0111  | A/17                             |

### Heli-Grip For Flexible Cable

|                   |   |      |      |        |            |                 |      |
|-------------------|---|------|------|--------|------------|-----------------|------|
| 5, 6 <sup>§</sup> | 2 | 1.16 | .500 | Nickel | Silver (C) | 1008018N005-001 | E/03 |
| RG-223            | 2 | 1.16 | .500 | Nickel | Silver (C) | 1008015N005-000 | E/03 |
| 7                 | 2 | 1.16 | .500 | Nickel | Silver (C) | 1008019N005-000 | E/03 |
| 8A                | 2 | 1.16 | .500 | Nickel | Silver (C) | 1008029N005-000 | E/03 |
| 8B                | 2 | 1.16 | .500 | Nickel | Silver (C) | 1008043N005-000 | E/03 |
| 9                 | 2 | 1.16 | .500 | Nickel | Silver (C) | 1008037N005-000 | E/03 |
| 10                | 2 | 1.16 | .500 | Nickel | Silver (C) | 1008100N005-000 | E/03 |
| 11                | 2 | 1.16 | .500 | Nickel | Silver (C) | 1008038N005-002 | E/03 |

### Crimp Type For Flexible Cable

|   |   |      |      |        |        |                    |      |
|---|---|------|------|--------|--------|--------------------|------|
| 5 | 3 | 1.16 | .500 | Nickel | Gold   | 1010017N000-001    | B/05 |
| 6 | 3 | 1.16 | .500 | Nickel | Gold   | 1010013N000-000    | B/05 |
| 7 | 3 | 1.16 | .500 | Nickel | Gold   | 1010020N000-000    | B/05 |
| 7 | 3 | 1.06 | .410 | Nickel | Silver | 1010020N001-001 ** | ***  |

### Solder-Clamp For Semi-Rigid Cable

|    |   |      |      |         |        |                 |      |
|----|---|------|------|---------|--------|-----------------|------|
| 13 | 2 | 1.16 | .500 | Nickel* | Silver | 1008031N003-000 | F/08 |
| 14 | 2 | 1.16 | .500 | Nickel* | Silver | 1008025N003-000 | F/07 |

<sup>§</sup>Except RG-223/U.

\*Solder ferrule is gold plated.

- See page 209 for cable groups.
- Assembly procedures start on page 210.
- (C) in contact plating column indicates captive contact.
- See page 6 for alternate body plating information.
- \*\*Indicates crimp center contact.
- \*\*\*Contact factory for cable assembly instructions.

## Bulkhead Jacks - Military Clamp For Flexible Cable

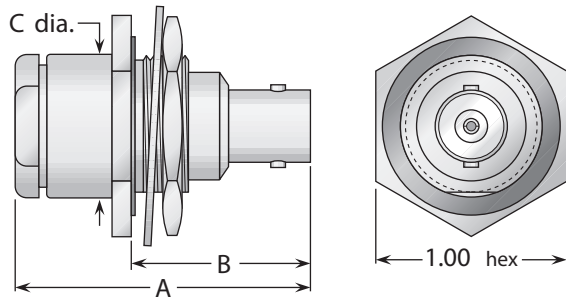

Figure 1  
(Rear mount)

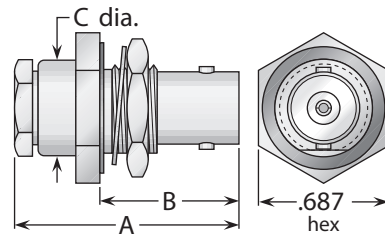

Figure 2  
(Rear mount)

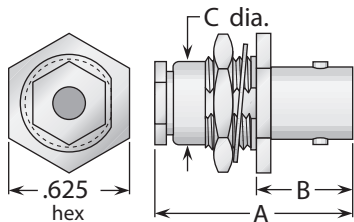

Figure 3  
(Front mount)

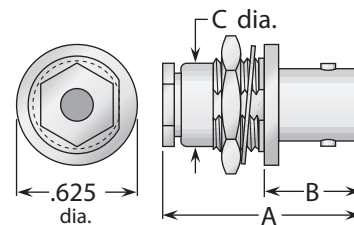

Figure 4  
(Front mount)

| Cable Group | Fig. | Dimensions |      |      | Mounting Figure | Max. Panel | Plating |            | Delta P/N       | Assembly Procedure/Trim Code |
|-------------|------|------------|------|------|-----------------|------------|---------|------------|-----------------|------------------------------|
|             |      | A          | B    | C    |                 |            | Body    | Contact    |                 |                              |
| 2, 3        | 1    | 1.55       | .920 | .750 | 51              | .110       | Nickel  | Gold (C)   | 1016004N511-000 | A/20                         |
| 5, 6        | 2    | 1.16       | .680 | .500 | 59              | .110       | Nickel  | Silver     | UG-909/U        | A/17                         |
| 5, 6        | 2    | 1.16       | .680 | .500 | 59              | .110       | Nickel  | Silver     | UG-909A/U       | A/17                         |
| 5, 6        | 2    | 1.16       | .810 | .500 | 59              | .240       | Nickel  | Silver     | UG-909B/U       | A/17                         |
| 5, 6        | 2    | 1.16       | .810 | .500 | 59              | .240       | Silver  | Gold (C)   | M39012/19-0101  | A/17                         |
| 5, 6        | 2    | 1.16       | .680 | .500 | 59              | .110       | Nickel  | Gold (C)   | 1016015N591-000 | A/17                         |
| 5, 6        | 3    | 1.14       | .550 | .440 | 57              | .090       | Nickel  | Silver     | 1017014N570-000 | C/04                         |
| 7           | 2    | 1.16       | .680 | .500 | 59              | .110       | Nickel  | Silver     | UG-910/U        | A/17                         |
| 7           | 2    | 1.16       | .680 | .500 | 59              | .110       | Nickel  | Silver     | UG-910A/U       | A/17                         |
| 7           | 2    | 1.16       | .810 | .500 | 59              | .240       | Nickel  | Silver     | UG-910B/U       | A/17                         |
| 7           | 2    | 1.16       | .810 | .500 | 59              | .240       | Silver  | Gold (C)   | M39012/19-0102  | A/17                         |
| 7           | 2    | 1.16       | .680 | .500 | 59              | .110       | Nickel  | Silver (C) | 1016021N591-000 | A/17                         |
| 7           | 4    | 1.14       | .550 | .440 | 57              | .090       | Nickel  | Silver     | UG-624/U        | C/04                         |
| 8A          | 2    | 1.16       | .810 | .500 | 59              | .240       | Silver  | Gold (C)   | M39012/19-0110  | A/17                         |
| 9           | 2    | 1.16       | .680 | .500 | 59              | .110       | Nickel  | Silver     | 1016036N590-000 | A/18                         |
| 9           | 2    | 1.16       | .680 | .500 | 59              | .110       | Nickel  | Silver (C) | 1016036N591-000 | A/17                         |
| 9           | 2    | 1.16       | .810 | .500 | 59              | .240       | Silver  | Gold (C)   | M39012/19-0220  | A/17                         |
| 11          | 2    | 1.16       | .680 | .500 | 59              | .110       | Nickel  | Silver     | 1016038N590-000 | A/18                         |
| 11          | 2    | 1.16       | .680 | .500 | 59              | .110       | Nickel  | Silver (C) | 1016038N591-000 | A/18                         |
| 22          | 2    | 1.16       | .810 | .500 | 59              | .240       | Silver  | Gold (C)   | M39012/19-0118  | A/17                         |
| 23          | 2    | 1.16       | .810 | .500 | 59              | .240       | Silver  | Gold (C)   | M39012/19-0111  | A/17                         |

- See page 209 for cable groups.
- Assembly procedures start on page 210.
- See page 208 for mounting dimensions.
- (C) in contact plating column indicates captive contact.
- See page 6 for alternate body plating information.



## Bulkhead Jack - Heli-Grip® For Flexible Cable

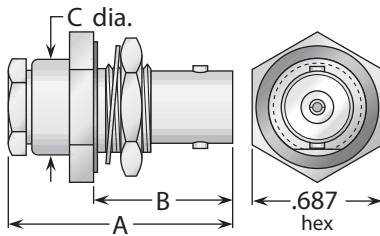
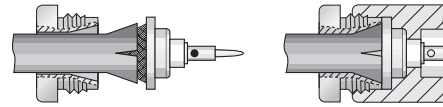

Figure 1 (Rear mount)

### Heli-Grip® Cable Attachment



These connectors have captivated contacts and allow rapid, easy assembly—simply trim the cable, slide into the cone/insulator/contact assembly (left), solder the center conductor to the contact, and screw body assembly (right) onto cable assembly.

| Cable Group       | Fig. | Dimensions |      |      | Mounting Figure | Max. Panel | Plating |            | Delta P/N       | Assembly Procedure/Trim Code |
|-------------------|------|------------|------|------|-----------------|------------|---------|------------|-----------------|------------------------------|
|                   |      | A          | B    | C    |                 |            | Body    | Contact    |                 |                              |
| 5, 6 <sup>§</sup> | 1    | 1.16       | .810 | .500 | 59              | .240       | Nickel  | Silver (C) | 1016018N595-000 | E/03                         |
| RG-223            | 1    | 1.16       | .810 | .500 | 59              | .240       | Nickel  | Silver (C) | 1016015N595-000 | E/03                         |
| 7                 | 1    | 1.16       | .810 | .500 | 59              | .240       | Nickel  | Silver (C) | 1016019N595-000 | E/03                         |
| 8A                | 1    | 1.16       | .810 | .500 | 59              | .240       | Nickel  | Silver (C) | 1016029N595-000 | E/03                         |
| 8B                | 1    | 1.16       | .810 | .500 | 59              | .240       | Nickel  | Silver (C) | 1016043N595-000 | E/03                         |
| 9                 | 1    | 1.16       | .810 | .500 | 59              | .240       | Nickel  | Silver (C) | 1016037N595-000 | E/03                         |
| 10                | 1    | 1.16       | .810 | .500 | 59              | .240       | Nickel  | Silver (C) | 1016100N595-002 | E/03                         |
| 11                | 1    | 1.16       | .810 | .500 | 59              | .240       | Nickel  | Silver (C) | 1016038N595-002 | E/03                         |

<sup>§</sup>Except RG-223/U.

## Bulkhead Jack - Crimp Type For Flexible Cable

Figure 1 (Rear mount)

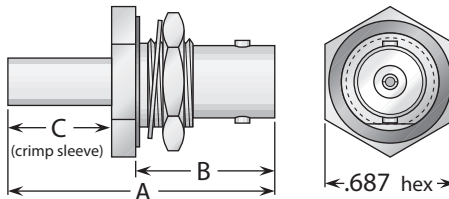

| Cable Group | Fig. | Dimensions |      |      | Mounting Figure | Max. Panel | Plating |         | Delta P/N       | Assembly Procedure/Trim Code |
|-------------|------|------------|------|------|-----------------|------------|---------|---------|-----------------|------------------------------|
|             |      | A          | B    | C    |                 |            | Body    | Contact |                 |                              |
| 5           | 1    | 1.31       | .680 | .500 | 59              | .110       | Nickel  | Silver  | 1019016N590-000 | B/21                         |
| 6           | 1    | 1.31       | .680 | .500 | 59              | .110       | Nickel  | Silver  | 1019013N590-000 | B/21                         |
| 7           | 1    | 1.31       | .680 | .500 | 59              | .110       | Nickel  | Silver  | 1019020N590-000 | B/22                         |

## Bulkhead Jack - Solder Clamp For Semi-Rigid Cable

Figure 1 (Rear mount)

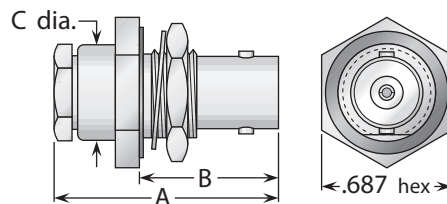

| Cable Group | Fig. | Dimensions |      |      | Mounting Figure | Max. Panel | Plating |         | Delta P/N       | Assembly Procedure/Trim Code |
|-------------|------|------------|------|------|-----------------|------------|---------|---------|-----------------|------------------------------|
|             |      | A          | B    | C    |                 |            | Body    | Contact |                 |                              |
| 13          | 1    | 1.16       | .810 | .500 | 59              | .240       | Nickel* | Silver  | 1016031N593-000 | F/08                         |
| 14          | 1    | 1.16       | .810 | .500 | 59              | .240       | Nickel* | Silver  | 1016025N593-000 | F/07                         |

\* Solder ferrule is gold plated.

- See page 209 for cable groups.
- Assembly procedures start on page 210.
- See page 208 for mounting dimensions.
- (C) in contact plating column indicates captive contact.
- See page 6 for alternate body plating information.



## Panel Jack- Military Clamp For Flexible Cable

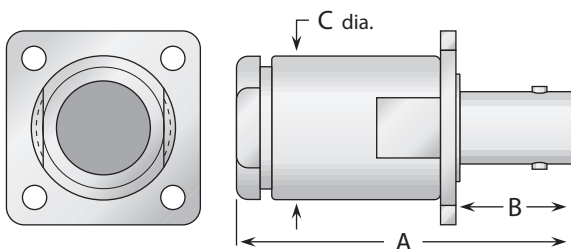

Figure 1

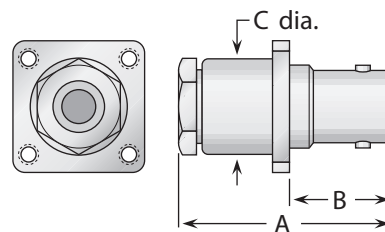

Figure 2

| Cable Group | Fig. | Dimensions |      |      | Mounting Figure | Plating |            | Delta P/N       | Assembly Procedure/Trim Code |
|-------------|------|------------|------|------|-----------------|---------|------------|-----------------|------------------------------|
|             |      | A          | B    | C    |                 | Body    | Contact    |                 |                              |
| 1           | 1    | 1.75       | .630 | .750 | 33              | Nickel  | Silver     | 1011001N330-000 | A/20                         |
| 2, 3        | 1    | 1.75       | .630 | .750 | 33              | Nickel  | Silver     | 1011004N330-000 | A/20                         |
| 5, 6        | 2    | 1.16       | .550 | .500 | 07              | Nickel  | Silver     | UG-291C/U       | A/17                         |
| 5, 6        | 2    | 1.16       | .550 | .500 | 07              | Silver  | Gold (C)   | M39012/18-0102  | A/17                         |
| 5, 6        | 2    | 1.16       | .550 | .500 | 07              | Nickel  | Gold (C)   | 1011015N071-000 | A/17                         |
| 7           | 2    | 1.16       | .550 | .500 | 07              | Nickel  | Silver     | UG-262C/U       | A/17                         |
| 7           | 2    | 1.16       | .550 | .500 | 07              | Silver  | Gold (C)   | M39012/18-0101  | A/17                         |
| 7           | 2    | 1.16       | .550 | .500 | 07              | Nickel  | Silver (C) | 1011021N071-000 | A/17                         |
| 8A          | 2    | 1.16       | .550 | .500 | 07              | Silver  | Gold (C)   | M39012/18-0103  | A/17                         |
| 9           | 2    | 1.16       | .550 | .500 | 07              | Nickel  | Silver     | 1011036N070-000 | A/18                         |
| 9           | 2    | 1.16       | .550 | .500 | 07              | Nickel  | Silver (C) | 1011036N071-000 | A/38                         |
| 9           | 2    | 1.16       | .550 | .500 | 07              | Silver  | Gold (C)   | M39012/18-0220  | A/38                         |
| 11          | 2    | 1.16       | .550 | .500 | 07              | Nickel  | Silver     | 1011038N070-000 | A/18                         |
| 11          | 2    | 1.16       | .550 | .500 | 07              | Nickel  | Silver (C) | 1011038N071-000 | A/18                         |
| 22          | 2    | 1.16       | .550 | .500 | 07              | Silver  | Gold (C)   | M39012/18-0118  | A/17                         |
| 23          | 2    | 1.16       | .550 | .500 | 07              | Silver  | Gold (C)   | M39012/18-0111  | A/17                         |

## Panel Jack - Solder-Clamp For Semi-Rigid Cable

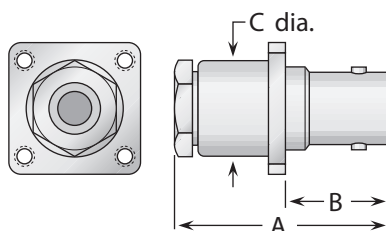

Figure 1

| Cable Group | Fig. | Dimensions |      |      | Mounting Figure | Plating |         | Delta P/N       | Assembly Procedure/Trim Code |
|-------------|------|------------|------|------|-----------------|---------|---------|-----------------|------------------------------|
|             |      | A          | B    | C    |                 | Body    | Contact |                 |                              |
| 13          | 1    | 1.16       | .550 | .500 | 07              | Nickel* | Gold    | 1011031N073-000 | F/08                         |
| 14          | 1    | 1.16       | .550 | .500 | 07              | Nickel* | Gold    | 1011025N073-000 | F/07                         |

\* Solder ferrule is gold plated.

- See page 209 for cable groups.
- Assembly procedures start on page 210.
- See page 208 for mounting dimensions.
- (C) in contact plating column indicates captive contact.
- See page 6 for alternate body plating information.

## Panel Jack- Heli-Grip® For Flexible Cable

### Heli-Grip® Cable Attachment

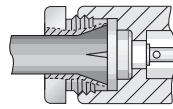
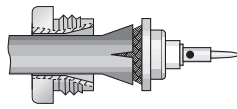

These connectors have captivated contacts and allow rapid, easy assembly—simply trim the cable, slide into the cone/insulator/contact assembly (left), solder the center conductor to the contact, and screw body assembly (right) onto the cable assembly.

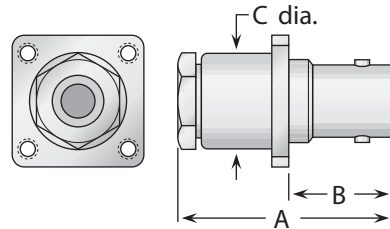

Figure 1

| Cable Group       | Fig. | Dimensions |      |      | Mounting Figure | Plating |            | Delta P/N       | Assembly Procedure/Trim Code |
|-------------------|------|------------|------|------|-----------------|---------|------------|-----------------|------------------------------|
|                   |      | A          | B    | C    |                 | Body    | Contact    |                 |                              |
| 5, 6 <sup>§</sup> | 1    | 1.16       | .550 | .500 | 07              | Nickel  | Silver (C) | 1011018N075-000 | E/03                         |
| RG-223            | 1    | 1.16       | .550 | .500 | 07              | Nickel  | Silver (C) | 1011015N075-000 | E/03                         |
| 7                 | 1    | 1.16       | .550 | .500 | 07              | Nickel  | Silver (C) | 1011019N075-000 | E/03                         |
| 8A                | 1    | 1.16       | .550 | .500 | 07              | Nickel  | Silver (C) | 1011029N075-000 | E/03                         |
| 8B                | 1    | 1.16       | .550 | .500 | 07              | Nickel  | Silver (C) | 1011043N075-000 | E/03                         |
| 9                 | 1    | 1.16       | .550 | .500 | 07              | Nickel  | Silver (C) | 1011037N075-000 | E/03                         |
| 10                | 1    | 1.16       | .550 | .500 | 07              | Nickel  | Silver (C) | 1011100N075-000 | E/03                         |
| 11                | 1    | 1.16       | .550 | .500 | 07              | Nickel  | Silver (C) | 1011038N075-000 | E/03                         |

<sup>§</sup>Except RG-223/U.

## Panel Jack - Crimp Type for Flexible Cable

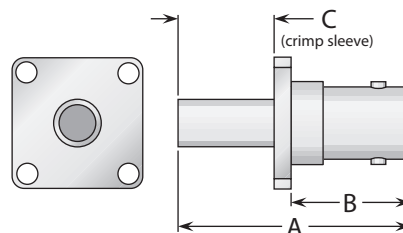

Figure 1

| Cable Group | Fig. | Dimensions |      |      | Mounting Figure | Plating |          | Delta P/N       | Assembly Procedure/Trim Code |
|-------------|------|------------|------|------|-----------------|---------|----------|-----------------|------------------------------|
|             |      | A          | B    | C    |                 | Body    | Contact  |                 |                              |
| 5           | 1    | 1.22       | .630 | .500 | 09              | Nickel  | Gold (C) | 1055017N091-000 | B/12                         |
| 6           | 1    | 1.22       | .630 | .500 | 09              | Nickel  | Gold (C) | 1055015N091-000 | B/12                         |
| 7           | 1    | 1.22       | .630 | .500 | 09              | Nickel  | Gold (C) | 1055019N091-000 | B/12                         |

- See page 209 for cable groups.
- Assembly procedures start on page 210.
- See page 208 for mounting dimensions.
- (C) in contact plating column indicates captive contact.
- See page 6 for alternate body plating information.

## Panel Jack Receptacles - Square Flange

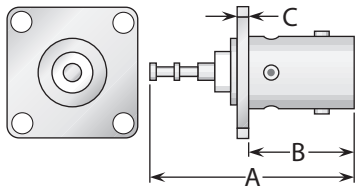

Figure 1  
(Turret contact)

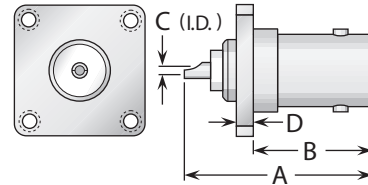

Figure 2  
(Solder pot contact)

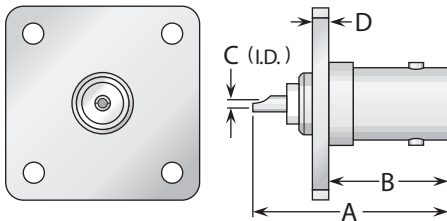

Figure 3  
(Solder pot contact, 1" square flange,  
interchangeable with type N standard flange size)

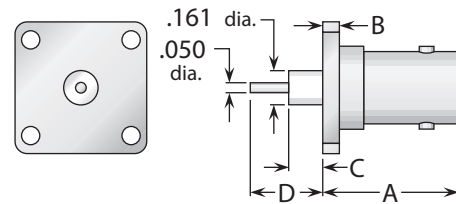

Figure 4  
(Post contact)

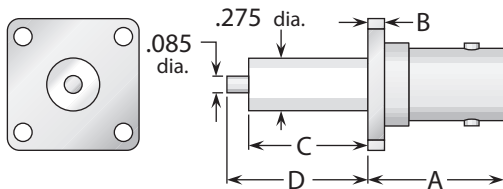

Figure 5  
(Post contact)

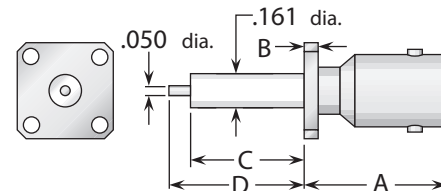

Figure 6  
(Post contact, 1/2" square flange,  
interchangeable with SMA standard flange size)

| Figure | Dimensions |      |      |      | Mounting Figure | Plating |            | Delta P/N         |
|--------|------------|------|------|------|-----------------|---------|------------|-------------------|
|        | A          | B    | C    | D    |                 | Body    | Contact    |                   |
| 1      | 1.06       | .550 | .050 | —    | 18              | Nickel  | Silver (C) | UG-185/U          |
| 2      | 1.06       | .630 | .062 | .090 | 07              | Nickel  | Silver (C) | UG-290A/U         |
| 2      | 1.06       | .630 | .043 | .090 | 12              | Nickel  | Silver (C) | UG-447/U          |
| 2      | 1.06       | .630 | .062 | .090 | 07              | Silver  | Gold (C)   | M39012/22-0001    |
| 2      | 1.06       | .630 | .062 | .090 | 09              | Nickel  | Silver (C) | 1013000N090-000   |
| 2      | 1.06       | .630 | .062 | .090 | 10              | Nickel  | Silver (C) | 1013000N100-000   |
| 2      | 1.06       | .630 | .062 | .090 | 18              | Nickel  | Gold (C)   | 1013000N180-000   |
| 2      | 1.00       | .750 | .062 | .080 | 18 <sup>s</sup> | Nickel  | Gold (C)   | 1013000F181-000** |
| 3      | 1.06       | .630 | .062 | .080 | 33              | Nickel  | Silver (C) | 1013000N330-000   |
| 4      | .715       | .090 | .175 | .375 | 09              | Nickel  | Silver (C) | 1058000N091-000   |
| 5      | .750       | .080 | .590 | .705 | 18 <sup>s</sup> | Nickel  | Gold (C)*  | 1058000N181-001   |
| 6      | .750       | .080 | .590 | .705 | 05              | Nickel  | Gold (C)   | 1058000N051-000   |

- (C) in contact plating column indicates captive contact.
- \*Indicates epoxy-captivated contact.
- \*\*Insulator flush with rear of flange.
- <sup>s</sup>Flange #18 except with .125 dia. mounting holes.
- See page 6 for alternate body plating information.

- See page 208 for mounting dimensions.
- All items are available with other flange sizes and contact configurations.

## Right Angle Panel Jack Receptacles - Square Flange

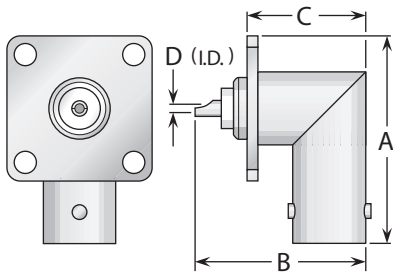

Figure 1  
(Solder pot contact)

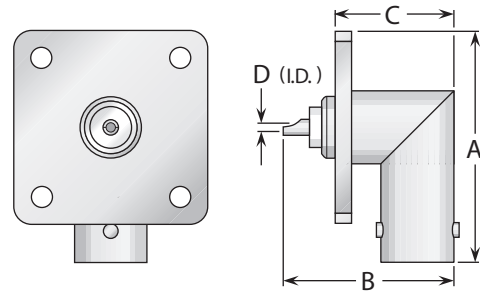

Figure 2  
(Solder pot contact, 1" square flange, interchangeable with type N standard flange size)

| Figure | Dimensions |      |      |      | Mounting Figure | Plating |            | Delta P/N       |
|--------|------------|------|------|------|-----------------|---------|------------|-----------------|
|        | A          | B    | C    | D    |                 | Body    | Contact    |                 |
| 1      | 1.09       | .910 | .610 | .062 | 18              | Nickel  | Silver (C) | UG-535/U        |
| 1      | 1.06       | .910 | .650 | .062 | 07              | Nickel  | Silver (C) | 1015000N070-000 |
| 1      | 1.06       | .910 | .650 | .062 | 09              | Nickel  | Gold (C)   | 1015000N090-000 |
| 2      | 1.22       | .910 | .610 | .062 | 33              | Nickel  | Silver (C) | 1015000N330-000 |

## Panel Plug Receptacles - Square Flange

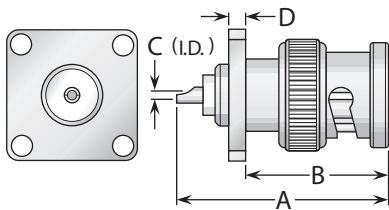

Figure 1  
(Solder pot contact, 3/4" square flange)

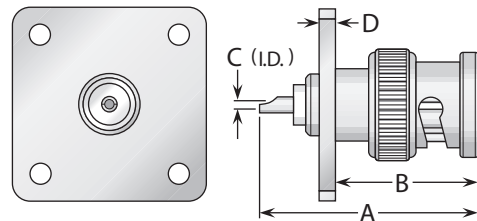
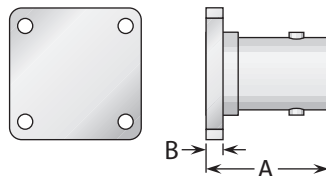

Figure 2  
(Solder pot contact, 1" square flange, interchangeable with type N standard flange size)

| Figure | Dimensions |      |      |      | Mounting Figure | Plating |            | Delta P/N       |
|--------|------------|------|------|------|-----------------|---------|------------|-----------------|
|        | A          | B    | C    | D    |                 | Body    | Contact    |                 |
| 1      | 1.19       | .800 | .062 | .090 | 18              | Nickel  | Silver (C) | UG-1104A/U      |
| 2      | 1.19       | .800 | .062 | .080 | 33              | Nickel  | Silver (C) | 1023000N330-000 |

## Dummy Receptacles



| Dimensions |      | Mounting Figure | Plating |         | Delta P/N       |
|------------|------|-----------------|---------|---------|-----------------|
| A          | B    |                 | Body    | Contact |                 |
| .750       | .090 | 09              | Nickel  | —       | 1063000N090-000 |

- (C) in contact plating column indicates captive contact.
- See page 6 for alternate body plating information.
- See page 208 for mounting dimensions.
- All items are available with other flange sizes and contact configurations.

## Bulkhead Jack Receptacles

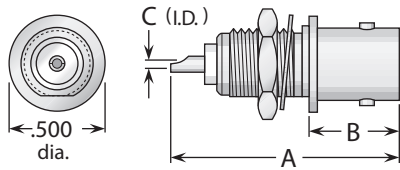

**Figure 1**  
(Front mount)

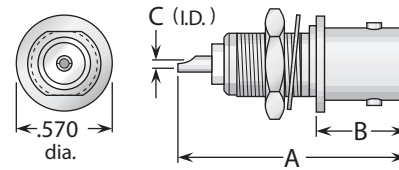

**Figure 2**  
(Front mount, pressurized [non-hermetic], with mounting gasket)

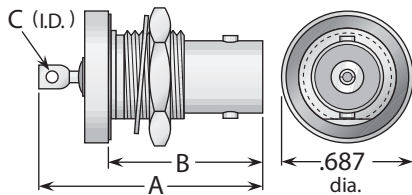

**Figure 3**  
(Rear mount, hermetically sealed, with mounting gasket)

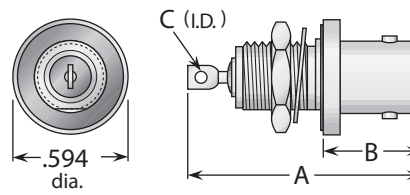

**Figure 4**  
(Front mount, hermetically sealed, with mounting gasket)

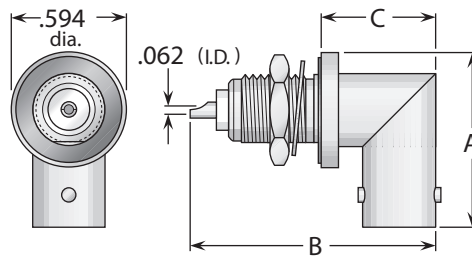

**Figure 5**  
(Right angle, solder pot contact)

| Figure | Dimensions |      |      | Max. Panel | Mounting Figure | Plating |            | Delta P/N      |
|--------|------------|------|------|------------|-----------------|---------|------------|----------------|
|        | A          | B    | C    |            |                 | Body    | Contact    |                |
| 1      | 1.06       | .490 | .062 | .130       | 62              | Nickel  | Silver (C) | UG-625B/U      |
| 2      | 1.28       | .600 | .052 | .190       | 75              | Nickel  | Silver (C) | UG-657/U       |
| 2      | 1.28       | .600 | .052 | .190       | 75              | Nickel  | Silver (C) | UG-657A/U      |
| 1      | 1.06       | .470 | .062 | .130       | 65              | Nickel  | Silver (C) | UG-1094/U      |
| 1      | 1.19       | .470 | .062 | .260       | 65              | Nickel  | Silver (C) | UG-1094A/U     |
| 1      | 1.06       | .490 | .062 | .130       | 62              | Silver  | Gold (C)   | M39012/21-0001 |
| 1      | 1.19       | .470 | .062 | .260       | 65              | Silver  | Gold (C)   | M39012/21-0002 |
| 1      | 1.19       | .470 | .062 | .260       | 62              | Silver  | Gold (C)   | M39012/21-0003 |
| 3      | 1.20       | .830 | .062 | .260       | 59              | Nickel  | Silver (C) | UG-911A/U      |
| 3      | 1.20       | .830 | .062 | .260       | 59              | Silver  | Gold (C)   | M39012/24-0001 |
| 4      | 1.20       | .520 | .062 | .260       | 63              | Nickel  | Silver (C) | UG-912/U       |
| 4      | 1.33       | .520 | .062 | .340       | 63              | Nickel  | Silver (C) | UG-912A/U      |
| 4      | 1.20       | .520 | .062 | .260       | 63              | Silver  | Gold (C)   | M39012/24-0002 |
| 5      | .920       | 1.22 | .590 | .130       | 63              | Nickel  | Silver (C) | UG-1098/U      |
| 5      | .920       | 1.34 | .590 | .250       | 63              | Nickel  | Silver (C) | UG-1098A/U     |
| 5      | .920       | 1.22 | .590 | .130       | 62              | Nickel  | Silver (C) | UG-1174/U      |

- (C) in contact plating column indicates captive contact.
- See page 6 for alternate body plating information.
- See page 208 for mounting dimensions.
- All items are available with other flange sizes and contact configurations.

## Bulkhead Jack Receptacles With Solder Lug

Figure 1  
(Standard grounding)

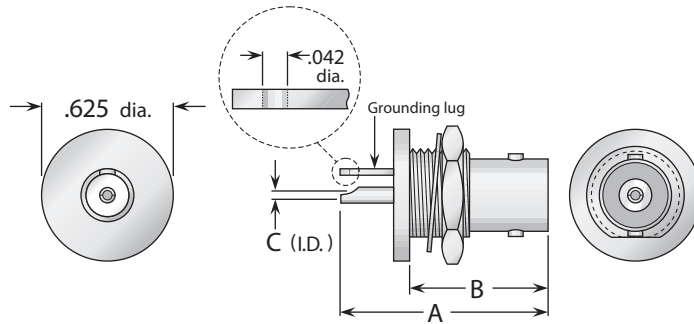

## Isolated-Ground Receptacles

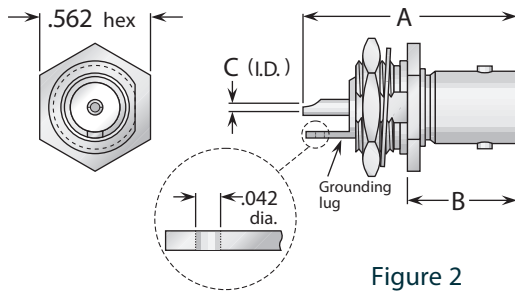
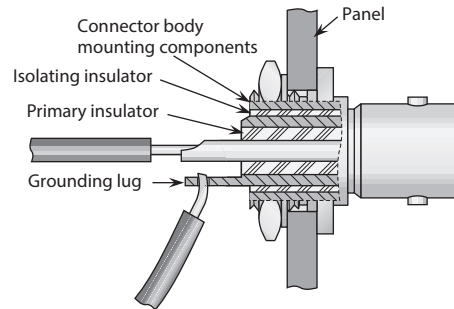

Figure 2  
(Isolated ground)



These receptacles feature an additional insulator between the main connector body and the body's mounting surfaces, electrically isolating the ground signal of the circuit from the panel. The circuit ground signal is passed through the panel via the solder lug for termination inside the equipment. Since they are not a triaxial connector design, isolated-ground receptacles can be used with any standard BNC plugs.

| Figure | Dimensions |      |      | Max. Panel | Mounting Figure | Plating |          | Delta P/N       |
|--------|------------|------|------|------------|-----------------|---------|----------|-----------------|
|        | A          | B    | C    |            |                 | Body    | Contact  |                 |
| 1      | 1.06       | .750 | .062 | .170       | 59              | Nickel  | Gold (C) | 1021000N591-000 |
| 2      | 1.06       | .500 | .062 | .170       | 59              | Nickel  | Gold (C) | 1020000F59G-000 |

## Bulkhead Plug Receptacles

Figure 1  
(Front mount)

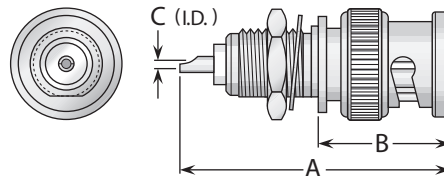

Bulkhead Plug Receptacle

| Figure | Dimensions |      |      | Max. Panel | Mounting Figure | Plating |            | Delta P/N       |
|--------|------------|------|------|------------|-----------------|---------|------------|-----------------|
|        | A          | B    | C    |            |                 | Body    | Contact    |                 |
| 1      | 1.25       | .690 | .062 | .160       | 65              | Nickel  | Silver (C) | 1024000N651-000 |

- (C) in contact plating column indicates captive contact.
- See page 6 for alternate body plating information.
- See page 208 for mounting dimensions.
- All items are available with other flange sizes and contact configurations.

## Receptacles For Printed Circuit Boards

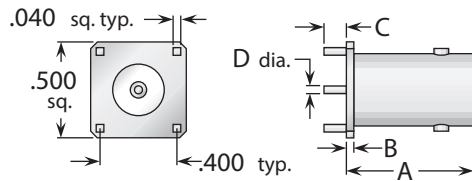

Figure 1

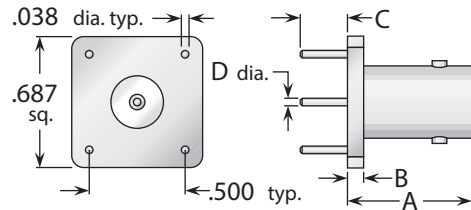

Figure 2

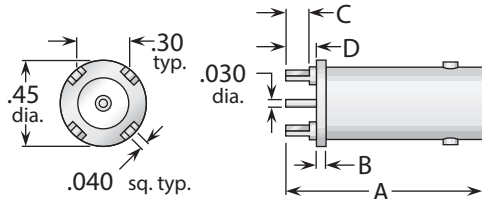

Figure 3

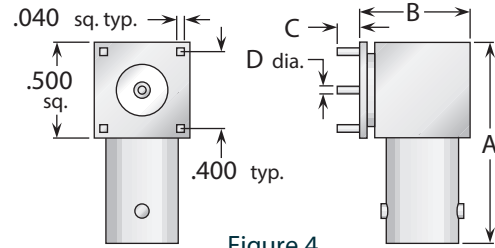

Figure 4

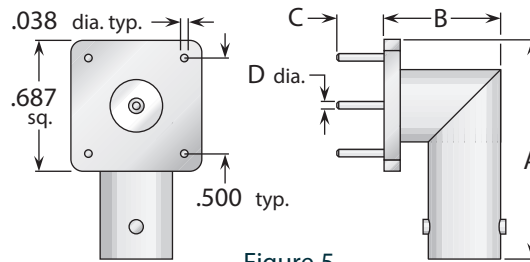

Figure 5

| Figure | Dimensions |      |      |      | Max. Board Thickness | Mounting Figure | Plating |            | Delta P/N       |
|--------|------------|------|------|------|----------------------|-----------------|---------|------------|-----------------|
|        | A          | B    | C    | D    |                      |                 | Body    | Contact    |                 |
| 1      | .660       | .040 | .116 | .040 | .063                 | PCB01           | Nickel  | Gold (C)   | 1058000N04P-000 |
| 1      | 1.15       | .040 | .116 | .040 | .063                 | PCB01           | Nickel  | Gold (C)   | 1058000N04P-001 |
| 2      | .650       | .085 | .250 | .038 | .125                 | PCB02           | Nickel  | Gold (C)   | 1058000N13P-000 |
| 3      | 1.03       | .050 | .125 | .160 | .063                 | PCB03           | Nickel  | Silver (C) | 1067000N91P-001 |
| 4      | 1.06       | .575 | .116 | .040 | .063                 | PCB01           | Nickel  | Gold (C)   | 1069000N03P-000 |
| 5      | .950       | .610 | .250 | .038 | .125                 | PCB02           | Nickel  | Gold (C)   | 1069000N13P-000 |

## Stripline Receptacles

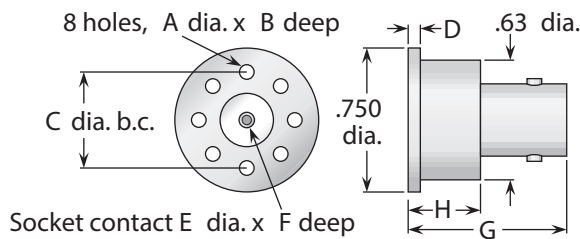

Figure 1

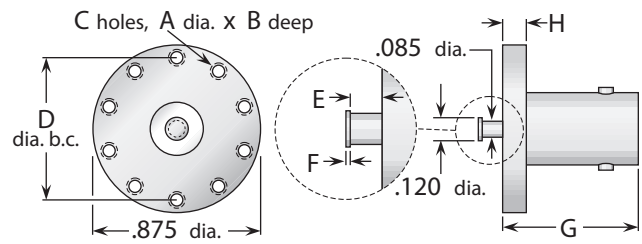

Figure 2

| Figure | Dimensions |      |      |      |      |      |      |      | Plating |          | Delta P/N       |
|--------|------------|------|------|------|------|------|------|------|---------|----------|-----------------|
|        | A          | B    | C    | D    | E    | F    | G    | H    | Body    | Contact  |                 |
| 1      | .078       | .310 | .500 | .063 | .063 | .220 | .828 | .375 | Nickel  | Gold (C) | 1056000N000-000 |
| 2      | #2-56      | .125 | 10   | .734 | .125 | .010 | .710 | .125 | Nickel  | Gold     | 1057000N000-000 |

- (C) in contact plating column indicates captive contact.
- See page 6 for alternate body plating information.
- See page 208 for mounting dimensions.



## Press Mount Receptacles

### Delta Press Mount Receptacles

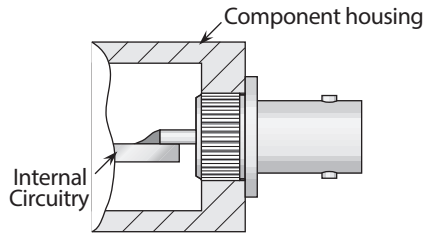

These connectors eliminate the need for complicated mounting hole patterns and mounting hardware.

They are simply pressed into a single through hole, and the precisely-engineered knurled mounting section provides retention strength far greater than normal mating and unmating forces. An integral shoulder provides a positive stop when mounting.

PressMounts are available for a wide variety of Delta connector series, and can be used in packages as small as the outer diameter of the connector body.

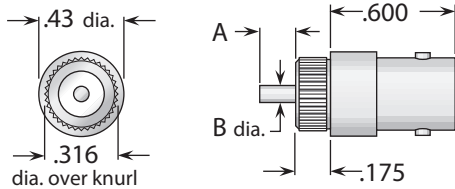

Figure 1  
(Post contact)

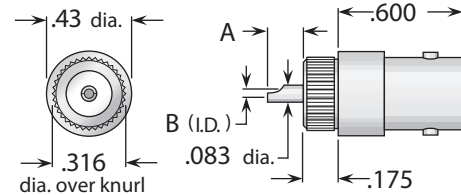

Figure 2  
(Solder pot contact)

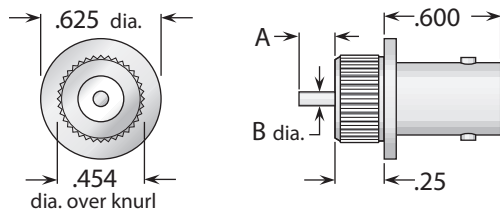

Figure 3  
(Post contact)

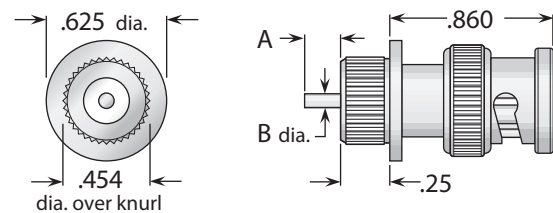
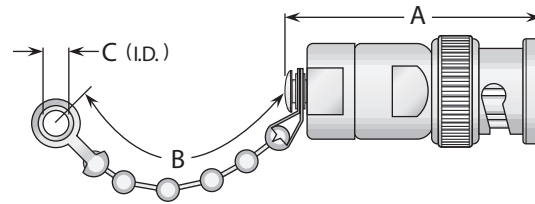

Figure 4  
(Plug type, post contact)

| Figure | Dimensions |      | Min. Panel | Mounting Hole   | Plating |            | Delta P/N       |
|--------|------------|------|------------|-----------------|---------|------------|-----------------|
|        | A          | B    |            |                 | Body    | Contact    |                 |
| 1      | .062       | .050 | .150       | .312 ±.001 dia. | Nickel  | Silver (C) | 1020000N911-001 |
| 2      | .285       | .062 | .150       | .312 ±.001 dia. | Nickel  | Silver (C) | 1020000N911-002 |
| 3      | .060       | .050 | .200       | .450 ±.001 dia. | Nickel  | Gold (C)   | 1020000N911-013 |
| 4      | .060       | .050 | .200       | .450 ±.001 dia. | Nickel  | Gold (C)   | 1024000N911-004 |

- (C) in contact plating column indicates captive contact.
- See page 6 for alternate body plating information.
- All items are available with other flange sizes and contact configurations.

## Resistive Termination (Plug Type)



| Resistor           | Dimensions |      |      | Features | Plating |            | Delta P/N       |
|--------------------|------------|------|------|----------|---------|------------|-----------------|
|                    | A          | B    | C    |          | Body    | Contact    |                 |
| 51 Ω ±5%, 1/2 Watt | 1.25       | 3.50 | .144 |          | Nickel  | Gold (C)   | MX-554/U        |
| 51 Ω ±5%, 1/2 Watt | 1.41       | 3.50 | .144 |          | Nickel  | Silver (C) | MX-554A/U       |
| 51 Ω ±5%, 1/2 Watt | 1.14       | —    | —    | No chain | Nickel  | Gold (C)   | 1031000N00A-003 |
| 51 Ω ±5%, 1 Watt   | 1.50       | 4.50 | .130 |          | Nickel  | Silver (C) | 1051000N000-000 |
| 51 Ω ±5%, 1 Watt   | 1.39       | —    | —    | No chain | Nickel  | Silver (C) | 1051000N00A-005 |
| 75 Ω ±5%, 1/2 Watt | 1.41       | 3.50 | .144 |          | Nickel  | Silver (C) | 1031000N000-004 |
| 75 Ω ±5%, 1/2 Watt | 1.14       | —    | —    | No chain | Nickel  | Gold (C)   | 1031000N00A-001 |
| 75 Ω ±5%, 1 Watt   | 1.39       | —    | —    | No chain | Nickel  | Silver (C) | 1051000N00A-002 |

## Dust Caps

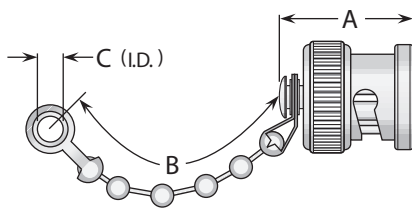

Figure 1  
(Shown with bead chain)

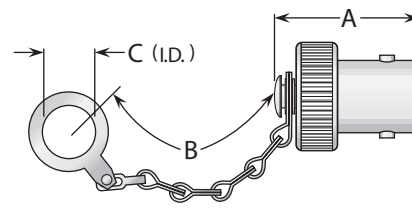
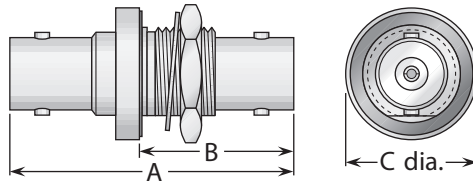

Figure 2  
(Shown with safety chain)

| Figure | Dimensions |      |      | Features                   | Plating |            | Delta P/N      |
|--------|------------|------|------|----------------------------|---------|------------|----------------|
|        | A          | B    | C    |                            | Body    | Contact    |                |
| 1      | .670       | 2.25 | .144 | Bead chain                 | Nickel  | —          | CW-123A/U      |
| 1      | .590       | —    | —    | No chain                   | Nickel  | —          | CW-155A/U      |
| 1      | .690       | 2.25 | .144 | Bead chain / shorting type | Nickel  | Silver (C) | CW-159/U       |
| 1      | .670       | 2.25 | .144 | Bead chain                 | Silver  | —          | M39012/25-0006 |
| 1      | .670       | 2.70 | .520 | Safety chain               | Silver  | —          | M39012/25-0007 |
| 2      | .690       | 3.25 | .281 | Bead chain                 | Nickel  | —          | CW-282/U       |
| 2      | .690       | 3.25 | .281 | Bead chain                 | Silver  | —          | M39012/25-0008 |
| 2      | .690       | 3.25 | .281 | Safety chain               | Silver  | —          | M39012/25-0009 |

- (C) in contact plating column indicates captive contact.
- See page 6 for alternate body plating information.
- Caps and terminations are available with other chain styles and/or resistances.

## Bulkhead Jack-Jack Adapter (Connects Two Plugs)



| Dimensions |      |      | Max. Panel | Mounting Figure | Plating |            | Delta P/N         |
|------------|------|------|------------|-----------------|---------|------------|-------------------|
| A          | B    | C    |            |                 | Body    | Contact    |                   |
| 1.53       | .860 | .690 | .275       | 59              | Nickel  | Silver (C) | UG-492A/U *       |
| 1.53       | .860 | .690 | .275       | 59              | Nickel  | Silver (C) | UG-492C/U *       |
| 1.53       | .860 | .690 | .275       | 59              | Nickel  | Silver (C) | UG-492D/U *       |
| 1.53       | .860 | .690 | .275       | 59              | Silver  | Gold (C)   | M55339/13-00492 * |
| 1.28       | .800 | .625 | .160       | 59              | Nickel  | Silver (C) | 1026000N591-000   |

\* Hermetically sealed, with mounting gasket.

## Panel Mounted Jack-Jack Adapter (Connects Two Plugs)

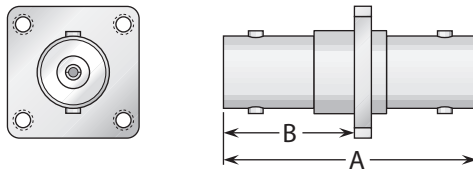

| Dimensions |      | Mounting Figure | Plating |            | Delta P/N |
|------------|------|-----------------|---------|------------|-----------|
| A          | B    |                 | Body    | Contact    |           |
| 1.28       | .690 | 07              | Nickel  | Silver (C) | UG-414A/U |

## Straight Jack-Jack Adapter (Connects Two Plugs)

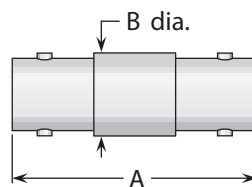

| Dimensions |      | Plating |            | Delta P/N       |
|------------|------|---------|------------|-----------------|
| A          | B    | Body    | Contact    |                 |
| 1.28       | .440 | Nickel  | Silver (C) | UG-914/U        |
| 1.28       | .440 | Silver  | Gold (C)   | M55339/16-00914 |
| 1.28       | .440 | Nickel  | Gold (C)   | 1028000N001-003 |

- (C) in contact plating column indicates captive contact.
- See page 6 for alternate body plating information.
- See page 208 for mounting dimensions.

## Straight Plug-Plug Adapter (Connects Two Jacks)

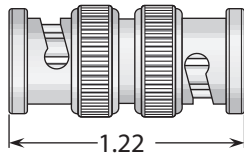

| Plating |            | Delta P/N       |
|---------|------------|-----------------|
| Body    | Contact    |                 |
| Nickel  | Silver (C) | UG-491B/U       |
| Silver  | Gold (C)   | M55339/15-00491 |

## Straight Plug-Jack Adapter (Connects One Jack & One Plug)

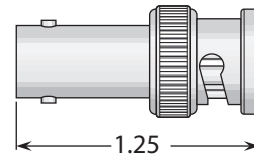

| Plating |          | Delta P/N       |
|---------|----------|-----------------|
| Body    | Contact  |                 |
| Nickel  | Gold (C) | 1034000N000-000 |

## Right Angle & Tee Adapter

Figure 1  
(Right angle plug-jack;  
connects one plug  
and one jack)

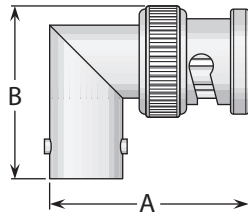

Figure 2  
(Tee jack-plug-jack;  
connects two plugs  
and one jack)

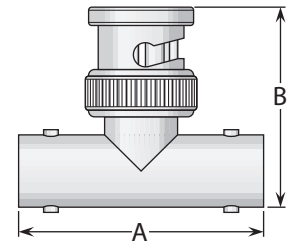

Figure 3  
(Tee jack-jack-jack;  
connects three plugs)

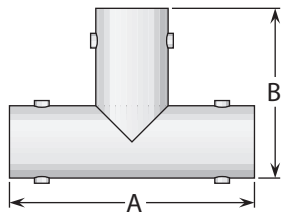
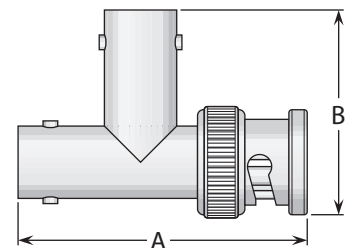

Figure 4  
(Tee jack-jack-plug;  
connects two plugs  
and one jack)



| Figure | Dimensions |      | Plating |            | Delta P/N       |
|--------|------------|------|---------|------------|-----------------|
|        | A          | B    | Body    | Contact    |                 |
| 1      | 1.06       | .880 | Nickel  | Silver (C) | UG-306A/U       |
| 1      | 1.06       | .880 | Nickel  | Silver (C) | UG-306B/U       |
| 1      | 1.06       | .880 | Silver  | Gold (C)   | M55339/14-00306 |
| 1      | 1.06       | .880 | Nickel  | Gold (C)   | 1029000N000-003 |
| 2      | 1.28       | 1.03 | Nickel  | Silver (C) | UG-274A/U       |
| 2      | 1.28       | 1.03 | Nickel  | Silver (C) | UG-274B/U       |
| 2      | 1.28       | 1.03 | Nickel  | Gold (C)   | UG-274C/U       |
| 2      | 1.28       | 1.03 | Silver  | Gold (C)   | M55339/17-00274 |
| 3      | 1.28       | .890 | Nickel  | Silver (C) | 1038000N000-002 |
| 3      | 1.28       | .970 | Silver  | Gold (C)   | M55339/17-00002 |
| 4      | 1.50       | 1.06 | Nickel  | Silver (C) | 1049000N000-000 |
| 4      | 1.50       | 1.06 | Silver  | Gold (C)   | M55339/17-00001 |

• (C) in contact plating column indicates captive contact.

• See page 6 for alternate body plating information.

## BNC75 Configurations

|  |    |   |    |
|--|----|---|----|
| Straight Cable Plugs .....                   | 31 | Panel Plug Receptacles.....             | 32 |
| Right Angle Cable Plugs .....                | 31 | Printed-Circuit Board Receptacles ..... | 32 |
| Bulkhead Cable Jacks .....                   | 31 | Bulkhead Jack Receptacles .....         | 33 |
| Panel Jack Receptacles (square flange) ..... | 32 | In-Series Adapters .....                | 33 |

## Straight & Right Angle Plugs For Flexible Cable

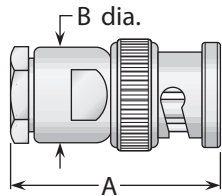

Figure 1  
(Heli-Grip® cable hardware)

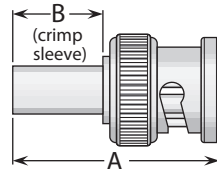

Figure 2  
(Crimp type)

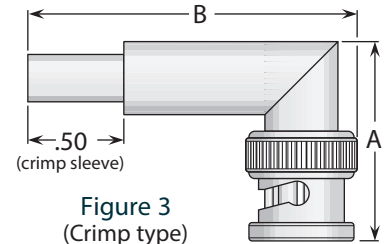
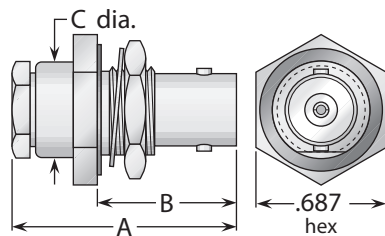

Figure 3  
(Crimp type)

| Cable Group | Figure | Dimensions |      | Plating |            | Delta P/N       | Assembly Procedure/<br>Trim Code |
|-------------|--------|------------|------|---------|------------|-----------------|----------------------------------|
|             |        | A          | B    | Body    | Contact    |                 |                                  |
| 7           | 1      | 1.06       | .500 | Nickel  | Silver (C) | 7501019N005-000 | E/03                             |
| 7           | 2      | 1.09       | .500 | Nickel  | Gold       | 7503020N000-002 | B/19                             |
| 7           | 2      | 1.05       | .410 | Nickel  | Gold (C)   | 7503020N001-000 | B/26                             |
| 7           | 3      | 1.03       | 1.71 | Nickel  | Gold       | 7507019N000-000 | B/02                             |
| 9           | 1      | 1.06       | .500 | Nickel  | Silver (C) | 7501037N005-000 | E/03                             |
| 9           | 2      | 1.13       | .390 | Nickel  | Gold       | 7503037N001-000 | B/27                             |
| 9           | 3      | 1.03       | 1.71 | Nickel  | Gold       | 7507037N000-000 | B/02                             |
| 26          | 2      | 1.10       | .450 | Nickel  | Gold (C)   | 7503108N001-000 | B/26                             |
| 31          | 2      | 1.13       | .500 | Nickel  | Gold       | 7503279N001-000 | B/19                             |

## Bulkhead Jack - Heli-Grip® For Flexible Cable

Figure 1  
(Rear mount)



### Heli-Grip® Cable Attachment

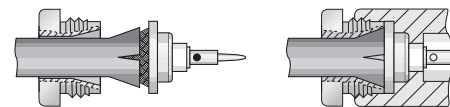

These connectors have captivated contacts and allow rapid, easy assembly—simply trim the cable, slide into the cone/insulator/contact assembly (left), solder the center conductor to the contact, and screw body assembly (right) onto cable assembly.

| Cable Group | Fig. | Dimensions |      |      | Mounting Figure | Max. Panel | Plating |          | Delta P/N       | Assembly Procedure/<br>Trim Code |
|-------------|------|------------|------|------|-----------------|------------|---------|----------|-----------------|----------------------------------|
|             |      | A          | B    | C    |                 |            | Body    | Contact  |                 |                                  |
| 7           | 1    | 1.16       | .810 | .500 | 59              | .240       | Nickel  | Gold (C) | 7516019N595-000 | E/03                             |
| 9           | 1    | 1.16       | .810 | .500 | 59              | .240       | Nickel  | Gold (C) | 7516037N595-000 | E/03                             |

- See page 209 for cable groups.
- Assembly procedures start on page 210.
- See page 208 for mounting dimensions.
- (C) in contact plating column indicates captive contact.
- See page 6 for alternate body plating information.

## Panel Jack & Plug Receptacles - Square Flange

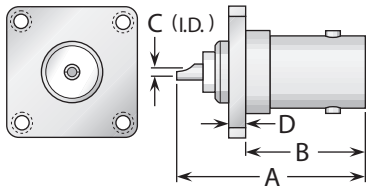

**Figure 1**  
(Solder pot contact, 11/16" square flange)

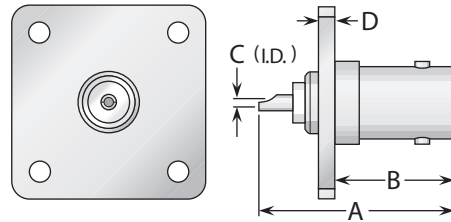

**Figure 2**  
(Solder pot contact, 1" square flange, interchangeable with type N standard flange size)

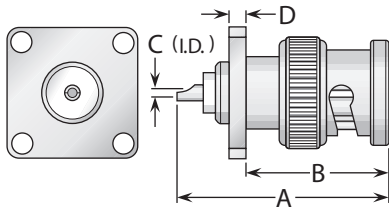

**Figure 3**  
(Solder pot contact, 3/4" square flange)

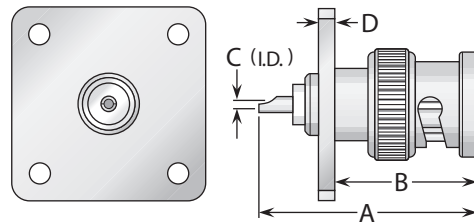

**Figure 4**  
(Solder pot contact, 1" square flange, interchangeable with type N standard flange size)

| Figure | Dimensions |      |      |      | Mounting Figure | Plating |          | Delta P/N       |
|--------|------------|------|------|------|-----------------|---------|----------|-----------------|
|        | A          | B    | C    | D    |                 | Body    | Contact  |                 |
| 1      | 1.06       | .630 | .030 | .090 | 09              | Nickel  | Gold (C) | 7513000N091-000 |
| 2      | 1.06       | .630 | .030 | .080 | 33              | Nickel  | Gold (C) | 7513000N331-002 |
| 3      | 1.19       | .800 | .030 | .090 | 18              | Nickel  | Gold (C) | 7523000N180-000 |
| 4      | 1.19       | .800 | .030 | .080 | 33              | Nickel  | Gold (C) | 7523000N331-001 |

## Receptacles For Printed Circuit Boards

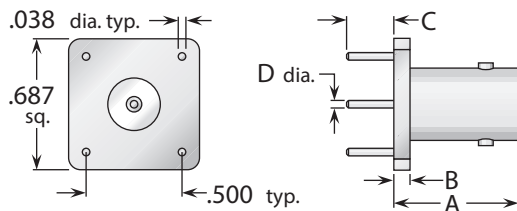

**Figure 1**

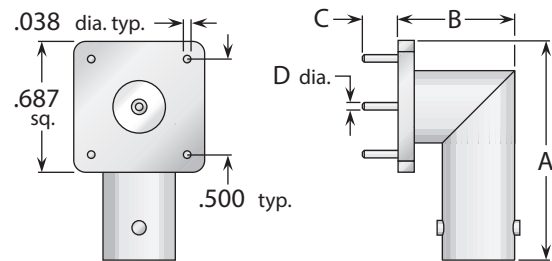

**Figure 2**

| Figure | Dimensions |      |      |      | Max. Board Thickness | Mounting Figure | Plating |            | Delta P/N       |
|--------|------------|------|------|------|----------------------|-----------------|---------|------------|-----------------|
|        | A          | B    | C    | D    |                      |                 | Body    | Contact    |                 |
| 1      | .650       | .085 | .250 | .038 | .125                 | PCB02           | Nickel  | Gold (C)   | 7567000N13P-001 |
| 2      | 1.34       | .520 | .125 | .038 | .063                 | PCB02           | Nickel  | Silver (C) | 7569000N13P-000 |

(C) in contact plating column indicates captive contact. • See page 208 for mounting dimensions.  
See page 6 for alternate body plating information.

## Bulkhead Jack Receptacles

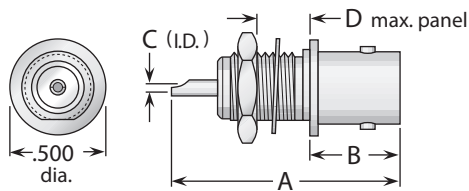

Figure 1  
(D-hole mounting)

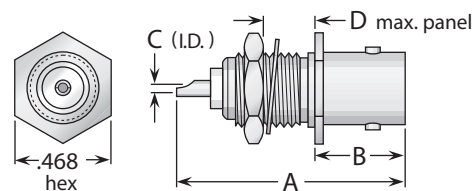
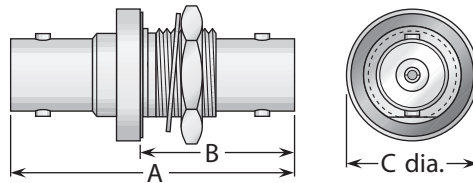

Figure 2  
(Round hole mounting)

| Figure | Dimensions |      |      |      | Mounting Figure | Plating |          | Delta P/N      |
|--------|------------|------|------|------|-----------------|---------|----------|----------------|
|        | A          | B    | C    | D    |                 | Body    | Contact  |                |
| 1      | 1.06       | .570 | .030 | .130 | 65              | Nickel  | Gold (C) | 752000N651-001 |
| 2      | 1.06       | .470 | .030 | .130 | 89              | Nickel  | Gold (C) | 752100N621-002 |

## Bulkhead Jack - Jack Adapter (Connect Two Plugs)



| Dimensions |      |      | Max. Panel | Mounting Figure | Plating |            | Delta P/N        |
|------------|------|------|------------|-----------------|---------|------------|------------------|
| A          | B    | C    |            |                 | Body    | Contact    |                  |
| 1.28       | .760 | .625 | .160       | 59              | Nickel  | Silver (C) | 752600N591-000 * |
| 1.28       | .800 | .625 | .160       | 59              | Nickel  | Silver (C) | 752600N591-001   |

## Straight & Right Angle Adapters

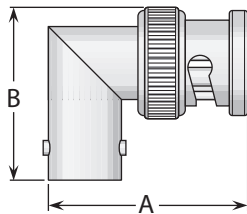

Figure 1  
(Right angle plug-jack;  
connects one plug and one jack)

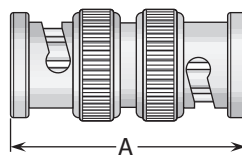

Figure 2  
(Straight plug-plug;  
connects two jacks)

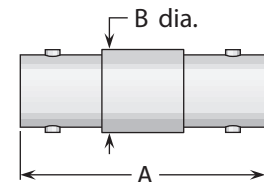

Figure 3  
(Straight jack-jack;  
connects two plugs)

| Figure | Dimensions |      | Plating |          | Delta P/N      |
|--------|------------|------|---------|----------|----------------|
|        | A          | B    | Body    | Contact  |                |
| 1      | 1.06       | .880 | Nickel  | Gold (C) | 752900N000-000 |
| 2      | 1.22       | —    | Nickel  | Gold (C) | 752700N001-000 |
| 3      | 1.28       | .440 | Nickel  | Gold (C) | 752800N001-000 |

- (C) in contact plating column indicates captive contact.
- See page 6 for alternate body plating information.
- See page 208 for mounting dimensions.
- \*Isolated ground mounting.



## Assembly Procedure A

- 1) Trim cable jacket to dimension A. Slide backnut, washer, V-gasket, and braid clamp onto cable as shown. Cable jacket should bottom on step in braid clamp.

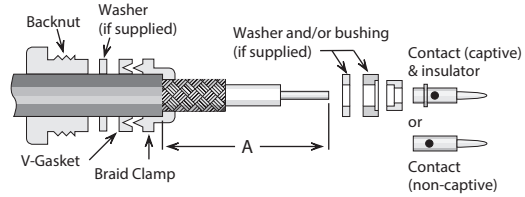

- 2) Comb braid wires out straight and fold back over front shoulder of braid clamp (braid wires should not overlap one another after folding). Trim braid wires flush with step of braid clamp. Trim cable dielectric and center conductor to dimensions B and C.

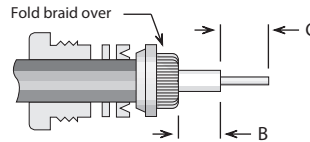

- 3) If support insulator is provided for RG-62 or 71 cable, insert into hollow in dielectric. Assemble rear bushing or washer (if supplied), rear insulator (if captive contact) and contact, and solder contact to center conductor. Rear of contact should be flush with cable dielectric end. For right angle connectors with access cap, omit this step entirely.

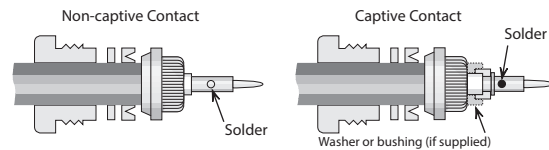

- 4) Insert prepared cable and hardware into body and tighten backnut. For right angle connectors with access cap, solder center conductor into slot in contact and tighten access cap.

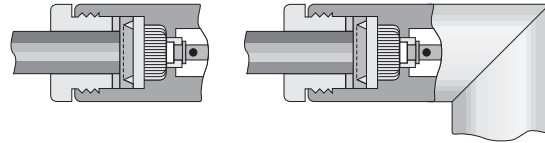

### Trim Codes For Assembly Procedure A

| Code | A            | B            | C            | Code | A            | B            | C            |
|------|--------------|--------------|--------------|------|--------------|--------------|--------------|
| A/01 | .375 (3/8)   | .047 (3/64)  | .203 (13/64) | A/20 | .375 (3/8)   | .047 (3/64)  | .172 (11/64) |
| A/02 | .375 (3/8)   | .109 (7/64)  | .203 (13/64) | A/21 | .500 (1/2)   | .313 (5/16)  | .172 (11/64) |
| A/03 | .438 (7/16)  | .250 (1/4)   | .188 (3/16)  | A/22 | .375 (3/8)   | .188 (3/16)  | .141 (9/64)  |
| A/04 | .281 (9/32)  | .047 (3/64)  | .125 (1/8)   | A/23 | .438 (7/16)  | .078 (5/64)  | .172 (11/64) |
| A/05 | .313 (5/16)  | .125 (1/8)   | .109 (7/64)  | A/24 | .500 (1/2)   | .094 (3/32)  | .141 (9/64)  |
| A/06 | .594 (19/32) | .391 (25/64) | .156 (5/32)  | A/25 | .438 (7/16)  | .141 (9/64)  | .172 (11/64) |
| A/07 | .375 (3/8)   | .047 (3/64)  | .125 (1/8)   | A/26 | .625 (5/8)   | .281 (9/32)  | .250 (1/4)   |
| A/08 | .281 (9/32)  | .109 (7/64)  | .094 (3/32)  | A/27 | .688 (11/16) | .281 (9/32)  | .125 (1/8)   |
| A/09 | .344 (11/32) | .109 (7/64)  | .094 (3/32)  | A/28 | .656 (21/32) | .297 (19/64) | .250 (1/4)   |
| A/10 | .406 (13/32) | .109 (7/64)  | .203 (13/64) | A/29 | .688 (11/16) | .125 (1/8)   | .313 (5/16)  |
| A/11 | .500 (1/2)   | .281 (9/32)  | .156 (5/32)  | A/30 | .688 (11/16) | .469 (15/32) | .156 (5/32)  |
| A/12 | .343         | .040         | .219         | A/31 | .700 (21/32) | .453 (29/64) | .250 (1/4)   |
| A/13 | .375 (3/8)   | .125 (1/8)   | .156 (5/32)  | A/32 | .313 (5/16)  | .078 (5/64)  | .188 (3/16)  |
| A/14 | .355         | .090         | .188 (3/16)  | A/33 | .250 (1/4)   | .078 (5/64)  | .094 (3/32)  |
| A/15 | .425         | .094 (3/32)  | .259         | A/34 | .250 (1/4)   | .062 (1/16)  | .109 (7/64)  |
| A/16 | .328 (21/64) | .094 (3/32)  | .188 (3/16)  | A/35 | .837         | .575         | .150         |
| A/17 | .375 (3/8)   | .109 (7/64)  | .125 (1/8)   | A/36 | .450         | .250         | .150         |
| A/18 | .375 (3/8)   | .062 (1/16)  | .172 (11/64) | A/37 | .281         | .038         | .188         |
| A/19 | .375 (3/8)   | .188 (3/16)  | .094 (3/32)  | A/38 | .281         | .069         | .156         |

## Assembly Procedure B

- 1) Trim cable per chart. Slide crimp sleeve back onto cable.

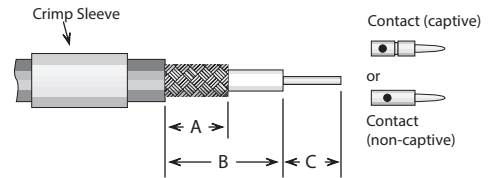

- 2) If support insulator is provided for RG-62 or 71 cable, insert into hollow in dielectric. Solder contact onto center conductor; back of contact flush with trimmed end of cable dielectric (omit this step for right angle connectors with access caps). Flare cut end of braid slightly by rotating dielectric.

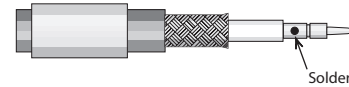

- 3) Insert cable/contact into rear of body, with all braid wires on outside of crimp tail.
  - a) For captive contact connectors, push cable in until contact snaps into insulator.
  - b) For noncaptive contact connectors, push cable in until cable dielectric bottoms in connector.
  - c) For right angle or tee connectors with access caps, push cable in until end of braid touches connector body shoulder, and cable center conductor rests in contact slot.

Trim excess braid wires even with shoulder of body. Slide crimp sleeve forward until flush with body and crimp (see page 211 for hex die sizes).

For right angle or tee connectors with access caps: Solder center conductor into contact slot, assemble insulator disc (if supplied), then press cap into body until seated or screw into place.

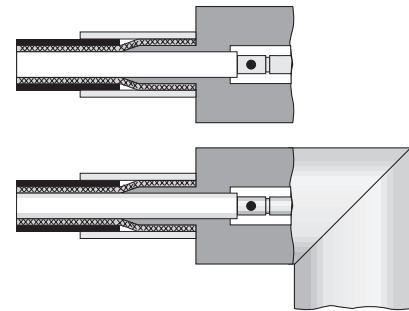

### Trim Codes For Assembly Procedure B

| Code | A    | B    | C    | Code | A    | B    | C    |
|------|------|------|------|------|------|------|------|
| B/01 | .320 | .470 | .140 | B/20 | .250 | .375 | .156 |
| B/02 | .422 | .578 | .172 | B/21 | .425 | .550 | .156 |
| B/03 | .406 | .500 | .187 | B/22 | .375 | .500 | .156 |
| B/04 | .285 | .505 | .140 | B/23 | .281 | .469 | .125 |
| B/05 | .335 | .460 | .140 | B/24 | .250 | .700 | .109 |
| B/06 | .187 | .437 | .219 | B/25 | .343 | .775 | .125 |
| B/07 | .422 | .610 | .156 | B/26 | .343 | .437 | .109 |
| B/08 | .422 | .562 | .219 | B/27 | .313 | .437 | .187 |
| B/09 | .313 | .610 | .203 | B/28 | .219 | .271 | .078 |
| B/10 | .280 | .436 | .187 | B/29 | .200 | .320 | .060 |
| B/11 | .430 | .542 | .156 | B/30 | .500 | .650 | .219 |
| B/12 | .300 | .434 | .156 | B/31 | .350 | .840 | .150 |
| B/13 | .300 | .447 | .156 | B/32 | .175 | .260 | .095 |
| B/14 | .420 | .645 | .187 | B/33 | .195 | .270 | .045 |
| B/15 | .300 | .420 | .120 | B/34 | .150 | .250 | .105 |
| B/16 | .312 | .609 | .125 | B/35 | .195 | .280 | .170 |
| B/17 | .250 | .500 | .156 | B/36 | .150 | .325 | .090 |
| B/18 | .437 | .562 | .109 | B/37 | .195 | .295 | .075 |
| B/19 | .343 | .437 | .156 | B/38 | .150 | .225 | .095 |
|      |      |      |      | B/39 | .250 | .300 | .135 |

## Assembly Procedure C

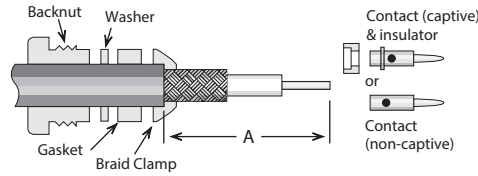

- 1) Trim cable jacket to dimension A. Slide backnut, washer, gasket, and braid clamp onto cable as shown. Cable jacket should bottom on step in braid clamp.

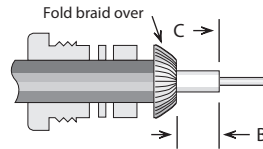

- 2) Comb braid wires out straight and fold back over front shoulder of braid clamp (braid wires should not overlap one another after folding). Trim braid wires flush with edge of braid clamp. Trim cable dielectric and center conductor to dimensions B and C.

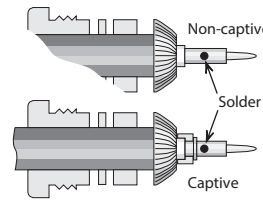

- 3) If support insulator is provided for RG-62 or 71 cable, insert into hollow in dielectric. Assemble rear insulator (if captive contact) and contact, and solder contact to center conductor. Rear of contact should be flush with cable dielectric end.

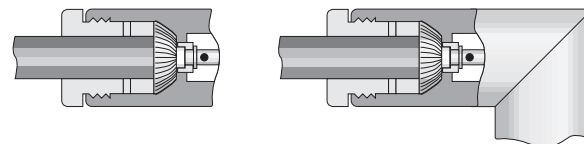

- 4) Insert prepared cable and hardware into body and tighten backnut. For right angle connectors with access cap, solder cable center conductor to slot in contact and tighten access cap.

| Trim Codes |              |             |             |
|------------|--------------|-------------|-------------|
| Code       | A            | B           | C           |
| C/01       | .656 (21/32) | .141 (9/64) | .250 (1/4)  |
| C/02       | .500 (1/2)   | .125 (1/8)  | .250 (1/4)  |
| C/03       | .450         | .136        | .187        |
| C/04       | .375 (3/8)   | .109 (7/64) | .125 (1/8)  |
| C/05       | .375 (3/8)   | .062 (1/16) | .250 (1/4)  |
| C/06       | .500 (1/2)   | .188 (3/16) | .125 (1/8)  |
| C/07       | .575         | .438        | .094        |
| C/08       | .625 (5/8)   | .141 (9/64) | .219 (7/32) |

## Assembly Procedure D

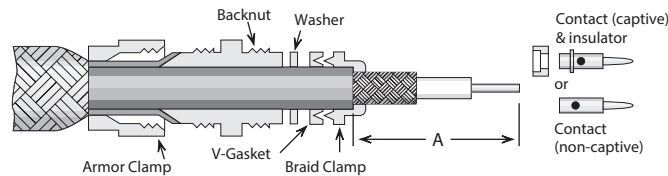

- 1) Slide armor clamp over cable. Push armor back to expose cable end. Slide backnut, washer (if supplied), gasket, and braid clamp onto cable as shown. Cable jacket should bottom on step in braid clamp. Trim cable jacket to dimension A.

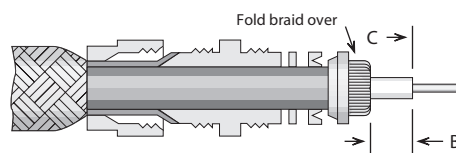

- 2) Comb braid wires out straight and fold back over front shoulder of braid clamp (braid wires should not overlap one another after folding). Trim braid wires flush with edge of braid clamp. Trim cable dielectric and center conductor to dimensions B and C.

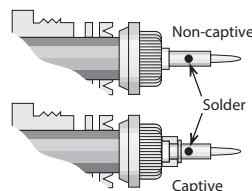

- 3) Assemble rear insulator (if captive contact) and contact, and solder contact to center conductor. Rear of contact should be flush with cable dielectric end.

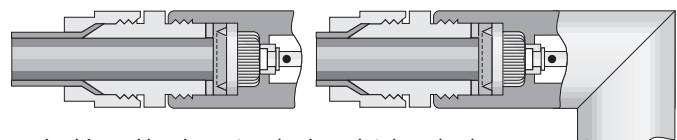

- 4) Insert prepared cable and hardware into body and tighten backnut. Trim armor to fit between armor clamp and braid clamp. Tighten armor clamp.

| Trim Codes |              |             |              |
|------------|--------------|-------------|--------------|
| Code       | A            | B           | C            |
| D/01       | .375 (3/8)   | .047 (3/64) | .250 (1/4)   |
| D/02       | .500 (1/2)   | .188 (3/16) | .219 (7/32)  |
| D/03       | .344 (11/32) | .047 (3/64) | .219 (7/32)  |
| D/04       | .313 (5/16)  | .047 (3/64) | .172 (11/64) |
| D/05       | .625 (5/8)   | .281 (9/32) | .250 (1/4)   |
| D/06       | .313 (5/16)  | .062 (1/16) | .109 (7/64)  |

## Assembly Procedure E

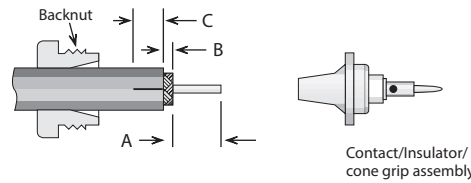

- 1) Slide backnut onto cable as shown. Trim cable to dimensions A and B as shown. Slit jacket to dimension C in two places, 180° apart.

| Trim Codes |             |             |             |
|------------|-------------|-------------|-------------|
| Code       | A           | B           | C           |
| E/01       | .250 (1/4)  | .141 (9/64) | .313 (5/16) |
| E/02       | .219 (7/32) | .063 (1/16) | .250 (1/4)  |
| E/03       | .250 (1/4)  | .031 (1/32) | .250 (1/4)  |

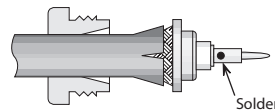

- 2) Slide cone/insulator/contact assembly under braid until braid is flush with shoulder. Solder contact to center conductor.

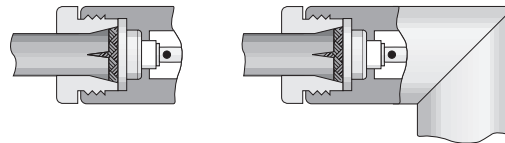

- 3) Insert prepared cable and hardware into body; tighten assembly by holding nut stationary and turning body.

## Assembly Procedure F

| Trim Codes |             |              |
|------------|-------------|--------------|
| Code       | A           | B            |
| F/01       | .250 (1/4)  | .219 (7/32)  |
| F/02       | .250 (1/4)  | .172 (11/64) |
| F/03       | .188 (3/16) | .188 (3/16)  |
| F/04       | .109 (7/64) | .265 (17/64) |
| F/05       | .156 (5/32) | .250 (1/4)   |
| F/06       | .219 (7/32) | .250 (1/4)   |
| F/07       | .156 (5/32) | .172 (11/64) |
| F/08       | .109 (7/64) | .219 (7/32)  |

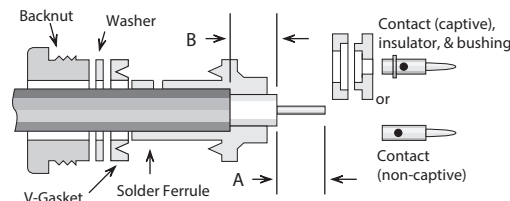

- 1) Trim cable per chart. Slide backnut, washer, v-gasket, and solder ferrule onto cable. Trimmed end of cable jacket should bottom on step in solder ferrule.

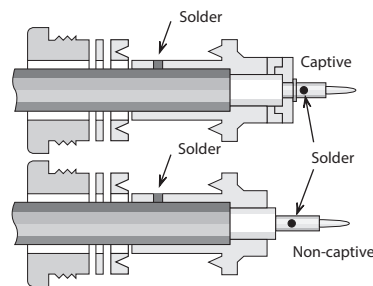

- 2) Solder ferrule to cable jacket as shown. Retrim cable dielectric to proper length if it has extruded from soldering heat. Slide bushing and rear insulator over cable dielectric if captive contact. Solder contact onto center conductor; back of contact flush with trimmed end of cable dielectric.

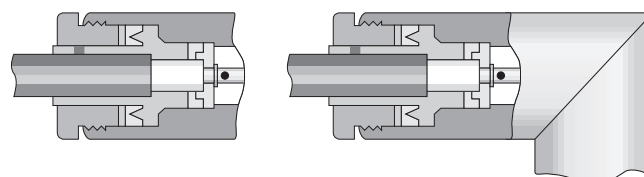

- 3) Insert prepared cable and hardware into body and tighten backnut.

## Assembly Procedure G

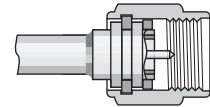
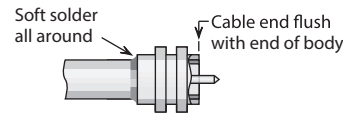
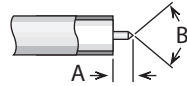
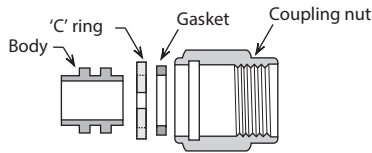

| Trim Codes |      |        |
|------------|------|--------|
| Code       | A    | B      |
| G/01       | .090 | 70-90° |

1) Trim cable as shown. Remove any burrs from jacket and center conductor.

2) Soft solder cable jacket to body, making sure that end of cable is flush with end of body. After solder joint has cooled, retrim any protruding dielectric flush with end of body.

3) Assemble 'C' ring and gasket to body. Compress 'C' ring and slide body assembly into coupling nut until ring is seated in groove.

## Assembly Procedure H

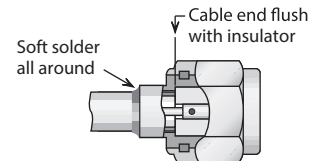
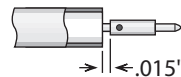
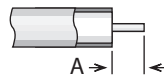
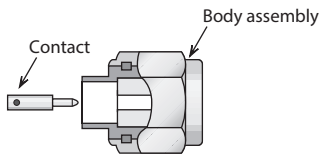

| Trim Codes |      |
|------------|------|
| Code       | A    |
| H/01       | .090 |
| H/02       | .060 |
| H/03       | .115 |
| H/04       | .150 |

1) Trim cable as shown. Remove any burrs from jacket and center conductor.

2) Solder contact to center conductor, fixturing to maintain gap as shown. Remove any excess solder from outside of contact.

3) Insert cable into body and solder cable jacket to body, keeping end of cable flush with insulator as shown.

Plug body assembly and contact shown; procedure is identical for jack connectors.

## Assembly Procedure I

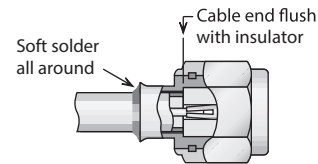
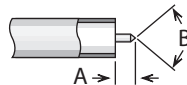
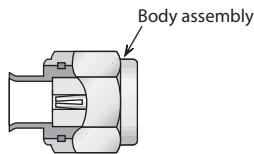

| Trim Codes |      |        |
|------------|------|--------|
| Code       | A    | B      |
| I/01       | .090 | 70-90° |

1) Trim cable as shown. Remove any burrs from jacket and center conductor.

2) Insert cable into body and solder cable jacket to body, keeping end of cable flush with insulator as shown.

Plug body assembly and contact shown; procedure is identical for jack connectors.

### Cable Positioner

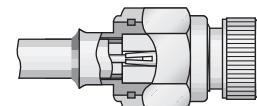
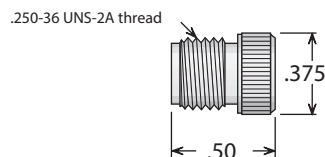

For .085" Cable:  
P/N 63-10072-2

For .141" Cable:  
P/N 63-10072-1

Using this positioner in the final step of assembly procedure H or I (for plugs only) will ensure that the contact and insulator are retained in the proper position to meet MIL-C-39012 requirements. The positioner should be screwed finger-tight into the mating end of the connector (as shown at right) before the cable jacket is soldered to the body assembly.

## Assembly Procedure J

| Trim Codes |      |      |
|------------|------|------|
| Code       | A    | B    |
| J/01       | .109 | .047 |
| J/02       | .059 | .039 |
| J/03       | .059 | .079 |
| J/04       | .050 | .059 |

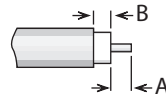

1) Trim cable as shown. Remove any burrs from jacket and center conductor.

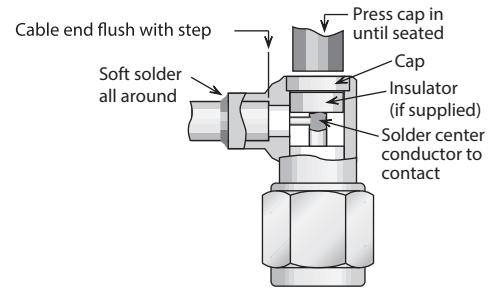

2) Soft solder cable jacket to body, making sure that end of cable is flush with step in body. Solder center conductor into contact slot, assemble insulator disc (if supplied), then press cap into body until seated or screw into place.

## Assembly Procedure K

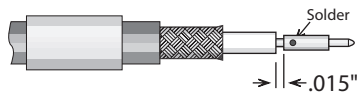
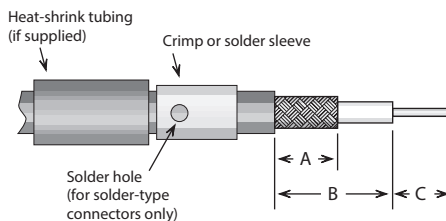

1) Trim cable per chart. Slide crimp (or solder) sleeve and heat-shrink tubing (if supplied) back onto cable.

2) Solder contact onto center conductor, fixturing to maintain gap as shown. Flare cut end of braid slightly by rotating dielectric.

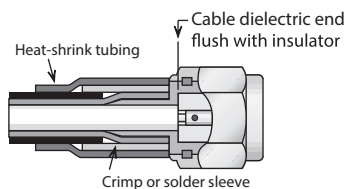

3) Insert cable/contact into rear of body, with all braid wires on outside of crimp tail. Push cable in until cable dielectric bottoms in connector. Trim excess braid wires even with shoulder of body. Slide crimp sleeve forward until flush with body and crimp (see page 211 for hex die sizes). (For solder-type connectors, solder braid to body and sleeve through hole in sleeve.) Slide heat-shrink tubing into place and shrink with hot-air gun.

Plug body assembly and contact shown; procedure is identical for jack connectors.

| Trim Codes |      |      |      |      |      |      |      |
|------------|------|------|------|------|------|------|------|
| Code       | A    | B    | C    | Code | A    | B    | C    |
| K/01       | .250 | .270 | .110 | K/07 | .220 | .290 | .135 |
| K/02       | .200 | .270 | .140 | K/08 | .420 | .620 | .090 |
| K/03       | .225 | .290 | .110 | K/09 | .090 | .135 | .160 |
| K/04       | .225 | .330 | .110 | K/10 | .250 | .415 | .115 |
| K/05       | .250 | .330 | .110 | K/11 | .250 | .400 | .150 |
| K/06       | .250 | .315 | .095 | K/12 | .282 | .390 | .140 |

## Assembly Procedure L

### Trim Codes

| Code | A    | B    | C    |
|------|------|------|------|
| L/01 | .250 | .438 | .109 |
| L/02 | .125 | .219 | .109 |
| L/03 | .234 | .344 | .109 |
| L/04 | .195 | .270 | .050 |
| L/05 | .095 | .155 | .050 |
| L/06 | .281 | .390 | .070 |

- 1) Trim cable per chart. Slide crimp (or solder) sleeve onto cable.

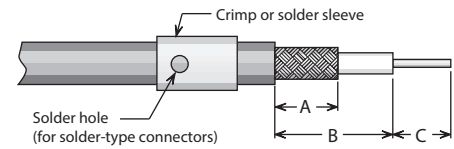

- 2) Insert cable into rear of body, with all braid wires on outside of crimp tail. Push cable in until end of braid touches connector body shoulder and center conductor rests in contact slot.

Slide crimp sleeve forward until flush with body and crimp (see page 211 for hex die sizes). (For solder-type connectors, solder braid to body and sleeve through hole in sleeve.)

Solder center conductor into contact slot, assemble insulator disc (if supplied), then press cap into body until seated or screw into place.

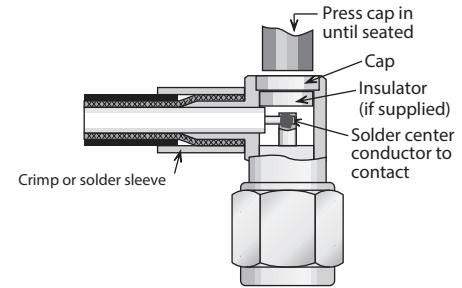

## Assembly Procedure M

### Cable Trim Codes

| Code | A    | B    | C    |
|------|------|------|------|
| M/01 | .281 | .390 | .140 |

- 1) Trim cable per chart. Slide crimp (or solder) sleeve and backnut onto cable.

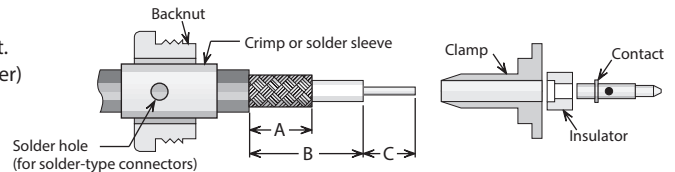

- 2) Flare cut end of braid slightly by rotating dielectric. Insert cable into rear of clamp, with all braid wires on outside of crimp tail. Slide insulator over cable dielectric until it is flush with front of clamp, and cable insulation bottoms inside insulator. Slide contact onto center conductor, with contact shoulder flush with front of insulator. Solder contact to center conductor.

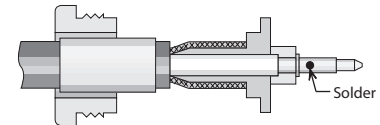

- 3) Slide crimp sleeve forward until flush with clamp shoulder; crimp as close to shoulder as possible. (see page 211 for hex die sizes). (For solder-type connectors, solder braid to body and sleeve through hole in sleeve.)

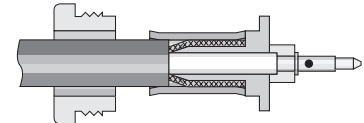

- 4) Insert prepared cable into back of body. Slide nut forward and tighten to 12–15 inch-pounds.

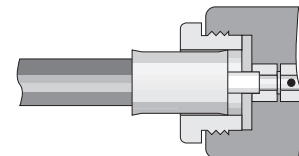

## Crimp Tools For Flexible Cable



Frame only—P/N M22520/5-01 —Use with interchangeable dies listed below.

| Cable Group* | Hex Die Size        | Die Set P/N | Closure |
|--------------|---------------------|-------------|---------|
| 2, 3, 4      | .429 hex, .400 wide | M22520/5-61 | A       |
| 5, 6         | .213 hex, .400 wide | M22520/5-19 | B       |
| 7            | .255 hex, .400 wide | M22520/5-19 | A       |
| 9            | .128 hex, .400 wide | M22520/5-35 | B       |
| 10           | .151 hex, .400 wide | M22520/5-37 | B       |
| 11           | .105 hex, .400 wide | M22520/5-33 | B       |

\* For Delta cable groups. See MIL-PRF-39012 specifications for dies sizes used with M39012 cable groups.



## Connector Flanges (Panel Mounted Connectors)

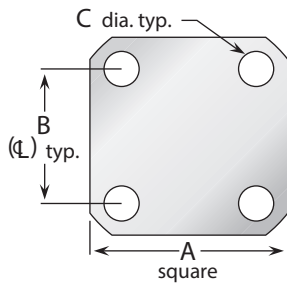

| 4-hole flanges |        |       |           |
|----------------|--------|-------|-----------|
| Figure         | A      | B     | C         |
| 04             | 1/2    | .360  | .089      |
| 05             | 1/2    | .340  | .102      |
| 07             | 11/16  | .500  | #3-56 tap |
| 08             | 11/16  | .500  | .136      |
| 09             | 11/16  | .500  | .125      |
| 10             | 11/16  | .500  | .120      |
| 12             | 11/16  | .500  | .109      |
| 18             | 3/4    | .531  | .136      |
| 26             | 1      | .718  | #6-32 tap |
| 27             | 1      | .718  | #4-40 tap |
| 30             | 1      | .718  | .166      |
| 32             | 1      | .718  | .136      |
| 32A            | 1      | .718  | .136*     |
| 33             | 1      | .718  | .125      |
| 34             | 1 3/32 | .812  | .150      |
| 36             | 1 3/16 | .906  | #6-32 tap |
| 39             | 1 3/16 | .906  | .152      |
| 40             | 1 3/16 | .906  | .125      |
| 45             | 2      | 1.437 | .257      |
| 91             | .375   | .250  | .067      |
| 91A            | .375   | .232  | .093      |

\* Countersunk to .245 dia.

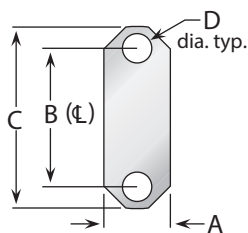

| 2-hole flanges |      |       |      |      |
|----------------|------|-------|------|------|
| Figure         | A    | B     | C    | D    |
| 92             | .223 | .481  | .625 | .102 |
| 92A            | .260 | .481  | .625 | .102 |
| 95             | .640 | 1.015 | 1.30 | .125 |

## Panel Cutouts (Bulkhead Mounted Connectors)

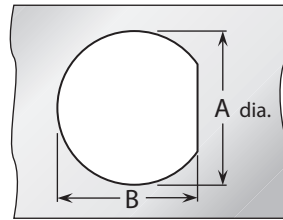

| D-Hole |      |      |
|--------|------|------|
| Figure | A    | B    |
| 51     | .755 | .723 |
| 54     | .630 | .598 |
| 55     | .630 | .583 |
| 57     | .557 | .531 |
| 59     | .505 | .473 |
| 62     | .442 | .410 |
| 63     | .407 | .362 |
| 65     | .380 | .348 |
| 66     | .319 | .292 |
| 67     | .255 | .236 |
| 68     | .195 | .176 |

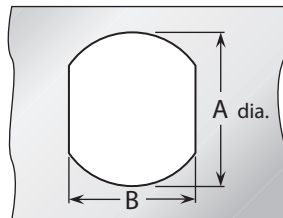

| Double D-Hole |      |      |
|---------------|------|------|
| Figure        | A    | B    |
| 69            | .755 | .692 |
| 72            | .630 | .536 |
| 75            | .380 | .341 |
| 84            | .319 | .278 |

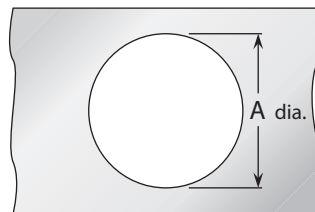

| Round Hole |      |
|------------|------|
| Figure     | A    |
| 82         | .255 |
| 89         | .380 |

## P.C. Board Drilling

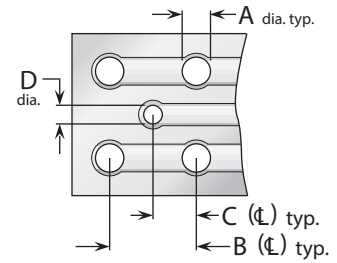

(PCB traces are shown for illustrative purpose only, and are not representative of actual circuitry.)

| Coaxial connectors |      |      |      |      |
|--------------------|------|------|------|------|
| Figure             | A    | B    | C    | D    |
| PCB01              | .067 | .400 | .200 | .045 |
| PCB02              | .045 | .500 | .250 | .045 |
| PCB03              | .067 | .300 | .150 | .035 |
| PCB05              | .067 | .200 | .100 | .055 |
| PCB06              | .067 | .200 | .100 | .045 |
| PCB07              | .045 | .177 | .088 | .045 |
| PCB08              | .032 | .100 | .050 | .032 |

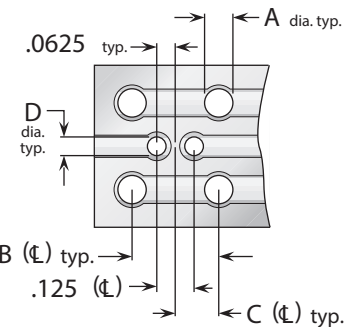

(PCB traces are shown for illustrative purpose only, and are not representative of actual circuitry.)

| Twinax Connectors |      |      |      |      |
|-------------------|------|------|------|------|
| Figure            | A    | B    | C    | D    |
| PCB04             | .045 | .500 | .250 | .045 |

## Delta Cable Groups

| Group | Cables   |
|-------|--|
| 1     | 1A RG-5, 5A, 5B, 21, 21A; M17/73, /162                       |
|       | 1B RG-6, 6A; M17/2   |
|       | 1C RG-143, 143A, 212, 222; M17/73, /112, /162                |
| 2     | 2A RG-8, 8A, 213; M17/74                                     |
|       | 2B RG-11, 11A; M17/6   |
| 3     | 3A RG-9, 9A, 9B, 214; M17/75                                 |
|       | 3B RG-13A, 216; M17/77                                       |
|       | 3C RG-225; M17/127   |
| 4     | RG-393; M17/127  |
| 5     | RG-58, 58A, 58C, 141, 141A; M17/28, /111                     |
| 6     | 6A RG-55A, 142, 142A, 223, 400; M17/60, /84, /128            |
|       | 6B RG-55, 55B, 142B; M17/60, /84                             |
| 7     | 7A RG-59, 59A, 59B, 62, 62A, 62B, 62C, 210; M17/29, /30, /97 |
|       | 7B RG-71, 71A, 71B; M17/90                                   |
| 8     | 8A RG-122; M17/54  |
|       | 8B RG-180, 180A, 180B, 195; M17/95, /137                     |
| 9     | 9A RG-174, 188, 188A, 316; M17/152                           |
|       | 9B RG-179A, 179B, 187, 187A; M17/94, /136                    |
| 10    | Double-Shielded RG-174, 316; M17/152                         |
| 11    | RG-178, 178A, 178B, 196, 196A; M17/93                        |
| 12    | .250" semi-rigid; RG-401; M17/129                            |
| 13    | .141" semi-rigid; RG-402; M17/130                            |
| 14    | .085" semi-rigid; RG-405; M17/133                            |
| 15    | RG-10, 12, 215; M17/6, /74                                   |
| 16    | RG-14A, 217; M17/78, /165                                    |
| 17    | RG-17A, 218  |
| 18    | RG-18A, 219  |
| 19    | RG-115A  |
| 20    | RG-118A, 228A  |
| 21    | RG-126   |
| 22    | RG-302   |
| 23    | RG-303   |
| 24    | RG-304   |
| 25    | Special 8X cable; contact factory for details.               |
| 26    | Belden 8281  |
| 27    | RG-108, 108A; M17/45   |
| 28    | RG-22, 22A, 22B; M17/15                                      |
| 29    | Belden 9207; Dearborn 6207; IBM 7362211                      |
| 30    | M17/176  |
| 31    | AT&T 735A  |

## Cable Group Finder

| Cable            | Group | Cable         | Group |
|------------------|-------|---------------|-------|
| RG-5, 5A, B      | 1A    | RG-225        | 3C    |
| RG-6, 6A         | 1B    | RG-228A       | 20    |
| RG-8, 8A         | 2A    | RG-302        | 22    |
| RG-9, 9A, B      | 3A    | RG-303        | 23    |
| RG-10            | 15    | RG-304        | 24    |
| RG-11, 11A       | 2B    | RG-316        | 9A    |
| RG-12            | 15    | RG-316DS      | 10    |
| RG-13A           | 3B    | RG-393        | 4     |
| RG-14A           | 16    | RG-400        | 6A    |
| RG-17A           | 17    | RG-401        | 12    |
| RG-18A           | 18    | RG-402        | 13    |
| RG-21, 21A       | 1A    | RG-405        | 14    |
| RG-22, 22A, B    | 28    | M17/2         | 1B    |
| RG-55, 55B       | 6B    | M17/6         | 2B    |
| RG-55A           | 6A    | M17/15        | 28    |
| RG-58, 58A, C    | 5     | M17/28        | 5     |
| RG-59, 59A, B    | 7A    | M17/29        | 7A    |
| RG-62, 62A, B, C | 7A    | M17/30        | 7A    |
| RG-71, 71A, B    | 7B    | M17/45        | 27    |
| RG-108, 108A     | 27    | M17/73        | 1A    |
| RG-115A          | 19    | M17/162       | 1A    |
| RG-118A          | 20    | M17/112       | 1C    |
| RG-122           | 8A    | M17/74        | 2A    |
| RG-126           | 21    | M17/75        | 3A    |
| RG-141, 141A     | 5     | M17/127       | 3C    |
| RG-142, 142A     | 6A    | M17/77        | 3B    |
| RG-142B          | 6B    | M17/60        | 6A    |
| RG-143, 143A     | 1C    | M18/84        | 6A    |
| RG-174           | 9A    | M17/128       | 6A    |
| RG-174DS         | 10    | M17/97        | 7A    |
| RG-178, 178A, B  | 11    | M17/54        | 8A    |
| RG-179A, 179B    | 9B    | M17/95        | 8B    |
| RG-180, 180A, B  | 8B    | M17/137       | 8B    |
| RG-187, 187A     | 9B    | M17/152       | 9A    |
| RG-188, 188A     | 9A    | M17/93        | 11    |
| RG-195           | 8B    | M17/129       | 12    |
| RG-196, 196A     | 11    | M17/130       | 13    |
| RG-210           | 7A    | M17/133       | 14    |
| RG-212           | 1C    | M17/78        | 16    |
| RG-213           | 2A    | M17/165       | 16    |
| RG-214           | 3A    | M17/176       | 30    |
| RG-215           | 15    | AT&T 735A     | 31    |
| RG-217           | 16    | Belden 8281   | 26    |
| RG-218           | 17    | Belden 9207   | 29    |
| RG-219           | 18    | Dearborn 6207 | 29    |
| RG-222           | 1C    | IBM 7362211   | 29    |
| RG-223           | 6A    |               |       |

Note: MIL-PRF-39012 QPL connectors have cable groups defined by the MIL specification, not the Delta cable groups shown here. See page 185 for M39012 cable groups.

## Warranty

We warrant our parts to be free of defects and workmanship for one year from purchase. During that time we will repair or replace (at our option) any parts found to be defective. The warranty does not apply to parts that have been modified, used in conditions exceeding Seller's, or military specifications, or disassembled. We will not, under any circumstances, be responsible for consequential or incidental damages or installation costs. No other warranties apply, and no other liability may be assumed or extended by representatives or distributors. The terms of the applicable warranty or warranties, as the case may be, as set forth herein are the sole and exclusive warranty terms that shall have any force or effect in the any product order, resulting from the quotation and such terms and in lieu of all other warranties, expressed or implied, including the implied warranties of merchantability and fitness for a particular purpose, which are hereby expressly excluded.



## Returns

Returns will be accepted only with a Return Authorization number issued by Delta, and are subject to inspection and acceptance upon arrival. Restocking charges will be determined prior to issuance of Return Authorization. All claims for shortages must be made within 30 days of receipt by customer.

## Ordering Information

Orders are subject to the terms and conditions on our order acknowledgement, which may only be modified by written agreement prior to sale. Order changes, cancellation, or termination will be accepted only with written approval from Delta Electronics Manufacturing.

## Copyright, Trademarks, & Patents

Entire contents copyright 2017, Delta Electronics Manufacturing Corporation. Reproduction rights are hereby granted for, and specifically limited to, printing or other reproduction of drawings and specifications for inclusion in specification or source control drawings, or purchasing procedures, by Delta customers only.

Heli-Grip<sup>®</sup>, PressMount<sup>®</sup>, and Global Manufacturer logo are trademarks. The Heli-Grip design is covered by U.S. and foreign patents

Delta Electronics Manufacturing Corporation  
416 Cabot Street, P.O. Box 53  
Beverly, MA 01915  
FSCM/CAGE 00795