

RF/Microwave Capacitors

RF/Microwave Multilayer Capacitors (MLC)

100B Series Porcelain Superchip® Multilayer Capacitors

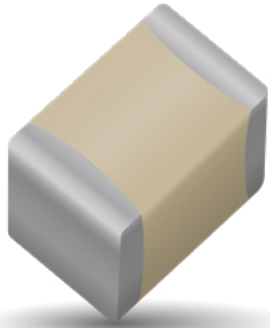

FEATURES

- Case B Size (.110" x .110")
- Capacitance Range 0.1pF to 1000pF
- Extended WVDC up to 1500 VDC
- Low ESR/ESL
- High Q
- Low Noise
- Ultra-Stable Performance
- High Self-Resonance
- Established Reliability (QPL)

GENERAL DESCRIPTION

KYOCERA AVX, the industry leader, offers new improved ESR/ESL performance for the 100 B Series RF/Microwave Capacitors. This Series is now available with extended operating temperatures up to 175°C. High Density porcelain construction provides a rugged, hermetic package.

FUNCTIONAL APPLICATIONS

- Bypass
- Coupling
- Tuning
- Impedance Matching
- DC Blocking

CIRCUIT APPLICATIONS

- UHF/Microwave RF Power Amplifiers
- Oscillators
- Low Noise Amplifiers
- Filter Networks
- Timing Circuits

ENVIRONMENTAL CHARACTERISTICS

Thermal Shock	Mil-STD-202, Method 107, Condition A
Moisture Resistance	Mil-STD-202, Method 106
Low Voltage Humidity	Mil-STD-202, Method 103, condition A, with 1.5 VDC applied while subjected to an environment of 85°C with 85% relative humidity for 240 hours
Life Test	MIL-STD-202, Method 108, for 2000 hours, at 125°C. Voltage applied. 200% of WVDC for capacitors rated at 500 volts DC or less. 120% of WVDC for capacitors rated at 1250 volts DC or less. 100% of WVDC for capacitors rated above 1250 volts DC
Termination Styles	Available in various surface mount and leaded styles. See Mechanical Configurations
Terminal Strength	Terminations for chips and pellets withstand a pull of 5 lbs. min., 15 lbs. typical, for 5 seconds in direction perpendicular to the termination surface of the capacitor.

PACKAGING OPTIONS



Tape & Reel



Vertical Orientation Tape & Reel



Cap Pac® (100 pcs)



ELECTRICAL SPECIFICATIONS

Temperature Coefficient (TCC)	+90 ±20 PPM/°C (-55°C to +125°C) +90 ±30 PPM/°C (+125°C to +175°C)
Capacitance Range	0.1pF to 1000pF
Operating Temperature	-55°C to +125°C*
Quality Factor	greater than 10,000 at 1 MHz
Insulation Resistance (IR)	0.1 pF to 470 pF: 10 ⁶ Megohms min. @ +25°C at rated WVDC. 10 ⁵ Megohms min. @ +125°C at rated WVDC. 510 pF to 1000 pF: 10 ⁵ Megohms min. @ +25°C at rated WVDC. 10 ⁴ Megohms min. @ +125°C at rated WVDC.
Working Voltage (WVDC)	See Capacitance Values table
Dielectric Withstanding Voltage (DWV)	250% of WVDC for capacitors rated at 500 volts DC or less for 5 seconds. 150% of WVDC for capacitors rated at 1250 volts DC or less for 5 seconds. 120% of WVDC for capacitors rated above 1250 Volts DC for 5 seconds
Aging Effects	None
Piezoelectric Effects	None
Capacitance Drift	± (0.02% or 0.02 pF), whichever is greater
Retrace	Less than ±(0.02% or 0.02 pF), whichever is greater.

RF/Microwave Capacitors

RF/Microwave Multilayer Capacitors (MLC)

100B Series Porcelain Superchip® Multilayer Capacitors



CAPACITANCE VALUES

Cap. Code	Cap. (pF)	Tol.	Rated WVDC		Cap. Code	Cap. (pF)	Tol.	Rated WVDC		Cap. Code	Cap. (pF)	Tol.	Rated WVDC		CAP. CODE	CAP. (pF)	TOL.	RATED WVDC																																					
			STD.	EXT.				STD.	EXT.				STD.	EXT.				STD.	EXT.	STD.	EXT.																																		
0R1	0.1	B	500	1500	2R4	2.4	B, C, D	500	1500	200	20	F, G, J, K, M	500	1500	151	150	F, G, J, K, M	300	EXT.																																				
0R2	0.2				2R7	2.7				220	22				161	160			1000																																				
0R3	0.3	3R0			3.0	240				24	181				180																																								
0R4	0.4	3R3			3.3	270				27	201				200																																								
0R5	0.5	B, C			500	1500				3R6	3.6				B, C, D	500		1500	300	30	F, G, J, K, M	500	1500	221	220	F, G, J, K, M	200	VOLT.																											
0R6	0.6									3R9	3.9								330	33				241	240																														
0R7	0.7	4R3								4.3	360								36	271				270	600																														
0R8	0.8	4R7								4.7	390								39	301				300																															
0R9	0.9	B, C, D								500	1500								5R1	5.1				B, C, J, K, M	500		1500	430	43	F, G, J, K, M	500	1500	331	330	F, G, J, K, M	200	600																		
1R0	1.0																		5R6	5.6								470	47				361	360																					
1R1	1.1	B, C, D	500	1500			6R2	6.2	B, C, J, K, M			500	1500	510			51		F, G, J, K, M	500								1500	391				390	F, G, J, K, M		200	VOLT.																		
1R2	1.2						6R8	6.8						560			56												431				430																						
1R3	1.3	B, C, D					500	1500						7R5			7.5												B, C, J, K, M				500			1500	620	62	F, G, J, K, M	500	1500	471	470	F, G, J, K, M	100	EXT.									
1R4	1.4													8R2			8.2																				680	68				511	510												
1R5	1.5	B, C, D			500	1500								9R1	9.1	B, C, J, K, M	500	1500			750	75	F, G, J, K, M			500											1500	561				560	F, G, J, K, M		100	EXT.									
1R6	1.6													100	10						820	82																621				620													
1R7	1.7	B, C, D												500	1500						110	11																B, C, J, K, M				500			1500	910	91	F, G, J, K, M	500	1500	681	680	F, G, J, K, M	300	EXT.
1R8	1.8																				120	12																								101	100				751	750			
1R9	1.9	B, C, D								500	1500										130	13		B, C, J, K, M	500		1500			111	110	F, G, J, K, M			500											1500	821				820	F, G, J, K, M		50	EXT.
2R0	2.0																				150	15								121	120																911				910				
2R1	2.1	B, C, D	500	1500					160			16	B, C, J, K, M						500	1500	131	130						F, G, J, K, M		500	1500			102													1000				F, G, J, K, M			50	VOLT.
2R2	2.2								180			18									102	1000												102													1000								

VRMS = 0.707 X WVDC

• SPECIAL VALUES, TOLERANCES, DIFFERENT WVDC AND MATCHING AVAILABLE. • ENCAPSULATION OPTION AVAILABLE. PLEASE CONSULT FACTORY. NOTE: EXTENDED WVDC DOES NOT APPLY TO CDR PRODUCTS.

HOW TO ORDER

Series 100 **Case Size** B **Capacitance** 910 **Termination Style Code** J **Voltage Rating** W **Rated WVDC** 500 **Laser Marking (Optional)** X **Packaging** T

See mechanical dimensions below

EIA Capacitance Code in pF.
First two digits = significant figures or "R" for decimal place.
Third digit = number of zeros or after "R" significant figures

Capacitance Tolerance Code

Code	B	C	D	F	G	J	K	M
Tol.	±1 pF	±25 pF	±5 pF	±1%	±2%	±5%	±10%	±20%

Packaging
T = Tape and Reel, 500 pc qty
TV = Vertical Tape and Reel, 500 pc qty
Please see last column of mechanical configuration table for other options.

Laser Marking (Optional)

Voltage Rating

Termination Style Code
Please see 2nd Column Mechanical Configuration Table

The above part number refers to a 100 B Series (case size B) 91 pF capacitor, J tolerance (±5%), 500 WVDC, with W termination (Tin /Lead, Solder Plated over Nickel Barrier), laser marking and Tape and Reel packaging.

RF/Microwave Capacitors

RF/Microwave Multilayer Capacitors (MLC)

100B Series Porcelain Superchip® Multilayer Capacitors



MECHANICAL CONFIGURATION

Series & Case Size	Term. Code	MIL-PRF-55681	Case Size & Type	Outline W/T is a Termination Surface	Body Dimensions inches (mm)			Lead and Termination Dimensions and Material			Pkg Type	Pkg Code			
					Length (L)	Width (W)	Thickness (T)	Overlap (Y)	Materials						
100B	W	CDR14BG	Solder Plate		.110+ .020 - .01 (2.79 + 0.51-0.25)	.110 ±.015 (2.79 ±0.38)	.102 (2.59) max.	.015 (0.38) ±.010 (0.25)	Tin / Lead, Solder Plated over Nickel Barrier Termination		T&R, 1000 or 500 pcs Vertical T&R, 1000 or 500 pcs Cap Pac, 100 pcs	T1K or T TV1K or TV C100			
100B	P	CDR14BG	Pellet		.110+ .035 - .01 (2.79 + 0.89-0.25)	.110 ±.015 (2.79 ±0.38)			Heavy Tin/Lead Coated, over Nickel Barrier Termination		T&R, 1000 or 500 pcs Vertical T&R, 1000 or 500 pcs Cap Pac, 100 pcs	T1K or T TV1K or TV C100			
100B	T	N/A	Solderable Nickel		.110+ .035 - .01 (2.79 + 0.51-0.25)	.110 ±.015 (2.79 ±0.38)			RoHS Compliant Tin Plated over Nickel Barrier Termination		T&R, 1000 or 500 pcs Vertical T&R, 1000 or 500 pcs Cap Pac, 100 pcs	T1K or T TV1K or TV C100			
100B	CA	CDR13BG	Gold Chip		.110+.020 - .010 (2.79 + 0.51-0.25)	.110 ±.015 (2.79 ±0.38)			RoHS Compliant Gold Plated over Nickel Barrier Termination		T&R, 1000 or 500 pcs Vertical T&R, 1000 or 500 pcs Cap Pac, 100 pcs	T1K or T TV1K or TV C100			
100B	MS	CDR21BG	Microstrip		.135 ±.015 (3.43 ±0.38)	.110 ±.015 (2.79 ±0.38)	.120 (3.05) max.	N/A	Length (L _L)	Width (W _L)	Thickness (T _L)	Cap Pac, 20 pcs	C20		
100B	AR	CDR22BG	Axial Ribbon				.250 (6.35) min.		.093±.005 (2.36 ±0.13)	.004 ± .001 (.102±.025)	Box, 20 or 100 pcs		B20 or B100		
100B	RR	CDR24BG	Radial Ribbon				.145 ±.020 (3.68 ±0.51)		.102 (2.59) max.	.500 (12.7)	#26 AWG, .016 (.406) dia. nominal		Box, 20 or 100 pcs		B20 or B100
100B	RW	CDR23BG	Radial Wire								Box, 20 or 100 pcs		B20 or B100		
100B	AW	CDR25BG	Axial Wire		Box, 20 or 100 pcs		B20 or B100								

Additional lead styles available: Narrow Microstrip (NM), Narrow Axial Ribbon (NA) and Vertical Narrow Microstrip (H). Other lead lengths are available; consult factory. All leads are high purity silver attached with high temperature solder and are **RoHS** compliant.

RF/Microwave Capacitors

RF/Microwave Multilayer Capacitors (MLC)

100B Series Porcelain Superchip® Multilayer Capacitors



NON-MAGNETIC MECHANICAL CONFIGURATION

Series & Case Size	Term. Code	MIL-PRF-55681	Case Size & Type	Outline W/T is a Termination Surface	Body Dimensions inches (mm)			Lead and Termination Dimensions and Material			Pkg Type	Pkg Code	
					Length (L)	Width (W)	Thickness (T)	Overlap (Y)	Materials				
100B	WN	Meets Requirements	Non-Mag		.110+ .020 - .01 (2.79 + 0.51-0.25)	.110 ±.015 (2.79 ±0.38)	.102 (2.59) max.	.015 (0.38) ±.010 (0.25)	Tin / Lead, Solder Plated over Nickel Barrier Termination		T&R, 1000 or 500 pcs Vertical T&R, 1000 or 500 pcs Cap Pac, 100 pcs	T1K or T TV1K or TV C100	
100B	PN	Meets Requirements	Solderable Nickel		.110+ .035 - .01 (2.79 + 0.51-0.25)	.110 ±.015 (2.79 ±0.38)			Heavy Tin / Lead, Coated over Non-Magnetic Barrier Termination		T&R, 1000 or 500 pcs Vertical T&R, 1000 or 500 pcs Cap Pac, 100 pcs	T1K or T TV1K or TV C100	
100B	TN	Meets Requirements	Non-Mag Solderable Barrier		.110+.020 - .010 (2.79 + 0.51-0.25)	.110 ±.015 (2.79 ±0.38)			RoHS Compliant Tin Plated over Non-Magnetic Barrier Termination		T&R, 1000 or 500 pcs Vertical T&R, 1000 or 500 pcs Cap Pac, 100 pcs	T1K or T TV1K or TV C100	
100B	MN	Meets Requirements	Microstrip		.135 ±.015 (3.43 ±0.38)	.110 ±.015 (2.79 ±0.38)	.120 (3.05) max.	N/A	Length (L _L)	Width (W _L)	Thickness (T _L)	Cap Pac, 20 pcs	C20
100B	AN	Meets Requirements	Axial Ribbon						.250 (6.35) (6.35) min.	.093±.005 (2.36 ±0.13)	.004 ± .001 (.102±.025)	Box, 20 or 100 pcs	B20 or B100
100B	FN	Meets Requirements	Radial Ribbon		.145 ±.020 (3.68 ±0.51)	.110 ±.015 (2.79 ±0.38)	.102 (2.59) max.	N/A	.500 (12.7)	#26 AWG., .016 (.406) dia. nominal	Box, 20 or 100 pcs	B20 or B100	
100B	RN	Meets Requirements	Radial Wire								Box, 20 or 100 pcs	B20 or B100	
100B	BN	Meets Requirements	Axial Wire								Box, 20 or 100 pcs	B20 or B100	

Additional lead styles available: Narrow Microstrip (NM), Narrow Axial Ribbon (NA) and Vertical Narrow Microstrip (H). Other lead lengths are available; consult factory. All leads are high purity silver attached with high temperature solder and are **RoHS** compliant.

SUGGESTED MOUNTING PAD DIMENSIONS

Horizontal
Electrode Orientation

Vertical
Electrode Orientation

Case B Vertical Mount

Cap Value	Pad Size	A Min.	B Min.	C Min.	D Min.
0.1 pF	Normal	.065	.050	.075	.175
	High Density	.045	.030	.075	.135
0.2 pF	Normal	.090	.050	.075	.175
	High Density	.070	.030	.075	.135
0.3 to 510 pF	Normal	.110	.050	.075	.175
	High Density	.090	.030	.075	.135
> 510 pF	Normal	.120	.050	.075	.175
	High Density	.100	.030	.075	.135

Horizontal Mount

All Values	Pad Size	A Min.	B Min.	C Min.	D Min.
All Values	Normal	.130	.050	.075	.175
	High Density	.110	.030	.075	.135

PERFORMANCE DATA

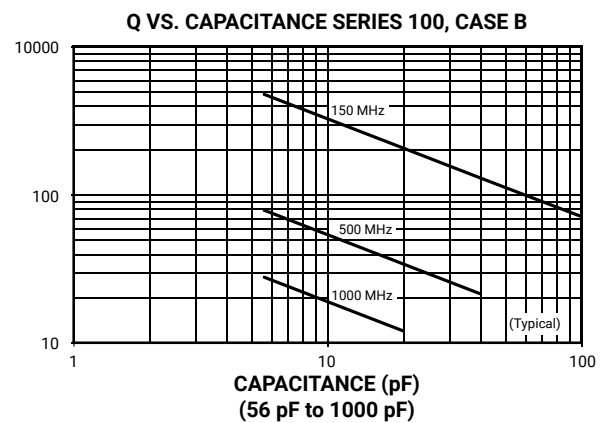
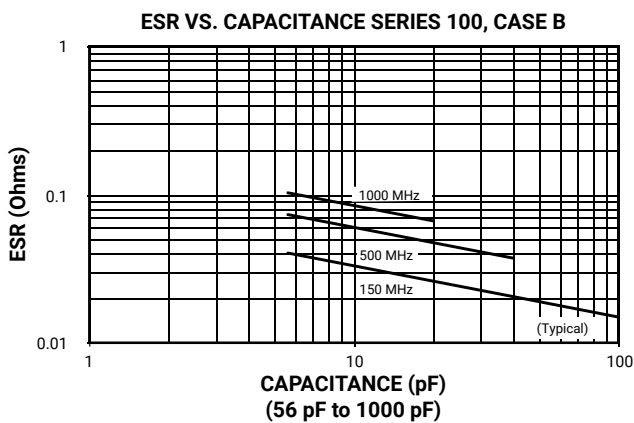
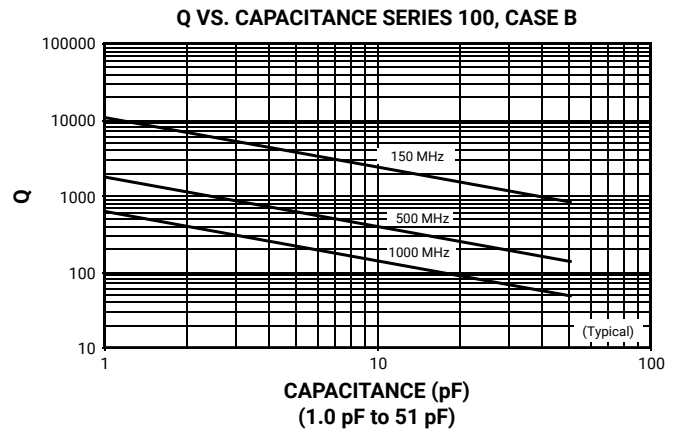

RF/Microwave Capacitors

RF/Microwave Multilayer Capacitors (MLC)

100B Series Porcelain Superchip® Multilayer Capacitors



PERFORMANCE DATA

SERIES RESONANCE VS. CAPACITANCE
SERIES 100, CASE B



CAPACITANCE CHANGE VS. TEMPERATURE
SERIES 100, CASE B



CURRENT RATING VS. CAPACITANCE
SERIES 100, CASE B

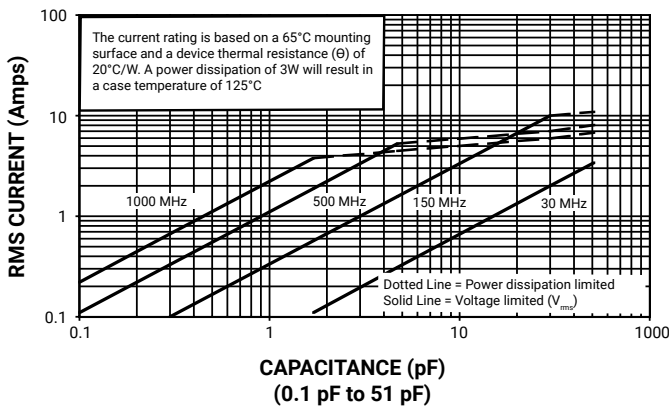

CURRENT RATING VS. CAPACITANCE
SERIES 100, CASE B

