

THIS DRAWING IS UNPUBLISHED.		RELEASED FOR PUBLICATION	
© COPYRIGHT - By -		ALL RIGHTS RESERVED.	
HOUSING CAP COUPLING NUT	STAINLESS STEEL PER ASTM-A484 AND ASTM- A582, TYPE 303	PASSIVATE PER QQ-P-35	
DIELECTRIC	TFE FLUOROCARBON PER ASTM-D-1457	N/A	
CENTER CONTACT	BRASS PER ASTM-B-16 HALF HARD	GOLD PLATE PER MIL-G-45204	
RETAINING RING	BERYLLIUM COPPER PER ASTM-B-194, ALLOY C17200, CONDITION H	N/A	
GASKET	SILICONE RUBBER PER ZZ-R-765	N/A	
FERRULE	COPPER OR BRASS ALLOY ROCKWELL F65 MAXIMUM	GOLD PLATE PER MIL-G-45204	
COMPONENT	MATERIAL	FINISH	

LOC	DIST	REVISIONS					
-	-	P	LTR	DESCRIPTION	DATE	DWN	APVD
		C		REV PER ECO-12-018918	15NOV12	PY	DW

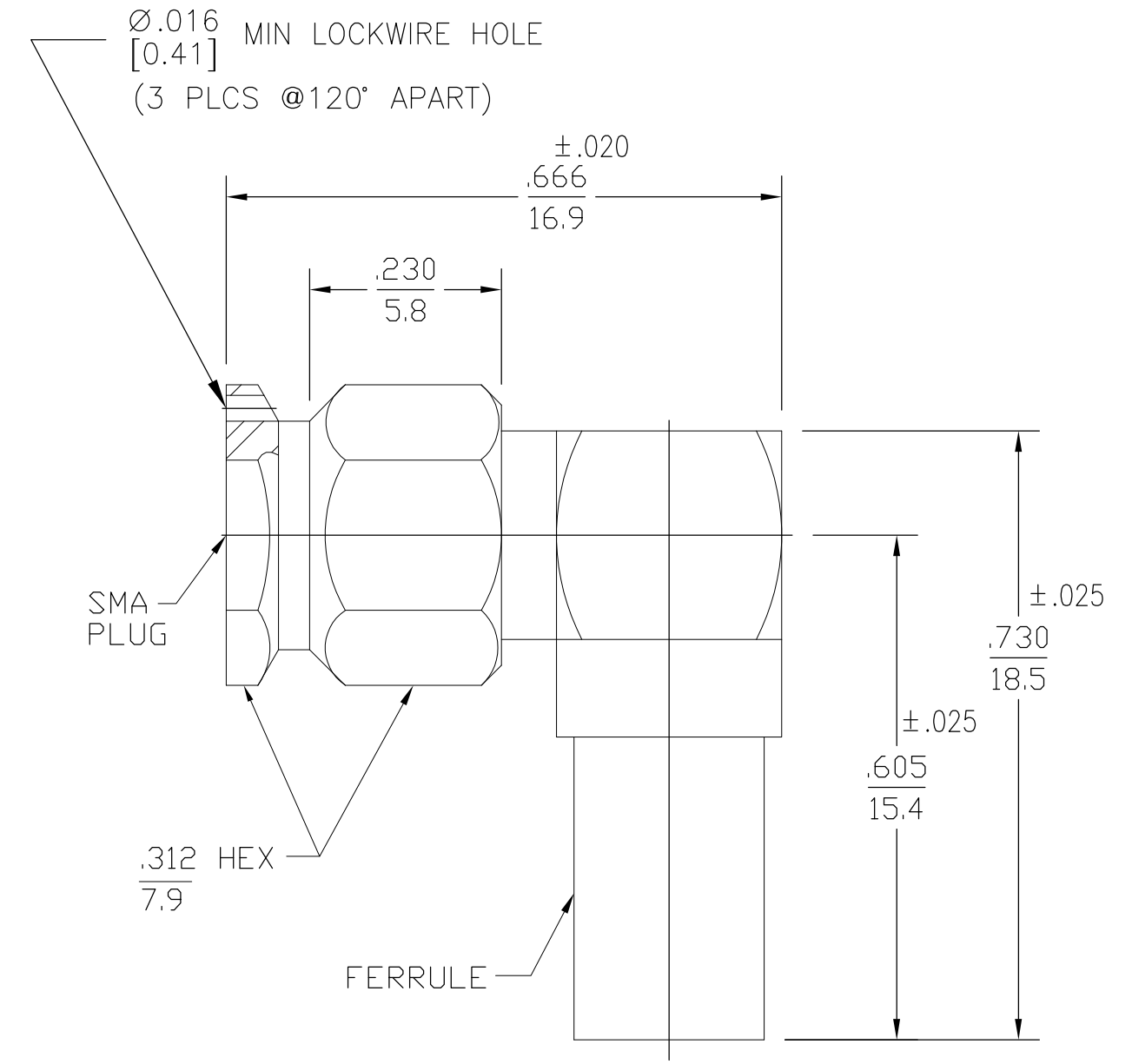

1. CAPTURED CENTER CONTACT

1052157-1
PART NO.

DESIGNED FOR USE WITH RG-174, 316/U	
CABLE ENTRY DIAMETER MINIMUM	
SLEEVE	.125
HOUSING	.066
CONTACT	.041 SLOT

THIS DRAWING IS A CONTROLLED DOCUMENT.	
DIMENSIONS: INCHES	TOLERANCES UNLESS OTHERWISE SPECIFIED:
	0 PLC ± -
	1 PLC ± -
	2 PLC ± -
	3 PLC ± .005 [0.13]
	4 PLC ± -
	ANGLES ± 1°
MATERIAL SEE TABLE	FINISH SEE TABLE

DWN P. YEAGER 05JUN2007	TE Connectivity
CHK D. WILSON 07JUN07	
APVD D. WILSON 07JUN07	
NAME SMA RIGHT ANGLE CABLE PLUG SOLDER ATTACHMENT M39012/56-3012 CAT B	
PRODUCT SPEC	RESTRICTED TO
APPLICATION SPEC	SIZE A3
WEIGHT -	CAGE CODE 00779
CUSTOMER DRAWING	DRAWING NO C-1052157
SCALE 5:1	SHEET 1 OF 1
REV C	