

THIS DRAWING IS UNPUBLISHED. RELEASED FOR PUBLICATION
 © COPYRIGHT BY TYCO ELECTRONICS CORPORATION. ALL INTERNATIONAL RIGHTS RESERVED.

LOC		DIST		REVISIONS			
P	LTR	DESCRIPTION	DATE	DWN	APVD		
B		REV PER ECO 09-014236	8-5-09	CT	DW		

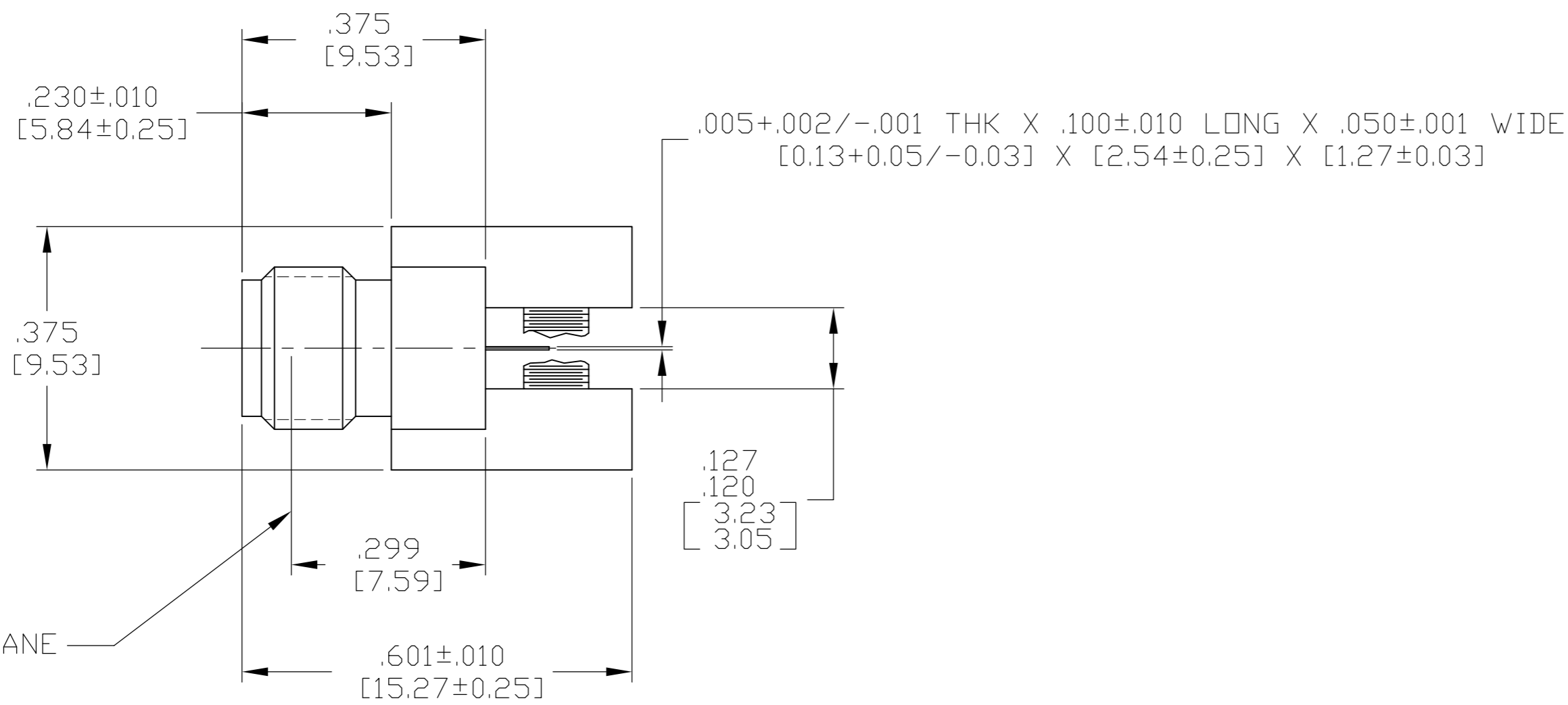
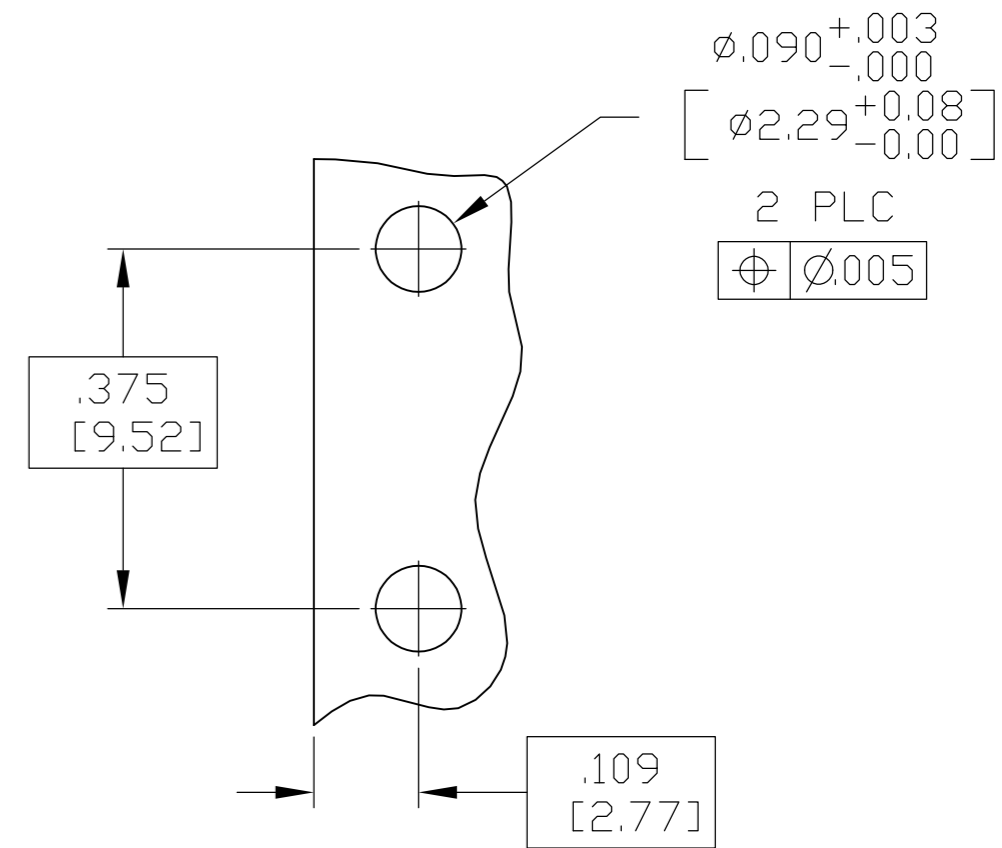
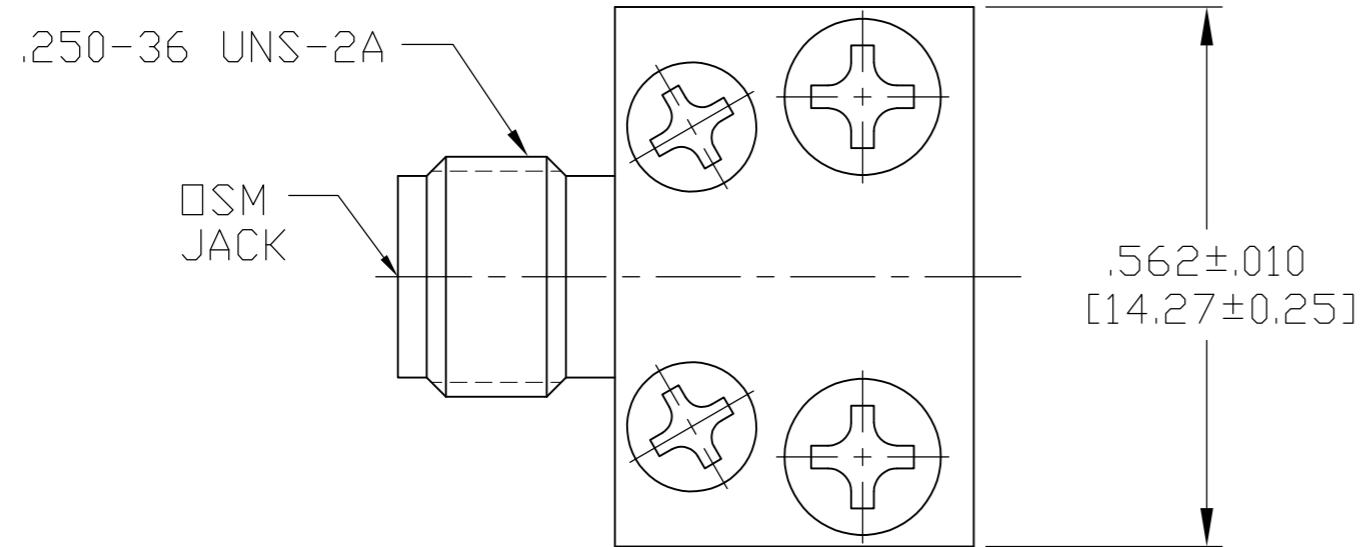

1. DESIGNED FOR USE WITH 1/8" THICK STRIPLINE

HOUSING BASE PLATES	STAINLESS STEEL PER ASTM-A484 AND ASTM- A582, TYPE 303	PASSIVATED PER SAE-AMS-2700
DIELECTRIC	TFE FLUOROCARBON PER ASTM-D-1457	N/A
CENTER CONTACT	BERYLLIUM COPPER PER ASTM-B-196 OR ASTM-B-197, ALLOY C17300, CONDITION H	GOLD PLATE PER MIL-G-45204 OVER COPPER PER AMS-2418
MACHINE SCREWS	CORROSION RESISTANT STEEL PER QQ-S-763	PASSIVATED PER SAE-AMS-2700
COMPONENT	MATERIAL	FINISH

J M83517/09-31002	1053478-1
MILITARY NUMBER	PART NO.

THIS DRAWING IS A CONTROLLED DOCUMENT.		DWN C.C.THOMAS 8-5-09	Tyco Electronics Corporation Harrisburg, PA 17105-3608	
DIMENSIONS: INCHES		CHK D.WILSON 8-5-09	NAME SMA STRIPLINE END LAUNCH JACK-TAB TERMINAL	
TOLERANCES UNLESS OTHERWISE SPECIFIED:		APVD D.WILSON 8-5-09	PRODUCT SPEC	
0 PLC ± -		APPLICATION SPEC		
1 PLC ± -		-		
2 PLC ± -		-		
3 PLC ± .005		-		
4 PLC ± -		-		
ANGLES ± -		-		
MATERIAL SEE TABLE	FINISH SEE TABLE	WEIGHT -	SIZE A2	CAGE CODE 00779
CUSTOMER DRAWING		DRAWING NO 1053478-1	RESTRICTED TO -	SCALE 5:1
		SHEET 1 of 1	REV B	