

1064-2

REVISIONS
CHANGES

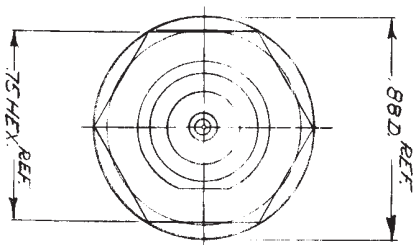
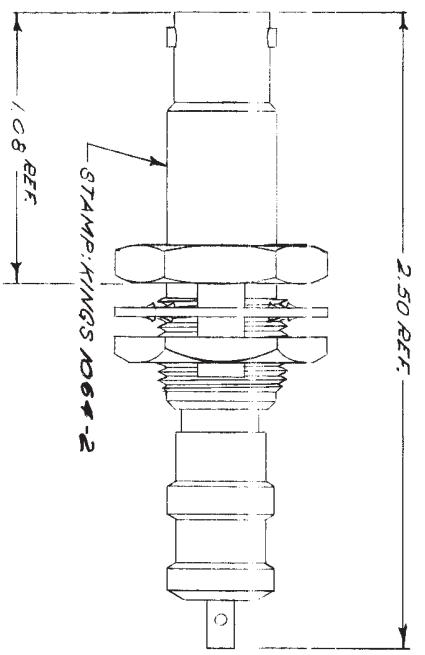
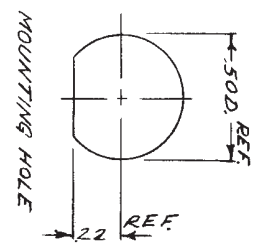

NOTES:
1. MUST WITHSTAND 15KV DC FOR ONE MINUTE AT 8,500 FT.

- UNLESS OTHERWISE SPECIFIED:
1. TOLERANCES:
FRACTIONS ± .010 DECIMALS ± .004 ANGLES ± 0° 30'
 2. REMOVE ALL BURRS, BREAK SHARP EDGES .005 MAX.
 3. NO FILLETS PERMITTED.
 4. SURFACE ROUGHNESS 63 MICRONS RMS MAX.
 5. ALL DIMENSIONS PRIOR TO PLATING.
- T. I. R. CONCENTRICITY OF ANY 2 DIAMETERS MAY NOT EXCEED THE SUM OF THEIR TOLERANCES.

DIETZEN 1984 Approval Traceur Vallum 8515

ITEM	REQ'D	DESCRIPTION	DRAWING NO.

REF:	
FINISH	
SPEC.	
MATL.	
SPEC.	
DRAWN	A.M.E.
DATE	3 DEC 1968
APPR.	
DATE	
KINGS ELECTRONICS 40 MARBLEDALE ROAD TUCKAHOE, N. Y. 10707	
1064-2	

S-D