

# GSD

123-23-9

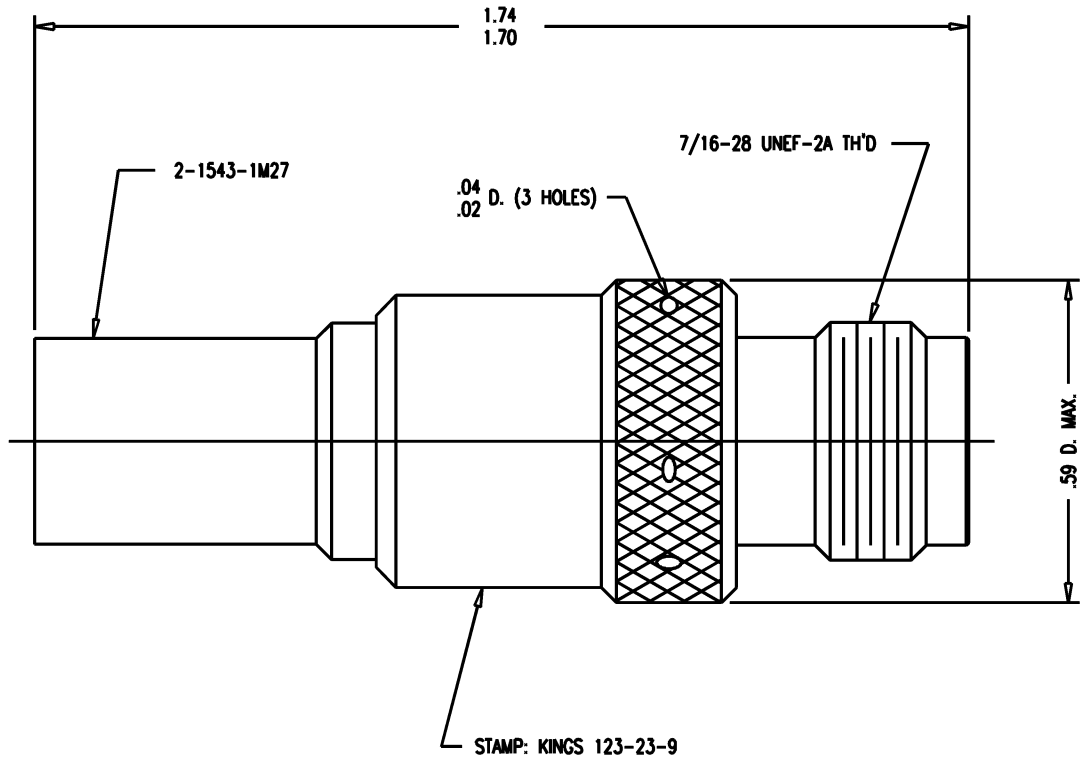

- NOTES:
- FOR USE WITH BOEING S280W503-4 & ADAMS RUSSELL FC28Z CABLE.
  - FOR CABLING INSTRUCTIONS SEE 3-546-2.
  - FOR CRIMPING USE DIE KTH-2212.
  - CENTER CONTACT (1-2288-4MA9) SUPPLIED UNASSEMBLED.
  - INTERFACE PER MIL-STD-348, FIG. 313-2.
  - MARK PACKAGE: KINGS 121-23-9  
XXXX (DATE CODE)
  - MATERIALS:  
CENTER CONTACT-BER. COP., ASTM-B-196  
K-GRIP SLEEVE-COMMERCIAL BRONZE, ASTM-B-135  
INSULATOR-TEFLON, ASTM-D-4894  
ALL OTHER METAL PARTS-BRASS, ASTM-B16
  - FINISHES:  
CENTER CONTACT-GOLD PLATE PER MIL-G-45204  
ALL OTHER METAL PARTS-KINGS TARNISH RESISTANT FINISH (TR-5)
  - ELECTRIAL CHARACTERISTICS:  
NOMINAL IMPEDANCE-50 OHMS  
FREQUENCY RANGE-DC TO 11 GHZ  
WORKING VOLTAGE-500 VRMS

REVISIONS

ISSUE	CHANGES
1	ADD LOCK WIRE HOLES KH 04/26/94
2	ER 35796 KH 09/26/94

KAM3581

SCALE 4:1	
APPROX SURFACE AREA	
USED ON	
REF: BOEING	
JACK, PANEL, TNC	
DRAWN KH	DATE 03/15/94
DESIGN JT	DATE 03/16/94
APPR.	DATE

**KINGS**  
ELECTRONICS CO., INC.  
TUCKAHOE, NEW YORK 10707

123-23-9

# GSD