

125-95-7

REVISIONS	
ISSUE	CHANGES
0	ER 37068 AR 07/18/96
1	CN 38710 C DCT 6/23/3
2	CN 39587 A DCT 8/22/6
D	REVISED PER ER25008 GGR 06/15/2010
E	REVISED PER DMF304 & ER39972 KPL 1/12/12

CUSTOMER SALES DRAWING

THIS DRAWING, THE DESIGNS AND IDEAS EMBODIED IN THE DEVICE TO WHICH IT RELATES, AND THE METHOD OF PRODUCING THE DEVICE, ARE THE PROPERTY OF WINCHESTER ELECTRONICS CORPORATION AND SHALL NOT BE EMPLOYED, COPIED, OR DISCLOSED TO ANYONE, IN ANY MANNER WITHOUT THE CONSENT OF WINCHESTER ELECTRONICS CORPORATION.

SCALE 4:1

APPROX SURFACE AREA

CAGE CODE: 91836

REF:

PLUG, TNC

DRAWN AR	DATE 07/18/96
DESIGN AR	DATE 07/18/96
APPR.	DATE



125-95-7

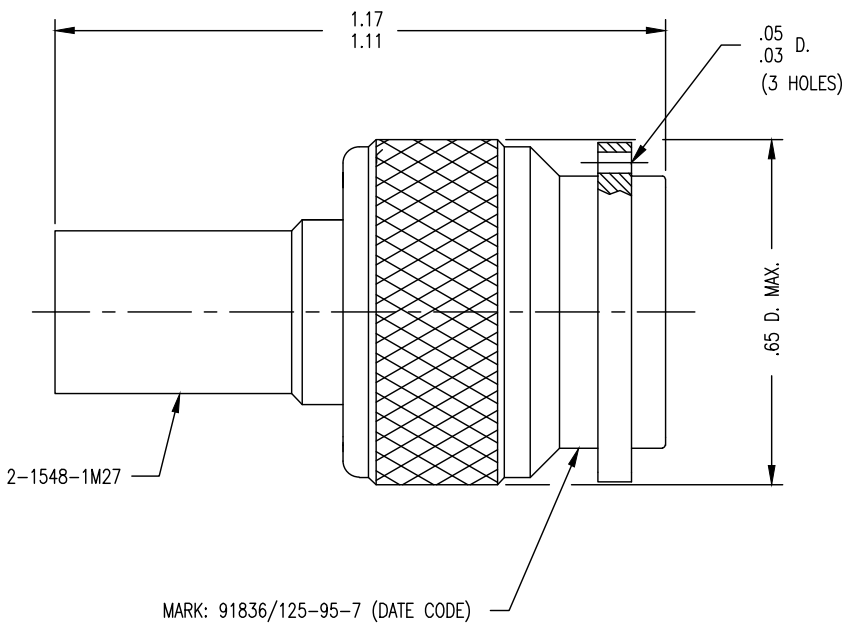

NOTES:

1. FOR USE WITH BOEING BMS 13-65 TYPE OG
2. FOR CABLING INSTRUCTIONS SEE 3-546-1.
3. FOR CRIMPING USE DIE KTH-2216.
4. INTERFACE PER MIL-STD-348, FIG. 313-1.
5. CENTER CONTACT (1-569-35MA9) SUPPLIED UNASSEMBLED.
6. MARK PACKAGE: HS5938-1 (DATE CODE)
125-95-7 (DATE CODE)
91836 (DATE CODE)
7. MATERIALS:
INSULATOR: TEFLON, ASTM D1710
K-GRIP SLEEVE: COM. BRONZE ASTM B135
OUTER CONTACT: BER. COPPER, ASTM B196
GASKET: SILICONE RUBBER, A-A-59588
C-RING: PHOSPHOR BRONZE, ASTM B103
ALL OTHER METAL PARTS: BRASS, ASTM B16

8. FINISHES:

- CENTER CONTACT: .000050 MIN GOLD PLATE, PER ASTM B488 OVER
.000050 MIN. NICKEL PER AMS-QQ-N-290 (RoHS)
ALL OTHER METAL PARTS: .000050 MIN NICKEL PER AMS-QQ-N-290
OVER .000050 MIN COPPER PER ASTM B734 (RoHS)

9. ELECTRICAL CHARACTERISTICS:

- NOMINAL IMPEDANCE: 50 OHMS
WORKING VOLTAGE: 500 VRMS
FREQUENCY RANGE: DC TO 11 GHZ.
VSWR: 1.30 MAX, .5-11 GHZ
INSERTION LOSS: .18 dB MAX AT 9 GHZ.

10. WEIGHT: 15.9 GRAMS