

SERPAC 1324AA (exploded isometric)

Electronic Enclosures

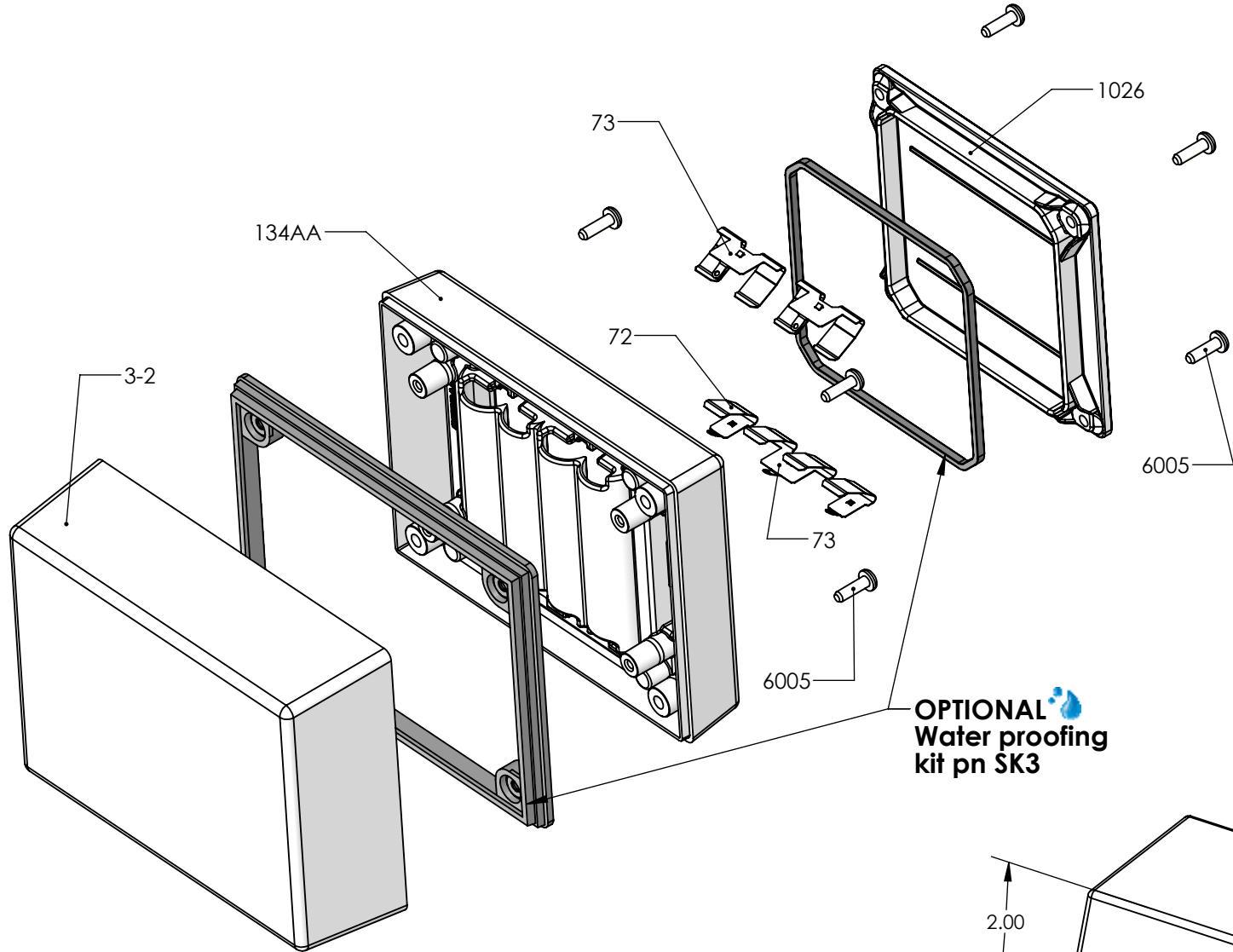

OPTIONAL
Water proofing
kit pn SK3

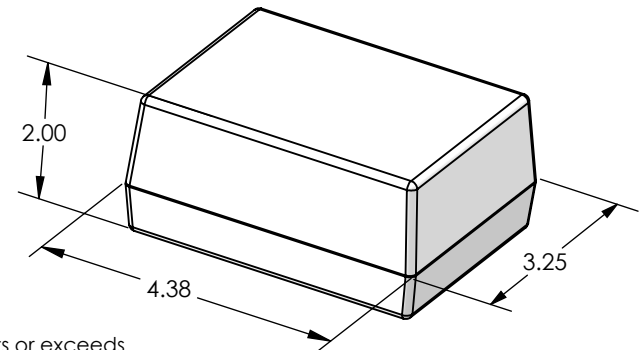

PART NO.	DESCRIPTION (Included)	ACCESSORIES (Optional)
3-2	Top	PART NO. DESCRIPTION
134AA	4AA Bottom	50 Non-skid Feet
1026	Access Door	SK3 Seal Kit for 13X
6005	#4X3/8" Self-Tapping Screw (8)	
73	Double Battery Contact (3)	
72	Single Battery Contact (2)	

- Notes: Enclosure weight .29 lb / 133 g
- 1) Enclosure meets or exceeds IP40 and NEMA 1
 - 2) When used with PS13 and ACO1 the enclosure meets or exceeds IP 67 and NEMA 4X, 12 and 13 MIL-STD-810G 506.5 (.02 lb / 10 g)
 - 3) Circuit Board drawings can be download at:
<https://serpac.com/accessories/circuit-boards.aspx>
 - 4) All components are RoHS Compliant.

SERPAC 1324AA

Electronic Enclosures

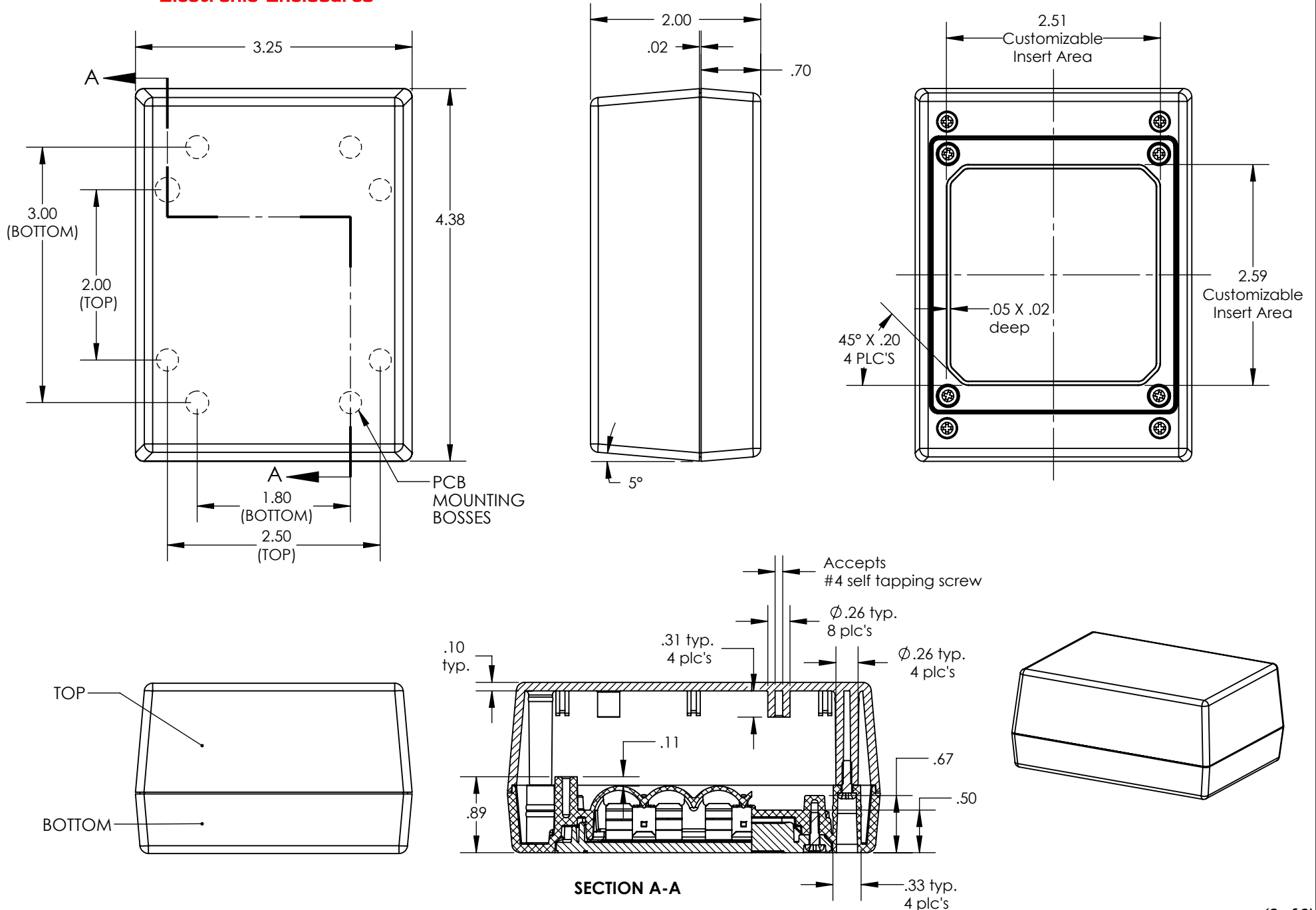

ALL DIMENSIONS ARE $\pm .010"$ 9/18/2020 (2 of 3)
2009 Wright Ave. La Verne, CA 91750
Ph. (626) 331-0517 Fx. (626) 331-8584 www.serpac.com