

SERPAC 132RAC (exploded isometric)

Electronic Enclosures

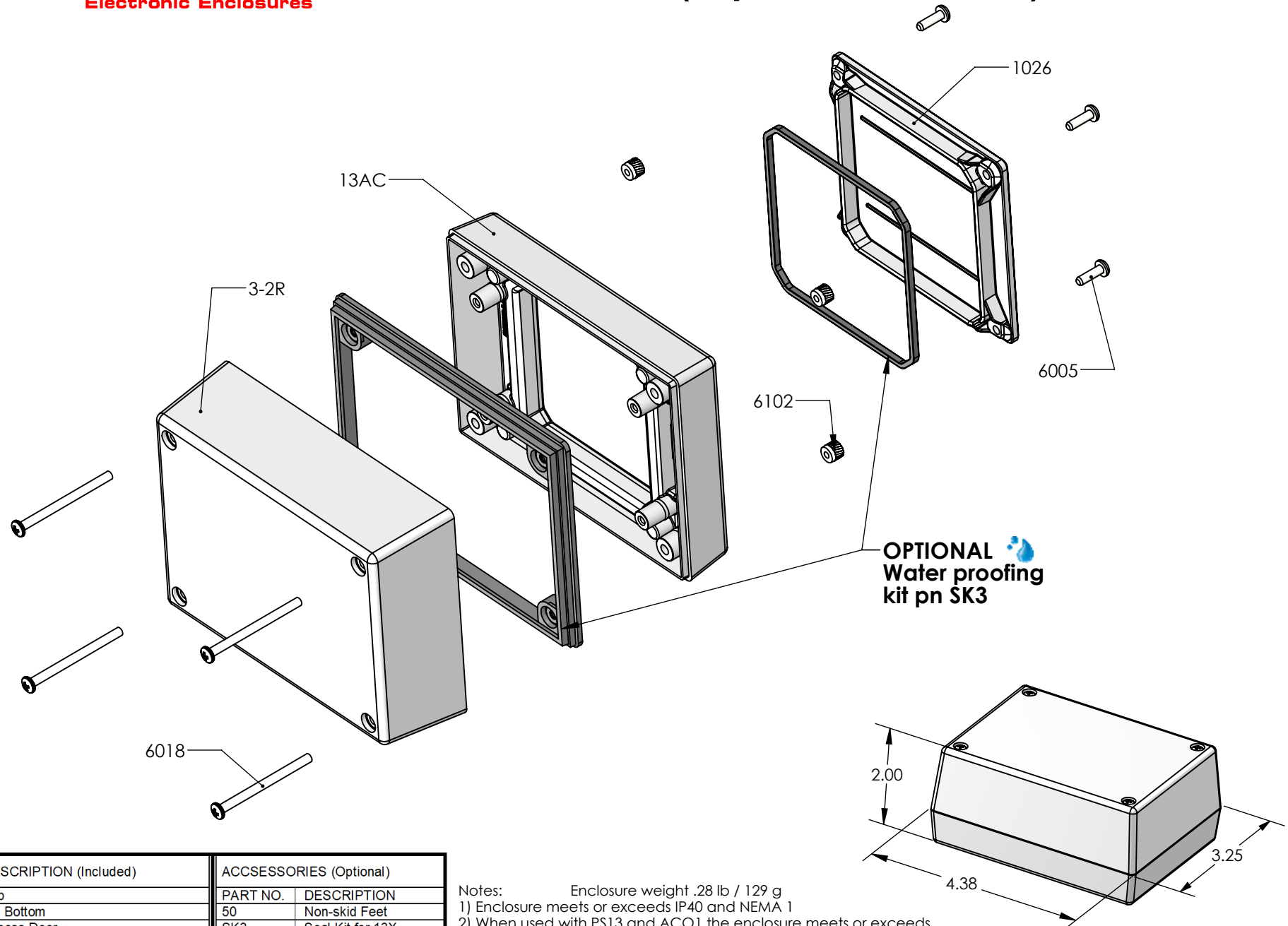

OPTIONAL
Water proofing
kit pn SK3

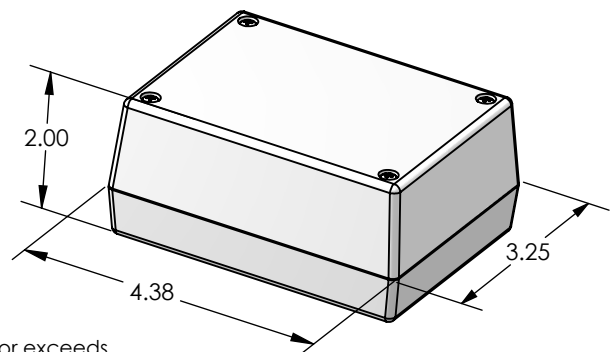

PART NO.	DESCRIPTION (Included)	ACCESSORIES (Optional)	
3-2R	Top	PART NO.	DESCRIPTION
13AC	AC Bottom	50	Non-skid Feet
1026	Access Door	SK3	Seal Kit for 13X
6005	#4X3/8" Self-Tapping Screw (4)		
6018	4-40 Screw (4)		
6102	4-40 Threaded Insert (4)		

Notes: Enclosure weight .28 lb / 129 g
 1) Enclosure meets or exceeds IP40 and NEMA 1
 2) When used with PS13 and ACO1 the enclosure meets or exceeds IP 67 and NEMA 4X, 12 and 13 MIL-STD-810G 506.5 (.02 lb / 10 g)
 3) Circuit Board drawings can be download at:
<https://serpac.com/accessories/circuit-boards.aspx>
 4) All components are RoHS Compliant.

SERPAC 132RAC

Electronic Enclosures

