

SERPAC 133R4AA (exploded isometric)

Electronic Enclosures

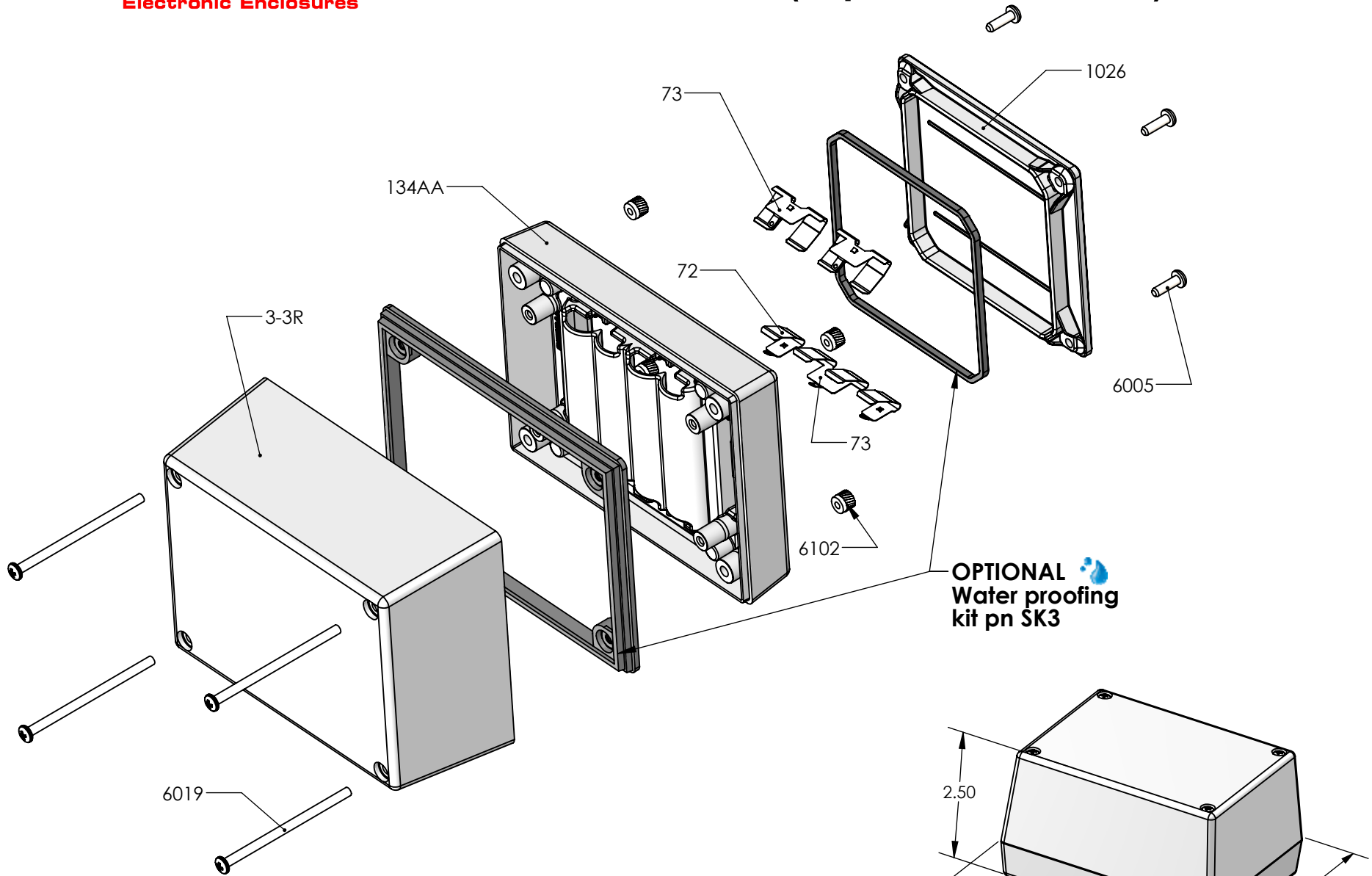

OPTIONAL
Water proofing
kit pn SK3

PART NO.	DESCRIPTION (Included)	ACCESSORIES (Optional)
3-3R	Top	PART NO. DESCRIPTION
134AA	4AA Bottom	50 Non-skid Feet
1026	Access Door	SK3 Seal Kit for 13X
6005	#4X3/8" Self-Tapping Screw (4)	
6019	4-40 Screw (4)	
6102	4-40 Threaded Insert (4)	
73	Double Battery Contact (3)	
72	Single Battery Contact (2)	

Notes: Enclosure weight .33 lb / 149 g
 1) Enclosure meets or exceeds IP40 and NEMA 1
 2) When used with PS13 and ACO1 the enclosure meets or exceeds IP 67 and NEMA 4X, 12 and 13 MIL-STD-810G 506.5
 3) Circuit Board drawings can be download at:
<https://serpac.com/accessories/circuit-boards.aspx>
 4) All components are RoHS Compliant.

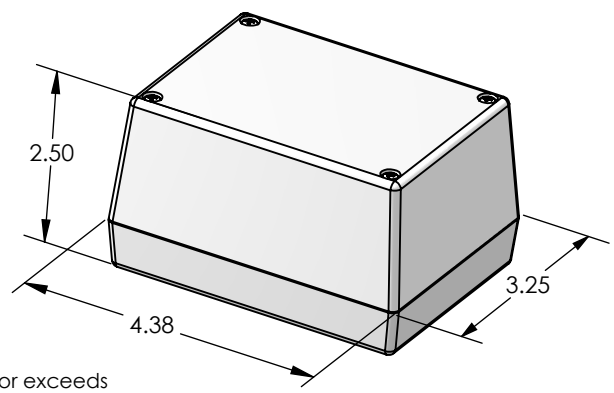

ALL DIMENSIONS ARE ± .010" 9/18/2020 (1 of 3)
 2009 Wright Ave. La Verne, CA 91750
 Ph. (626) 331-0517 Fx. (626) 331-8584 serpac.com

SERPAC 133R4AA

Electronic Enclosures

