

THIS DRAWING IS UNPUBLISHED. RELEASED FOR PUBLICATION
 © COPYRIGHT BY TYCO ELECTRONICS CORPORATION. ALL INTERNATIONAL RIGHTS RESERVED.

LOC		DIST		REVISIONS			
P	LTR	DESCRIPTION	DATE	DWN	APVD		
C		REV PER ECO 08-024900	10-20-08	CT	KT		

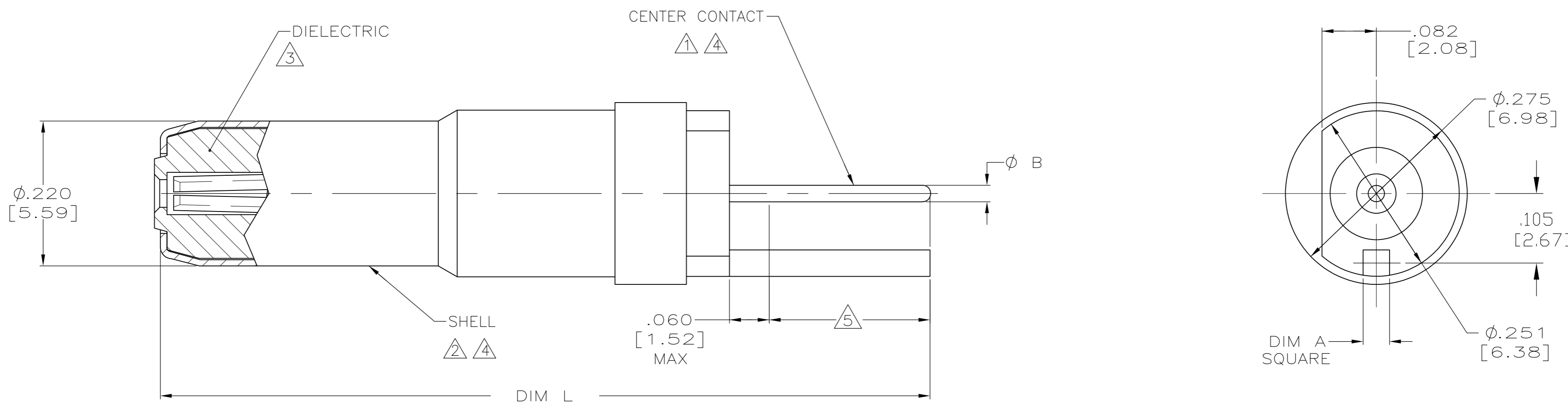

- 1 BERYLLIUM COPPER PER ASTM-B-197 OR ASTM-B-643.
- 2 BRASS PER ASTM-B-16.
- 3 PTFE PER ASTM-D-1710.
- 4 GOLD PLATE PER ASTM-B-488 (MIL-G-45204), TYPE 2, GRADE C, .000050 [0.00127] MIN THK OVER NICKEL PLATE PER QQ-N-290, .000050 [0.00127] MIN THK.
- 5 THIS AREA IS SOLDER DIPPED. (-4 ONLY)

$.020 \pm .002$ [0.51 ± 0.05]	$.040 \pm .003$ [1.02 ± 0.08]	NO	1.205 [30.61]	1484201-5
$.026$ [0.66] MAX	$.047$ [1.19] MAX	YES	1.277 [32.44]	1484201-4
$.020 \pm .002$ [0.51 ± 0.05]	$.040 \pm .003$ [1.02 ± 0.08]	NO	1.277 [32.44]	1484201-3
$.020 \pm .002$ [0.51 ± 0.05]	$.040 \pm .003$ [1.02 ± 0.08]	NO	1.249 [31.72]	1484201-2
$.020 \pm .002$ [0.51 ± 0.05]	$.040 \pm .003$ [1.02 ± 0.08]	NO	1.158 [29.41]	1484201-1
DIM B	DIM A	SOLDER DIPPED	L ± .020 [± 0.51]	PART NUMBER

THIS DRAWING IS A CONTROLLED DOCUMENT.

DIMENSIONS: INCHES [mm]	TOLERANCES UNLESS OTHERWISE SPECIFIED:	DWN C.C.THOMAS 1-10-02	Tyco Electronics Corporation Harrisburg, PA 17105-3608
	0 PLC ± - 1 PLC ± - 2 PLC ± - 3 PLC ± .005 [0.13] 4 PLC ± - ANGLES ± -	CHK S.GLATFELTER 1-10-02	
MATERIAL SEE CALLOUTS	FINISH SEE CALLOUTS	APVD S.GLATFELTER 1-10-02	NAME PIN CONTACT ASSY, COAX, SIZE 5 POSTED, ARINC 600
		PRODUCT SPEC	SIZE A2
		APPLICATION SPEC	CAGE CODE 00779
		WEIGHT -	DRAWING NO C=1484201
		CUSTOMER DRAWING	RESTRICTED TO -
			SCALE 8:1 SHEET 1 of 1 REV C