

SYMBOL DEFINITION		MISSING NUMBERS		DWG STATUS		REVISION HISTORY		AUTH	
DATE	STG	REV	CHG	N/P	ZONE	DATE	STG	REV	CHG
130C99	R	C4				196791	JHN	JVM	
120E00	R	C5				205206	JOS	JOS	
20MR01	R	C6				208002	BRB	BRB	GD
13JN01	R	C7				210696	RH	RH	GD
28FE02	R	CB				221921	TLD	TLD	GD

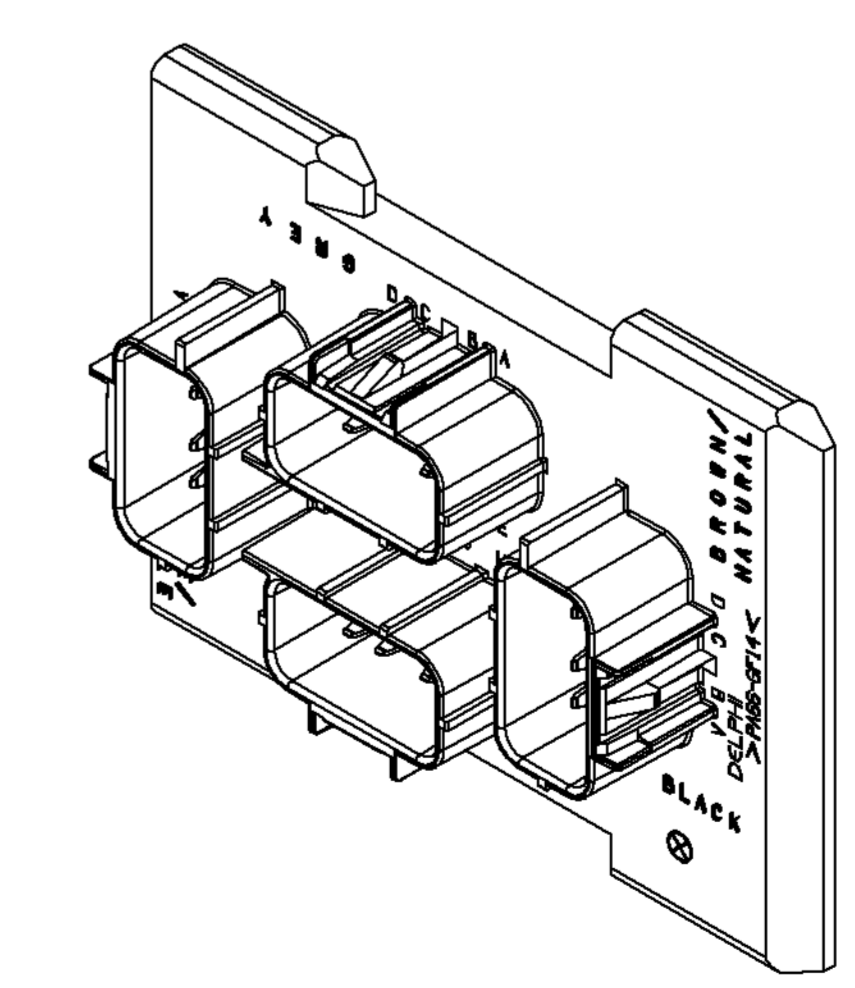
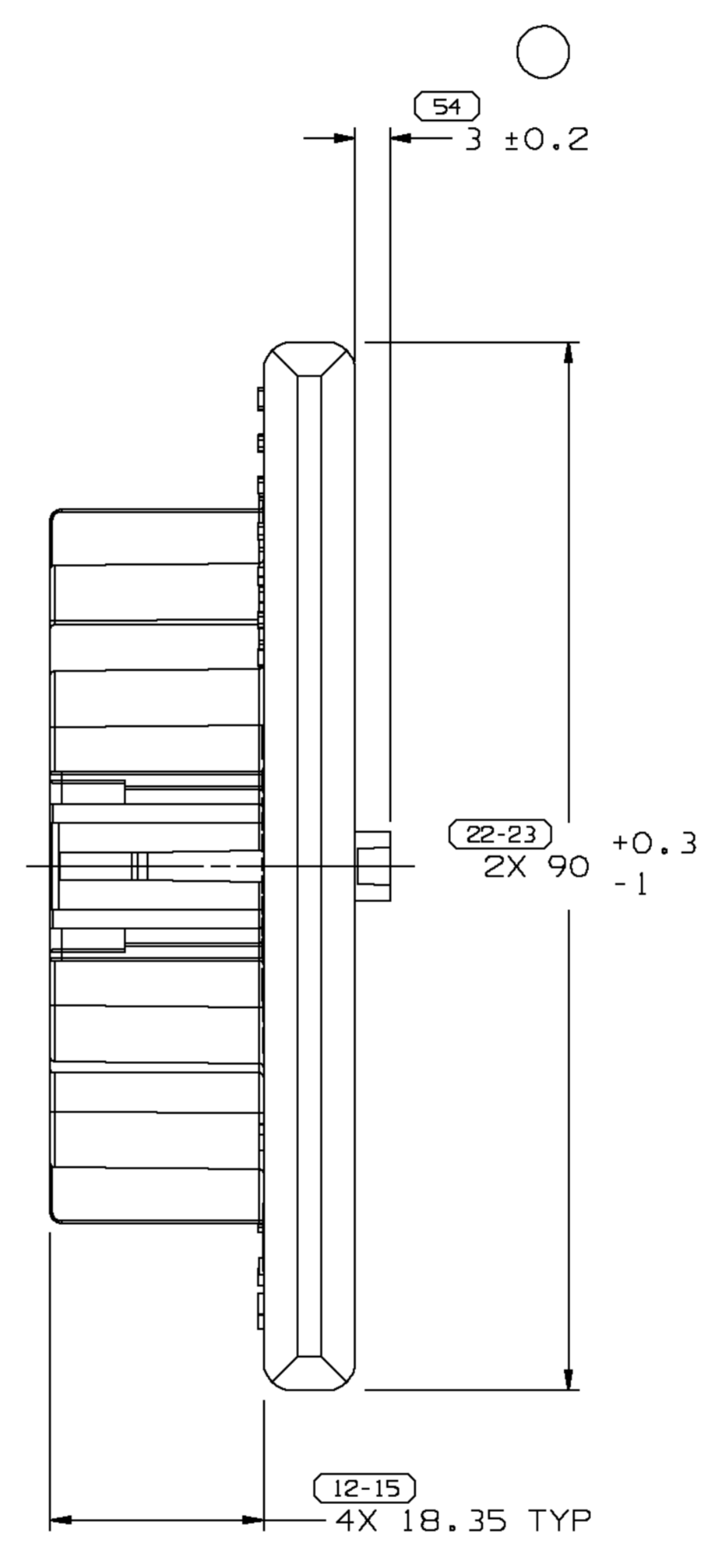
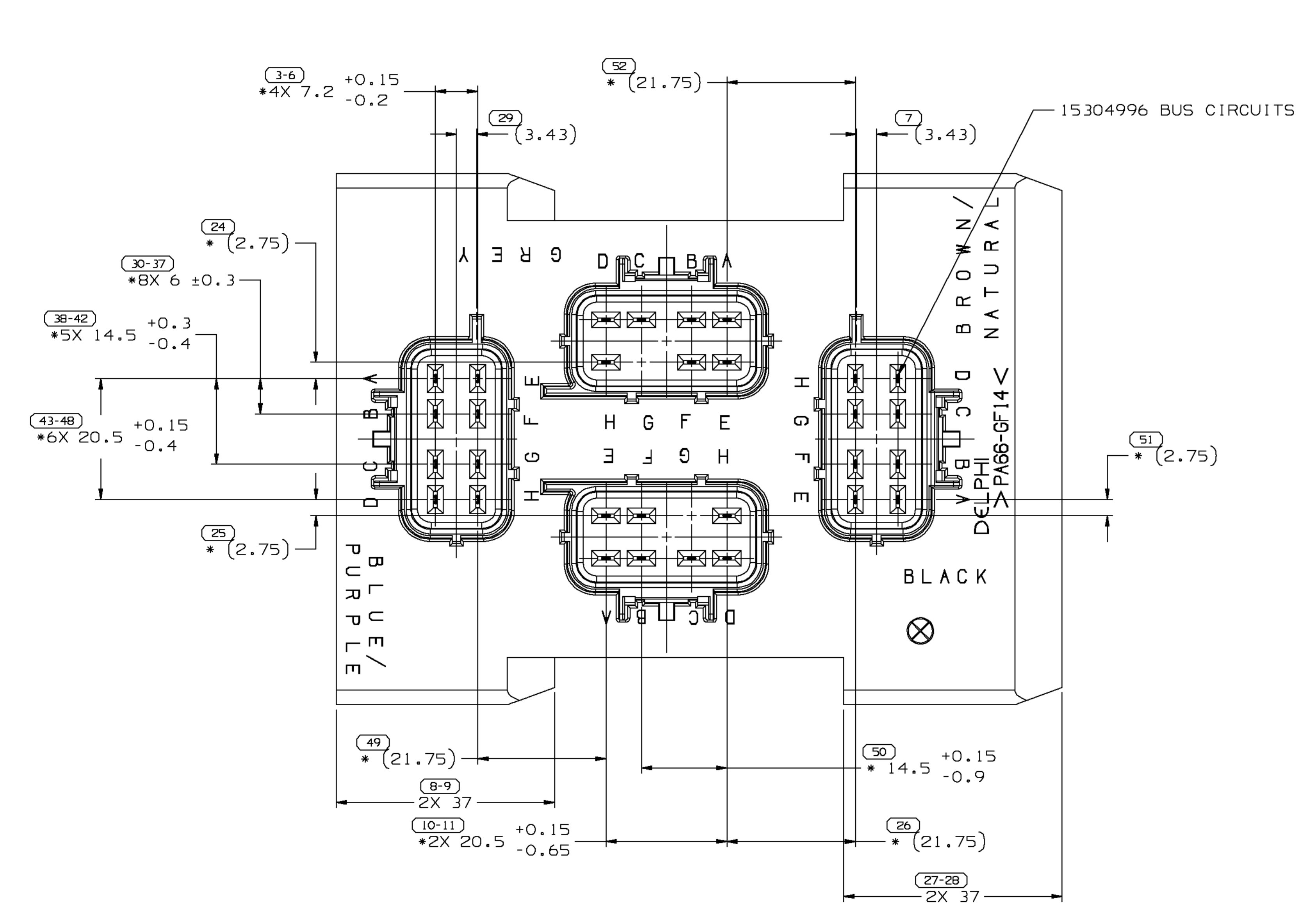
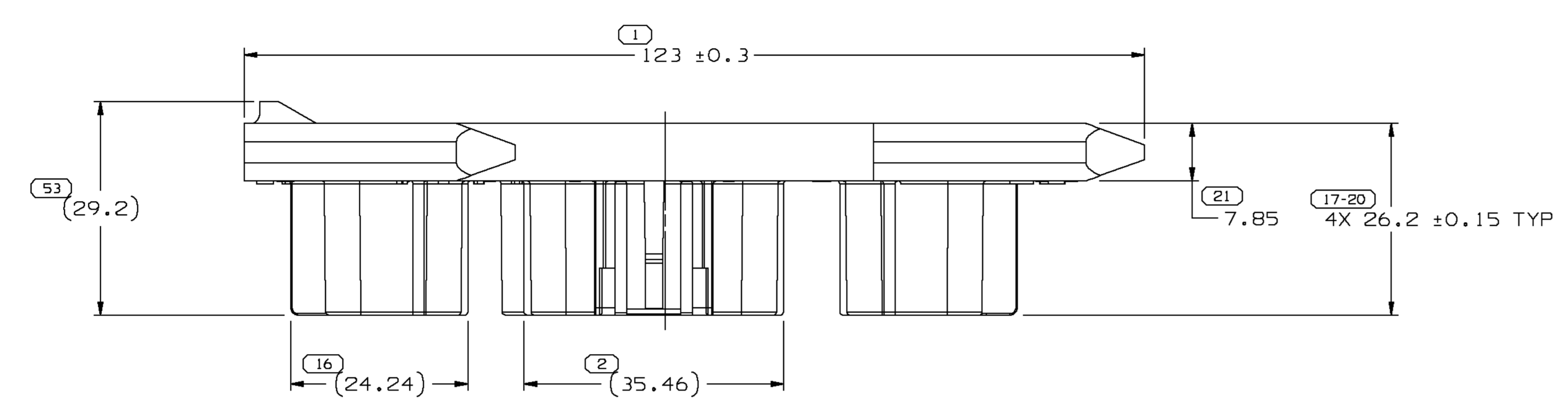

- NOTES
- UNLESS OTHERWISE SPECIFIED AND/OR INDICATED: DIMENSIONS ARE TO FACE OF VIEW SHOWN AND AUTOMATICALLY ROUNDED BY COMPUTER FOR INSPECTION. (SEE MATH MODEL FOR PRECISE DIMENSIONS.) FOR ALL OTHER DIMENSIONS NOT SHOWN BUT REQUIRED FOR TOOL BUILD, SEE MATH MODEL FOR PRECISE TOOL PATH DATA.
  - THIS PART IS NOT CONTROLLED FOR AUTOMATIC FEEDING.
  - MATING COMPONENTS OR EQUIVALENT: CONNECTOR 15317304, 15317305, 15317306 AND 15317308 CPA 15317629
  - THIS PART USES STAMPED CIRCUIT 15304996 (1-7 PLCS)
  - ALL PARTS MUST BE ELECTRICALLY FUNCTIONAL. THIS INCLUDES ELECTRICAL TESTS FOR OPEN CIRCUITS, SHORTS, AND 500 VOLT DC HI-POT CIRCUIT ISOLATION.
  - ALL PARTS ARE TO BE PACKAGED SUCH THAT BREAKAGE DOES NOT OCCUR, AND THAT THE GENERAL MOTORS PACKAGING AND IDENTIFICATION REQUIREMENTS FOR PRODUCTION PARTS, SPECIFICATION GM-1738, ARE FOLLOWED.
  - COMPONENT TO BE MOLDED SUCH THAT CONNECTIONS AND BODY MEET SEALING REQUIREMENTS OF ESA-710.
  - \* ALL TERMINAL CENTERLINE MEASUREMENTS ARE TO BE MEASURED FROM BASE OF TERMINAL

<b>DELPHI</b> Automotive Systems		MATERIAL SPEC R00715B1 PA66 GF14 HS IM-GR4 DK	
SUBSTANCES OF CONCERN AND RECYCLED CONTENT PER DELPHI-A 10949001		DISTR CODE D	
PART DRAWING			
CODE NUMBER 6900	DWG DATE 180C96	SCALE 2:1	D
OC SPEC	STYLE	VOLUME cm³ 73.437	
PART GEOMETRY VIRTUAL ASM		UNLESS OTHERWISE SPECIFIED: THIS DOCUMENT IS IN ACCORDANCE WITH ASME Y14.5M - 1994 AS AMENDED BY THE GM GLOBAL DIMENSIONING AND TOLERANCING ADDENDUM - 1997. ALL GEOMETRIC TOLERANCES AND RELATED DATUMS APPLY RFS. RULE #1 (PERFECT FORM AT MMC) DOES NOT APPLY WHEN RELATIONSHIP BETWEEN FEATURES IS ESTABLISHED BY ORIENTATION OR LOCATION TOLERANCES. SEPARATE POSITION CALLOUTS MAY BE GAGED SEPARATELY REGARDLESS OF DATUM REFERENCES.	
COPY OF MATH DATA DO NOT SCALE		REFERENCE	DATE
METRIC UNLESS OTHERWISE SPECIFIED, ALL DIMENSIONS ARE IN MILLIMETERS		APVD1 E. MONCISVAIS	180C96
THIRD ANGLE PROJECTION		APVD2 ENRIQUE BAEZ	280C96
DRAWING NAME HD CONN 32M GT 280 BUS CONNECTION IML		APVD3 G. DETTER	18N096
SHEET NUMBER 1 OF 1		APVD4	
DRAWING NUMBER 15304995		APVD5	
DWG STATUS R CB		SIZE A0	

DIMENSIONAL RANGE (MM)		CHART E1	
FROM	TO	FROM	TO
0	> 20	> 20	> 300
> 20	> 30	> 30	> 400
> 30	> 40	> 40	> 500
> 40	> 50	> 50	> 600
> 50	> 60	> 60	> 700
> 60	> 70	> 70	> 800
> 70	> 80	> 80	> 900
> 80	> 90	> 90	> 1000
> 90	> 100	> 100	> 1100
> 100	> 110	> 110	> 1200
> 110	> 120	> 120	> 1300
> 120	> 130	> 130	> 1400
> 130	> 140	> 140	> 1500
> 140	> 150	> 150	> 1600
> 150	> 160	> 160	> 1700
> 160	> 170	> 170	> 1800
> 170	> 180	> 180	> 1900
> 180	> 190	> 190	> 2000
> 190	> 200	> 200	> 2100
> 200	> 210	> 210	> 2200
> 210	> 220	> 220	> 2300
> 220	> 230	> 230	> 2400
> 230	> 240	> 240	> 2500
> 240	> 250	> 250	> 2600
> 250	> 260	> 260	> 2700
> 260	> 270	> 270	> 2800
> 270	> 280	> 280	> 2900
> 280	> 290	> 290	> 3000
> 290	> 300	> 300	> 3100
> 300	> 310	> 310	> 3200
> 310	> 320	> 320	> 3300
> 320	> 330	> 330	> 3400
> 330	> 340	> 340	> 3500
> 340	> 350	> 350	> 3600
> 350	> 360	> 360	> 3700
> 360	> 370	> 370	> 3800
> 370	> 380	> 380	> 3900
> 380	> 390	> 390	> 4000
> 390	> 400	> 400	> 4100
> 400	> 410	> 410	> 4200
> 410	> 420	> 420	> 4300
> 420	> 430	> 430	> 4400
> 430	> 440	> 440	> 4500
> 440	> 450	> 450	> 4600
> 450	> 460	> 460	> 4700
> 460	> 470	> 470	> 4800
> 470	> 480	> 480	> 4900
> 480	> 490	> 490	> 5000
> 490	> 500	> 500	> 5100
> 500	> 510	> 510	> 5200
> 510	> 520	> 520	> 5300
> 520	> 530	> 530	> 5400
> 530	> 540	> 540	> 5500
> 540	> 550	> 550	> 5600
> 550	> 560	> 560	> 5700
> 560	> 570	> 570	> 5800
> 570	> 580	> 580	> 5900
> 580	> 590	> 590	> 6000
> 590	> 600	> 600	> 6100
> 600	> 610	> 610	> 6200
> 610	> 620	> 620	> 6300
> 620	> 630	> 630	> 6400
> 630	> 640	> 640	> 6500
> 640	> 650	> 650	> 6600
> 650	> 660	> 660	> 6700
> 660	> 670	> 670	> 6800
> 670	> 680	> 680	> 6900
> 680	> 690	> 690	> 7000
> 690	> 700	> 700	> 7100
> 700	> 710	> 710	> 7200
> 710	> 720	> 720	> 7300
> 720	> 730	> 730	> 7400
> 730	> 740	> 740	> 7500
> 740	> 750	> 750	> 7600
> 750	> 760	> 760	> 7700
> 760	> 770	> 770	> 7800
> 770	> 780	> 780	> 7900
> 780	> 790	> 790	> 8000
> 790	> 800	> 800	> 8100
> 800	> 810	> 810	> 8200
> 810	> 820	> 820	> 8300
> 820	> 830	> 830	> 8400
> 830	> 840	> 840	> 8500
> 840	> 850	> 850	> 8600
> 850	> 860	> 860	> 8700
> 860	> 870	> 870	> 8800
> 870	> 880	> 880	> 8900
> 880	> 890	> 890	> 9000
> 890	> 900	> 900	> 9100
> 900	> 910	> 910	> 9200
> 910	> 920	> 920	> 9300
> 920	> 930	> 930	> 9400
> 930	> 940	> 940	> 9500
> 940	> 950	> 950	> 9600
> 950	> 960	> 960	> 9700
> 960	> 970	> 970	> 9800
> 970	> 980	> 980	> 9900
> 980	> 990	> 990	> 10000

DELPHI PACKARD ELECTRIC SYSTEMS  
WARREN, OHIO 44486