

THIS AREA MUST BE FLAT TO WITHIN 1.30 MM TOTAL AND FREE FROM SURFACE DEFECTS AT LEAST 15.0 MM ALL AROUND. NOTE, THIS HOLDS TRUE FOR STRAIGHT PUNCHED HOLE ALSO

THIS AREA TO BE FREE FROM BURRS ALL AROUND

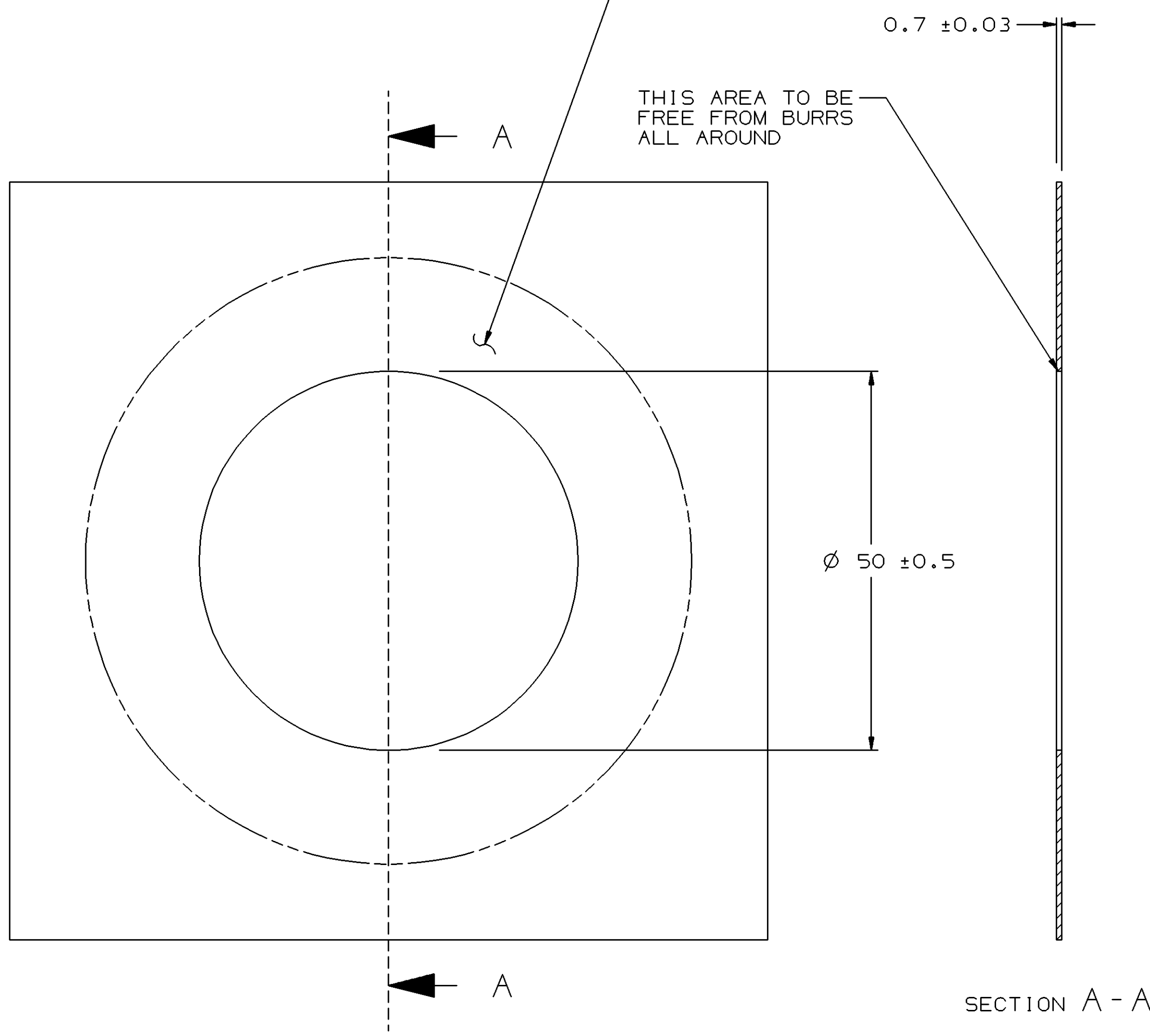

SECTION A - A

REF SHEET METAL VIEWS

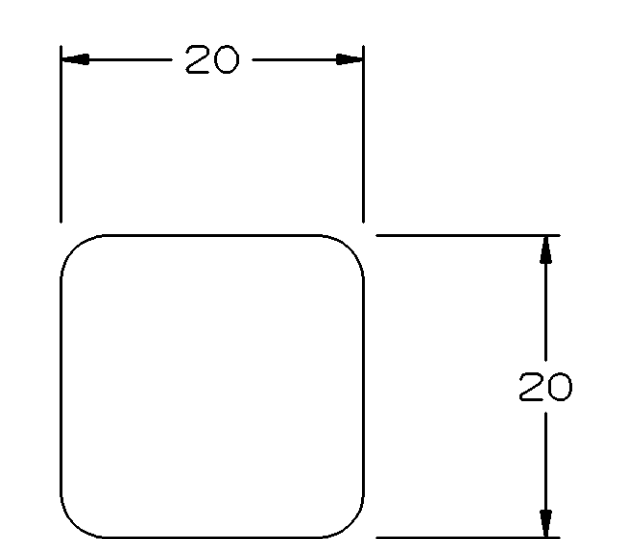

MAXIMUM ALLOWABLE DIMENSION OF STRECHED GROMMET NECK WHEN USING A 4 BILL SPREADER

SYMBOL DEFINITION		TOTAL NO OF INSPECTIONS REQUIRED	MISSING SYMBOLS
A DIMENSION WITHOUT AN INSPECTION REPORT SYMBOL DOES NOT REQUIRE INSPECTION. IT MAY BE CONTROLLED ON THE INDIVIDUAL COMPONENT DRAWING.		3	NO MISSING SYMBOL NUMBER
		LAST NO. USED	3

DWO STATUS						REVISION HISTORY				AUTH	DR	APVD1	APVD2
DATE	STG	REV	N/P	CHG	ZONE								
17FE05	R	A1	-	-		ADDED LEFT, BACK & BOTTOM VIEWS, ADDED NOTE (1) PLCI, ADDED SHEET METAL VIEWS, ADDED MAX ALLOWABLE DIM VIEW, ADDED TOLERANCE CHART, ADDED PROCESS SENSITIVE CHART, ADDED PROCESS SENSITIVE DIM TO CHART, ADDED DELPHI LOGO, REMOVED NOTE (1) PLCI, UPDATED MATERIAL SPEC, CLEARED REV COLUMN AND UPDATED FORMAT				264651	EES	EES	JS
190C05	R	A2	-	-		ADDED NOTE #7				273773	RH	RH	JAS

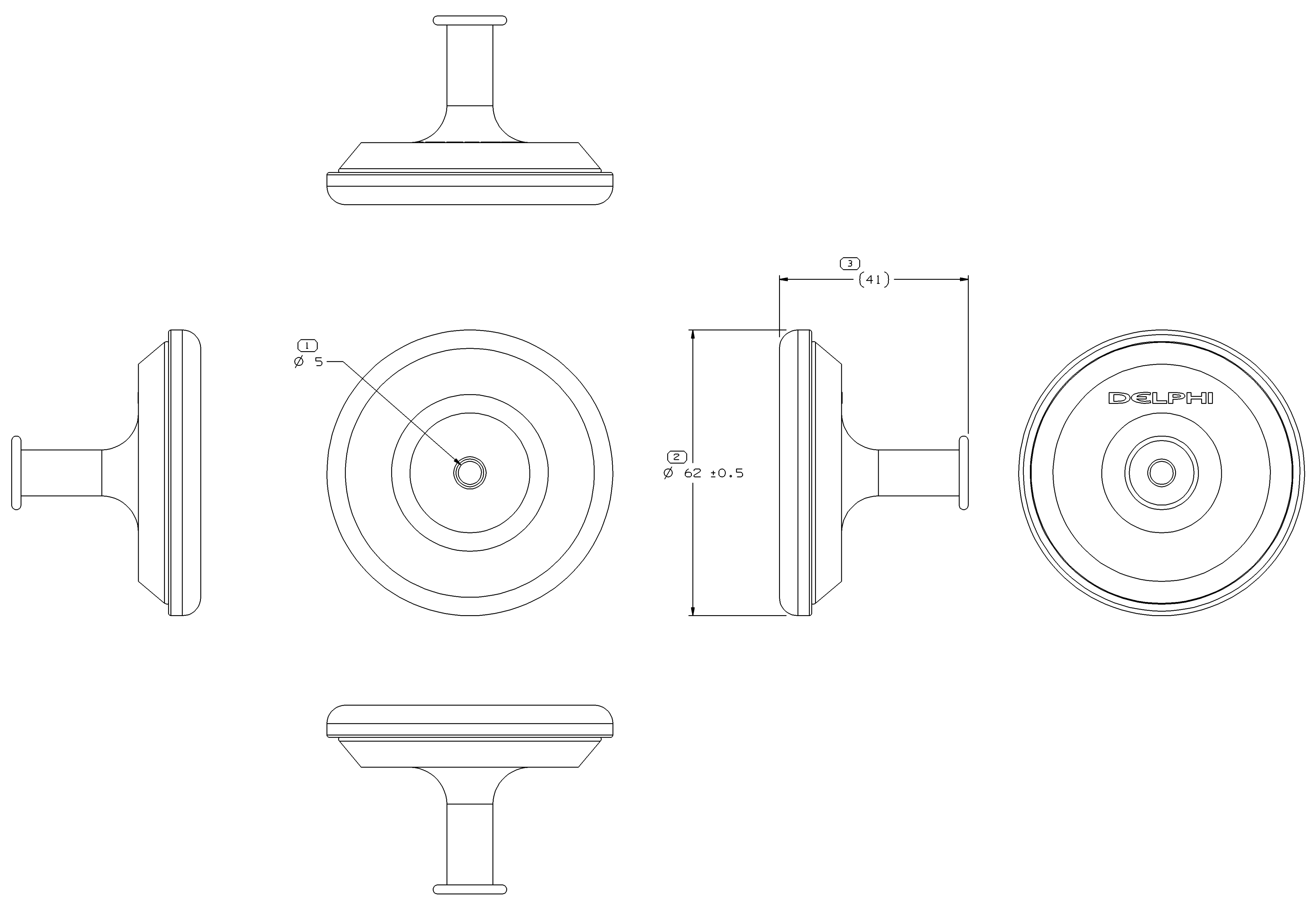

NOTES:

- UNLESS OTHERWISE SPECIFIED AND/OR INDICATED: DIMENSIONS ARE TO FACE OF VIEW SHOWN AND AUTOMATICALLY ROUNDED BY COMPUTER FOR INSPECTION. (SEE MATH MODEL FOR PRECISE DIMENSION) FOR ALL OTHER DIMENSIONS NOT SHOWN BUT REQUIRED FOR TOOL BUILD, SEE MATH MODEL FOR PRECISE TOOL PATH DATA.
- THIS GROMMET TO BE USED WITH HARNESS BUNDLE SMOOTH TAPE WRAPPED USING 5 MIL TAPE HAVING NO SLITS ON EDGES.
- PART IS SYMMETRICAL ABOUT CENTERLINE, EXCEPT AS NOTED.
- THIS PART IS NOT CONTROLLED FOR AUTOMATIC FEEDING.
- THIS PART MATES TO 50.0±0.5 DIA HOLE IN 0.73/0.67 THICK SHEET METAL.
- (2.3)X(0.1) RAISED DELPHI CORPORATE BRAND TO BE LOCATED ON ANY EXTERIOR SURFACE, PREFERABLY VISIBLE AT FINAL ASSEMBLY. OPTIONAL CONSTRUCTION TO BE "PED" OR NO LOGO.
- REFERENCE VPS B36 PAGE #6 FOR ALLOWABLE FLASH.

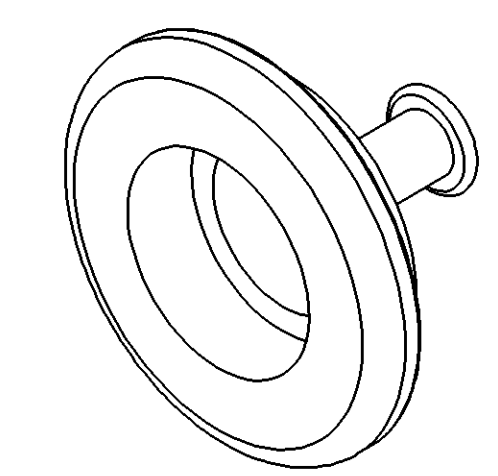

DWO TYPE		PART DRAWING	
STYLE		DISTR CODE	D
VOLUME (COP)	24.013		
UNLESS OTHERWISE SPECIFIED THIS DOCUMENT IS IN ACCORDANCE WITH ASME Y14.5M-1994 AS AMENDED BY THE 2003 DIMENSIONING AND TOLERANCING ADDENDUM (2003). SEPARATE PATTERNING FEATURES MAY BE DIMED SEPARATELY REGARDLESS OF DATUM REFERENCES.			
ALL DIMENSIONS ARE IN MILLIMETERS			

DELPHI
DELPHI PACKARD ELECTRIC SYSTEMS
WARREN, OH

DR	DATE
APVD1 G.G. LOQUIERO	12SE97
APVD2 JUAN GONZALEZ	12SE97
APVD3 BRIAN EDWARDS	17SE97
APVD4	
APVD5	

MATERIAL: M4433002

UNLESS OTHERWISE SPECIFIED: SUBSTANCE OF CONCERN AND RECYCLED CONTENT PER DELPHI 10949001

DRAWING NAME: GROM TAPE ON

DRAWING NUMBER: 15336109

SIZE: A0 | SCALE: 2:1 | FRAME NO: 1 OF 2 | SHEET NO: 1 OF 1 | STG: R | REV: A2

PROCESS SENSITIVE DIMENSION		THIRD ANGLE PROJECTION		DO NOT SCALE	
DIMENSIONS ENCLOSED IN () INDICATE RETROFIT DIMENSIONS AND NO TOLERANCE LIMITS ARE ESTABLISHED		USE MATH DATA		UNSPRINGS	
DIMENSIONAL RANGE (MM)	CHART C				
FROM	> 0	> 25	> 50	> 80	
TO	≤ 60	80			
TOLERANCE UNLESS OTHERWISE SPECIFIED					
±0.3		±0.5	±0.6	±0.75	
ANGULAR TOLERANCE ±2°					