

SYMBOL DEFINITION		MISSING NUMBERS		DWG STATUS				REVISION HISTORY				AUTH DR CK APVD					
A DIMENSION WITHOUT AN INSPECTION REPORT SYMBOL () DOES NOT REQUIRE INSPECTION. IT MAY BE CONTROLLED ON AN INDIVIDUAL COMPONENT DRAWING		TOTAL NO. OF SYMBOLS ON DRAWING	LAST NO. USED	DATE	STG	REV	CHK	N/P	ZONE								
		28	34	01SE99	R	002	-	-	-	WAS PE073321, REVISED AND RELEASED				990005	AMG	JVM	AJH
				14MR00	R	003	-	-	-	REVISED GRAPHICS				199387	AMG	JVM	AJH
				16FE01	R	004	-	-	-	REVISED LOCK ARM, (80.3) WAS (79.23), (26.5) WAS (25.54) AND (72) WAS 71.99				206918	AAS	JAA	AJH
				05AP01	R	005	-	-	-	REVISED LOCK ARM, 2.15 WAS 2.07, (79.3) WAS (80.3), (25.5) WAS (26.5)				207874	TSH	TSH	AJH
				30MY01	R	005	-	AA	-	REVISED TOLERANCES (6 PLCS) AND REMOVED 22.5+0.6-0.15 DIM				209219	TLD	TLD	AJH
				03MY01	R	005	-	AB	-	24.5+0.15-0.5 DIM WAS 24.5+0.5-0.15				209352	TLD	TLD	AJH
				27JN01	R	006	-	-	-	REVISED GRAPHICS				209699	LOA	JAA	AJH
				20AU01	R	006	-	AA	-	2.07+0.6/-0.15 WAS 2.07 AND 2.15+0.52/-0.15 WAS 2.15				212865	HAM	HAM	AH
				11SE01	R	007	-	-	-	REVISED MODEL AND DIM- WAS 2.15 +0.52/-0.15				214365	MAC	MAC	AJH

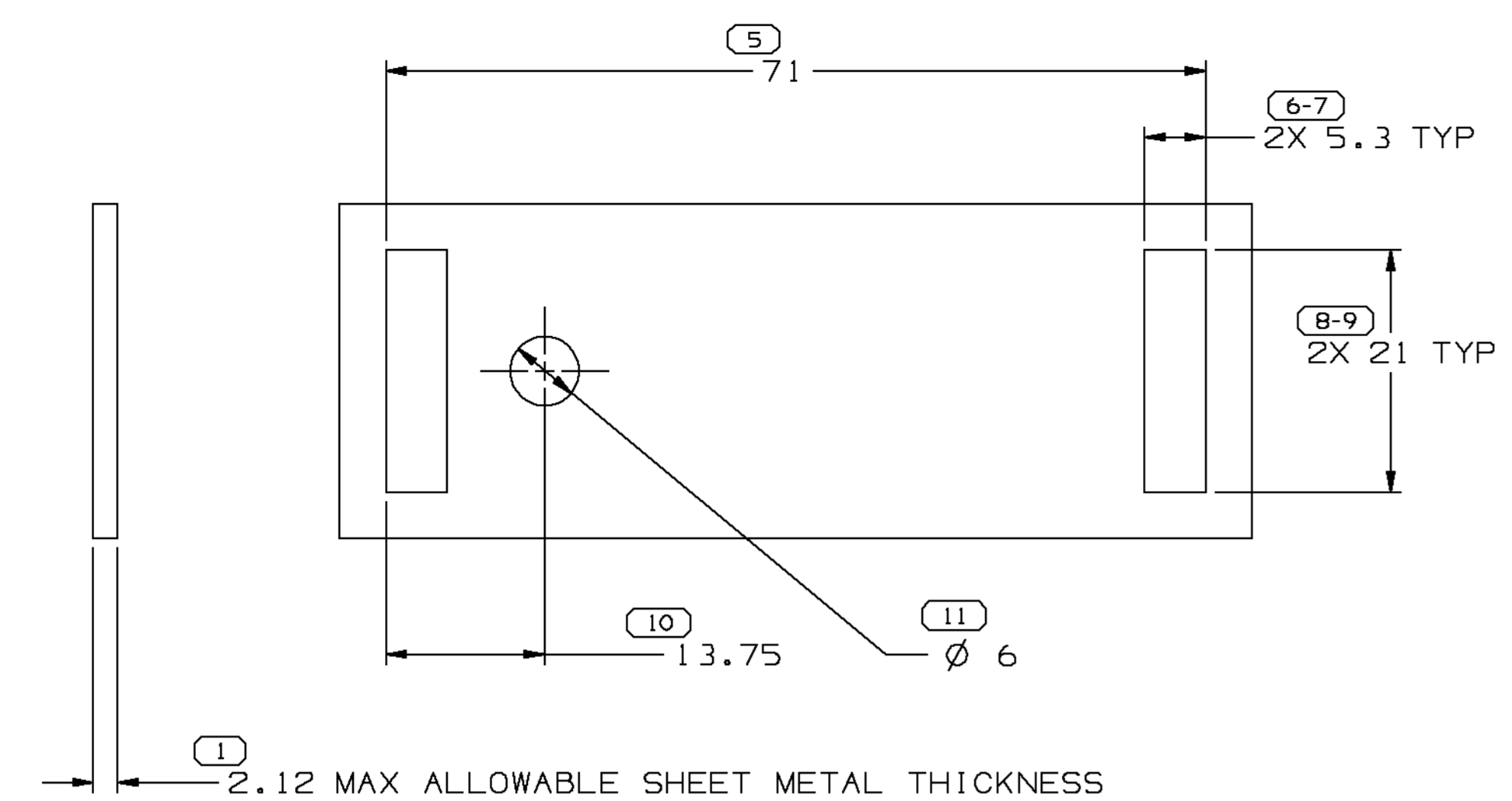

MOUNTING HOLE DETAIL

INSPECTION SYMBOLS SHOWN IN THIS VIEW ARE FOR REFERENCE ONLY

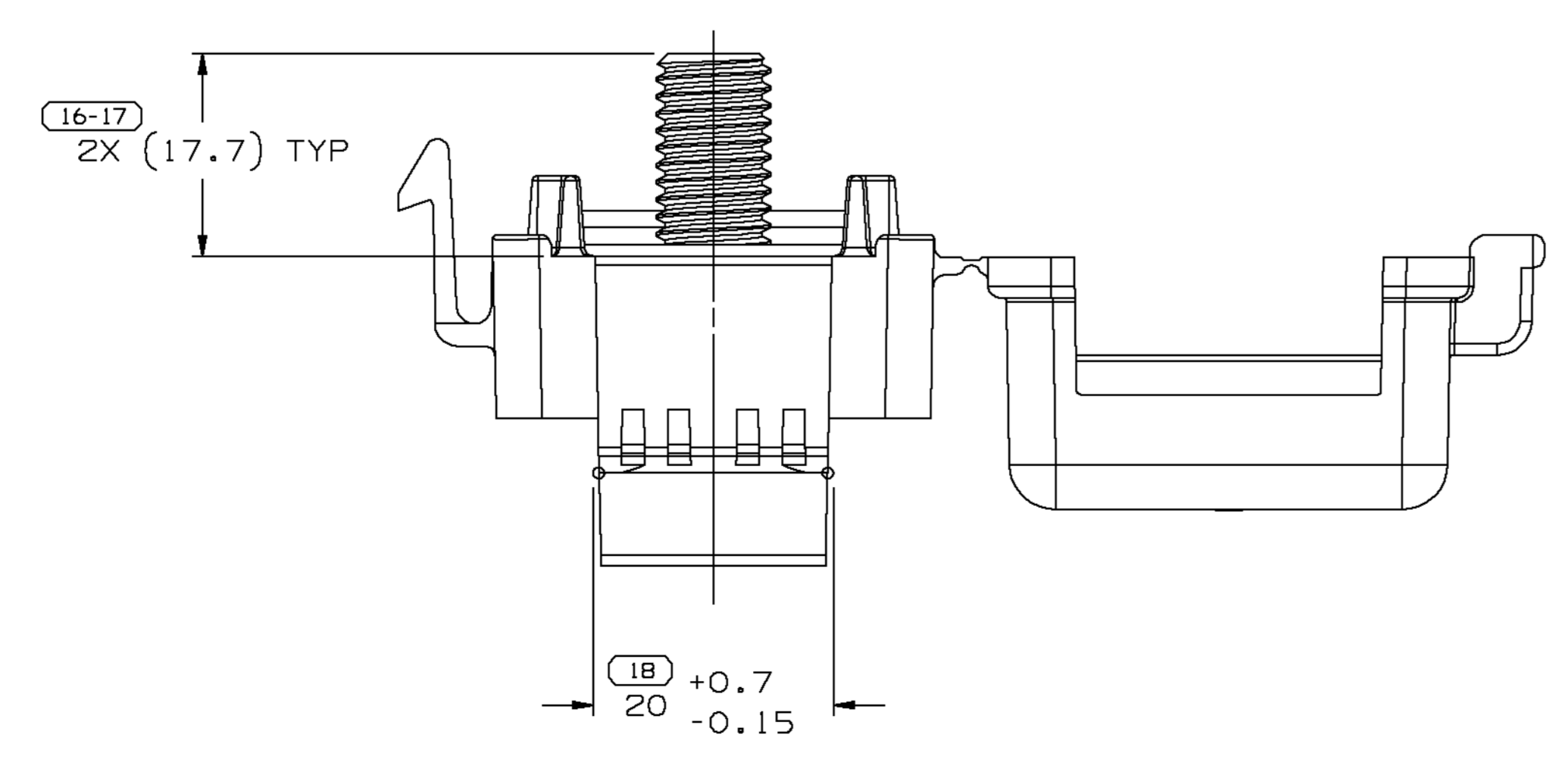
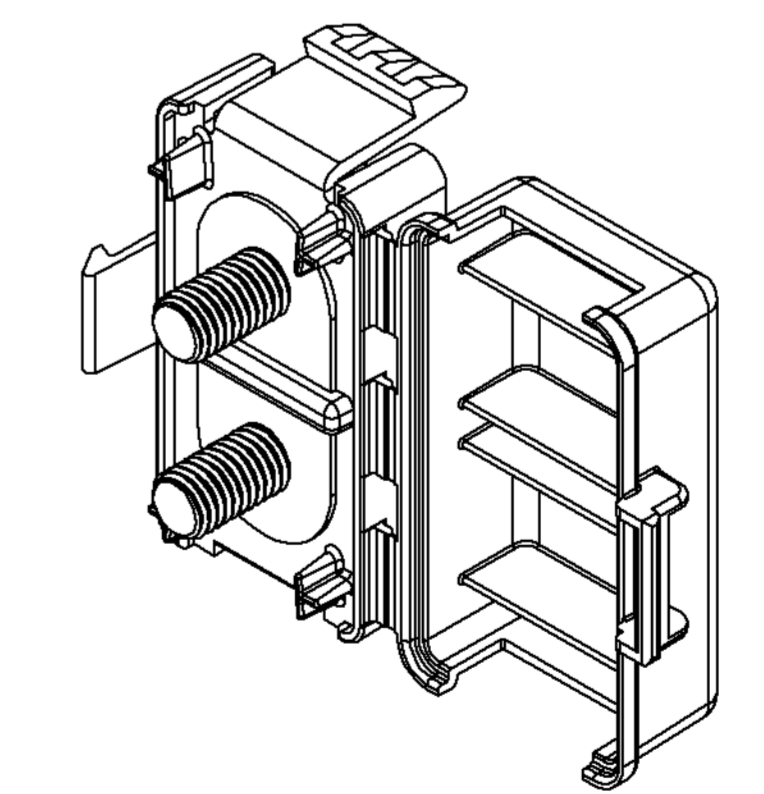
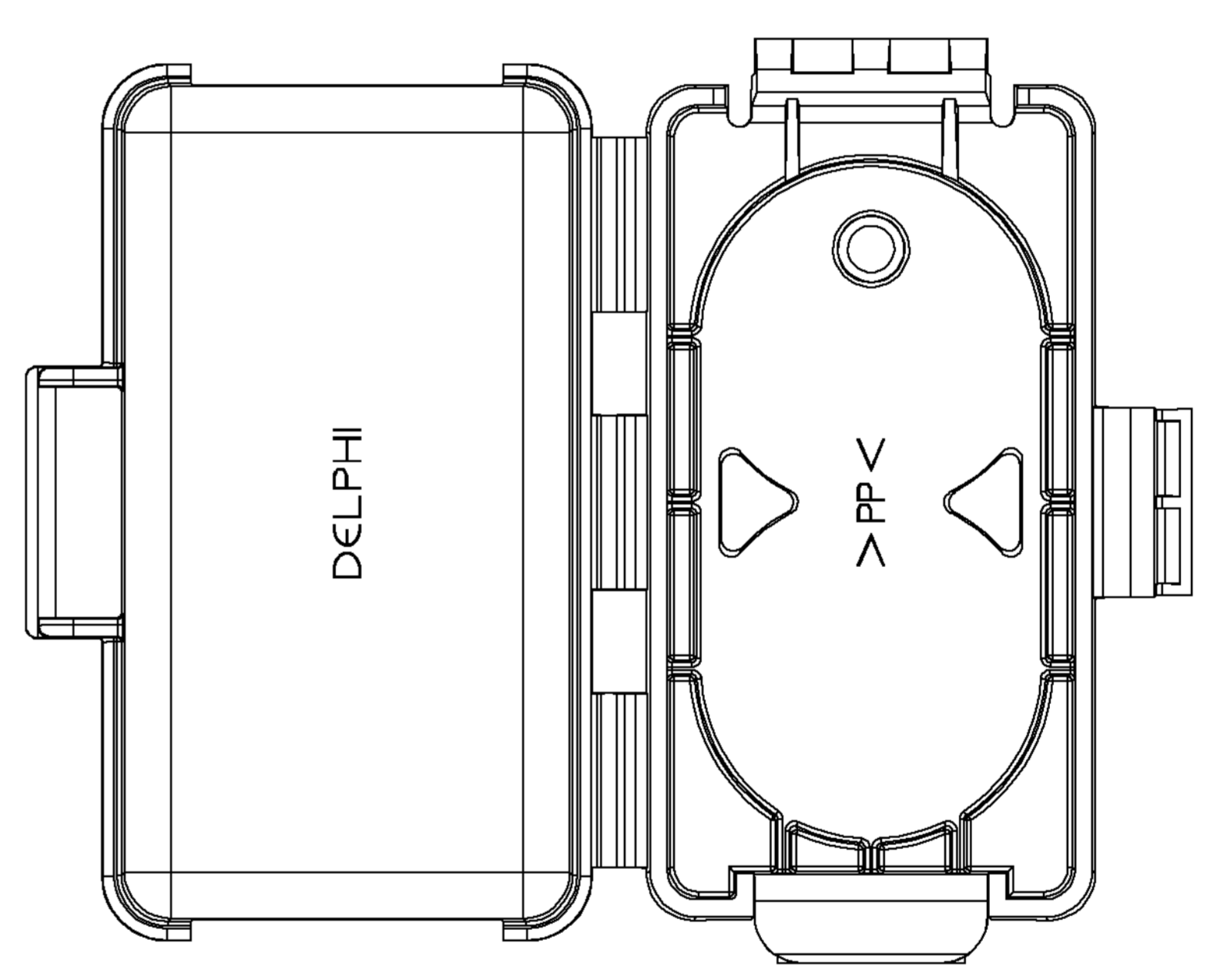
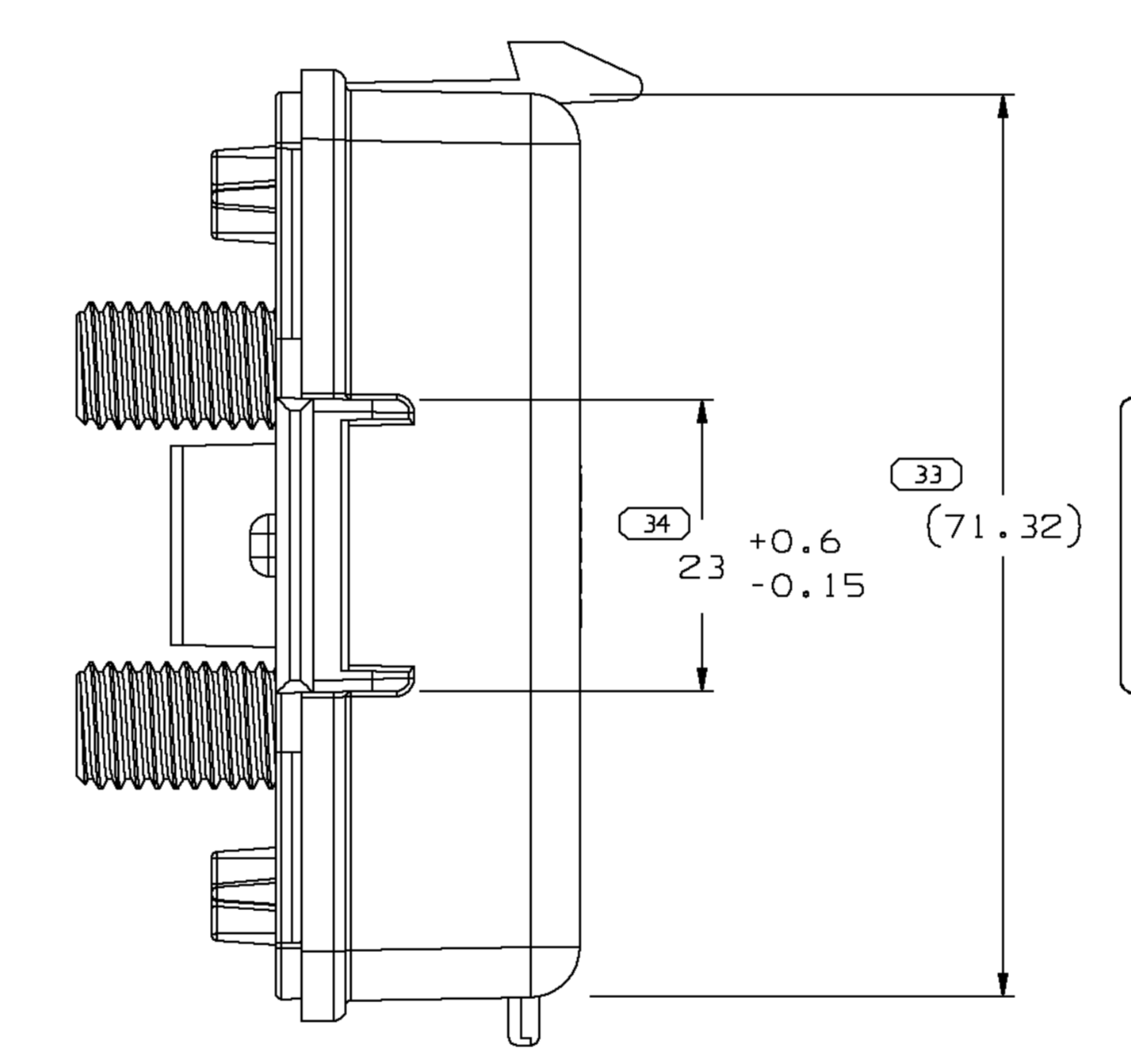
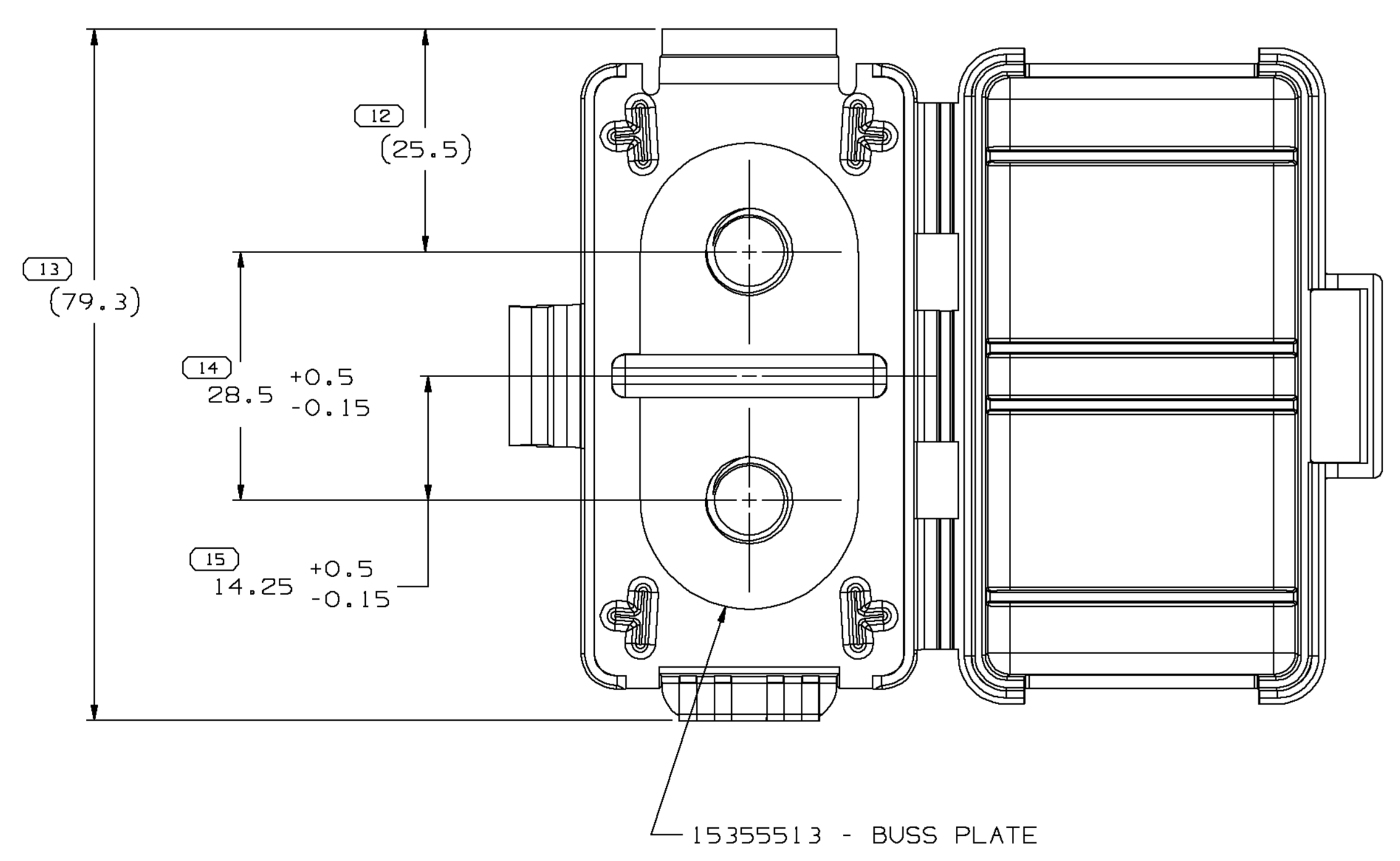
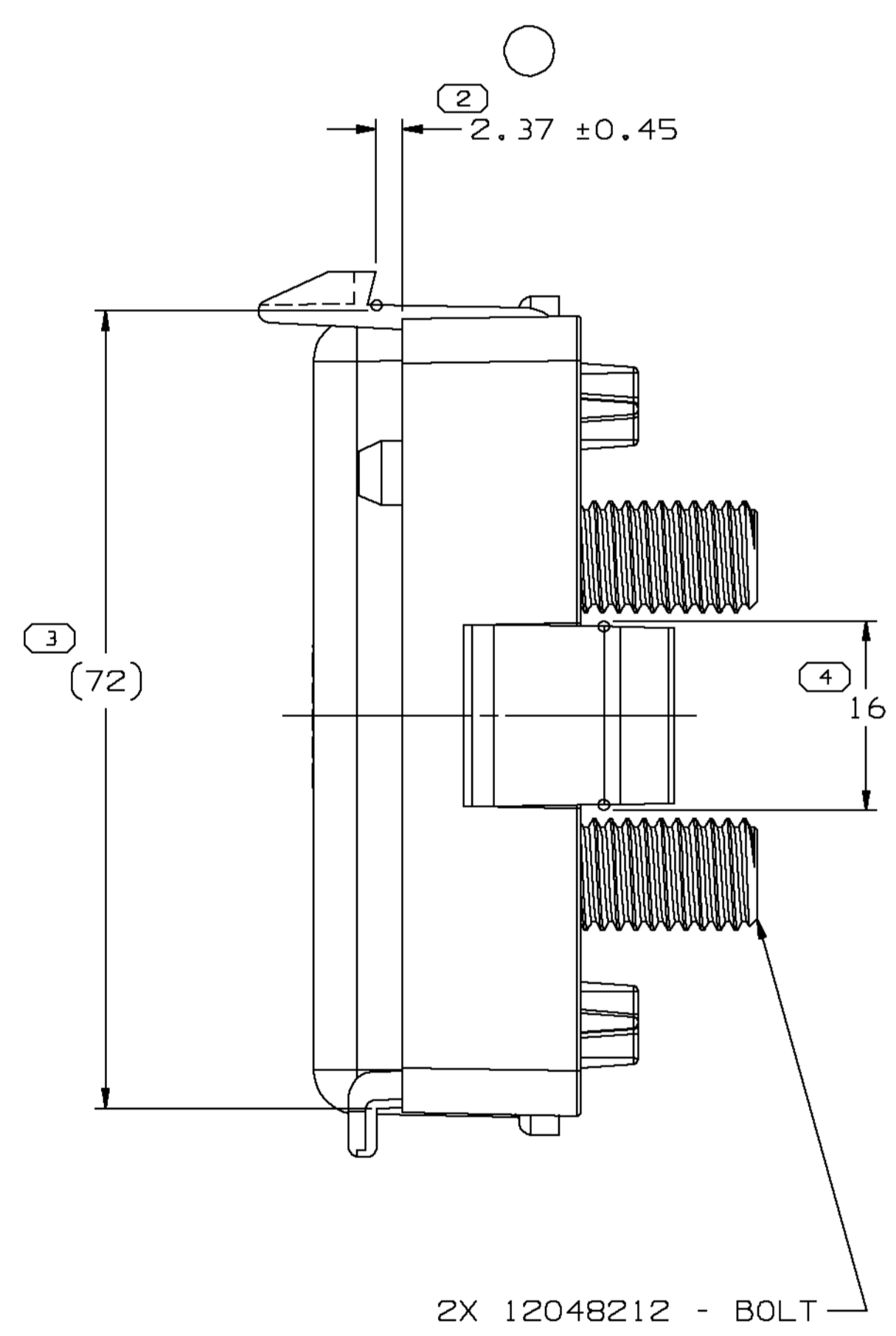
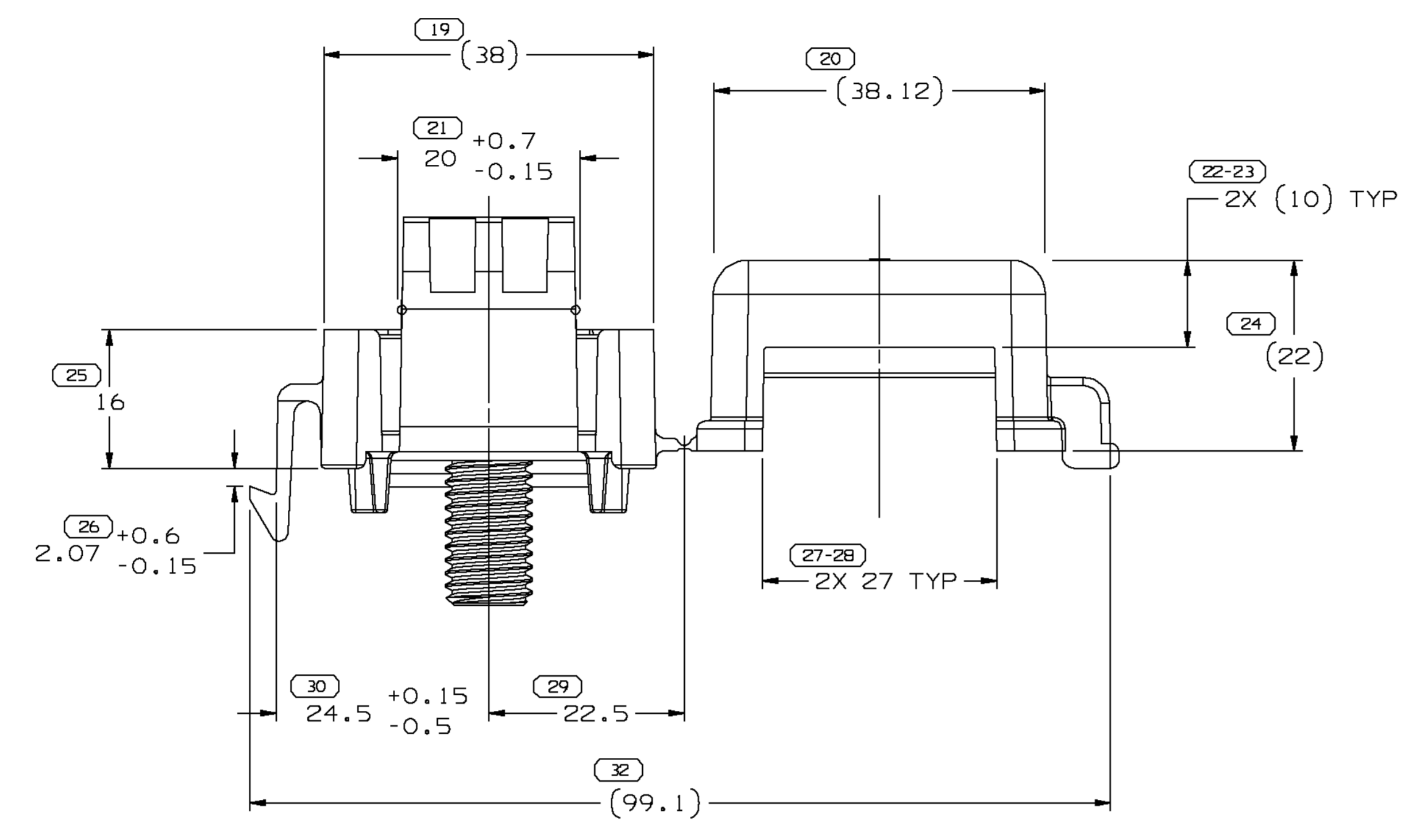

NOTES

- UNLESS OTHERWISE SPECIFIED AND/OR INDICATED: DIMENSIONS ARE TO FACE OF VIEW SHOWN AND AUTOMATICALLY ROUNDED BY COMPUTER FOR INSPECTION. (SEE MATH MODEL FOR PRECISE DIMENSIONS.) FOR ALL OTHER DIMENSIONS NOT SHOWN BUT REQUIRED FOR TOOL BUILD, SEE MATH MODEL FOR PRECISE TOOL PATH DATA.
- MATING COMPONENTS OR EQUIVALENT:
NUT (2 REQ'D) - 12020097
TERMINAL - 12146360 (WITH SLEEVE)
- INSERTS MUST RESIST A TORQUE OF 25 NM WITHOUT STRIPPING OR TURNING IN PLASTIC. (REFERENCE)
- ALL EXTERIOR SURFACES OF COVER, EXCEPT HINGE AND LOCK, TO BE STIPPLE FINISHED.
- THIS PART IS NOT CONTROLLED FOR AUTOMATIC FEEDING.
- EACH STUD CAN ACCEPT A MAXIMUM OF TWO SLEEVED RING TERMINALS IN A FAN ARRANGEMENT.

DIMENSIONAL RANGE (MM)		TOLERANCE UNLESS OTHERWISE SPECIFIED		ANGULAR TOLERANCE ±	
FROM	TO				
0	> 20	±0.15	±0.2	±0.3	±0.5
> 20	> 30	±0.2	±0.3	±0.4	±0.5
> 30	> 70	±0.3	±0.4	±0.5	±0.6
> 70	> 100	±0.4	±0.5	±0.6	±0.8
> 100	> 150	±0.5	±0.6	±0.8	±1.0
> 150	> 200	±0.6	±0.8	±1.0	±1.2
> 200	> 250	±0.8	±1.0	±1.2	±1.5
> 250	> 300	±1.0	±1.2	±1.5	±2.0
> 300	> 400	±1.2	±1.5	±2.0	±2.5

DELPHI
Automotive Systems

MATERIAL SPEC
R0071602 PP 1M-RED

SUBSTANCES OF CONCERN AND RECYCLED CONTENT PER DELPHI-A 10949001

PART DRAWING

CODE NUMBER 6900	DWG DATE 01SE99	SCALE 2:1	DISTR CODE D
OC SPEC	STYLE	VOLUME cm³ 35.322	

PART GEOMETRY: 3D SOLID

UNLESS OTHERWISE SPECIFIED:
THIS DOCUMENT IS IN ACCORDANCE WITH ASME Y14.5M - 1994 AS AMENDED BY THE GM GLOBAL DIMENSIONING AND TOLERANCING ADDENDUM - 1997. ALL GEOMETRIC TOLERANCES AND RELATED DATUMS APPLY RFS. RULE #1 (PERFECT FORM AT MMC) DOES NOT APPLY WHEN RELATIONSHIP BETWEEN FEATURES IS ESTABLISHED BY ORIENTATION OR LOCATION TOLERANCES. SEPARATE POSITION CALLOUTS MAY BE GAGED SEPARATELY REGARDLESS OF DATUM REFERENCES.

REFERENCE	DR	DATE
APVD1	ANDRES MENDEZ	01SE99
APVD2	J. VILLAMIL	02SE99
APVD3	AL HERRMANN	07SE99
APVD4		
APVD5		

METRIC UNLESS OTHERWISE SPECIFIED, ALL DIMENSIONS ARE IN MILLIMETERS

THIRD ANGLE PROJECTION

DRAWING NAME: ASM CONN REMOTE ACCESS

SHEET NUMBER 1 OF 1	DRAWING NUMBER 15355512	DWG STATUS R 007	SIZE A0
------------------------	----------------------------	---------------------	------------