

15383048 & 12160811
PLATING LOCATION DETAIL

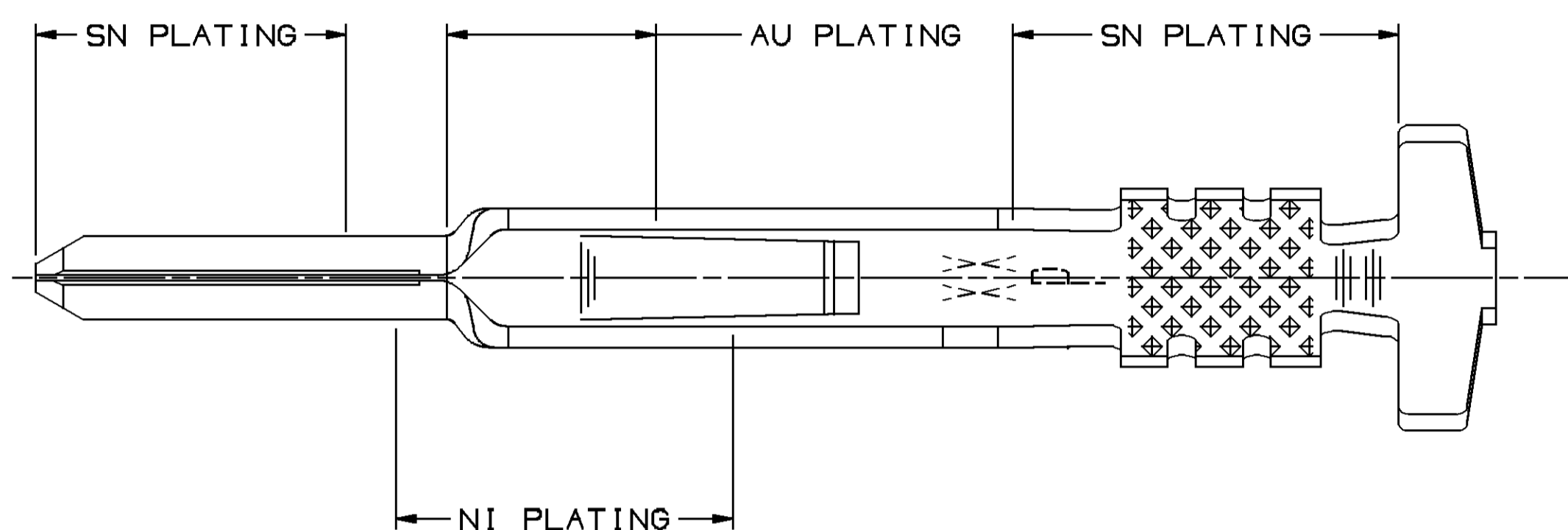

12110502
PLATING LOCATION DETAIL

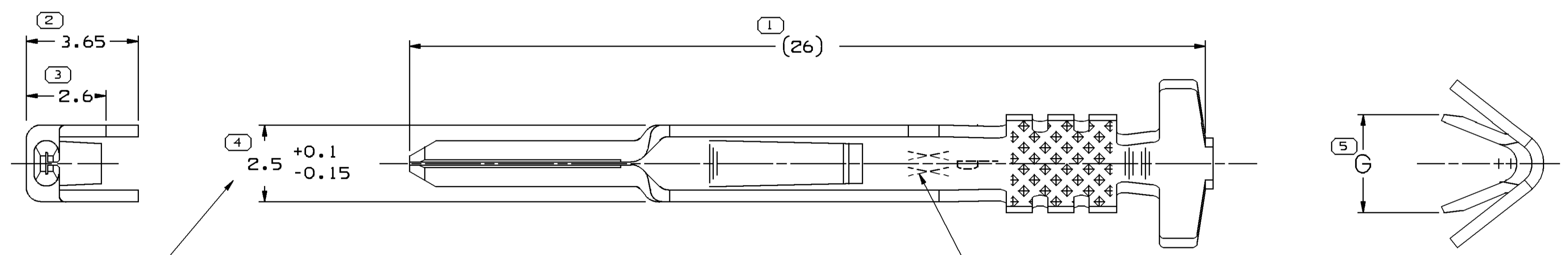

THIS WIDTH MUST BE MAINTAINED FOR A MINIMUM DISTANCE OF 8.8 FROM THE FRONT OF THE BOX TO THE BACK OF THE STOP TO LOCK FEATURE

TYPE 101

STAMP I.D. "PXX" IN THIS AREA (0.6) CHARACTERS XX DESIGNATES DIE NUMBER LOCATION IS APPROXIMATE.

CONDUCTOR WINGS FOR (SEE CHART) MM² CABLE

INSULATION WINGS FOR (SEE CHART) Ø MAX INSULATION

- NOTES
- UNLESS OTHERWISE SPECIFIED AND/OR INDICATED: DIMENSIONS ARE TO FACE OF VIEW SHOWN AND AUTOMATICALLY ROUNDED BY COMPUTER FOR INSPECTION (SEE MATH MODEL FOR PRECISE DIMENSIONS). FOR ALL OTHER DIMENSIONS NOT SHOWN BUT REQUIRED FOR TOOL BUILD, SEE MATH MODEL FOR PRECISE TOOL PATH DATA.
 - REFERENCE MATING COMPONENTS OR EQUIVALENT: TERMINAL 12047767
 - NO CHANGE IS TO BE MADE TO THIS PART WITHOUT IFG AUTHORIZATION (P/N 12110502 ONLY).

| PART NO | REV | N/P | STATUS | MAT'L SIZE | MAT'L SPEC | SIZE (MM ²) | ID | DIA | TYPE |
|----------|-----|-----|--------|---------------|---|-------------------------|----|----------|---------|
| 15383048 | 01 | AH | | 0.381 X 34.52 | TIN BRASS ALLOY GOLD, TIN & NICKEL ELECTROPLATE | 0.35- 0.5 | 21 | 2.4-1.47 | 301 2.4 |
| 12160811 | C9 | - | | 0.381 X 34.52 | TIN BRASS ALLOY GOLD, TIN & NICKEL ELECTROPLATE | 0.5 - 0.8 | 19 | 2.4-1.84 | 301 3.2 |
| 12110502 | D9 | - | | 0.381 X 34.52 | TIN BRASS ALLOY GOLD, TIN & NICKEL ELECTROPLATE | 0.5 - 0.8 | 19 | 2.4-1.84 | 301 3.2 |
| | | | | | | | | | |

SYMBOL DEFINITION

A DIMENSION WITHOUT AN INSPECTION REPORT SYMBOL DOES NOT REQUIRE INSPECTION. IT MAY BE CONTROLLED ON THE INDIVIDUAL COMPONENT DRAWING.

| | |
|----------------------------------|---|
| TOTAL NO OF INSPECTIONS REQUIRED | 6 |
| LAST NO. USED | 6 |

MISSING SYMBOLS

| | |
|--------------------------|--|
| NO MISSING SYMBOL NUMBER | |
|--------------------------|--|

| DWG STATUS | | | | | ZONE | REVISION HISTORY | AUTH | DR | APVD1 | APVD2 |
|------------|-----|-----|-----|-----|------|--|--------|-----|-------|-------|
| DATE | STG | REV | N/P | CHG | | | | | | |
| 30N099 | R | 01 | - | - | | ALL PARTS - REDRAWN TO PD | 196871 | GMC | GMC | 06 |
| 30N099 | R | 02 | - | - | | 15383048 - RELEASED | 990005 | GMC | GMC | 06 |
| 19N003 | R | 03 | - | - | | ALL PARTS - UPDATED CHART "G" WAS "A" | 247796 | LOA | FKV | RD |
| 10N004 | - | 04 | - | - | | ALL PARTS - UPDATED MAT'L SPEC CALLOUT | 261173 | JS | JS | B6 |
| 30MR05 | R | 05 | - | - | | ALL PARTS - TOLERANCE ON DIM #5 WAS ±0.1 | 265258 | LMB | LMB | MM |
| 16AU05 | R | 06 | - | - | | ALL PARTS - ADDED STAMP I.D. LABEL | 270616 | RTV | FRG | MKM |
| 15JA09 | R | 07 | - | - | | ALL ACTIVE PARTS - ADDED LABEL AND DIM 2.5 +0.1/-0.15 WAS 2.5 ±0.1 | 407112 | SCR | ECB | GEM |
| 10DE09 | R | 08 | - | - | | ALL PARTS - REFERENCE MATING TERMINAL WAS 12047776 | 409633 | DGL | DGL | GEM |
| 31MY10 | R | 09 | - | - | | ALL PARTS - UPDATED PDM ATTRIBUTES | 410934 | MAB | JAA | GEM |
| 21JL10 | R | 10 | - | - | | ALL PARTS - ADDED PLATING INFORMATION | 411388 | AHY | DMC | GEM |

DELPHI
DELPHI PACKARD ELECTRICAL/ELECTRONIC ARCHITECTURE
WARREN, OH

| | |
|---------------------|--------|
| DR | DATE |
| APVD1 H. CASTRILLON | 08MY97 |
| APVD2 J. VAZQUEZ | 12MY97 |
| APVD3 R. LANDRIES | 12MY97 |
| APVD4 | |
| APVD5 | |

UNLESS OTHERWISE SPECIFIED THIS DOCUMENT IS IN ACCORDANCE WITH ASME Y14.5M-1994 AS AMENDED BY THE 0M GLOBAL DIMENSIONING AND TOLERANCING ADDENDUM - 1997. ALL GEOMETRIC TOLERANCES AND RELATED DATUMS APPLY RFS. RULE #1 (PERFECT FORM AT MMPI) DOES NOT APPLY WHEN RELATIONSHIP BETWEEN FEATURES IS ESTABLISHED BY ORIENTATION OR LOCATION TOLERANCES. SEPARATE POSITION CALLOUTS MAY BE GAGED SEPARATELY, REGARDLESS OF DATUM REFERENCE. ALL DIMENSIONS ARE IN MILLIMETERS

REFERENCE

| | |
|------------------------|--------------|
| THIRD ANGLE PROJECTION | DO NOT SCALE |
| USE MATH DATA | |

DRAWING NAME: TAXI TERM M/M/P 150
DRAWING NUMBER: 12040995

| | | | | | | |
|------|-------|----------|----------|-----|-----|-----|
| SIZE | SCALE | FRAME NO | SHEET NO | STG | REV | N/P |
| A1 | 10:1 | 1 OF 1 | 3 OF 3 | R | 10 | - |

4 PROCESS SENSITIVE DIMENSION

| | |
|--------------------------------------|-----------|
| DIMENSIONAL RANGE (MM) | CHART 'D' |
| FROM 0 TO 12 | > 12 |
| TOLERANCE UNLESS OTHERWISE SPECIFIED | |
| ±0.1 | ±0.2 |
| ANGULAR TOLERANCE ±2° | |