

# Mini-Din Receptacles

161-2103, 161-2104

**KOBI**CONN

Mini-Din Receptacles

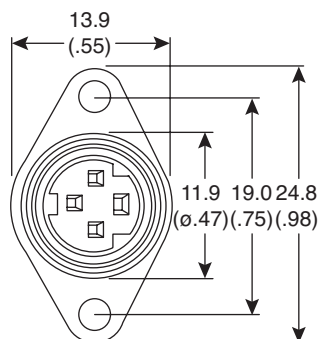
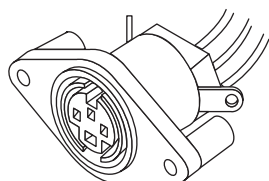

Dimensions: mm (In.)

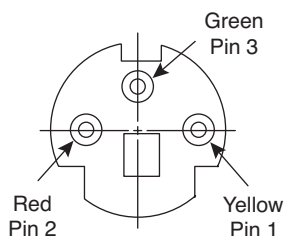
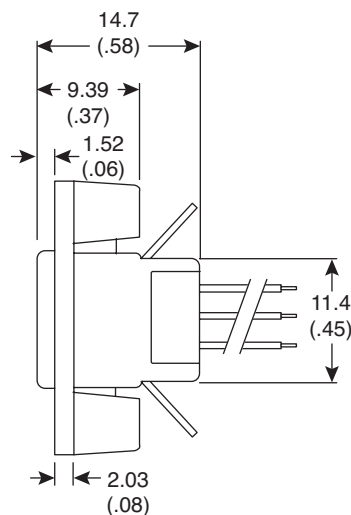

161-2103  
3 Pin

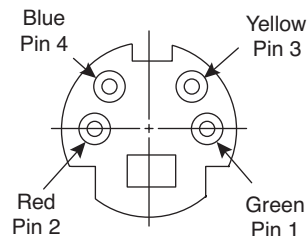

161-2104  
4 Pin

## SPECIFICATIONS

<b>Type:</b>	panel mount Mini-Din jacks w/leads
<b>Rating:</b>	100VAC 1A max., 12VDC 2A max.
<b>Insulation resistance:</b>	50mΩ min. @ 250VDC
<b>Dielectric strength:</b>	250VAC for 1 minute
<b>Contact resistance:</b>	30MΩ max.
<b>Insertion force:</b>	4.5Kg max.
<b>Withdrawal force:</b>	.9Kg ~ 3Kg
<b>Dimension tolerance:</b>	±.1mm (.004)
<b>Mounting hole:</b>	ø2.2mm (.08)
<b>Wire gauge:</b>	26AWG
<b>Lead length:</b>	200mm (7.87")
<b>Screw size:</b>	M2.6 x 8mm

Date Last Revised: 6-09-05

Available from Mouser Electronics  
1-800-346-6873  
www.mouser.com

KC-300693

161-2103, 161-2104