

DASH NO.	M CODE	MADE FROM
----------	--------	-----------

GSD

2029-15-9

REVISIONS	
ISSUE	CHANGES
0	ER 32981 JCA 03/20/91
1	CN 35329 C KVH 02/16/94
2	CN 38020 C TML 06/12/00

2029159S

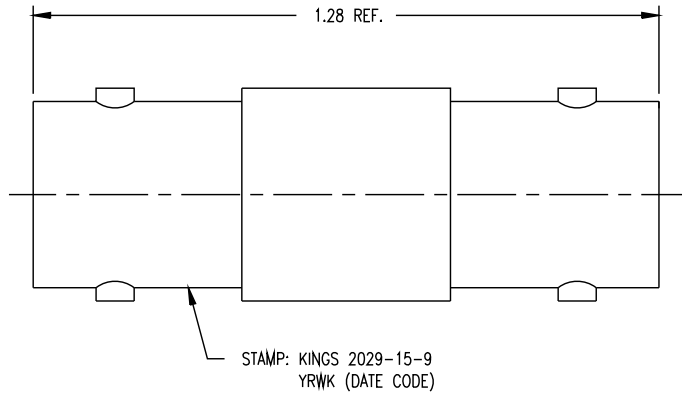

NOTES:

- INTERFACES PER MIL-STD-348, FIG. 301-2 (AS APPLICABLE)..
- MATERIALS:  
INSULATOR: TEFLON, ASTM-D-4894  
CENTER CONTACT: BER. COP., ASTM-B-196  
ALL OTHER PARTS: BRASS, ASTM-B16
- FINISHES:  
CENTER CONTACT : HARD GOLD PLATE PER MIL-STD-45204  
ALL OTHER METAL PARTS: KINGS TARNISH RESISTANT FINISH (TR-5)
- ELECTRICAL CHARACTERISTICS:  
NOMINAL IMPEDANCE: 75 OHMS  
VOLTAGE RATING: 500 VRMS  
FREQUENCY RANGE: DC TO 2 GHz

UNLESS OTHERWISE SPECIFIED

- |  |   |  |
|--|---|--|
| 1. TOLERANCES: FRACTIONS & 2 PLACE DECIMALS ± .010<br>3 PLACE DECIMALS ± .004 ANGLES ± 1°<br>CONCENTRICITY OF ANY 2 DIAMETERS MAY NOT EXCEED HALF THE SUM OF THEIR TOLERANCES. | 2. REMOVE ALL BURRS, BREAK SHARP EDGES .005 MAX.<br>3. NO FILLETS PERMITTED.<br>4. SURFACE ROUGHNESS 63 MICROINCHES RMS MAX.<br>5. ALL DIMENSIONS PRIOR TO PLATING.<br>6. ALL PLATING IN ACCORDANCE WITH KER 10004. | 7. ALL LEAD THREADS TO BE CHAMFERED 45° TO ROOT DIAMETER.<br>★ CRITICAL DIMENSIONS |
|--|---|--|

GSD

SCALE 4:1	
APPROX SURFACE AREA	
WAS: JCA1498	
USED ON	
REF:	
ADPT, F-F, 75 BNC-75 BNC	
DRAWN JCA	DATE 03/20/91
DESIGN GA	DATE 03/21/91
APPR.	DATE
 ROCK HILL, SOUTH CAROLINA 29730	
2029-15-9	