

LOC	DIST	REV	DATE	BY	APP'D
AD	00				

REVISIONS					
REV	DATE	BY	APP'D	DESCRIPTION	DATE
D	21NOV2012	WS	RP	REV PER ECO-12-018914	
E	15JAN2013	WS	RP	REV PER ECO-12-020324	
F	04SEP2019	AP	SY	REVISED PER ECO-19-012987	
G	13JUL2020	AP	SY	REVISED PER ECO-20-009694	

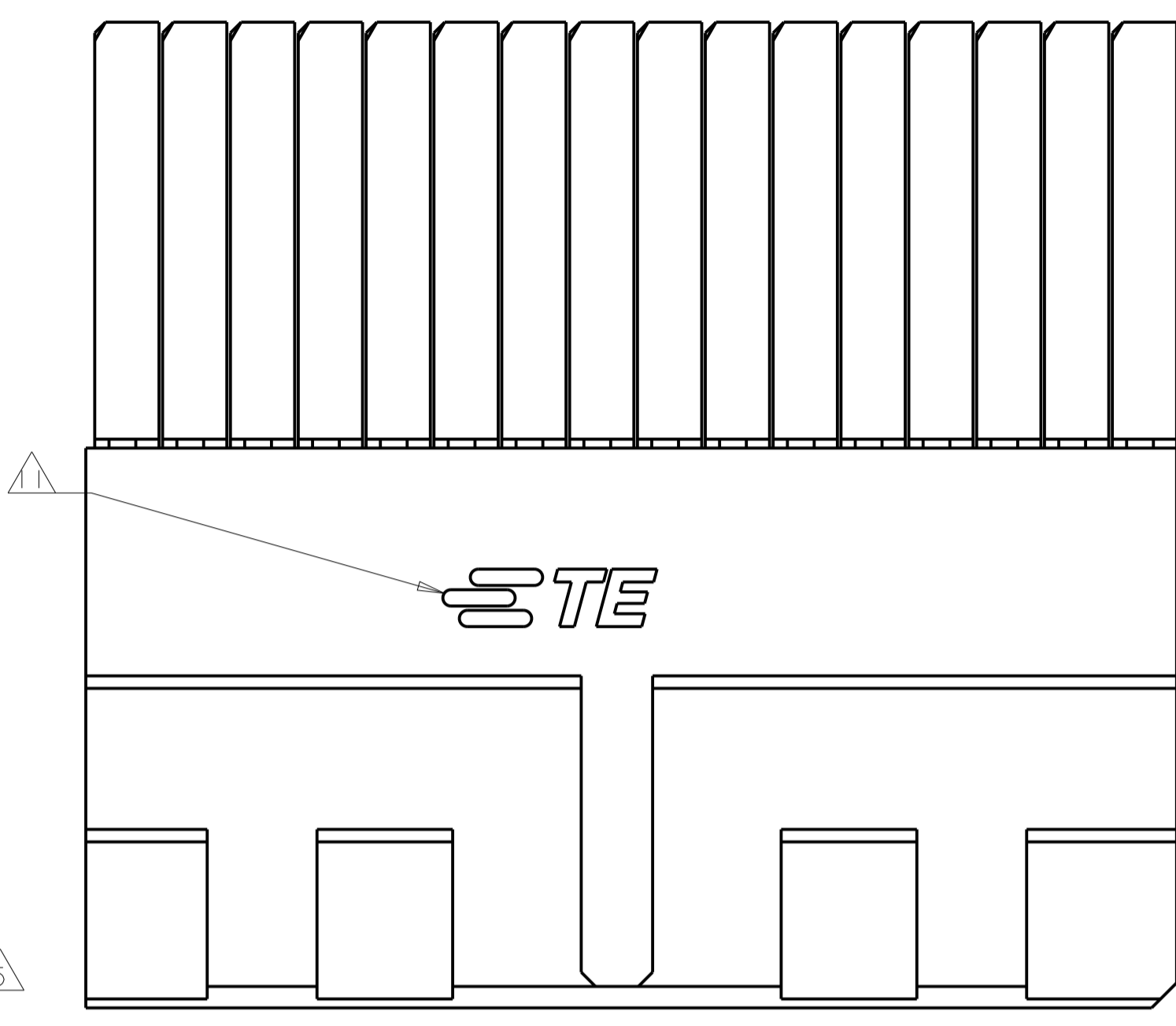

- △ MATERIAL:  
CONTACT AND SHIELD - PHOS BRONZE  
HOUSING AND CHICKLET - LCP, UL 94V-0, COLOR - BLACK
- △ FINISH:  
CONTACT AREA FINISH CONFORMS TO THE REQUIREMENTS OF TE PRODUCT SPECIFICATION 108-2303; BASED ON TELCORDIA GR-1217-CORE FOR SYSTEM QUALITY LEVEL III APPLICATIONS IN CONTROLLED ENVIRONMENTS (CENTRAL OFFICE).
- △ CONNECTOR MARKED ON EITHER SIDE OF HOUSING WITH PART NUMBER, DATE CODE AND STANDARD IN APPROXIMATE AREA SHOWN.
- △ DIMENSION APPLIES TO CENTERLINE OF THRU HOLE.
- △ DATUMS AND BASIC DIMENSIONS ESTABLISHED BY CUSTOMER.
- 6. CONTACT AREA LUBRICATED WITH BELLCORE APPROVED LUBRICANT. TECHNICAL REFERENCE: GR-1217-CORE, ISSUE 1, NOVEMBER 1995.
- △ REFERENCE APPLICATION SPEC 114-13202 FOR RECOMMENDED PLATED THRU HOLE DIAMETER AND PLATING THICKNESSES.
- △ THE GROUNDS IN EACH COLUMN ARE COMMONED.
- △ FINISH:  
CONTACT: MATING AREA - 0.76µm MIN GOLD OVER 1.27µm MIN NICKEL  
COMPLIANT PIN AREA - 0.5µm MIN MATTE TIN OVER 1.27µm MIN NICKEL  
SHIELD: 1.27µm MIN NICKEL
- △ FINISH: CONTACT MATING AREA 0.076µm MIN GOLD OVER 0.68µm PdNi (TOTAL 0.76µm MIN) OVER 1.27µm NICKEL. COMPLIANT PIN AREA 0.5µm MIN MATTE TIN OVER 1.27µm MIN NICKEL. SHIELD: 1.27µm MIN NICKEL.
- △ SHOWN LOGO OR OTHER TE OWNED LOGOS IN APPROXIMATE AREA

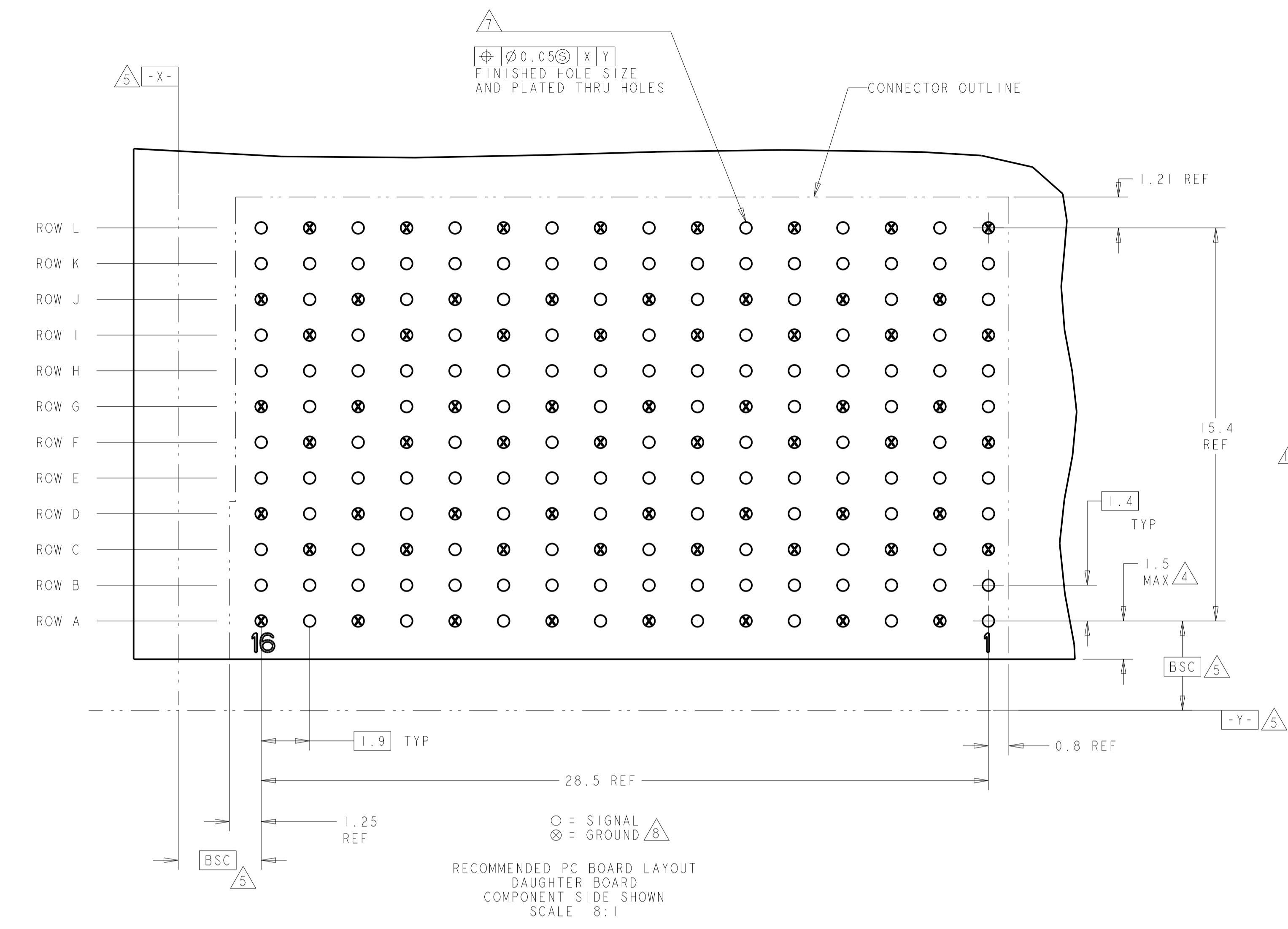

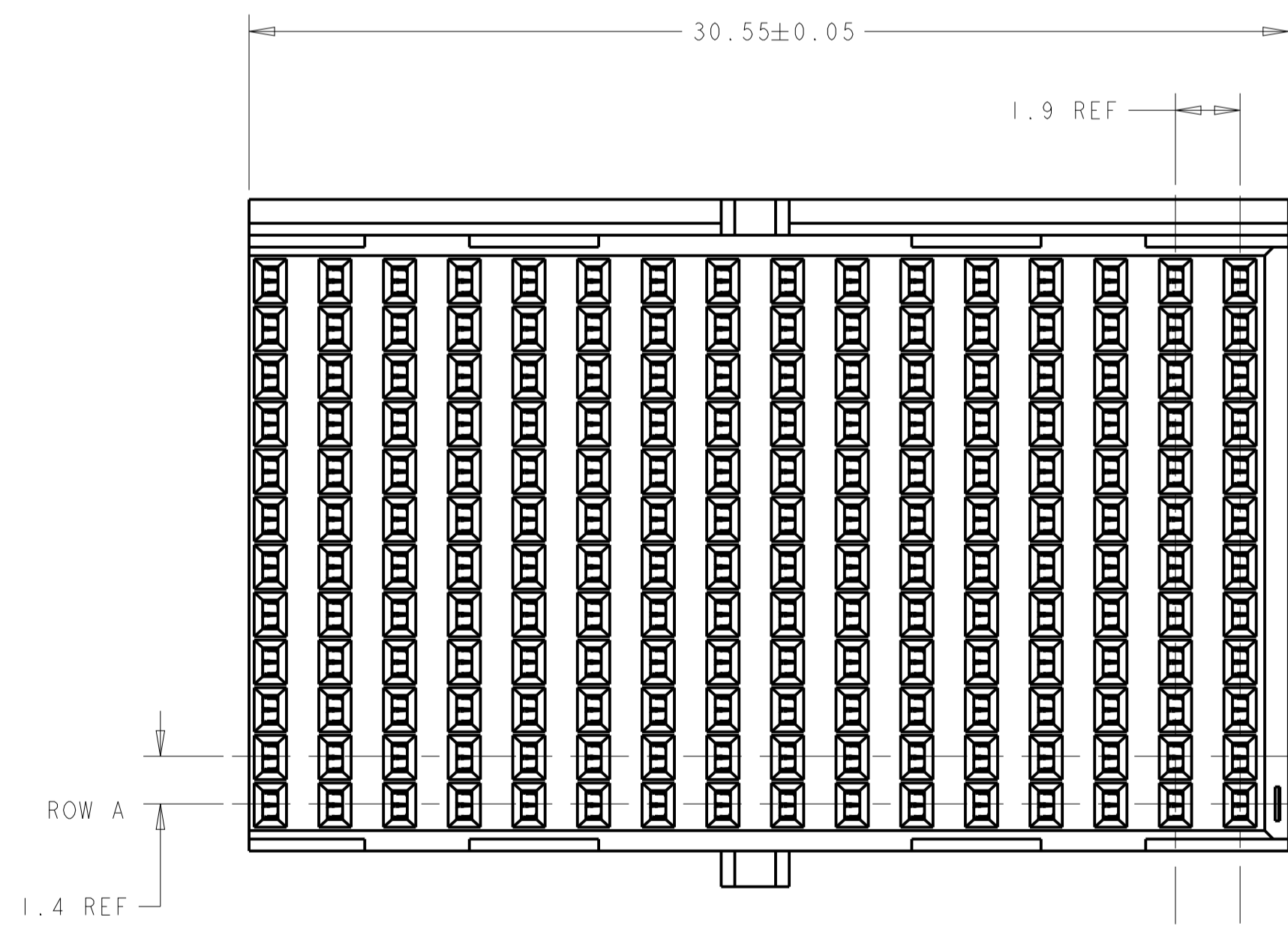
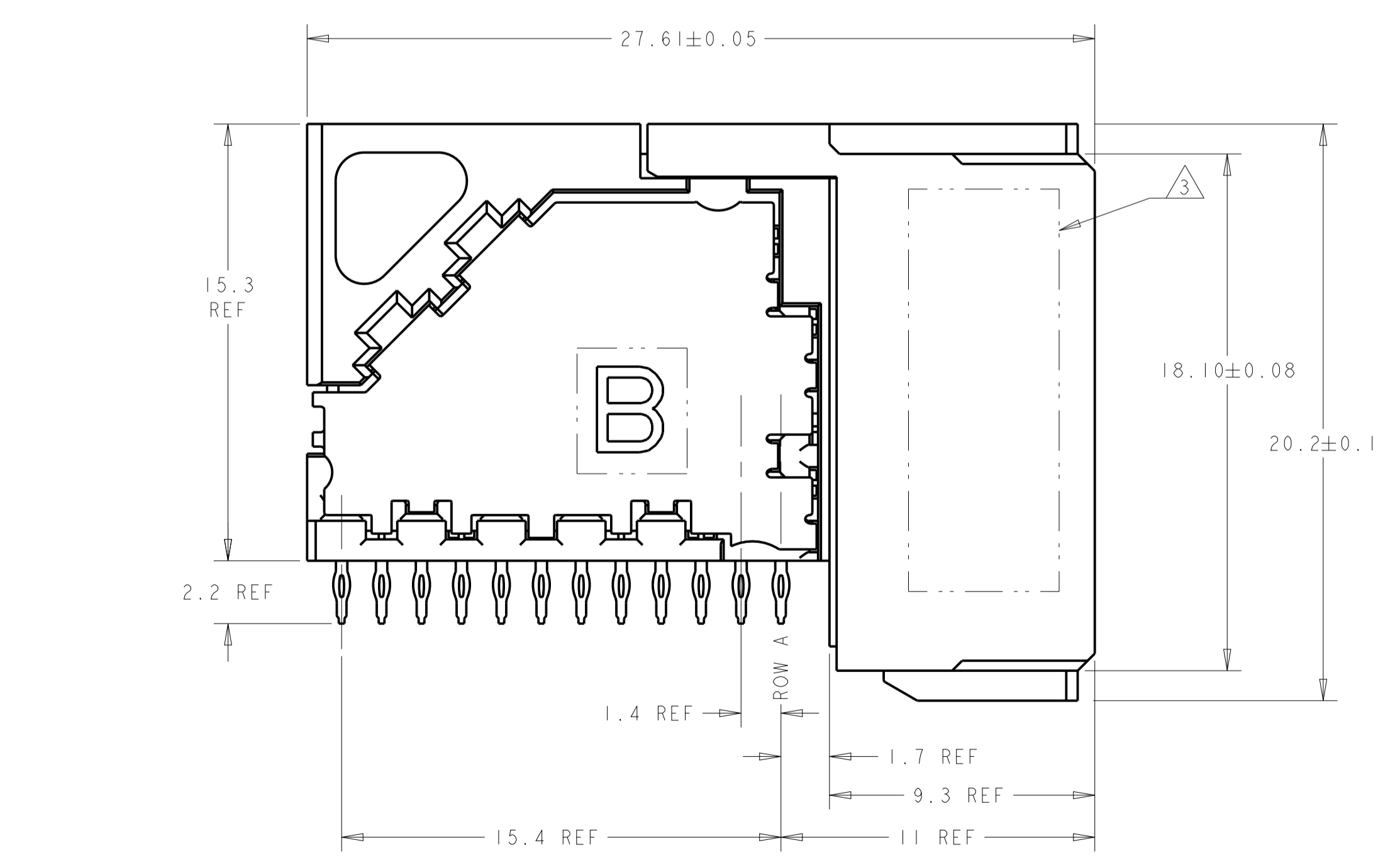
△10	2065783-3
△9	2065783-2
△2	2065783-1
FINISH	PART NUMBER

THIS DRAWING IS A CONTROLLED DOCUMENT.

OWN: B. CARBO 21MAY2009  
 CHK: R. PATTERSON 21MAY2009  
 APVD: R. PATTERSON 21MAY2009

TE Connectivity

RECEPTACLE ASSEMBLY, 4 PAIR, 16 COLUMN

SIZE: A100779 C=2065783

SCALE: 6:1 SHEET 1 OF 1 REV G

DIMENSIONS:	TOLERANCES UNLESS OTHERWISE SPECIFIED:
mm	0 PLC ±
	1 PLC ±
	2 PLC ±
	3 PLC ±
	4 PLC ±
	ANGLES ±

MATERIAL: SEE TABLE

FINISH: SEE TABLE

WEIGHT: -

CUSTOMER DRAWING