

REVISIONS				
P	LTR	DESCRIPTION	DATE	APPROV
C		REV PER ECO 20-015430	5-25-21	CT RL

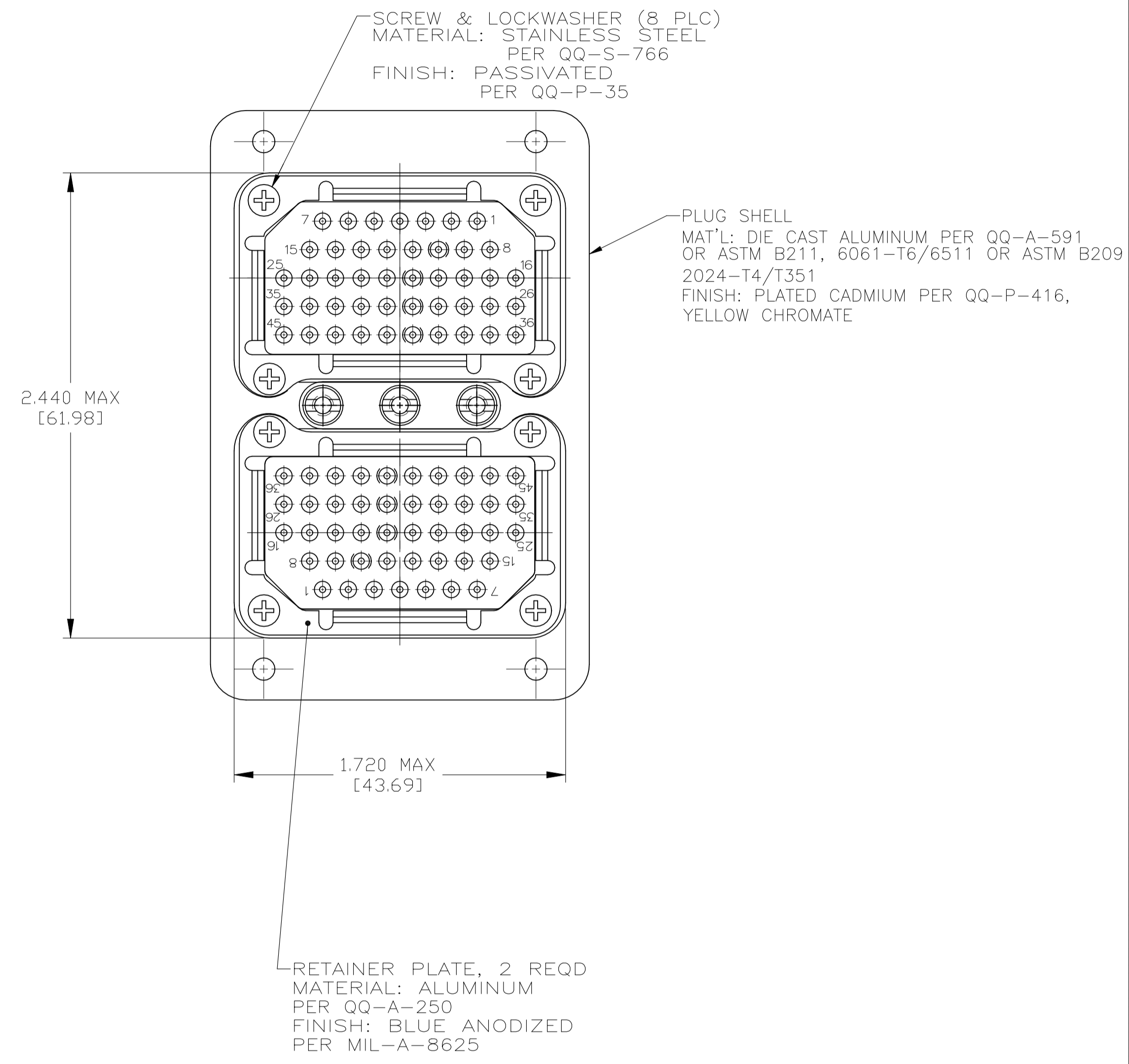
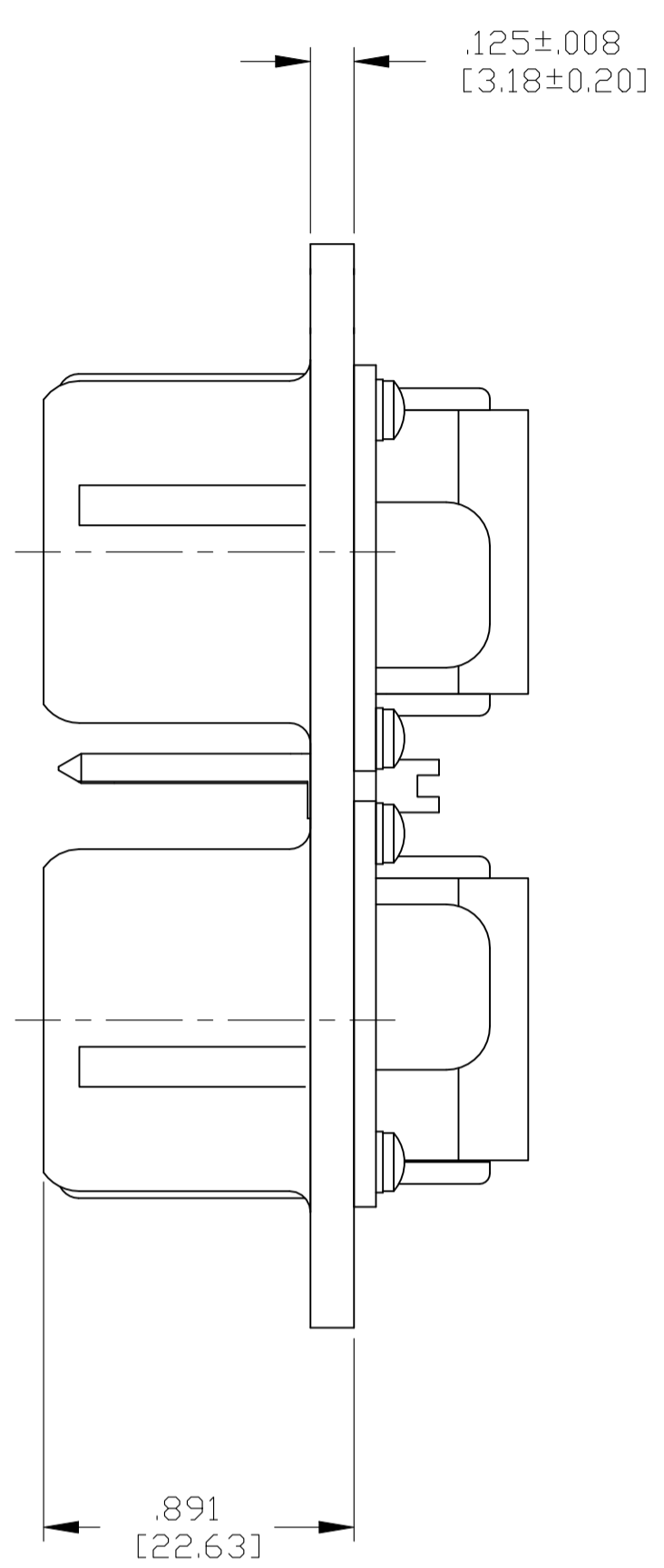
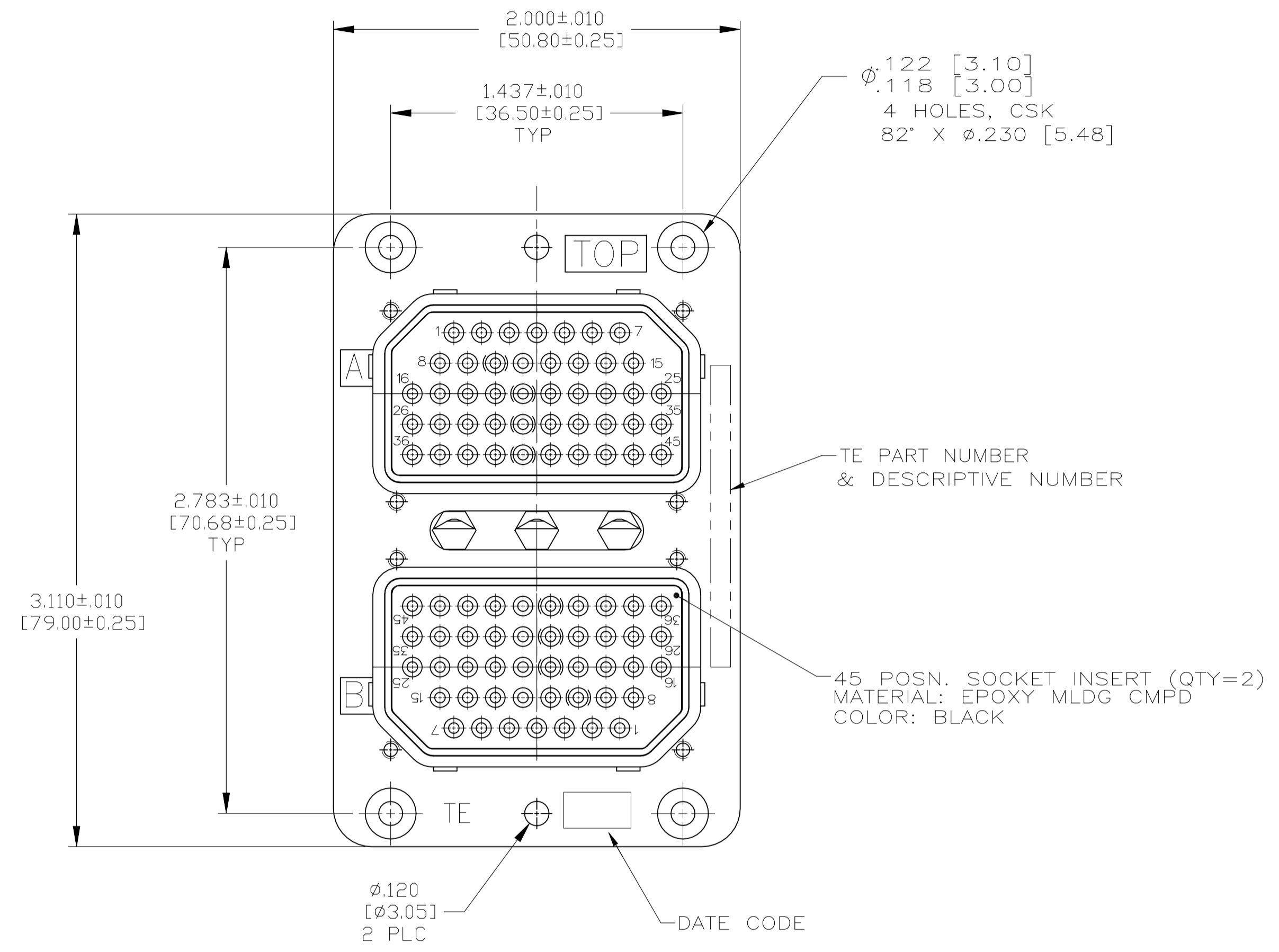

SEALING PLUG;
 SIZE #20 (QTY=14)
 MAT'L: FEP-100
 FINISH: COLOR RED

SOCKET; SIZE #20 (QTY=90)
 MAT'L: Be Cu PER ASTM-B-196
 FINISH: GOLD PER MIL-G-45204
 OVER NICKEL PER QQ-N-290
 HOOD: STAINLESS STEEL, PASSIVATED

INS/EXT TOOL
 QTY = 1

1. SEALING PLUGS, CONTACTS & INS/EXT TOOL ARE PACKAGED SEPARATELY AND SHIPPED WITH CONNECTOR.
 2. KEYING SHOWN IN POSITION "01" FOR REFERENCE ONLY.
 SEE TABLE FOR KEYING POSITION.
 FOR POSITION "00" KEYING SHIPPED UNASSEMBLED.

KEYING POSITION	DESCRIPTIVE NUMBER	PART NUMBER
04	RME2P45S45S-0004 (200)	208324-2
01	RME2P45S45S-0001 (200)	208324-1

THIS DRAWING IS A CONTROLLED DOCUMENT.

DIMENSIONS: INCHES	TOLERANCES UNLESS OTHERWISE SPECIFIED:	0 PLC ± -	1 PLC ± -	2 PLC ± -	3 PLC ± .005 [0.13]	4 PLC ± -	ANGLES ± -
MATERIAL SEE CALLOUTS	FINISH SEE CALLOUTS	WEIGHT 0.000000	SIZE A1	CAGE CODE 00779	DRAWING NO C=208324	RESTRICTED TO -	

CUSTOMER DRAWING SCALE 2:1 SHEET 1 of 1 REV C

APPROVED: D. FARY
 DATE: 6-24-08
 NAME: PLUG ASSY, ARINC 404

TE Connectivity