

LOC	DIST	REVISIONS			
P	LTN	DESCRIPTION	DATE	DWN	APVD
GP	00	A	INITIAL RELEASE	31JAN2013	JY AC

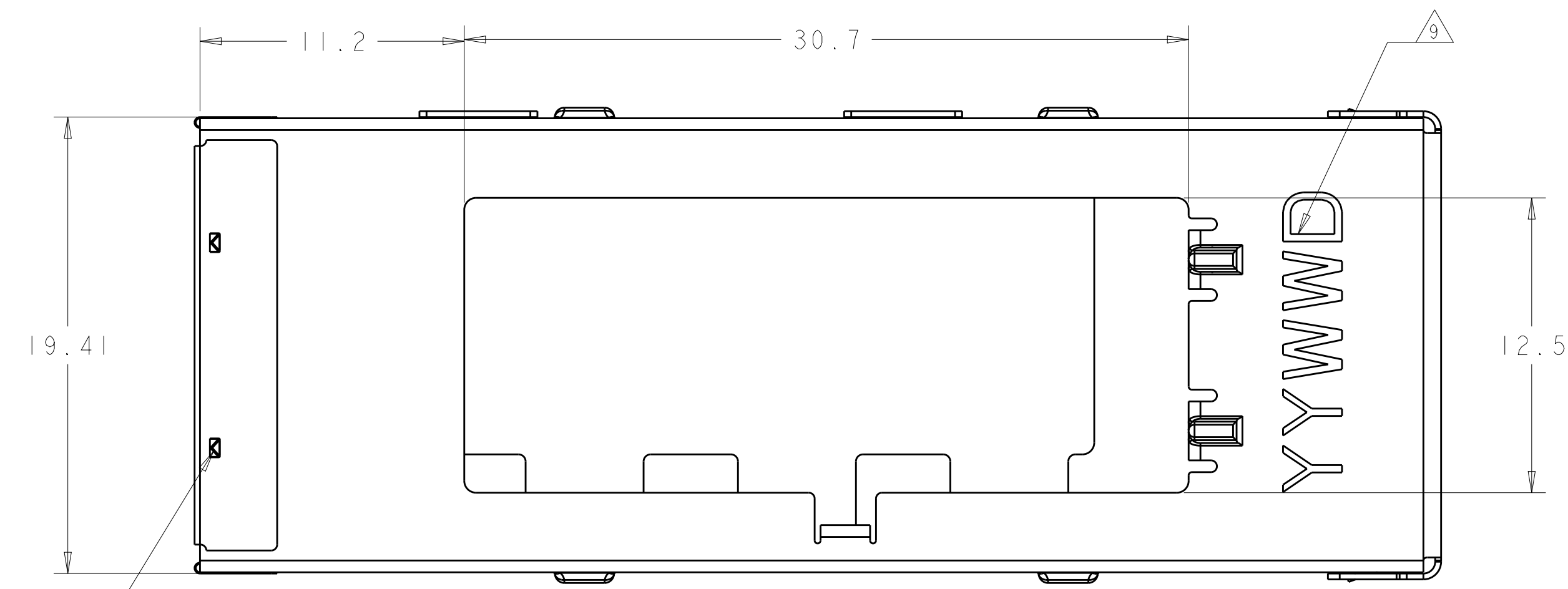

Sn42Bi58 SOLDER  
6 PLACES

- △ CAGE MATERIAL: NICKEL SILVER, 0.25 THICK  
EMI SPRING MATERIAL: COPPER ALLOY
- △ MINIMUM PITCH DIMENSION.
- 3. MATES WITH QSFP MSA COMPATIBLE TRANSCEIVER.
- △ REFERENCE APPLICATION SPEC 114-13218 FOR RECOMMENDED DRILL HOLE DIAMETER AND PLATING THICKNESS.
- △ DATUMS AND BASIC DIMENSIONS ESTABLISHED BY CUSTOMER.
- △ DIMENSION C IS THE NOMINAL THICKNESS OF CUSTOMER SUPPLIED PC BOARD.  
SINGLE SIDED PC BOARD MINIMUM THICKNESS: 1.45  
DOUBLE SIDED PC BOARD MINIMUM THICKNESS: 2.7.
- △ DATUM -A- IS TOP SURFACE OF HOST BOARD.
- △ SURFACE TRACES PERMITTED WITHIN THIS AREA EXCEPT WHERE CAGE STANDOFFS, SHOWN IN DETAIL J, CONTACT PC BOARD.
- △ DATE CODE (YYWWD) MARKED ON TOP OF CAGE AND CONCEALED BY HEAT SINK APPLIES TO CAGE ASSEMBLY ONLY.
- △ EMI SPRING FINISH: 2µm MIN TIN.
- 11. PRODUCT HAS NOT COMPLETED QUALIFICATION TESTING.

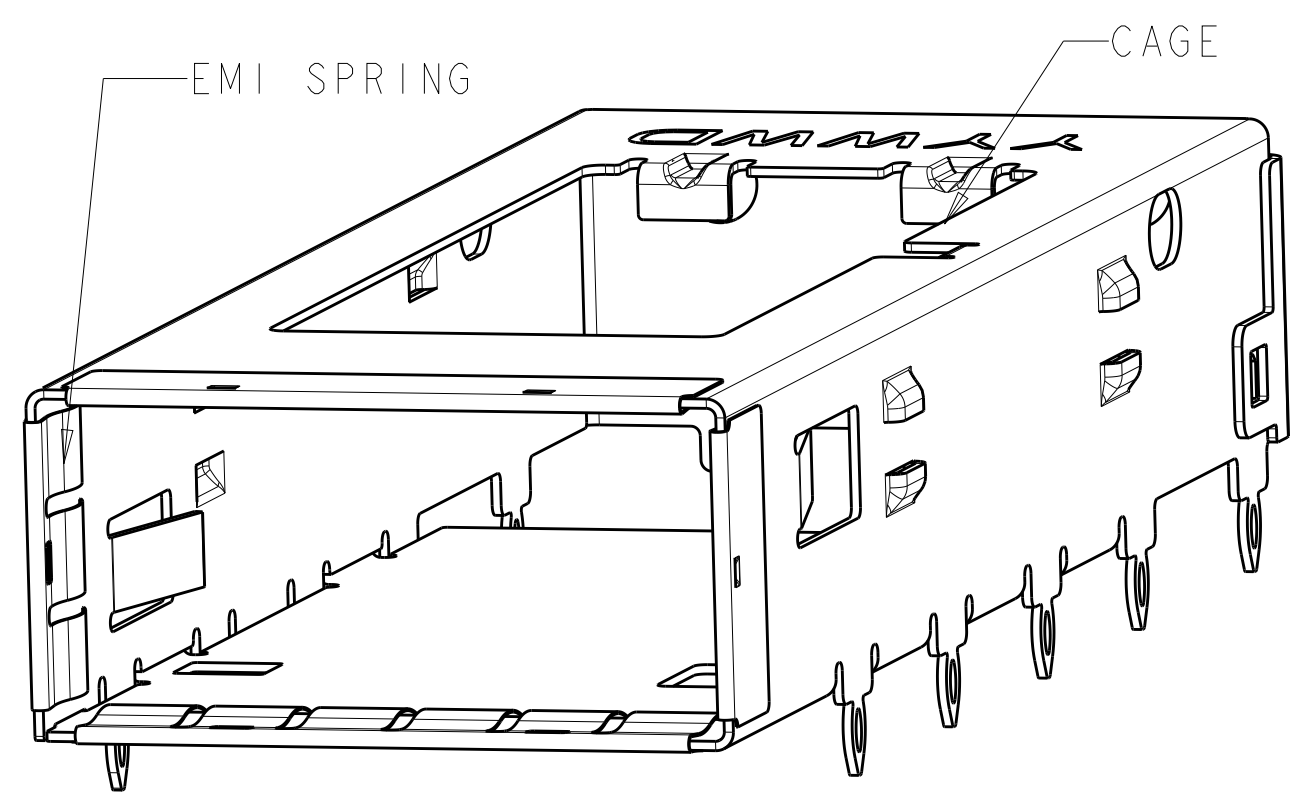
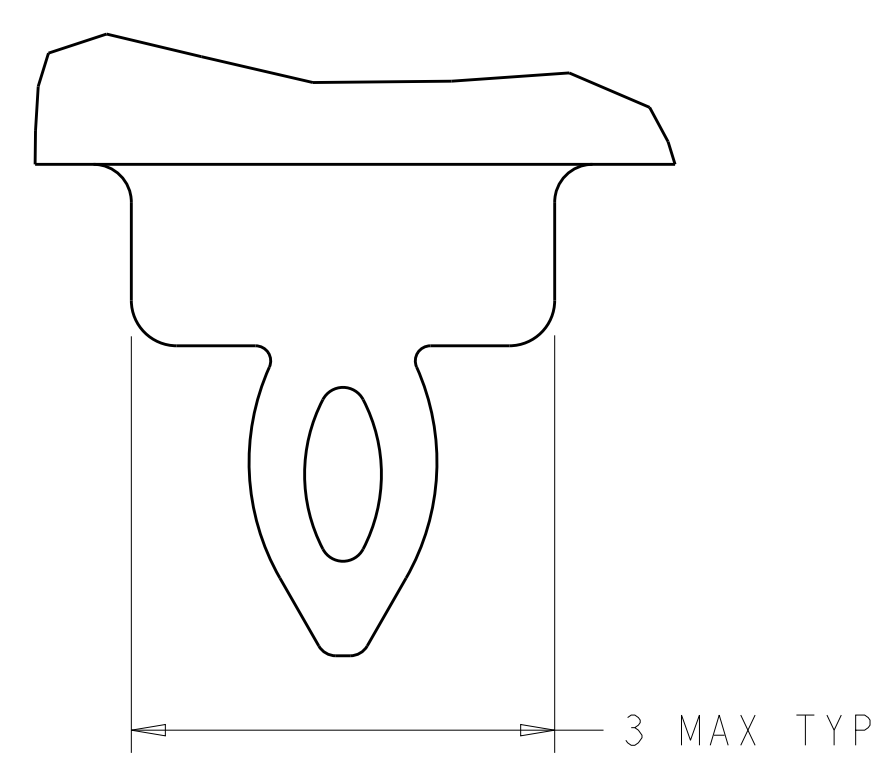
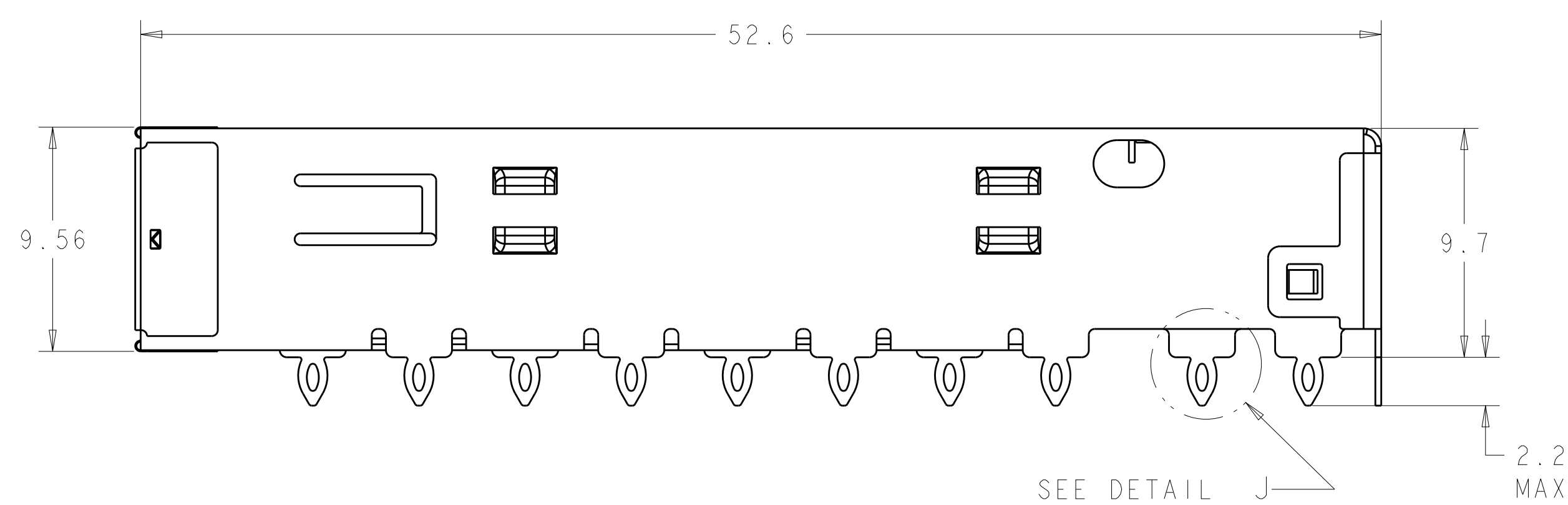
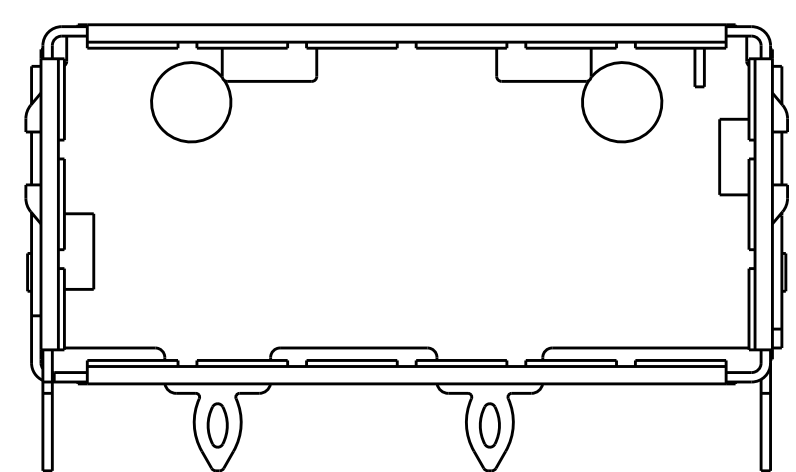

DETAIL J  
SCALE 20:1

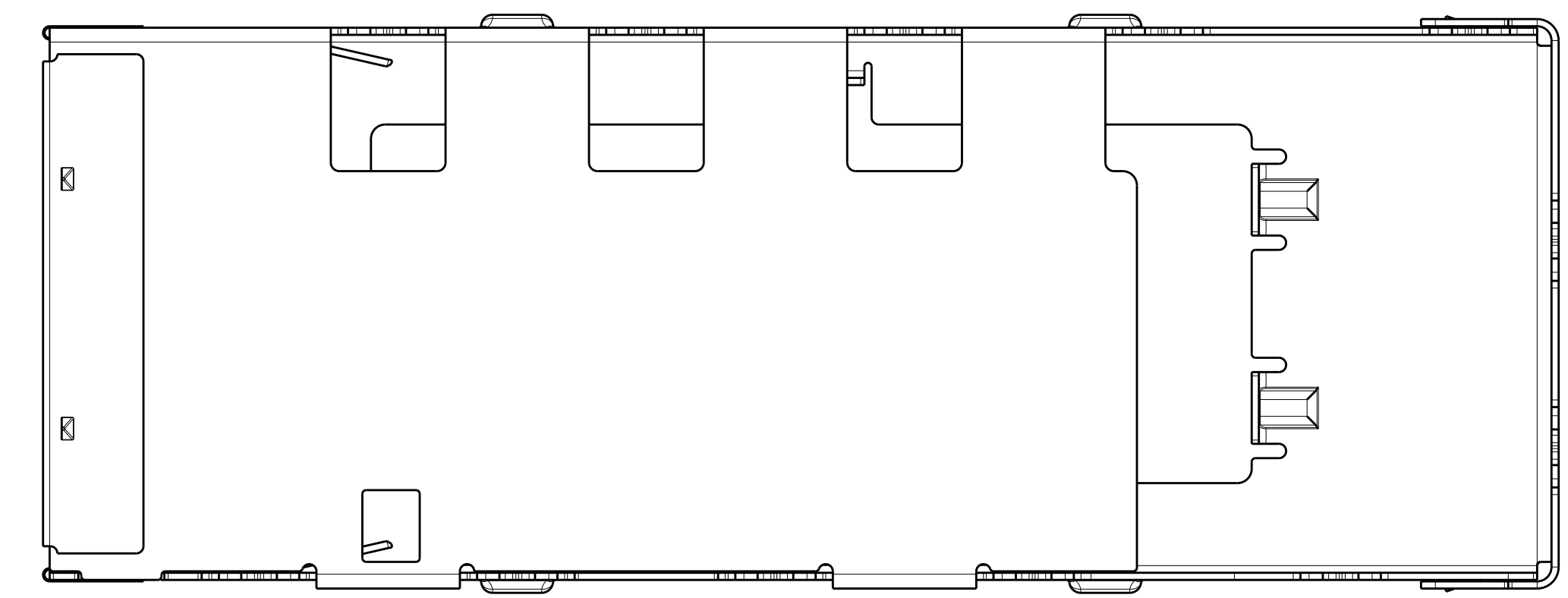

2170398-1  
PART NUMBER

THIS DRAWING IS A CONTROLLED DOCUMENT.		DWN: JASON YANG 21AUG2012	TE Connectivity	
DIMENSIONS:		CHK: ALEX CAI 21AUG2012		
TOLERANCES UNLESS OTHERWISE SPECIFIED:		APVD: ALEX CAI 21AUG2012	NAME: 1X1 QSFP, CAGE ASSEMBLY W/O FLANGE	
mm	0 PLC ±	PRODUCT SPEC	SIZE: CAGE CODE DRAWING NO	
	1 PLC ±0.25	108-2286	RESTRICTED TO	
	2 PLC ±0.15	APPLICATION SPEC	A100779C=2170398	
	3 PLC ±	114-13218	SCALE 5:1 SHEET 1 OF 4 REV A	
	4 PLC ±	WEIGHT	Customer Drawing	
	ANGLES ±			
MATERIAL	FINISH			

LOC	DIST	REVISIONS					
GP	00	P	LTN	DESCRIPTION	DATE	DWN	APVD
-	-	-	-	SEE SHEET 1	-	-	-

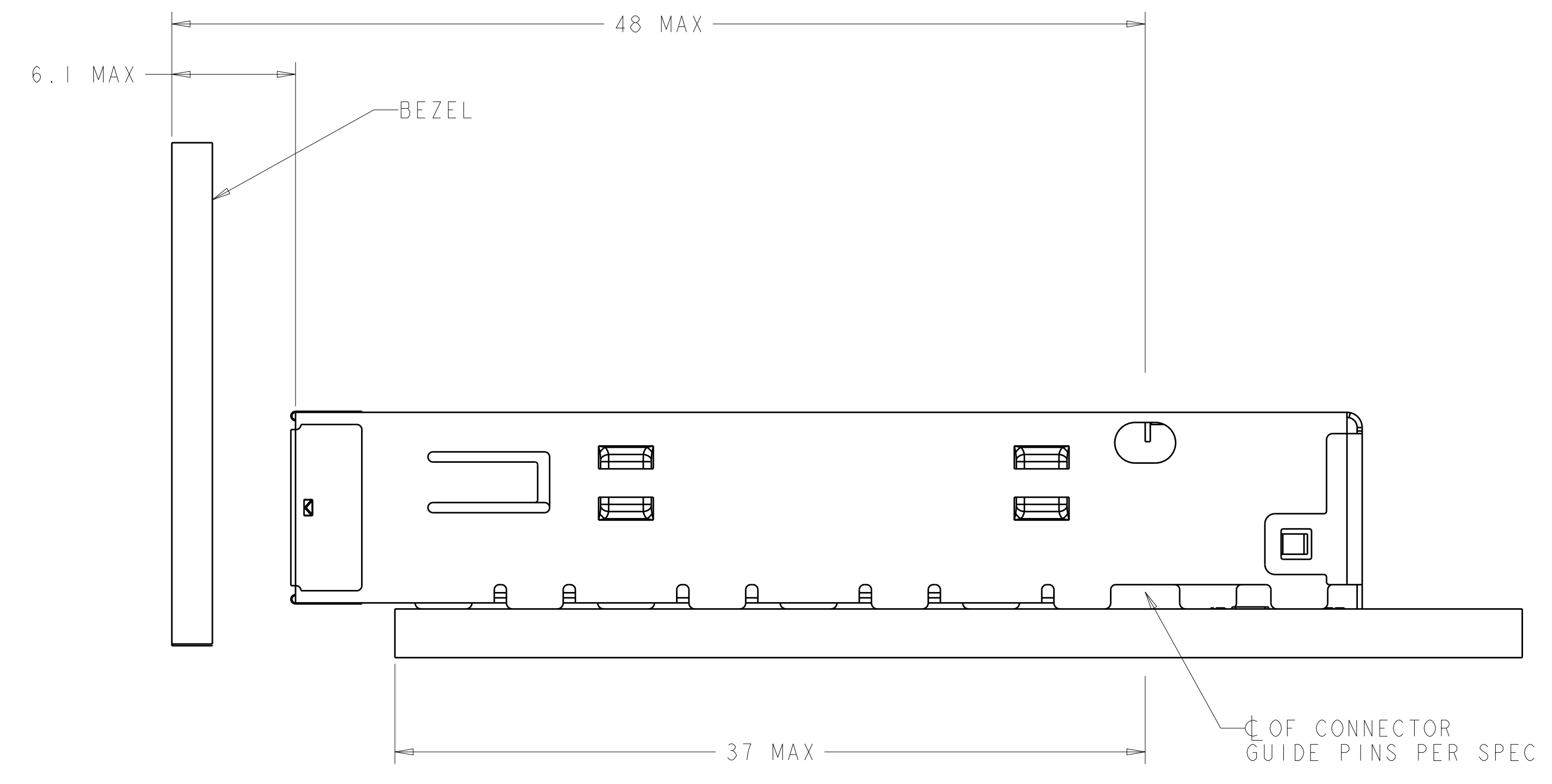
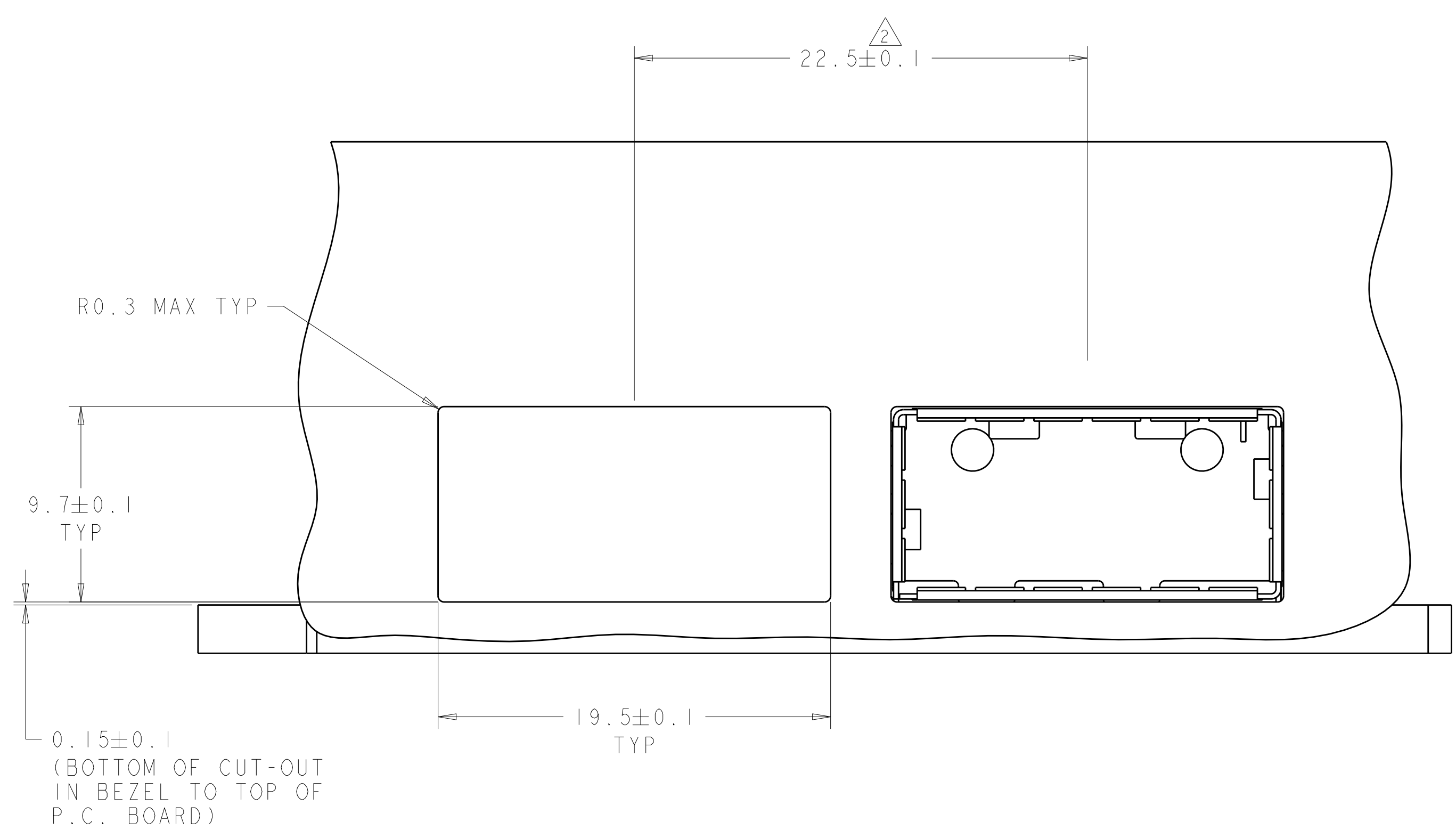

ONE SIDED CONFIGURATION

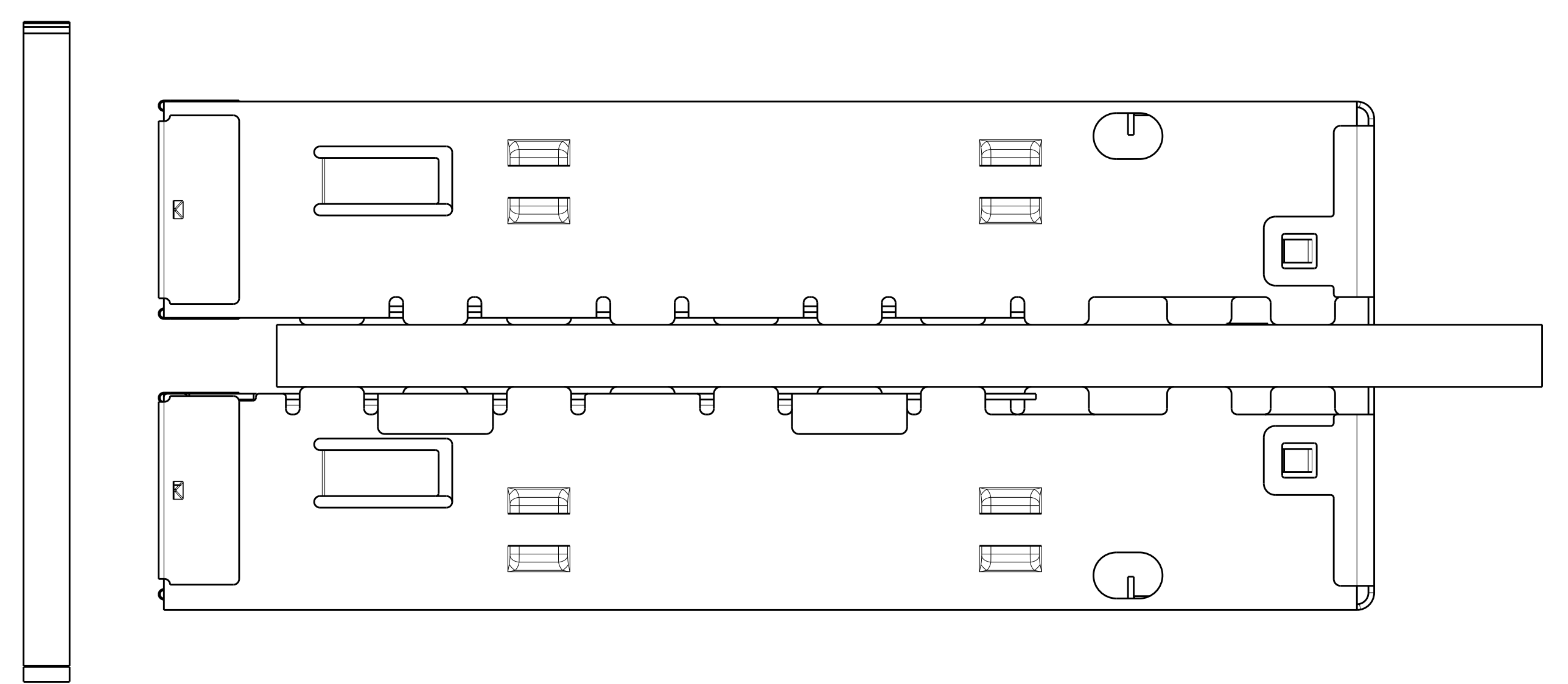
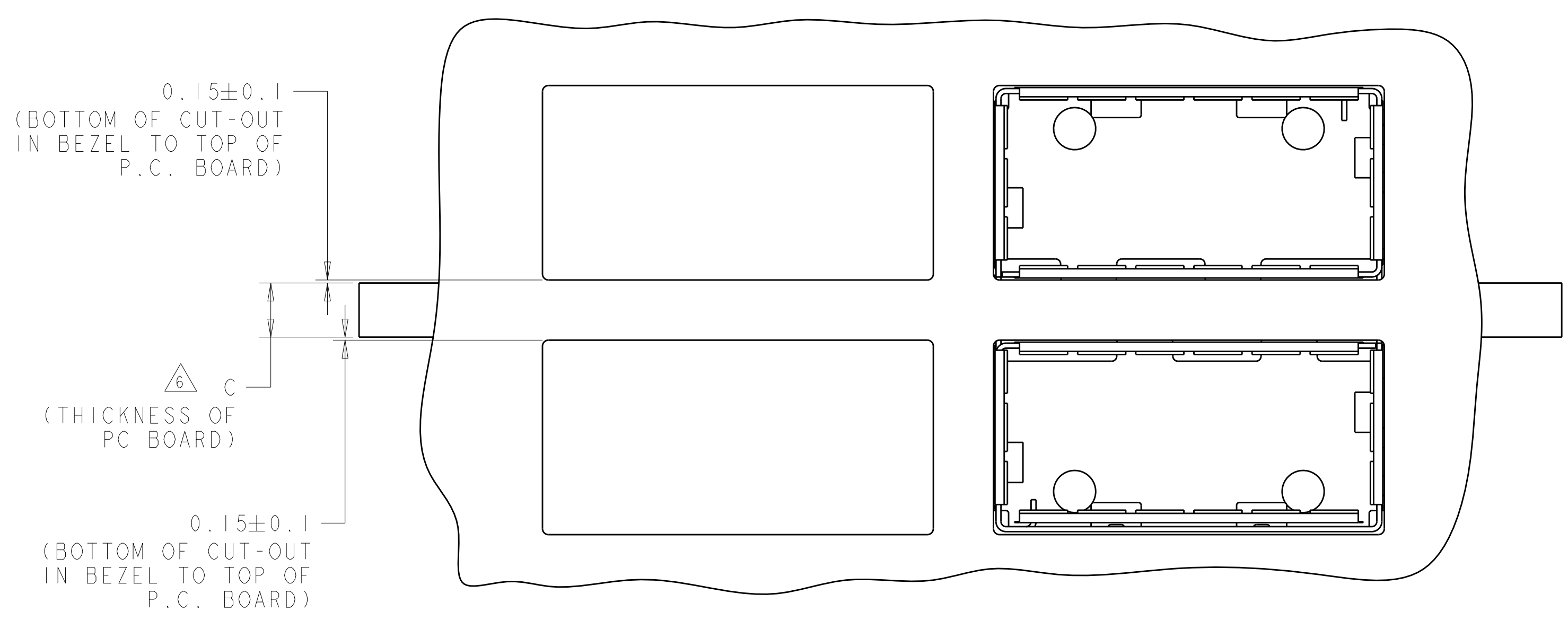

BELLY TO BELLY CONFIGURATION  
 SIMILAR TO ONE SIDED EXCEPT  
 WHERE NOTED

THIS DRAWING IS A CONTROLLED DOCUMENT.		DWN: JASON YANG 21AUG2012	 TE Connectivity
DIMENSIONS: mm		CHK: ALEX CAI 21AUG2012	
TOLERANCES UNLESS OTHERWISE SPECIFIED:		APVD: ALEY CAI 21AUG2012	NAME: IXI QSFP, CAGE ASSEMBLY W/O FLANGE
0 PLC ±	1 PLC ±0.25	PRODUCT SPEC: 108-2286	SIZE: A1
2 PLC ±0.15	3 PLC ±	APPLICATION SPEC: 114-13218	CAGE CODE: 2170398
4 PLC ±	ANGLES ±	WEIGHT: -	RESTRICTED TO: -
MATERIAL: -	FINISH: -	Customer Drawing	SCALE: 5:1
		SHEET: 2 OF 4	REV: A

LOC	DIST	REVISIONS					
GP	00	P	LTN	DESCRIPTION	DATE	DWN	APVD
		-		SEE SHEET 1			

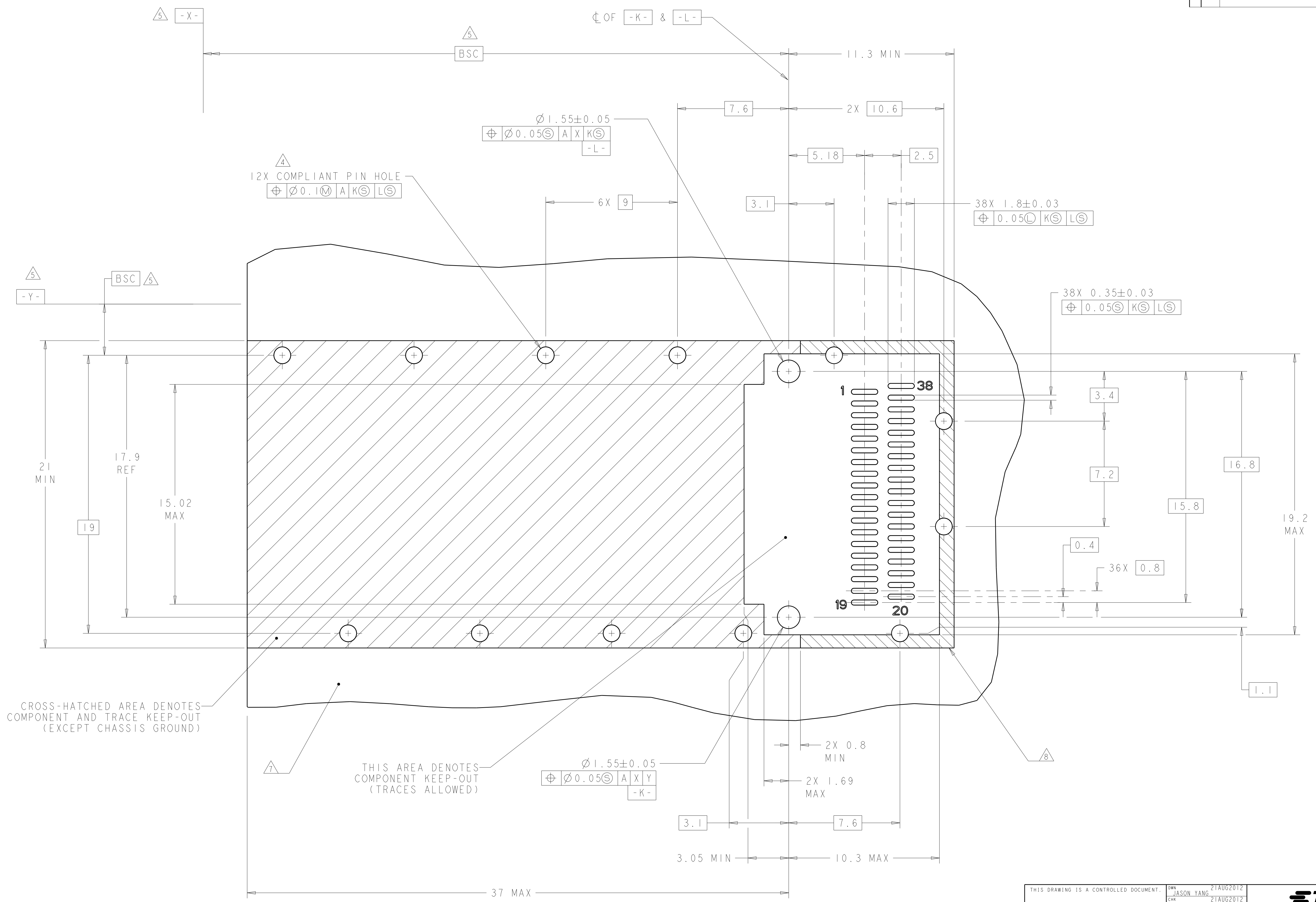

CROSS-HATCHED AREA DENOTES COMPONENT AND TRACE KEEP-OUT (EXCEPT CHASSIS GROUND)

THIS AREA DENOTES COMPONENT KEEP-OUT (TRACES ALLOWED)

Ø 1.55±0.05  
 ⊕ Ø 0.05 S | A X Y  
 -K-

RECOMMENDED PCB LAYOUT  
 SINGLE SIDED CONFIGURATION  
 TOLERANCE: ±0.05  
 SCALE 8:1

THIS DRAWING IS A CONTROLLED DOCUMENT.		DWN: JASON YANG 21AUG2012	TE Connectivity
DIMENSIONS: mm		CHK: ALEX CAI 21AUG2012	
TOLERANCES UNLESS OTHERWISE SPECIFIED:		APVD: ALEX CAI 21AUG2012	NAME: IXI QSFP, CAGE ASSEMBLY W/O FLANGE
0 PLC	±	PRODUCT SPEC	SIZE: CAGE CODE DRAWING NO
1 PLC	±0.25	108-2286	RESTRICTED TO
2 PLC	±0.15	APPLICATION SPEC	A100779C=2170398
3 PLC	±	114-13218	SCALE 4:1 SHEET 3 OF 4 REV A
4 PLC	±	WEIGHT	
ANGLES	±	Customer Drawing	