

LOC	DIST	REVISIONS					
GP	00	#	LY#	DESCRIPTION	DATE	OWN	APVD
		1		PRELIMINARY	24SEP2013	ZJ	JY
		A		ACTIVE THE DRAWING	31DEC2013	ZJ	JY
		B		REVISED PER ECO-15-005721	4AUG2015	RG	SH
		D		REVISED PER ECO-19-004279	20MAR2019	TX	SH

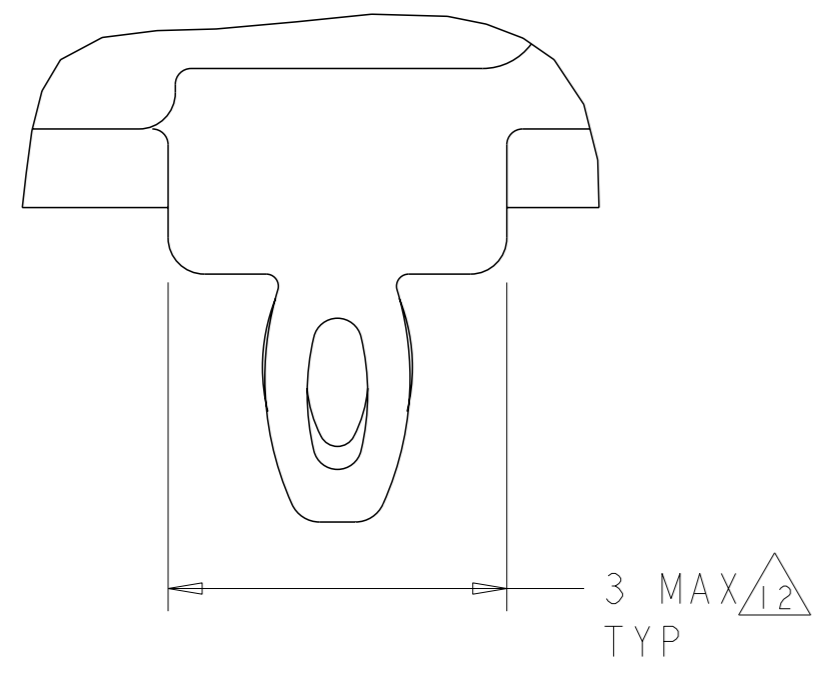

DETAIL S
SCALE 16:1

- 1. CAGE ASSEMBLY MATERIAL: NICKEL SILVER, 0.25 THICK
- HEAT SINK MATERIAL: ALUMINUM
- HEAT SINK CLIP MATERIAL: STAINLESS STEEL
- EMI SPRING MATERIAL: COPPER ALLOY
- FRONT FLANGE MATERIAL: ZINC ALLOY
- 2. PITCH BETWEEN PORTS OF ONE 1X4 CAGE ASSEMBLY.
- 3. SPACING BETWEEN CAGES ON THE SAME PC BOARD, TO BE SPECIFIED BY CUSTOMER, MUST COMPLY WITH MINIMUM DIMENSIONS SHOWN.
- 4. REFERENCE APPLICATION SPEC 114-13218 FOR RECOMMENDED DRILL HOLE DIAMETER AND PLATING THICKNESS.
- 5. DATUMS AND BASIC DIMENSIONS ESTABLISHED BY CUSTOMER.
- 6. DIMENSION C IS THE NOMINAL THICKNESS OF CUSTOMER SUPPLIED PC BOARD, SINGLE SIDED PC BOARD MINIMUM THICKNESS = 1.45mm, DOUBLE SIDED PC BOARD MINIMUM THICKNESS = 2.2mm PER QSFP.
- 7. HEAT SINKS AND CLIPS SHIPPED ASSEMBLED TO CAGE ASSEMBLY. CAGE ASSEMBLY MAY BE PRESSED INTO THE PCB AS SHIPPED.
- 8. DATUM -A- IS TOP SURFACE OF PC BOARD.
- 9. DIMENSION APPLIES WITH MODULE INSERTED IN CAGE.
- 10. UNPLATED THRU HOLE.

- 11. MATES WITH QSFP MSA COMPATIBLE TRANSCEIVER.
- 12. SURFACE TRACES PERMITTED WITHIN THIS AREA EXCEPT WHERE CAGE STANDOFFS, SHOWN IN DETAIL A AND S, CONTACT PC BOARD.
- 13. BASELINE FOR THESE DIMENSIONS IS THE CENTER OF COMPLIANT PIN HOLE.
- 14. 2D BARCODE AND DATE CODE (YYWW) MARKED ON SIDE OF CAGE.
- 15. REFERENCE APP SPEC 114-13218 FOR GASKET THICKNESS CALCULATION.
- 16. EMI SPRING FINISH: 2µm MINIMUM TIN
FRONT FLANGE FINISH: 3µm MINIMUM TIN OVER 1.27µm MINIMUM NICKEL OVER 5.08µm MINIMUM COPPER.
HEAT SINK FINISH: NICKEL.

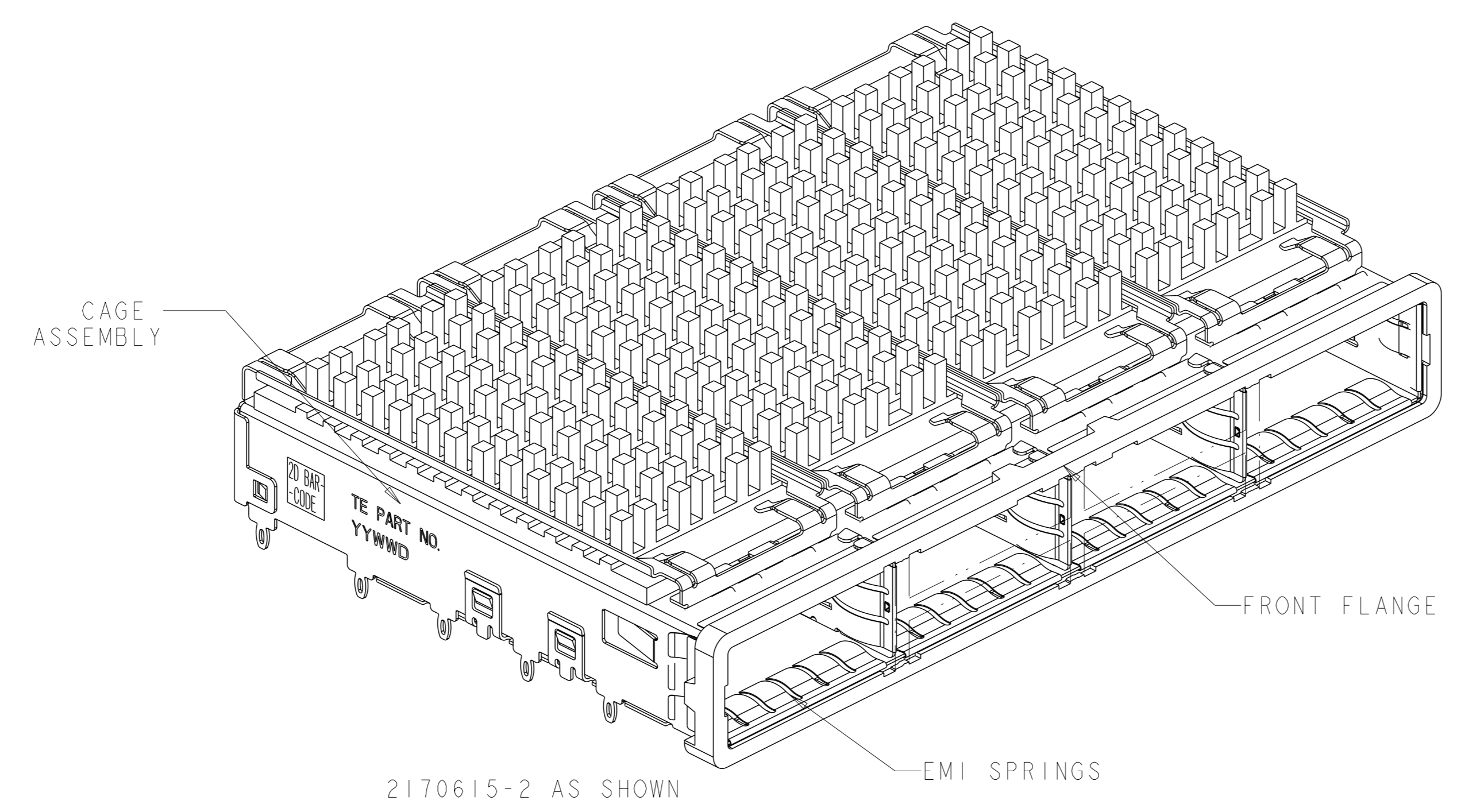
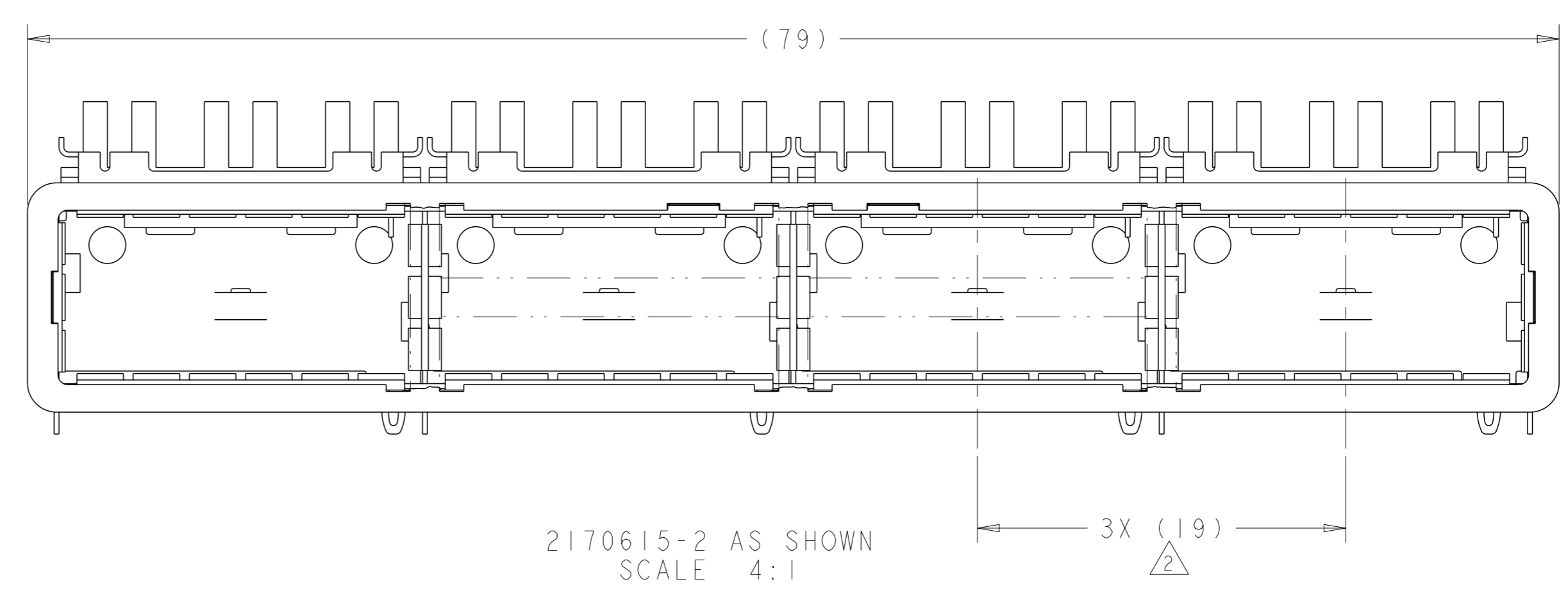
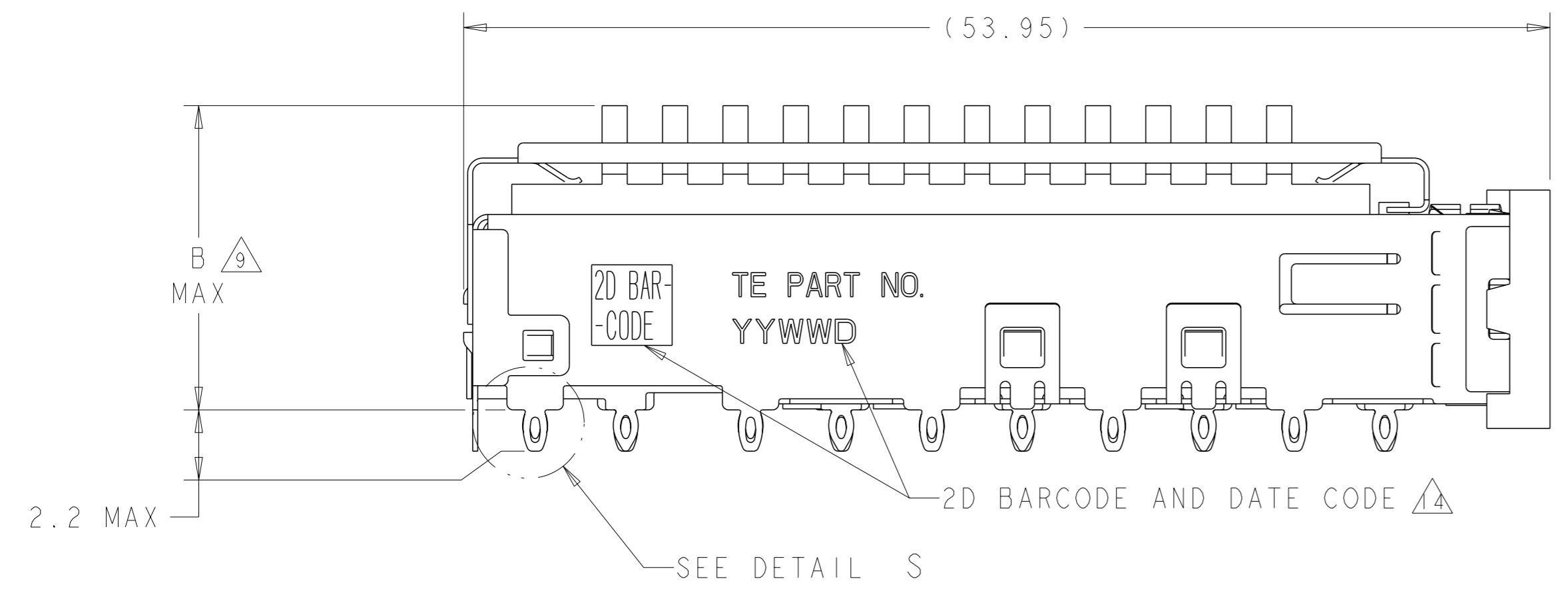

23.0	NETWORKING	2170615-4
16.0	SAN	2170615-2
13.7	PCI	2170615-1
B	HEAT SINK PROFILE	PART NUMBER

THIS DRAWING IS A CONTROLLED DOCUMENT. OWN: ZJ, CHK: JY, APVD: MC, DATE: 24SEP2013

DIMENSIONS: mm. TOLERANCES UNLESS OTHERWISE SPECIFIED: 0 PLC ±, 1 PLC ±0.1, 2 PLC ±0.1, 3 PLC ±, 4 PLC ±, ANGLES FINISH ±.

MATERIAL: 1. FINISH: 16.

Customer Drawing

TE Connectivity

NAME: 1X4 CAGE ASSEMBLY, BEHIND BEZEL, W/ HEAT SINKS, QSFP

PRODUCT SPEC: 108-2286

APPLICATION SPEC: 114-13218

SIZE: A1, CAGE CODE: 00779, DRAWING NO: 2170615, RESTRICTED TO: -

SCALE: 1:1, SHEET: 1 OF 6, REV: D

LOC	DIST	REVISIONS					
GP	00	P	LYR	DESCRIPTION	DATE	OWN	APVD
		-		SEE SHEET 1	-	-	-

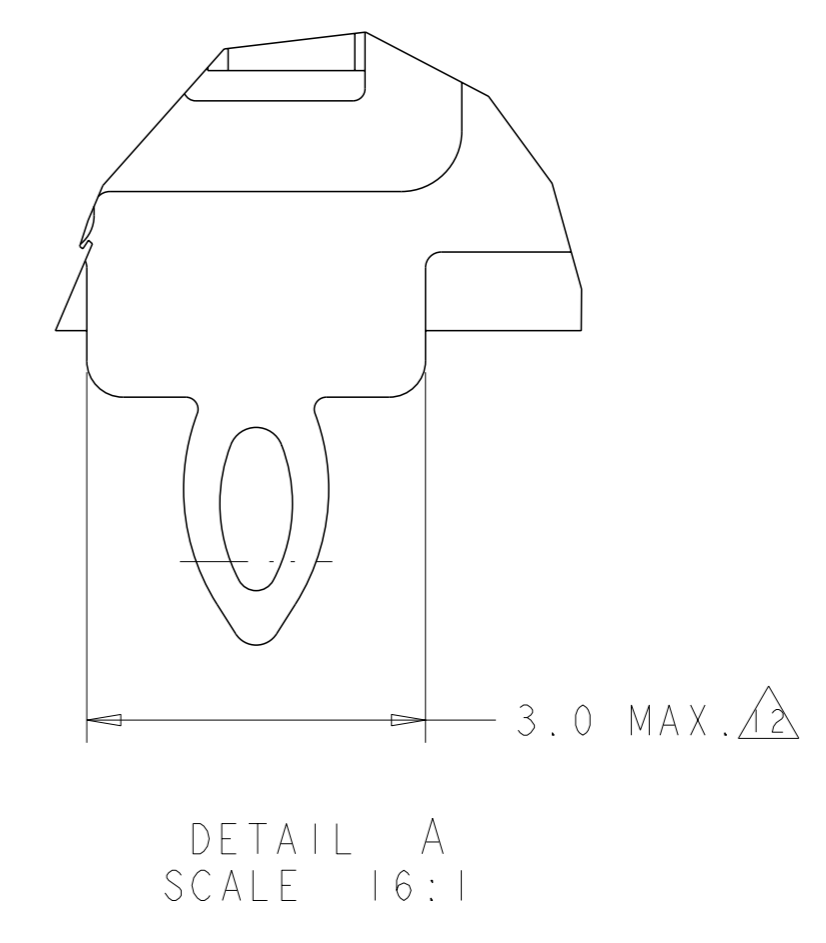
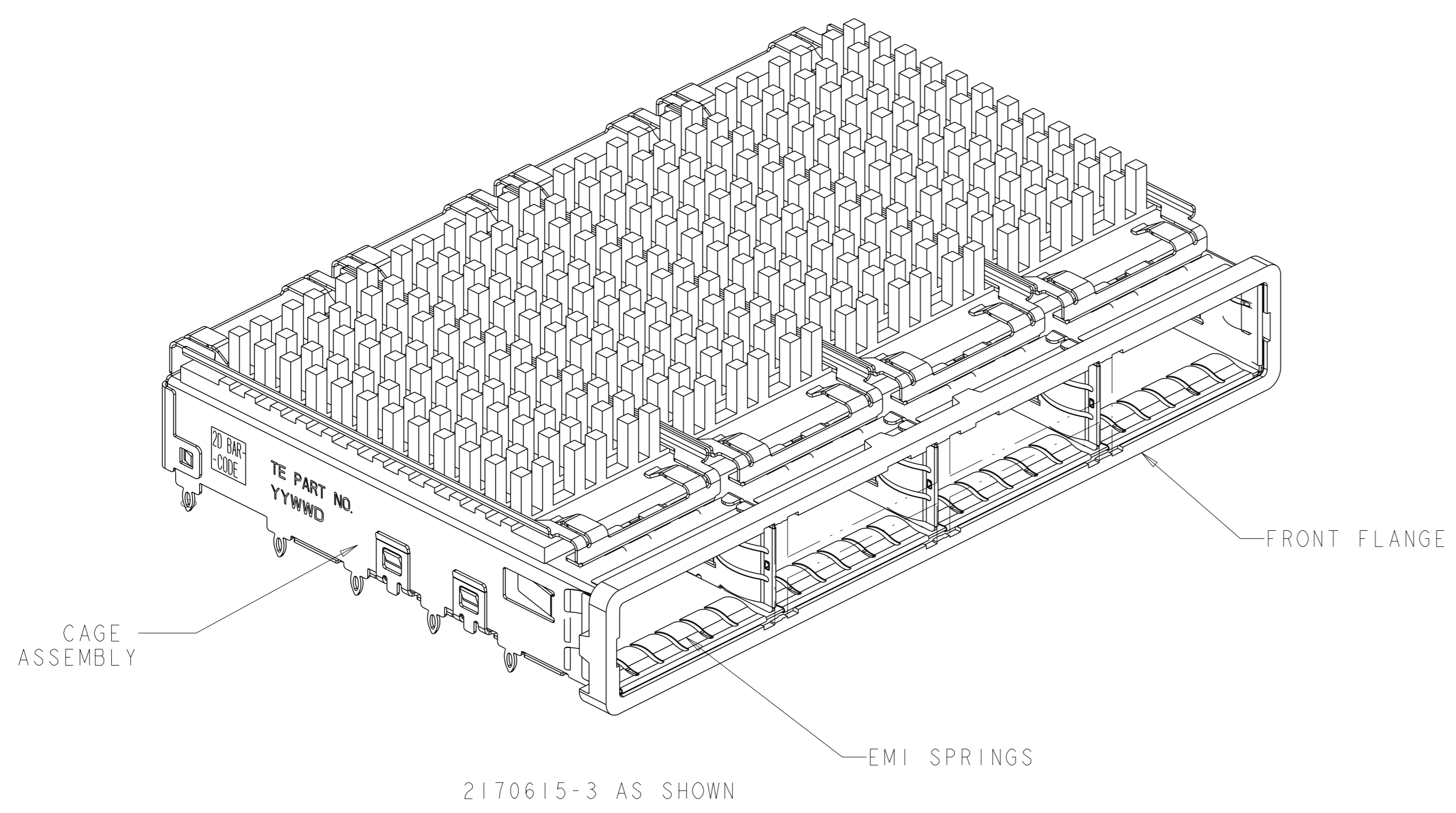
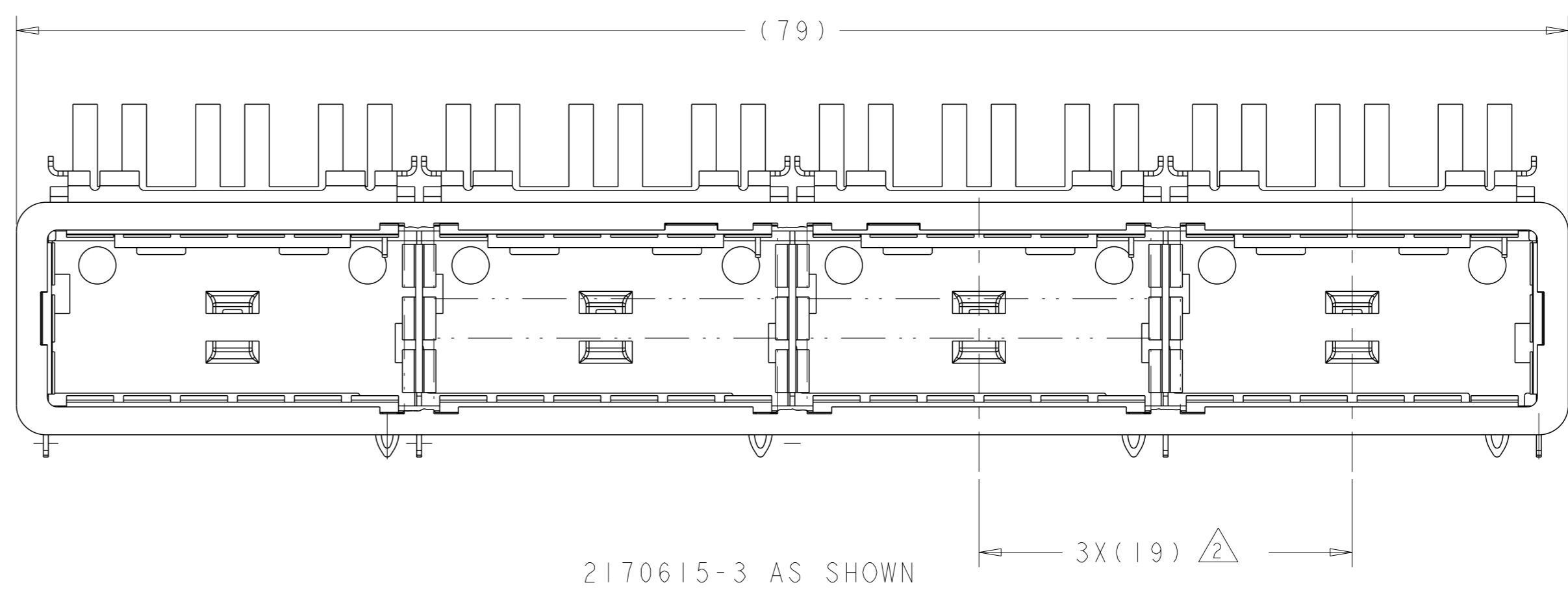
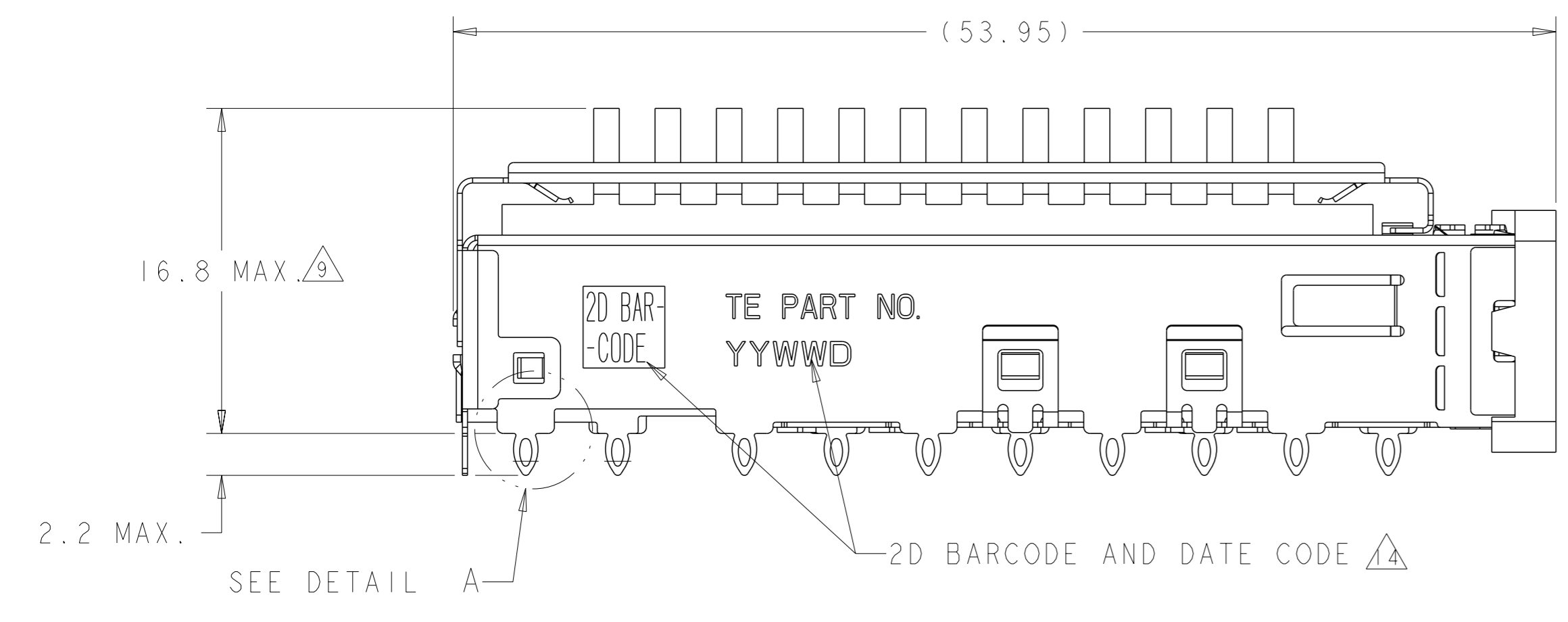

CUSTOMIZED	2170615-3
HEAT SINK PROFILE	PART NUMBER

THIS DRAWING IS A CONTROLLED DOCUMENT.		OWN	ZJ	24SEP2013	TE Connectivity NAME 1X4 CAGE ASSEMBLY, BEHIND BEZEL, W/ HEAT SINKS, QSFP			
DIMENSIONS:		CHK	JY	24SEP2013				
TOLERANCES UNLESS OTHERWISE SPECIFIED:		APVD	MC	24SEP2013				
mm		PRODUCT SPEC						
0 PLC	±	108-2286			SIZE	CAGE CODE	DRAWING NO.	RESTRICTED TO
1 PLC	±0.1	APPLICATION SPEC			A1	00779	2170615	
2 PLC	±0.1	114-13218			SCALE	1:1	SHEET	2
3 PLC	±				OF	6	REV	D
4 PLC	±							
ANGLES	±							
FINISH	±							
MATERIAL		WEIGHT			Customer Drawing			

LOC		DIST		REVISIONS			
GP	00	P	LYR	DESCRIPTION	DATE	OWN	APVD
		-		SEE SHEET 1	-	-	-

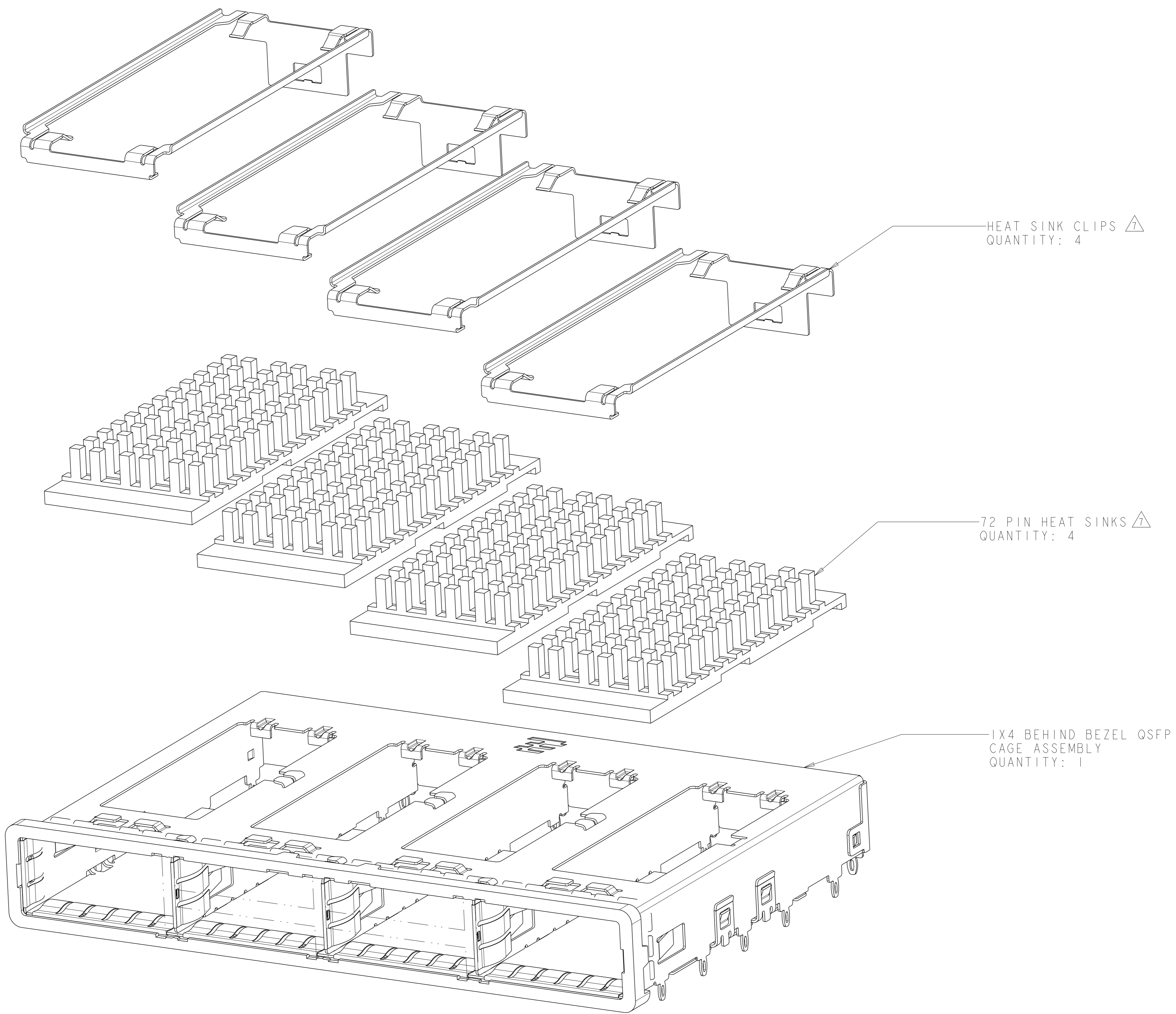

2170615-2 AS SHOWN

THIS DRAWING IS A CONTROLLED DOCUMENT.		OWN	Z4SEP2013	TE TE Connectivity
		CHK	Z4SEP2013	
		APVD	Z4SEP2013	NAME 1X4 CAGE ASSEMBLY, BEHIND BEZEL, W/ HEAT SINKS, QSFP
		PRODUCT SPEC	108-2286	
		APPLICATION SPEC	114-13218	RESTRICTED TO
		WEIGHT	-	
DIMENSIONS:		TOLERANCES UNLESS OTHERWISE SPECIFIED:		SIZE A100779C=2170615
mm		0 PLC ±		
		1 PLC ±0.1		SCALE 1:1 SHEET 3 OF 6 REV D
		2 PLC ±0.1		
		3 PLC ±		
		4 PLC ±		
		ANGLES FINISH		
MATERIAL		Customer Drawing		

LOC	DIST	REVISIONS			
GP	00	REV	DATE	OWN	APVD
-	SEE SHEET 1	-	-	-	-

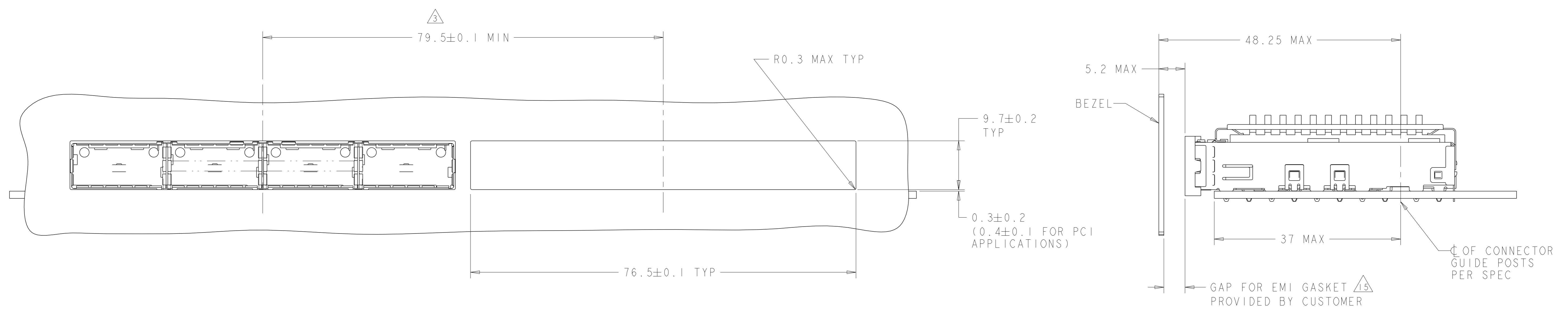

ONE SIDED CONFIGURATION
 SCALE 5:2

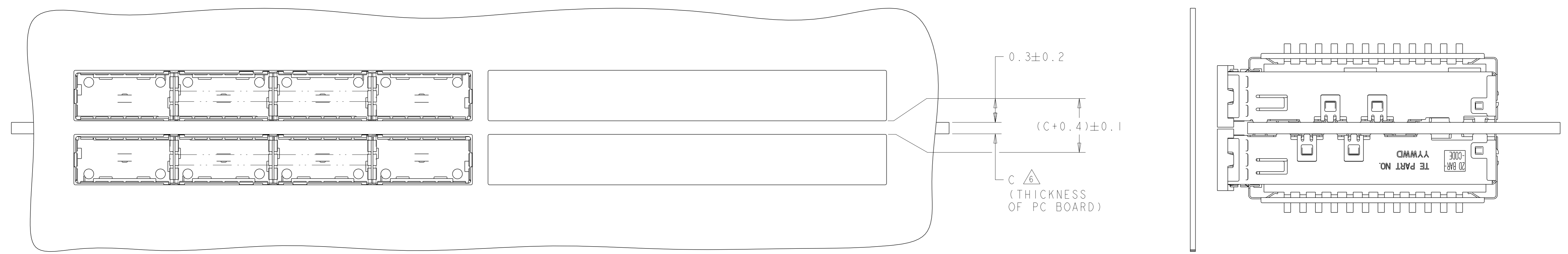

BELLY TO BELLY CONFIGURATION SIMILAR
 TO ONE SIDED EXCEPT WHERE NOTED
 SCALE 5:2

THIS DRAWING IS A CONTROLLED DOCUMENT.		OWN: ZJ	24SEP2013	TE TE Connectivity
DIMENSIONS:		CHK: JY	24SEP2013	
mm	TOLERANCES UNLESS OTHERWISE SPECIFIED:	APVD: MC	24SEP2013	NAME: 1X4 CAGE ASSEMBLY, BEHIND BEZEL, W/ HEAT SINKS, QSFP
0 PLC ±	1 PLC ±0.1	PRODUCT SPEC	108-2286	SIZE: CAGE CODE DRAWING NO
2 PLC ±0.1	3 PLC ±	APPLICATION SPEC	114-13218	RESTRICTED TO
4 PLC ±	ANGLES ±	FINISH ±	WEIGHT	A100779C=2170615
MATERIAL			Customer Drawing	SCALE 1:1 SHEET 4 OF 6 REV D

LOC	DIST	REV	DESCRIPTION	DATE	OWN	APVD
GP	00		SEE SHEET 1			

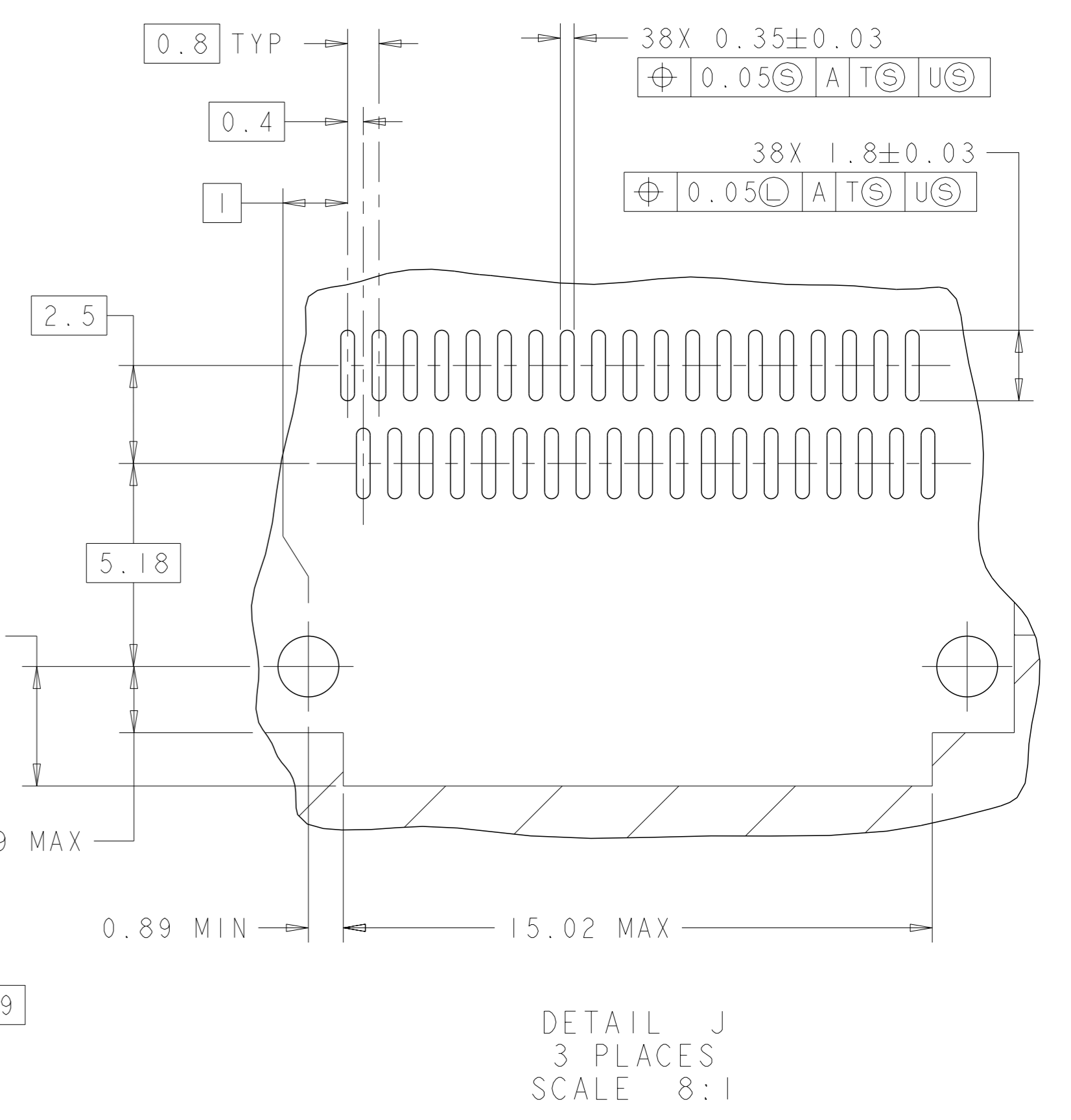
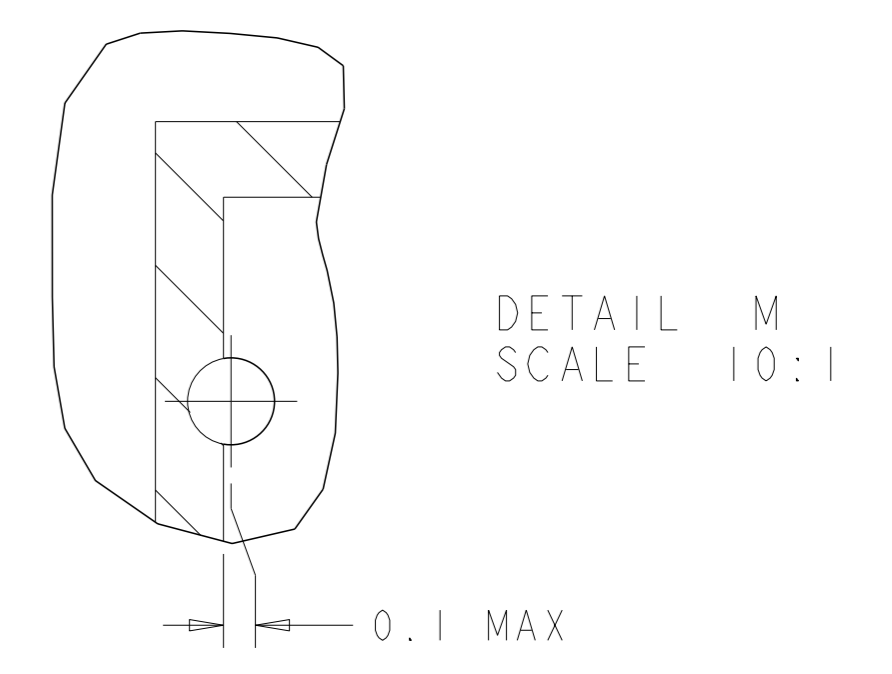
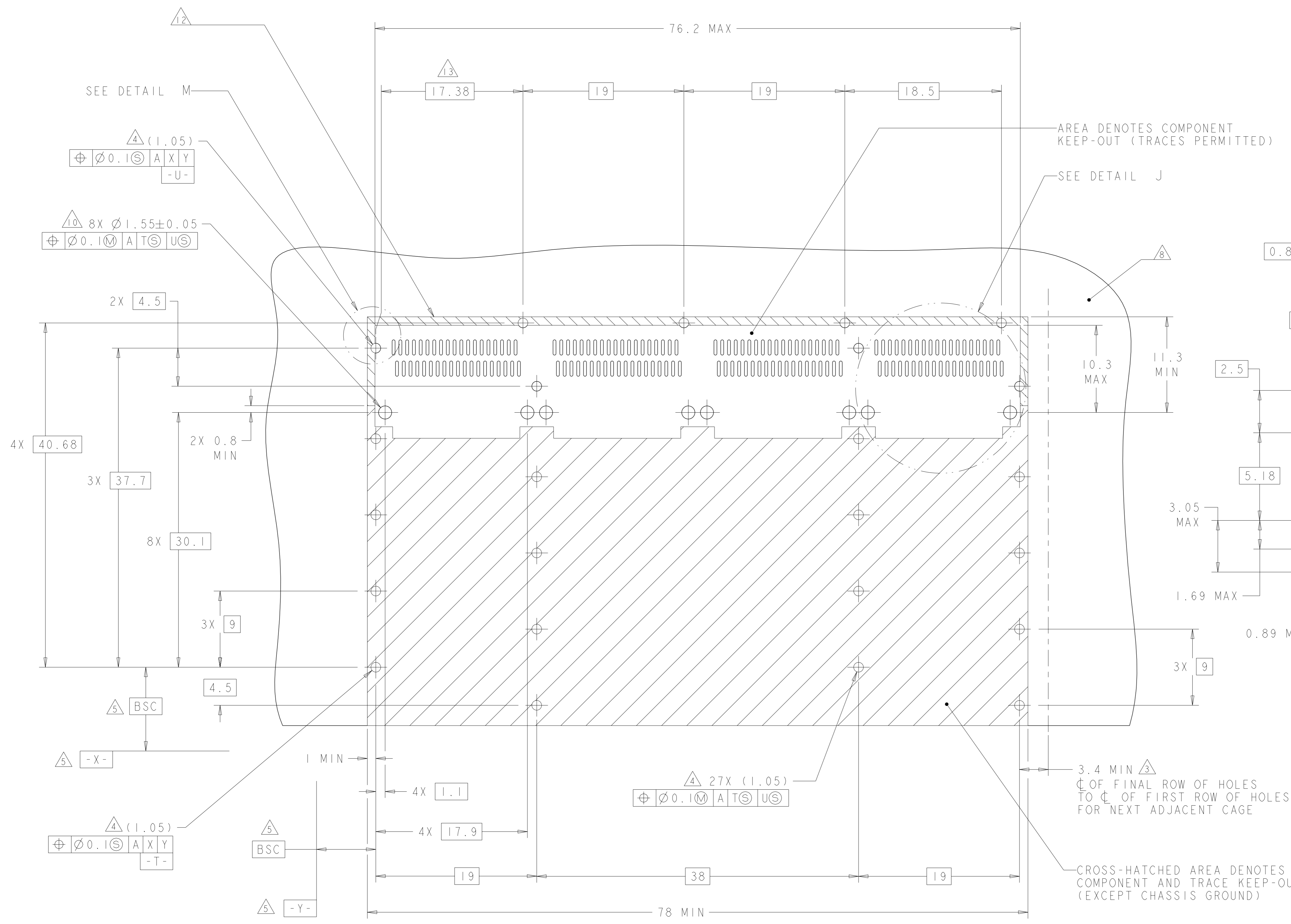

RECOMMENDED PC BOARD LAYOUT
 SINGLE SIDE MOUNT CONFIGURATION
 SCALE 4:1

THIS PRODUCT HAS NOT COMPLETED VALIDATION/QUALIFICATION TESTING

THIS DRAWING IS A CONTROLLED DOCUMENT.		OWN: ZJ	24SEP2013		TE Connectivity
DIMENSIONS: mm		CHK: JY	24SEP2013		NAME: 1X4 CAGE ASSEMBLY, BEHIND BEZEL, W/ HEAT SINKS, QSFP
TOLERANCES UNLESS OTHERWISE SPECIFIED:		APVD: MC	24SEP2013	PRODUCT SPEC: 108-2286	
0 PLC ±		APPLICATION SPEC: 114-13218		SIZE: A1	
1 PLC ±0.1		WEIGHT: -		CAGE CODE: 00779	
2 PLC ±0.1		FINISH: -		DRAWING NO: 2170615	
3 PLC ±		MATERIAL: -		RESTRICTED TO: -	
4 PLC ±		Customer Drawing		SCALE: 1:1	
ANGLES: ±		SHEET: 5		OF: 6	
FINISH: ±		REV: D			