

NOTES:

25-925-2000-91

**Materials:** SST. corrosion-resistant, Non Magnetic 303, per ASTM A484 and A582. Beryllium Copper per ASTM-B-196, QQ-C-530 Oxide-Noryl (tm), MIL-P-46129

**Finish:** Center Conductors, body, body components and solder components shall be plated per MIL-G-45204 Type II, Class 1 over Nickel plate per QQ-N-290.

**Frequency:** DC-40 GHz  
1.25 TO 40 GHz

**VSWR:**  
**Insertion Loss:** .05√Frequency

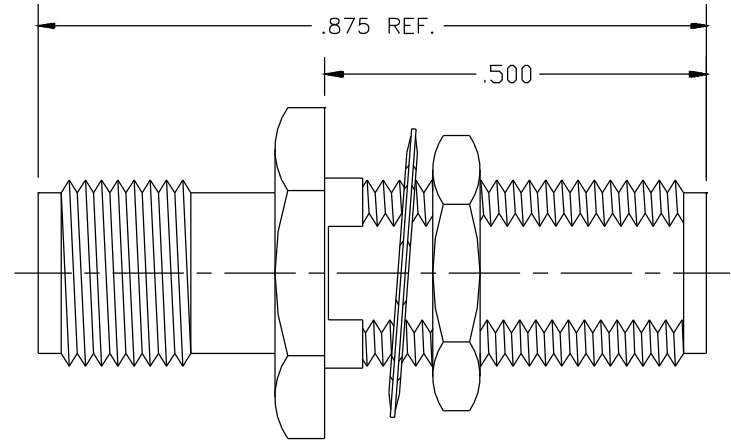
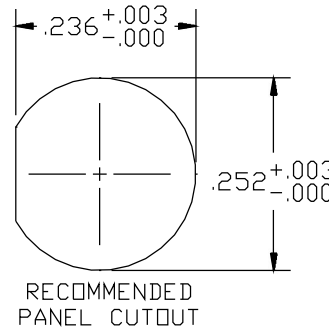

LTR	DESCRIPTION	DATE	APPR.	DRAWN	CHECKED	USED ON	SRI CONNECTOR GAGE CO. 3950 DOW ROAD MELBOURNE FL. 32934			
-	REL	04/03		APPR.	SCALE	25-925-2000-91	2.9mm JACK TO 2.9mm JACK BLKHD			
				UNLESS OTHERWISE SPECIFIED: 1. REMOVE ALL BURRS 2. BREAK ALL CORNERS & EDGES .005 R. MAX 3. CHAMFER 1st & LAST THREADS 45° 4. SURFACE FINISHED 32✓ UNLESS OTHERWISE SPECIFIED. 5. DIAMETERS ON COMMON CENTERS TO BE CONCENTRIC WITHIN .002 T.I.R. 6. ALL DIMENSIONS ARE AFTER PLATING.						TITLE
				DIMENSIONS ARE IN INCHES TOLERANCES			FINISH		SHEET	DWG. NO.
				DECIMALS .X ±.030 .XX ±.010 .XXX ±.005	FRACTIONAL ± 1/64	ANGULAR .X° ±1°0' .X°X' ±15'	SIZE	FSCM NO.		
						A	OHMO1			