

REV.	DATE	ECR NO.	DESCRIPTION
NC	01/15/10	XXXXXX	INITIAL RELEASE

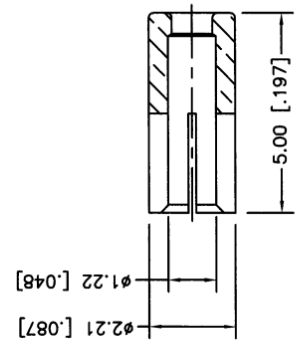
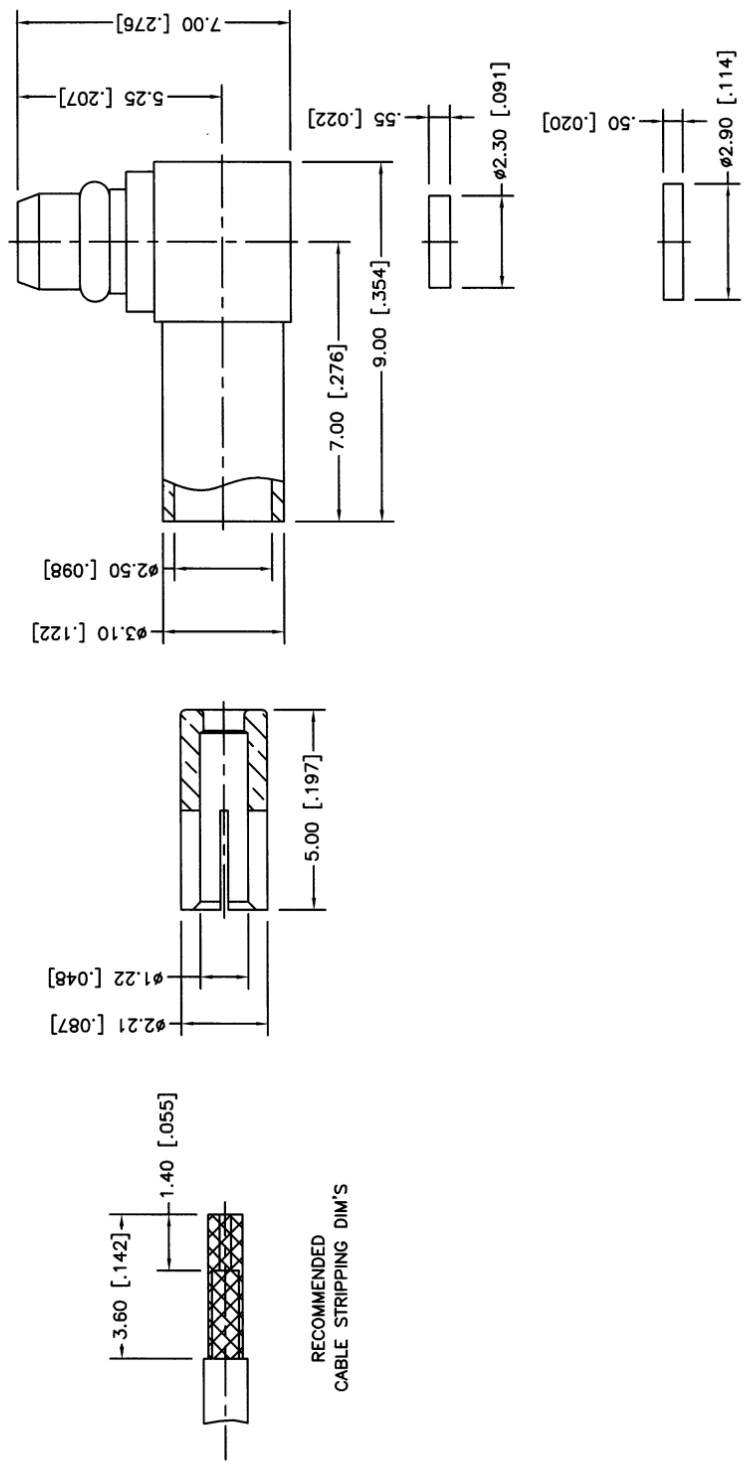

REV.	DATE	ECR NO.	DESCRIPTION
NC	01/15/10	XXXXXX	INITIAL RELEASE

7	INSULATOR	PTFE	NATURAL	1	QTY
6	COVER	BRASS	GOLD	1	
5	INNER FERRULE	BRASS	GOLD	1	
4	RETAINER RING	BER. COPPER	GOLD	1	
3	CONTACT PIN	BRASS	GOLD	1	
2	INSULATOR	PTFE	NATURAL	1	
1	BODY WITH HOUSING	BRASS	GOLD	1	
	DESCRIPTION	MATERIAL	FINISH		

UNLESS OTHERWISE SPECIFIED DIMENSIONS ARE IN INCHES AND DECIMALS THEREOF UNLESS INDICATED OTHERWISE IN THIS DRAWING. DIMENSIONS IN MILLIMETERS ARE FOR CUSTOMER REFERENCE ONLY.	APPROVALS	DATE
UNLESS OTHERWISE SPECIFIED TOLERANCES FOR ALL DIMENSIONS ARE: 0.5 - 8mm ± 0.20mm 8 - 30mm ± 0.40mm 30 - 120mm ± 0.50mm UNLESS OTHERWISE SPECIFIED TOLERANCES FOR INCHES ARE: .020 - .315 = ± 0.007" .315 - 1.180 = ± 0.015" 1.180 - 4.724 = ± 0.020"	DRAWN M.ZHANG	01/15/10
	CHECKED	
	ISSUED	
	SHEET 1 OF 1	
	CAD FILE C:/CONNEX/262138.DWG	

Amphenol Connex	
PART DESCRIPTION	
MMCX R/A CRIMP PLUG (FOR 1.13mm CABLE)	
PART NO.	262138
DWG. NO.	262138.DWG
REV.	NC
SIZE	A
SCALE	NA