

THIS DRAWING IS UNPUBLISHED.

RELEASED FOR PUBLICATION

20

© COPYRIGHT 20 BY - ALL RIGHTS RESERVED.

LOC  
AL

DIST  
2

REVISIONS

P	LTR	DESCRIPTION	DATE	DWN	APVD
E		CHANGED PCB LAYOUT	01SEP2008	J.S.	G.T.
F		DELETED PART REVISION TABLE	18MAR2009	JS	PEG
F1		REVISED PCB HOLES LAYOUT	04APR2011	AV	GT
F2		REVISED PER ECR-13-009678	18SEP2013	RS	DD

TYPICAL APPLICATION

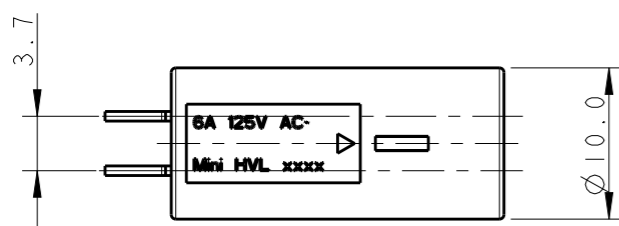
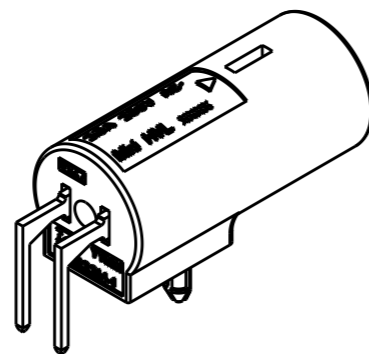
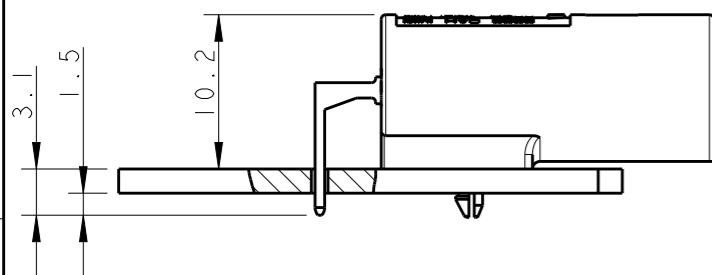

SECTION A-A  
SCALE 2:1

PRINTED CIRCUIT BOARD LAYOUT FOR LOW VOLTAGE VERSION

TOLERANCES UNLESS OTHERWISE SPECIFIED ± 0.05  
PRINTED CIRCUIT BOARD THICKNESS: 1.6 mm NOMINAL

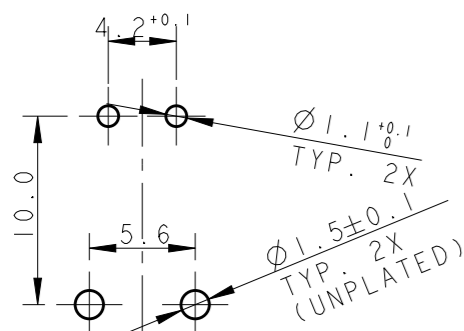

HIGH VOLTAGE

P/N 293315-1;-2;-6;-7  
KEYING HV-1

P/N 293315-3  
KEYING HV-3

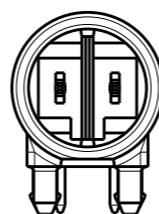
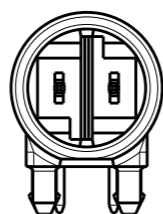

LOW VOLTAGE

P/N 293315-4  
KEYING LV-1

P/N 293315-5  
KEYING LV-2

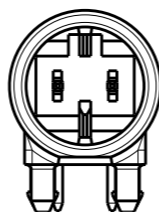
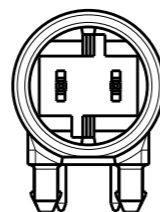

PRINTED CIRCUIT BOARD LAYOUT FOR HIGH VOLTAGE VERSION

TOLERANCES UNLESS OTHERWISE SPECIFIED ± 0.05  
PRINTED CIRCUIT BOARD THICKNESS: 1.6 mm NOMINAL

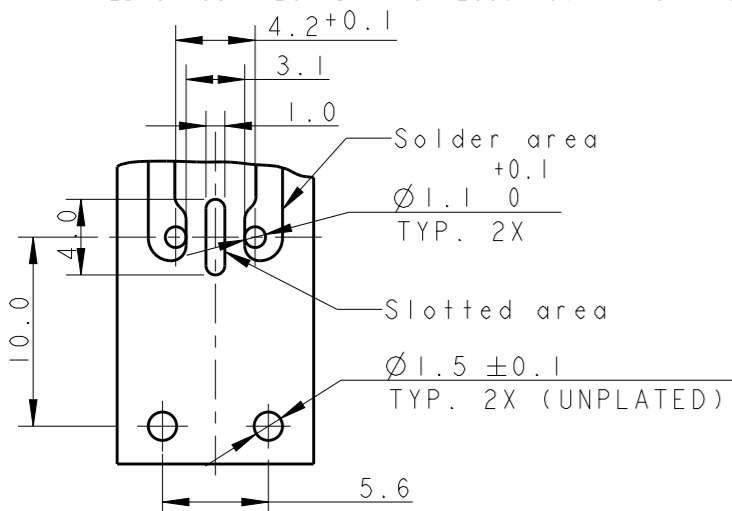

NOTE:

- 1 TIN PLATED CONTACTS
- 2 GOLD PLATED CONTACTS
- 3 MATERIAL HOUSING PA66 25%GFF UL94 V0

NOTE	KEYING	REMARKS	PART NUMBER	COLOR
2	HV-1	HIGH-VOLT 250 V AC	293315-7	BLACK
2	HV-1	HIGH-VOLT 250 V AC	293315-6	WHITE
1	LV-2	LOW-VOLT 42 V DC	293315-5	YELLOW
1	LV-1	LOW-VOLT 42 V AC	293315-4	LIGHT GREY
1	HV-3	HIGH-VOLT 125 V AC	293315-3	BLUE
1	HV-1	HIGH-VOLT 250 V AC	293315-2	BLACK
1	HV-1	HIGH-VOLT 250 V AC	293315-1	WHITE

THIS DRAWING IS A CONTROLLED DOCUMENT.

DIMENSIONS:	TOLERANCES UNLESS OTHERWISE SPECIFIED:
mm	
	0 PLC ±-
	1 PLC ±0.3
	2 PLC ±0.1
	3 PLC ±-
	4 PLC ±-
	ANGLES ±0.5°

MATERIAL - FINISH -

DWN	20JUN2007
CHK	R. FRABONI
APVD	J. SALO
PRODUCT SPEC	11FEB2008
APPLICATION SPEC	L. BATTILO
WEIGHT	108-94018
	114-32102

<b>STE</b> TE Connectivity			
NAME 7.5 mm PCB CONNECTOR ASSEMBLY 90 DEGREE MALE VERSION			
SIZE	CAGE CODE	DRAWING NO	RESTRICTED TO
A3	00779	C-293315	-

Customer Drawing SCALE 2:1 SHEET 1 OF 1 REV F2