

| SYMBOL DEFINITION | | TOTAL NO OF INSPECTIONS REQUIRED |
|--|---------------|----------------------------------|
| A DIMENSION WITHOUT AN INSPECTION REPORT SYMBOL DOES NOT REQUIRE INSPECTION. IT MAY BE CONTROLLED ON THE INDIVIDUAL COMPONENT DRAWING. | | 6 |
| | LAST NO. USED | 5 |

| MISSING SYMBOLS | | | | REVISION HISTORY | | | | AUTH | DR | APVD | APVD |
|-----------------|-----|-----|-----|------------------|------|--|--------|------|-----|------|------|
| DATE | STG | REV | N/P | CHG | ZONE | | | | | | |
| 260C18 | R | 01 | - | - | | WAS PE405638 AND RELEASED PART DRAWING | 441334 | KV | KV | KR | |
| 23JA20 | R | 01 | AA | - | | UPDATED PART AVAILABILITY | 550825 | AKS | SNS | JLW | |

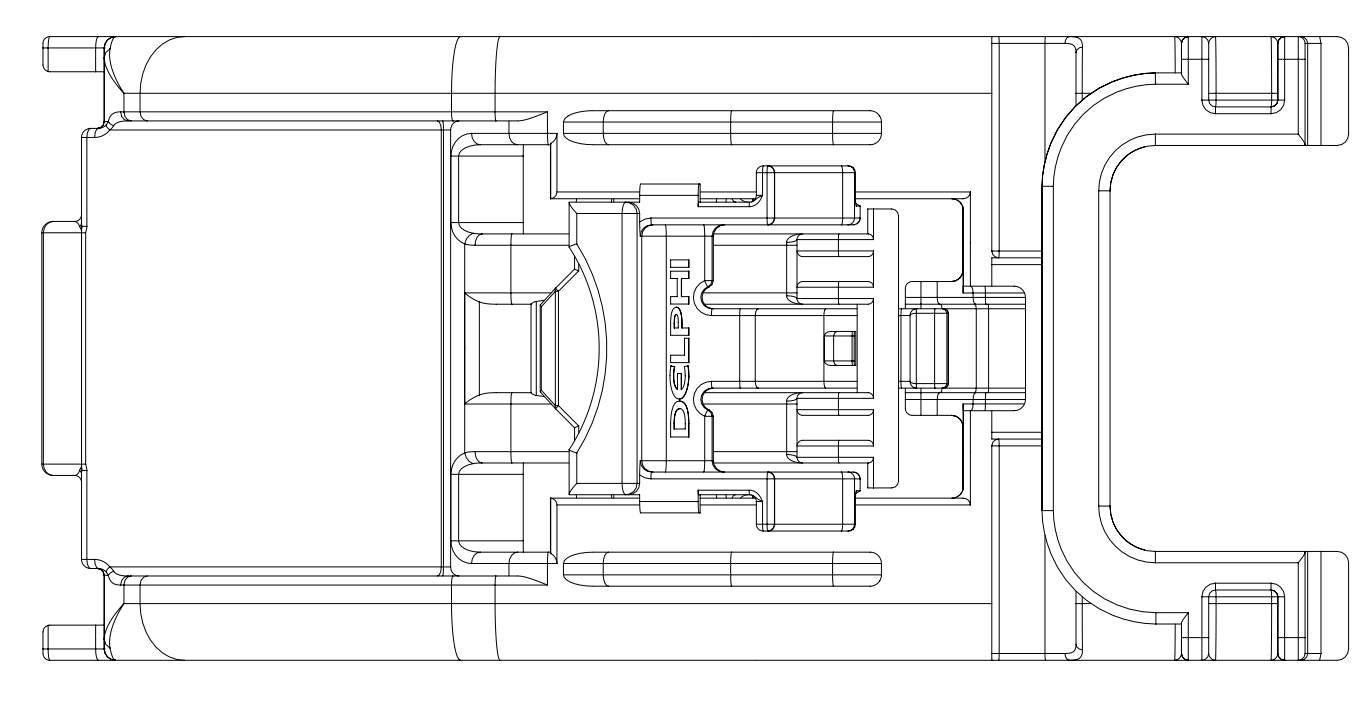
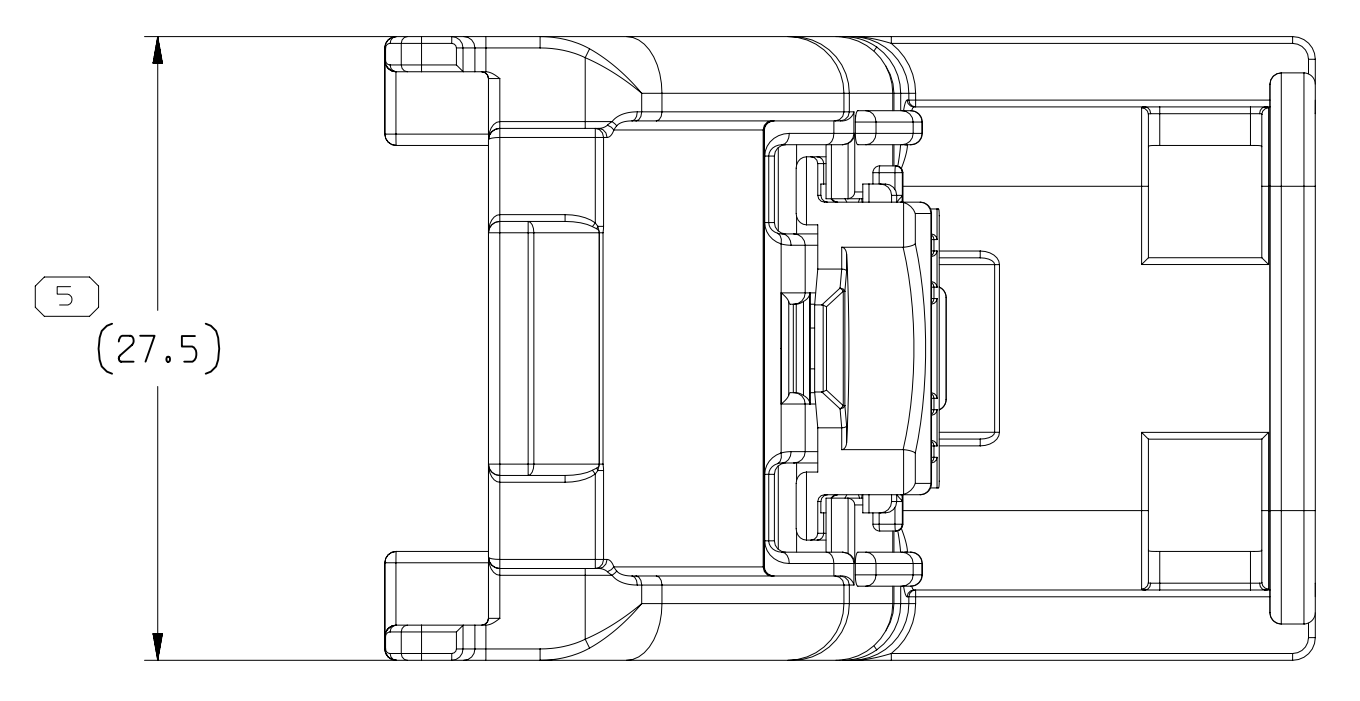
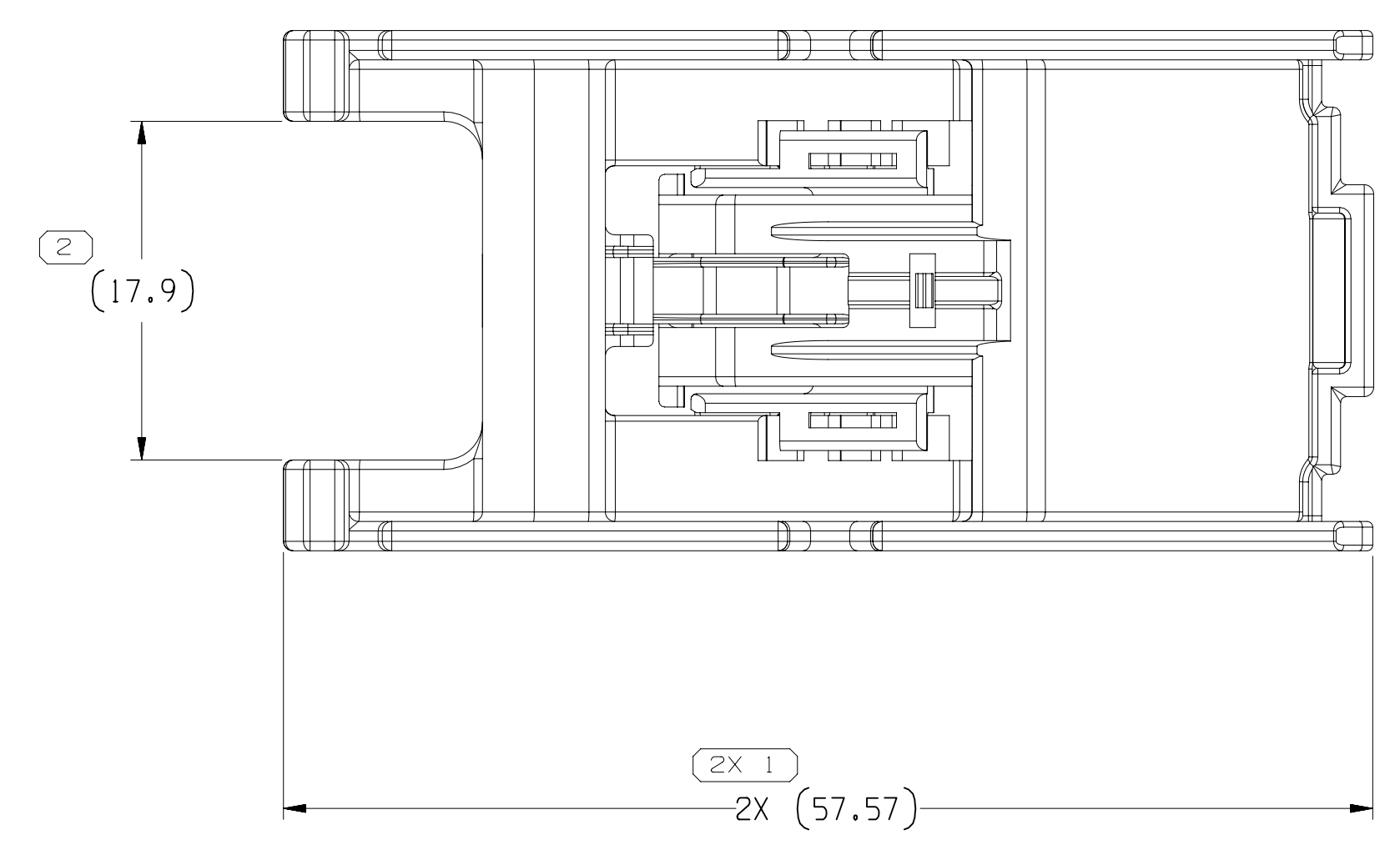
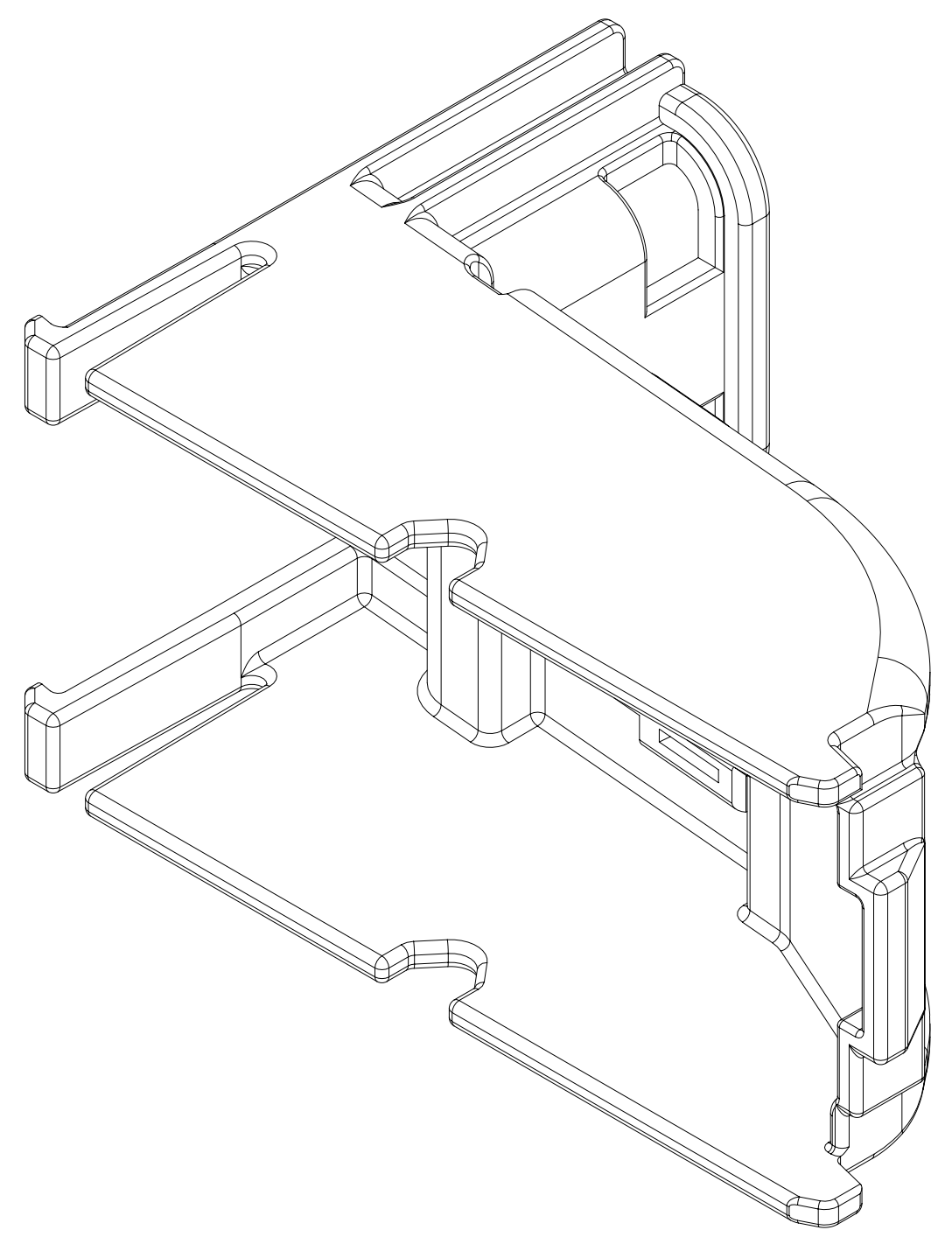
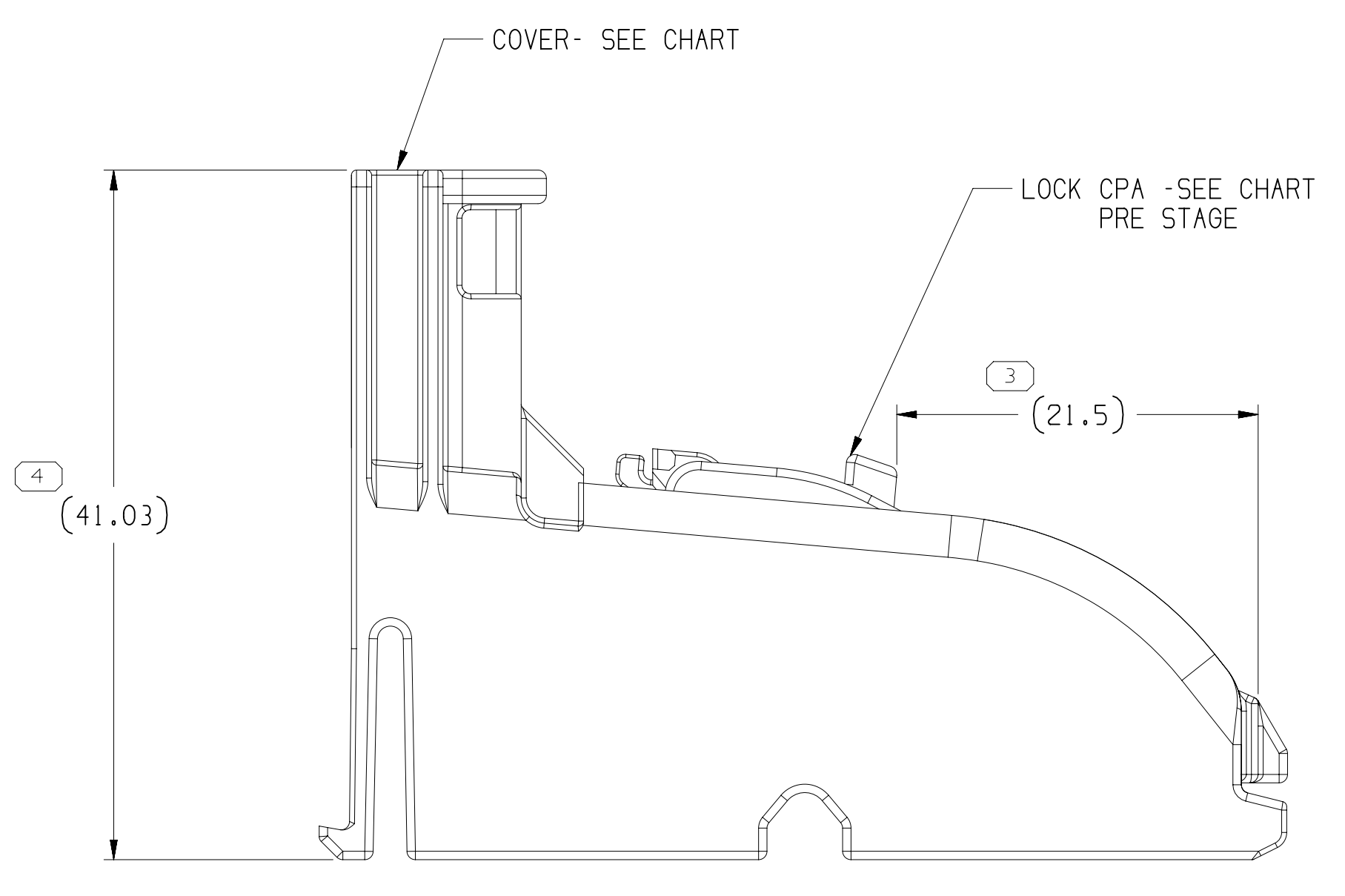

NOTES

- UNLESS OTHERWISE SPECIFIED AND/OR INDICATED:
DIMENSIONS ARE TO FACE OF VIEW SHOWN AND AUTOMATICALLY ROUNDED BY COMPUTER FOR INSPECTION (SEE MATH MODEL FOR PRECISE DIMENSIONS). FOR ALL OTHER DIMENSIONS NOT SHOWN BUT REQUIRED FOR TOOL BUILD, SEE MATH MODEL FOR PRECISE TOOL PATH DATA.
- THIS PRODUCT IS NOT CATEGORIZED AS AN APPEARANCE ITEM, MINOR IMPERFECTIONS INCLUDING, BUT NOT LIMITED TO, FLOW MARKS, COLOR BLEMISHES, GATE VESTIGES, AND SOFT FLASH THAT DO NOT AFFECT THE FIT, FORM, OR FUNCTION OF THE PART ARE PERMISSIBLE PER DPNP-4.7-CS-01.
- REFERENCE MATING COMPONENTS OR EQUIVALENT:
ASM CONNECTOR 35211572
- THIS ASSEMBLY MUST BE SHIPPED AS SHOWN.

| PART NO | REV | N/P | COVER | CPA |
|----------|-----|-----|----------|----------|
| 35211578 | 01 | AA | 35211579 | 33297525 |

| DIMENSIONAL RANGE (MM) | TOLERANCE (UNLESS OTHERWISE SPECIFIED) | CHART | ET | | | | | | |
|---|--|-------|------|-------|-------|-------|-------|-------|-------|
| FROM > 0 | > 20 | > 30 | > 70 | > 100 | > 150 | > 200 | > 250 | > 300 | > 400 |
| TO | 20 | 30 | 70 | 100 | 150 | 200 | 250 | 300 | 400 |
| TOLERANCE (UNLESS OTHERWISE SPECIFIED) | | | | | | | | | |
| ±0.15 ±0.2 ±0.3 ±0.4 ±0.5 ±0.6 ±0.8 ±1 ±1.2 | | | | | | | | | |
| ANGULAR TOLERANCE: ±2° | | | | | | | | | |

•APTIV•
CONNECTION SYSTEMS
Oremut, India
COPYRIGHT 2018 APTIV, ALL RIGHTS RESERVED.
THIS DRAWING IS THE PROPERTY OF APTIV AND CONTAINS APTIV CONFIDENTIAL INFORMATION. THE REPRODUCTION, DISTRIBUTION AND UTILIZATION OF THIS DOCUMENT OR ITS RELATED CAD DATA, AS WELL AS COMMUNICATION OF ANY CONTENT TO OTHERS, WITHOUT EXPRESS AUTHORIZATION, IS PROHIBITED.

| | |
|-------------------|--------|
| DR | DATE |
| APVD1 V.KANDASAMY | 260C18 |
| APVD2 V.KANDASAMY | 260C18 |
| APVD3 REED KEATON | 260C18 |
| APVD4 | |
| APVDS | |

SUBSTANCES OF CONCERN AND RECYCLED CONTENT PER APTIV 10949001

MATERIAL:
SEE DRAWING

DRAWING NAME:
ASM COV WIRE DRESS APEX

DRAWING NUMBER:
35211578

SIZE: A0
SCALE: 3:1
FRAME NO: 1 OF 1
SHEET NO: 1 OF 1
REV: R
N/P: AA

| LINE DRAWN THROUGH A PART NUMBER INDICATES THAT PHYSICAL PARTS ARE NOT AVAILABLE FOR ORDERING. | INDICATES THAT PHYSICAL PARTS ARE AVAILABLE FOR ORDERING. |
|--|---|
| NO MISSING SYMBOL NUMBER | NO MISSING SYMBOL NUMBER |
| DATE | DATE |
| STG | STG |
| REV | REV |
| N/P | N/P |
| CHG | CHG |
| ZONE | ZONE |

THIRD ANGLE PROJECTION
DO NOT SCALE
USE MATH DATA