

5100H Series Low Current LED Panel Mount Indicator

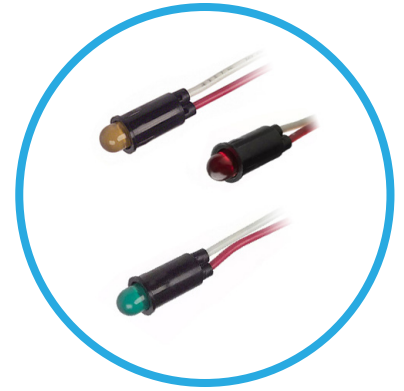

LED round panel mount indicator with wire or straight leads available in different colors and different operating voltage range.

Application

- Aircraft and Military
- Panel Indication
- Electrical Control Panels
- Industrial Machinery
- Instrument Panels
- Automation & Control
- Appliances
- Transportation Dashboards
- Displays

Key Features

- LED output color: red, amber, green, blue, and yellow
- LED Size: 5mm (T-1 3/4)
- Super bright 30mcd
- Low current
- Built-in resistor chip operates directly off 5 volt or 12 volt supply without external resistor
- Flashing LED option feature available
- Operating Temperature: -40 ~ +85 celsius
- Life Expectancy: 100,000 hours
- Panel hole diameter: snap-fit into $\varnothing.249$ (6.33mm) / .254 (6.45mm) hole
- Panel Thickness: .031 (.79mm) to .062 (1.58mm)
- Wire Leads: No. 24 AWG, 4.4"MIN 6.3"MAX, included stripped 1/2" Anode(+): Red Lead, bonded strands
- Housing: Black Nylon
- For additional options please contact VCC
- RoHS and REACH Compliant

Product Dimensions

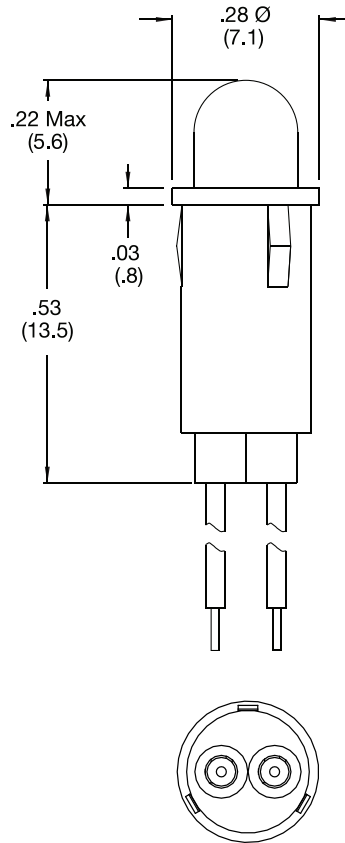

Recommended Mounting Hole

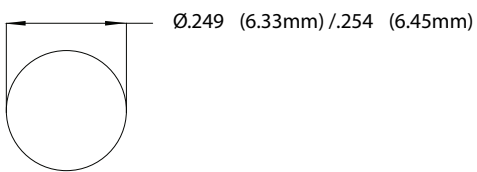

Notes:

1. All dimensions are in inches (millimeters)
2. Tolerance is ± 0.01 (0.25) unless otherwise noted