



SMA, SMB AND TWINAXIAL CONNECTORS AND ADAPTERS

Pomona®

Coaxial Connectors



Pomona ACCESS

FAX ON DEMAND This symbol indicates immediate Fax-On-Demand Technical Information is available. Dial (U.S.) (800) 444-6785, (Outside U.S.) (909) 469-2991. Enter the Pomona Access number (shown in italics) when prompted.

SMA WITHIN SERIES ADAPTERS

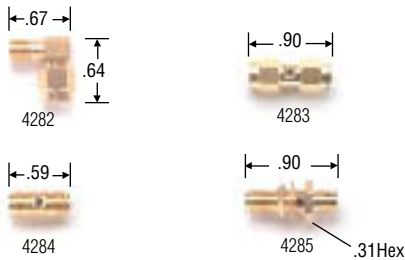

MATERIAL: Shell: Gold Plated Brass
Center Contacts: Gold Plated Brass

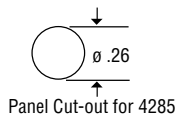

Pomona ACCESS	Model	Type	PRICE
	4282	SMA (f) to (m), Rt. Angle	22.00
	4283	SMA (m) to (m)	16.00
	4383A	SMA (m) to (m)*	14.00
	4284	SMA (f) to (f)	16.00
	4285	SMA (f) to (f)	19.00

* Passivated SS

SMA SHORTING CAP

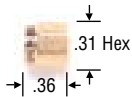

Screw onto SMA female. Protects sensitive instrument inputs or provides a necessary reference short. Gold plated steel center contact.

Pomona ACCESS	Model	Outer Shell	PRICE
	90297	5088 Gold Plated	16.00

SMA CABLE PLUGS/JACKS



4804/4859 SMA(M)



4805 SMA(F)

Supplied with center conductor and sleeve.
Impedance: 50 Ohms

MATERIAL: Shell: Passivated Steel
Insulation: PTFE

Pomona ACCESS	Model	Fits Cable Types	PRICE
	90104	174, 179, 187	10.55
	90105	188, 316	19.60
	90106	55, 142	12.00

TWINAX CABLE PLUG



RATING: 500 VRMS Max., -65°C (-85°F) to +165°C (+329°F)
Use on twinaxial cable types RG108 and Belden 9272.

Polarized Contact (One Male, One Female)

MATERIAL: Body: Brass, Tarnish Resistant Plating
Contact: Male: Gold Plated Brass;
Female: Gold Plated Beryllium Copper
Dielectric: PTFE

Pomona ACCESS	Model	PRICE
	90107	4957 26.00

SMA PCB MOUNTING FEMALE

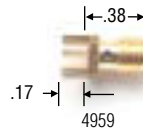

RATING: 335 VRMS Max., -65°C (-85°F) to +165°C (329°F)
Impedance: 50 Ohms

MATERIAL: Body: Stainless Steel, Gold Plated
Center Contact: Gold Plated Beryllium Copper
Dielectric: PTFE

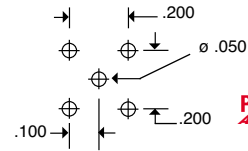

Pomona ACCESS	Model	PRICE
	90288	4959 19.95

SMA (F) PANEL RECEPTACLE

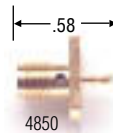

RATING: 335 VRMS Max., -65°C (-85°F) to +165°C (+329°F)
Impedance 50 Ohms

MATERIAL: Body: Gold Plated Stainless Steel
Center Contact: Gold Plated Beryllium Copper
Dielectric: PTFE
Flange thickness .065

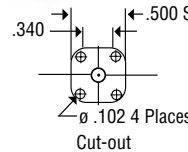

Pomona ACCESS	Model	PRICE
	90279	4850 19.05

SMB CABLE PLUGS/JACKS



RATING: 335 VRMS Max., -65°C (-85°F) to +165°C (+329°F)

These SMB (Subminiature "B") connectors snap together for quick assembly.

Impedance: 50 Ohms

Frequency Range: DC to 4GHz

Fits RG174 & RG316 cable types.

MATERIAL: Shell: Brass, Tarnish Resistant Plating
Insulation: PTFE

Contact: Male: Gold Plated Brass;
Female: Gold Plated Beryllium Copper



Pomona ACCESS	Model	Type	PRICE
	90121	5375 Cable Plug with Female Contact, Crimp Type	12.85
	90122	5379 Cable Jack with Male Contact, Crimp Type	10.25

TWINAX BULKHEAD RECEPTACLE

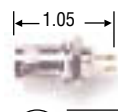

RATING: 500 VRMS Max., -65°C (-85°F) to +165°C (+329°F)
Polarized Contact (One Male, One Female)

MATERIAL: Body: Brass, Tarnish Resistant Plating
Contact: Male: Gold Plated Brass;
Female: Gold Plated Beryllium Copper
Dielectric: PTFE

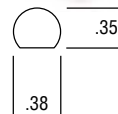

Max. Panel Thickness: .13"

Pomona ACCESS	Model	PRICE
	90287	4958 21.90