

PAGE 1/2	ISSUE 07-04-15E	SERIES SMA	PART NUMBER 5919-9503-001
----------	-----------------	------------	---------------------------

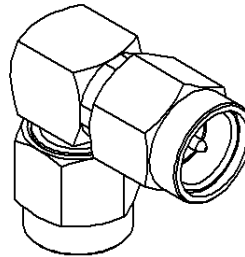

All dimensions are in mm.

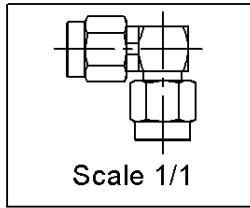
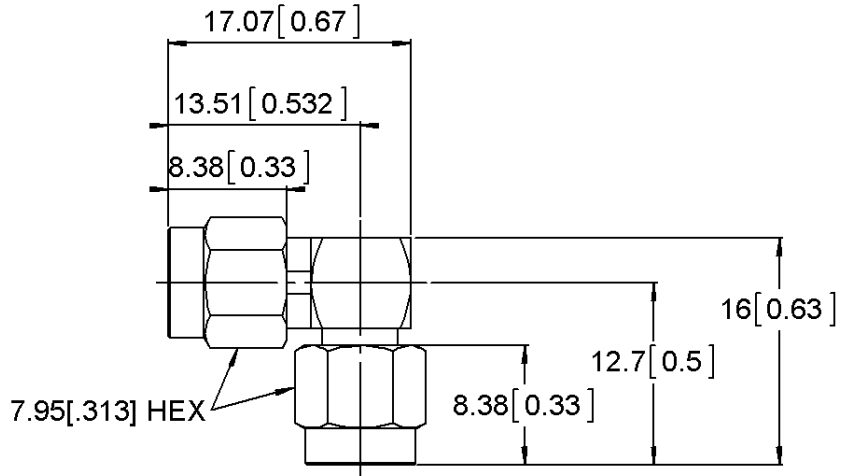
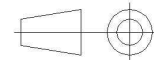

COMPONENTS	MATERIALS	PLATING (µm)
Body	STAINLESS STEEL	PASSIVATED
Center contact	BERYLLIUM COPPER, BRASS	GOLD 1.3 OVER NICKEL 2.5
Outer contact		
Insulator	PTFE	
Gasket	SILICONE RUBBER	
Others parts	BRASS, STAINLESS STEEL	PASSIVATED, NICKEL
-	-	-
-	-	-

PAGE 2/2	ISSUE 07-04-15E	SERIES SMA	PART NUMBER 5919-9503-001
----------	-----------------	------------	---------------------------

PACKAGING

Standard	Unit	Other
100	Contact us	Contact us

ELECTRICAL CHARACTERISTICS

Impedance		50	Ω	
Frequency		0-18	GHz	
VSWR	*1.15 +	0.0050	x F(GHz) Maxi	
Insertion loss		*.05	√F(GHz) dB Maxi	
RF leakage	- (NA	- F(GHz) dB Maxi	
Voltage rating		500	Veff Maxi	
Dielectric withstanding voltage		1000	Veff mini	
Insulation resistance		5000	MΩ mini	

ENVIRONMENTAL

Operating	-65/+165	°C
Hermetic seal	NA	Atm.cm3/s
Panel leakage	NA	

MECHANICAL CHARACTERISTICS

<u>Center contact retention</u>			
Axial force – Mating End	27	N mini	
Axial force – Opposite end	27	N mini	
Torque	2.8	N.cm mini	
<u>Recommended torque</u>			
Mating	90	N.cm	
	90	N.cm	
	0	N.cm	
Panel nut	NA	N.cm	
Mating life	500	Cycles mini	
Weight	6.1800	g	

SPECIFICATION

OTHER CHARACTERISTICS

***0-12.4 GHz**