

A-A

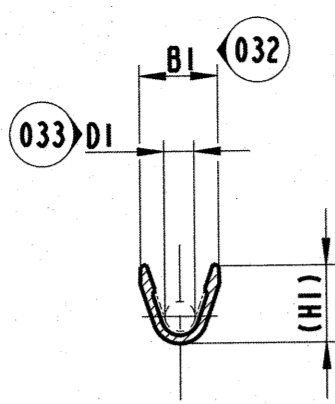

B-B

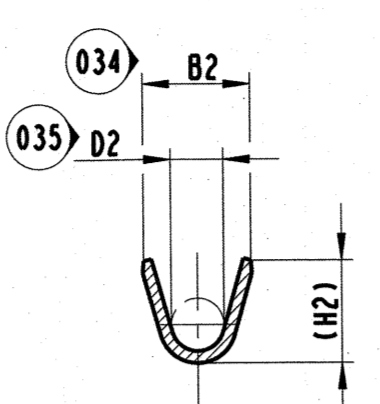

E-E

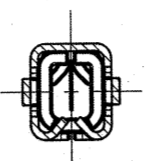

ANSCHLAGBILD
CRIMPED ON WIRE
M 2:1

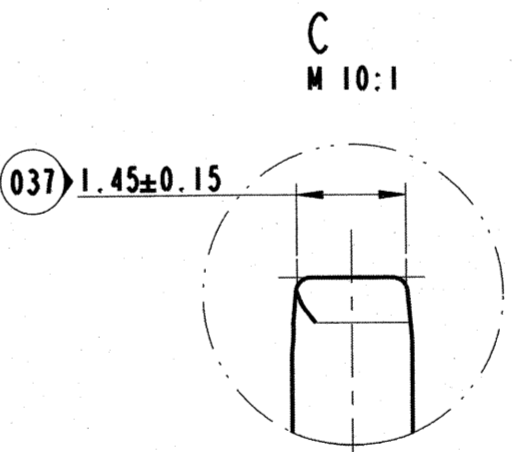
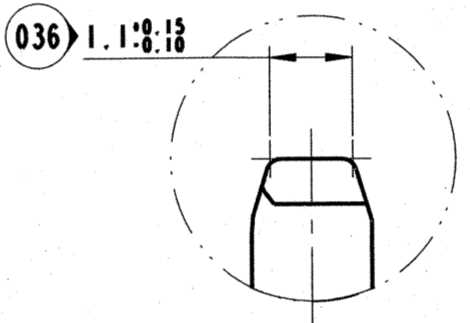
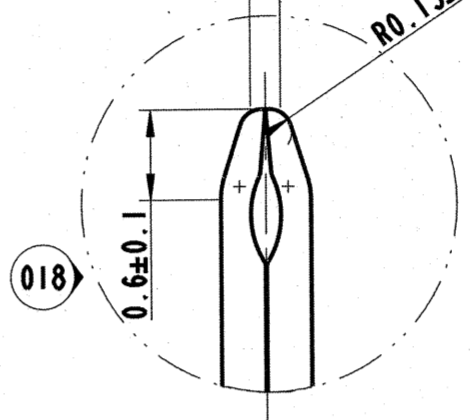
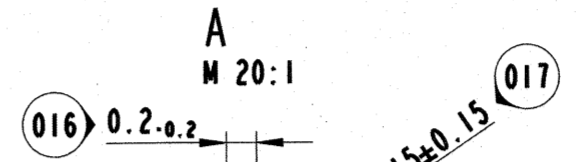
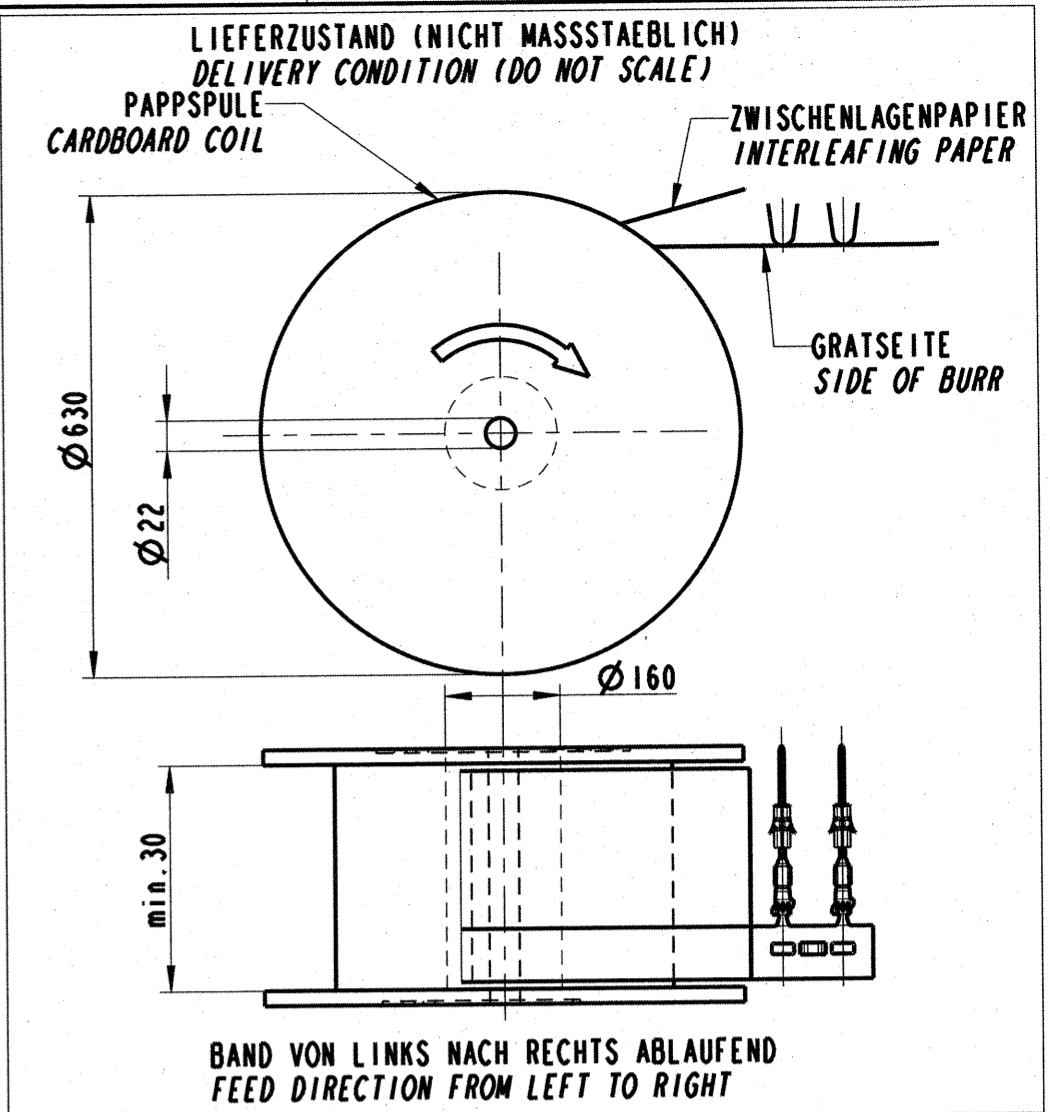
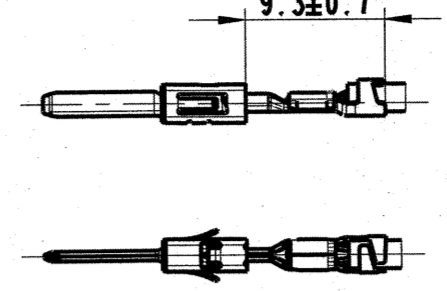

BEMERKUNGEN / NOTES

- MASZ GILT NUR FUER KABELKONFEKTIONAER DIMENSION ONLY FOR HARNESSMAKER
- DIE VERARBEITUNG DER FLACHSTECKER ERFOLGTE NACH MVL-CRIMP SPEZIFIKATION 9 084 10 00 BLATT 2 THE MALE TERMINALS MUST BE CRIMPED ACCORDING MVL-CRIMP SPECIFICATION 9 084 10 00 SHEET 2
- CRIMP DIMENSIONIERUNG ERFOLGTE FUER FLRY-LEITUNG NACH DIN 72551-6/1 CRIMP DIMENSIONS WERE DESIGNED FOR FLRY WIRES ACCORDING TO DIN 72551-6
- VEREDLUNGSBEREICH FUER GOLDVERSIONEN ALLSEITIG UEBER EINER UNTERNICKELUNG PLATING AREA FOR GOLDVERSIONS ALL SIDES OVER UNDERLAYER Ni
- CRIMPBEREICH (1-3)µm MATT Sn(GOLDERVERSIONEN) CRIMP AREA (1-3)µm MATT Sn(GOLDERVERSIONEN)
- MVL-FIRMENZEICHENI MVL-SUPPLIER CODE
- TEILECODE I PART CODE
- WOCHE UND JAHR DER HERSTELLUNG WEEK AND YEAR OF PRODUCTION
- GERADE MITTELSCHRIFTI STRAIGHT MEDIUM LETTER: 0.7 VERTIEFTI DEEPEND: 0.06-0.03
- PRAEGEN VOR DEM SCHNEIDENI REALIZE SERRATIONS FOR CUTTING

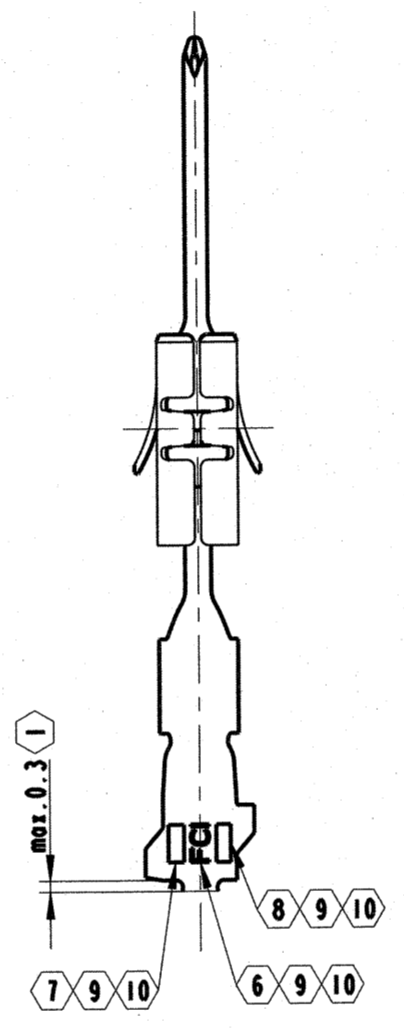
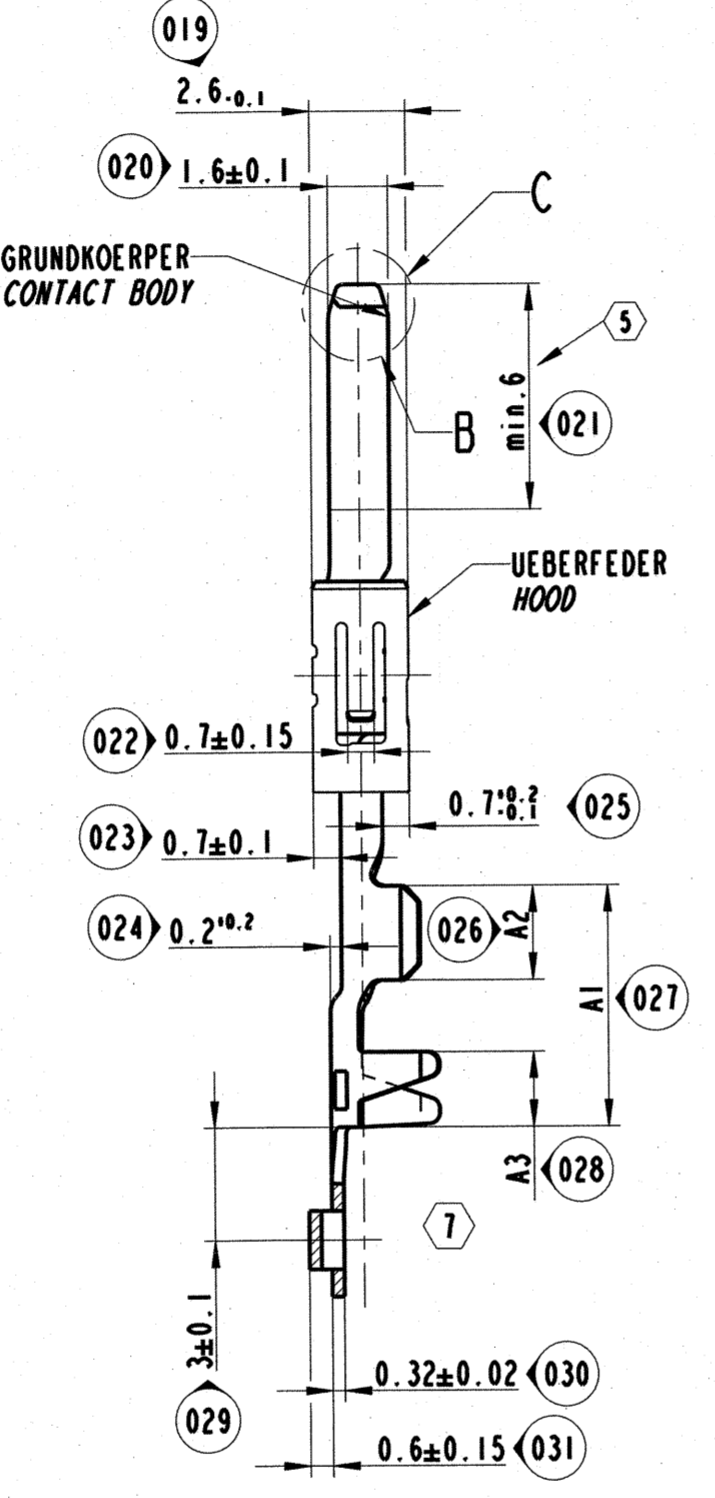
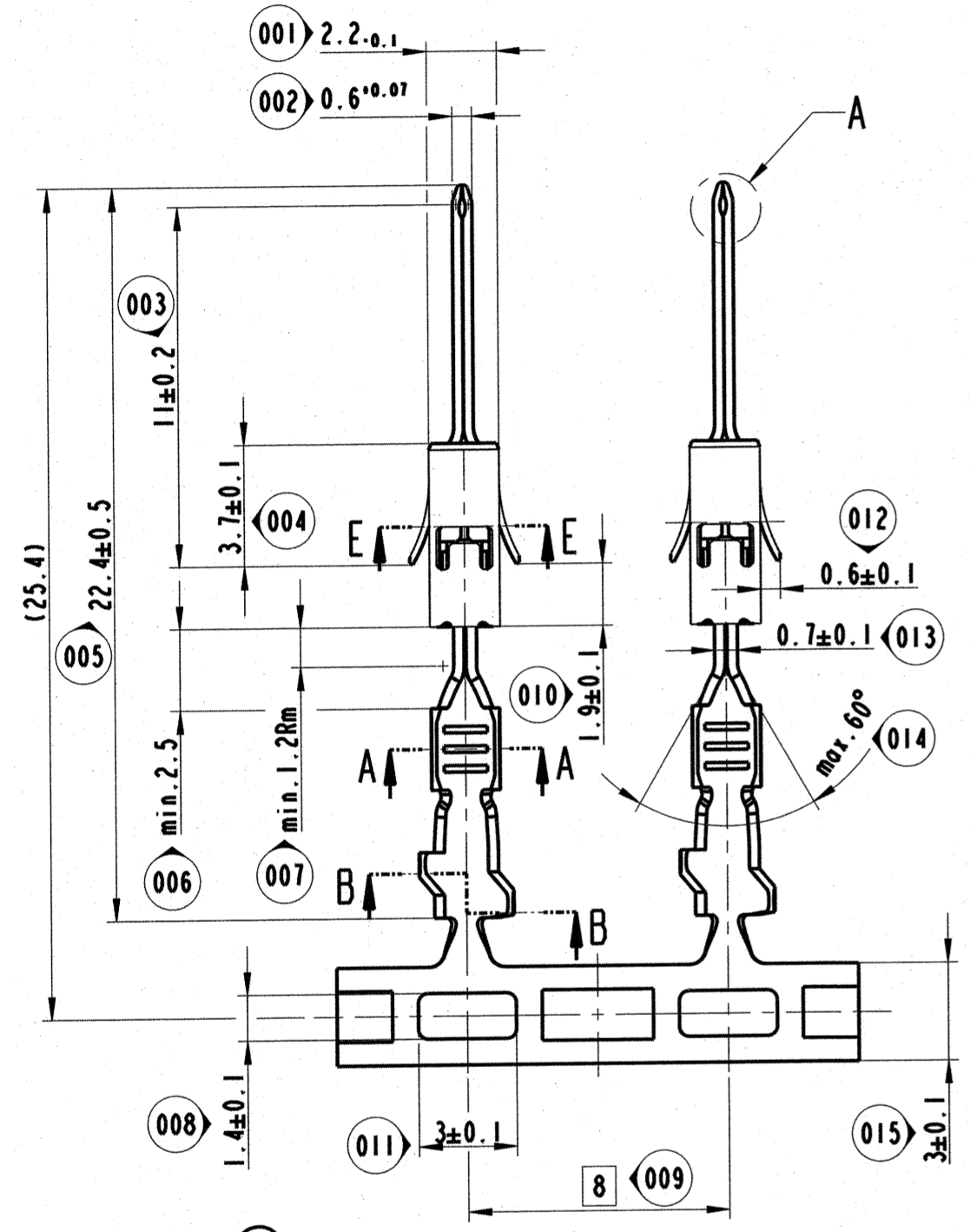

F

MVL TEILE-NR. MVL PART-NO.	DELPHI TEILE-NR. DELPHI PART-NO.	OBERFLAECHE CONTACT FINISH	TEILE CODE PART CODE	KABELQUERSCHN. (mm²) KABEL: FLR WIRE SIZE (mm²)	GRUNDKOEPPER CONTACT BODY	UEBERFEDER CANTILEVER SPRING	MATERIAL	A1	A2	A3	B1	B2	D1	D2	(H1)	(H2)	FRONT NACH/ ACC. DETAIL
6 010 19 44	33504727	0.8µm NiAu	3H	> 1.0 - 1.5	CuSn4 F47			6.4	3.0	2.0	3.0	3.7	1.4	2.4	3.1	3.8	C
6 010 19 41	33504755	1-3µm Sn	3T		CuFe2P F42												B
6 010 06 41	10769218	1-3µm Sn	3L														
6 010 19 34	33504726	0.8µm NiAu	2H	0.5 - 1.0	CuSn4 F47			6.4	3.0	2.0	2.5	3.2	1.2	1.8	2.7	3.4	C
6 010 19 31	10863773	1-3µm Sn	2T		CuFe2P F42												
6 010 14 34	33504725	1.27µm NiAu	2E		CuSn4 F47	FEDERSTAHL/ STAINLESS STEEL X10CrNi 18 8 NACH/ ACC. DIN EN 10151											B
6 010 06 34	10751589	0.8µm NiAu	2V		CuFe2P F42												
6 010 06 31	10756897	1-3µm Sn	2L														
6 010 19 14	33504724	0.8µm NiAu	1H		CuSn4 F47												C
6 010 19 11	10866290	1-3µm Sn	1T		CuFe2P F42												
6 010 14 14	33504723	1.27µm NiAu	1E	> 0.2 - 0.35	CuSn4 F47			6.4	2.5	2.0	2.1	2.9	0.8	1.4	2.1	2.9	B
6 010 06 14	10751586	0.8µm NiAu	1V														
6 010 06 11	10775249	1-3µm Sn	1L		CuFe2P F42												

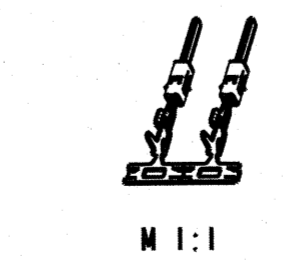

Rm = Radiusmitte
radius center point
E = Eckenmasz
width across corners

ECN-NR. E.C.N. NUMBER	DATE DATUM	DD / MM / YY REVISION INDEX	POSITION ANWENDUNG	CHANGE DESCRIPTION ÄNDERUNG	DRAWN BY GEZ.	CHK. BY GEN.	APPR. BY GEN.
14-10262	20.10.14	F	AC11	DELPHI P/W ADDED			
655/11	15.09.11	E	F11 E11 F11	Dimension 22.4mm was 22.2mm; Dimension 25.4mm was 25.2mm; Dimension 11.0mm was 10.8mm;	Solhish	St.Mueller	Hoernlein
538/08	16.02.11	D	-/C10 C10 D06 A05 C03/D03 C01	Redrawn in Pro-E; Part revision revised; Crimp code deleted; Part code added; Week and year of production added; Hole added; 3D view added;	Solhish	St.Mueller	Hoernlein
479/06	12.07.06	C04		UEBERARBEITUNG	S.Weiss	P.Wuetzel	Hoernlein

PRODUCT SPEC. PRODUKT SPEZIFIK.	PACKAGING SPEC. VERPACKUNGS SPEZIFIK.	APPLICATION SPEC. ANWENDUNGS SPEZIFIK.	COPYRIGHT DELPHI CORPORATION AND/OR ITS AFFILIATES. ALL RIGHTS RESERVED. REVISED THIS DRAWING IS THE PROPERTY OF DELPHI CORPORATION. THE REPRODUCTION, DISTRIBUTION AND UTILIZATION OF THIS DOCUMENT OR ITS RELATED CAD DATA, AS WELL AS COMMUNICATION OF ANY CONTENT TO OTHERS, WITHOUT EXPRESS AUTHORIZATION IS PROHIBITED.
		9 084 10 00	

TOLERANCES TOLERANZEN	MATERIAL MATERIAL	SURFACE FINISH OBERFLAECHE
SEE TABLE	SIEME TABELLE SEE TABLE	SIEME TABELLE SEE TABLE

DO NOT SCALE DRAWING ZEICHNUNG NICHT VERMESSEN	DATE DATUM	NAME NAME	TITLE BENENNUNG
1998	12.03.	S.Mueller	FLACHSTECKER DCS2-1.5 NORMALE ANWENDUNG MALE TERMINAL DCS2-1.5 NORMAL APPLICATION
	12.03.	S.Mueller	
	12.03.	G.May	

DRIVING NUMBER ZEICHN. NUMMER	FILE NAME DATEI NAME	SCALE M:
6 010 06 11	60100611C.B1.D	5:1