

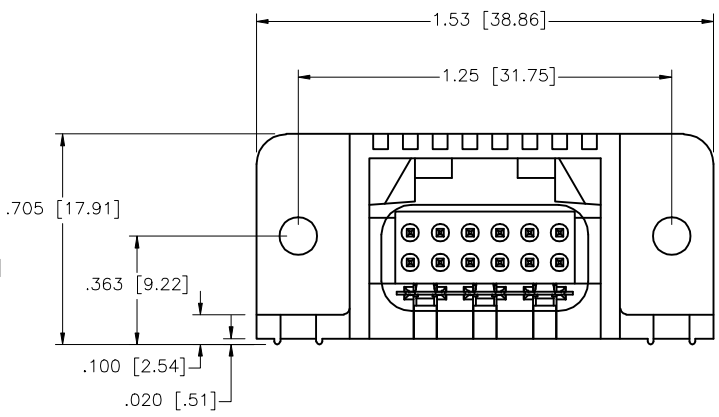

Copyright FCJ

PRODUCT NUMBER
SEE TABLE

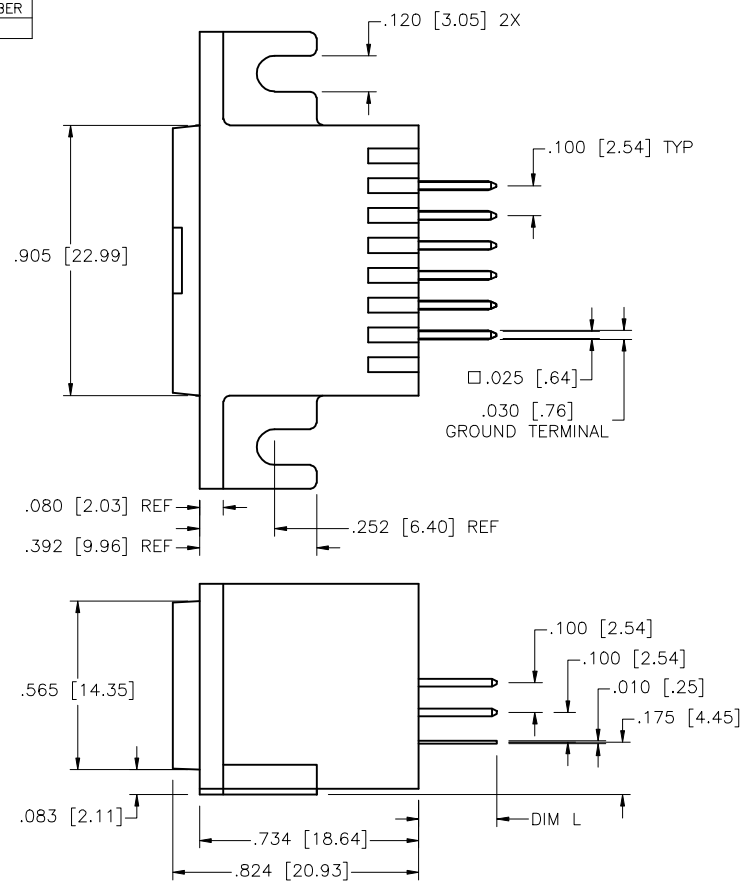

| | | | | | | | |
|-------------|----------|-----|----------|---------------------------------------|----------------------------------|------------|---|
| mat'l. code | | | | surface ISO 1302 | tolerance ISO 406 ISO 1101 | projection | product family LATCH-N-LOK |
| ltr | ecn no | dr | date | tolerances unless otherwise specified | | INCH/MM | title |
| C | V12179 | TFG | 8/24/01 | angles | .XX±.01/XX±0.3 | | 2X6 LNL VERTICAL PANEL MOUNT HEADER ASSEMBLY |
| D | M04-0230 | MHT | 12/8/04 | linear | .XXX±.006/XXX±0.13 | scale 1:1 | |
| E | M05-0052 | ERE | 03/19/05 | 0°±2' | .XXX±.0020/XXX±0.05 | | sheet 1 of 2 size |
| F | M06-0365 | AGS | 9/21/06 | dr | M. CORNMAN | 6/20/90 | 69983 |
| G | M09-0048 | MHT | 3/12/09 | engr | D. HORCHLER | 6/20/90 | A3 |
| | | | | chr | D. HORCHLER | 6/20/90 | |
| | | | | appd | D. HORCHLER | 6/20/90 | type Product Customer Drawing |
| sheet | revision | G | G | | | | |
| index | sheet | 1 | 2 | | | | |

form A3

| PRODUCT NUMBER | COLOR | NOTE (4) | DIM L |
|----------------|-------------|----------|---------------|
| 69983-X01 | LIGHT GRAY | | |
| -X02 | OFF WHITE | | |
| -X03 | DARK GRAY | | |
| -X04 | BLACK | | |
| -X05 | SLATE GRAY | | SEE KEY BELOW |
| -X07 | SILVER GRAY | | |
| -X08 | PEARL WHITE | | |
| 69983-X09 | PEBBLE GRAY | | |

OBS
OBS
OBS
OBS

| DASH NO | MISSING PIN LOCATION DETAIL A | DASH NO | MISSING PIN LOCATION DETAIL A |
|-----------|----------------------------------|-------------|----------------------------------|
| 69983-X0X | ALL PINS LOADED | 69983-X0XLF | ALL PINS LOADED |
| -X1X | | -X1XLF | |
| -X2X | | -X2XLF | |
| -X3X | | -X3XLF | |
| -X4X | | -X4XLF | |
| -X5X | | -X5XLF | |
| -X6X | | -X6XLF | |
| -X7X | | -X7XLF | |
| -X8X | | -X8XLF | |
| 69983-X9X | | 69983-X9XLF | |

PIN LENGTH KEY

| DASH NO | DIM L |
|-------------|-----------|
| 69983-0XXLF | .130/3.30 |
| 69983-1XXLF | .230/5.84 |
| 69983-2XXLF | .318/8.08 |

NOTES:

- HEADER SHROUD MAT'L: POLYCARBONATE UL94V-0 RATED.
- GROUND CONTACT
MAT'L: 3/4 HARD PHOS. BRONZE
PLATING: 100-160u"/2.54-4.06u TIN
- SIGNAL CONTACT
MAT'L: 3/4 HARD PHOS. BRONZE
PLATING: 30u"/.76u PALLADIUM ALLOY WITH GOLD.
FLASH OVER 50u"/1.27u NICKEL.
- NUMBERS SHOWN ARE FOR G.E. LEXAN AND ARE FOR REFERENCE ONLY.
- THIS ASSEMBLY UL APPROVED PER FILE E66906 VOL. 1, SEC. 84, AND CSA APPROVED PER MASTER FILE LR46923.
- ADD LF SUFFIX AT THE END OF PART NUMBER FOR LEAD FREE OPTION.
- THIS PRODUCT MEETS EUROPEAN UNION DIRECTIVES AND OTHER COUNTRY REGULATION AS DESCRIBED IN GS-22-008.
- PLATING OPTIONS:
MAY BE EITHER GOLD OR GXT PLATED AT MANUFACTURER'S OPTION.

| | | | | | |
|-------------|----------------|--|----------------------------------|--|-------------------------------|
| mat'l. code | | surface ISO 1302 | tolerance ISO 406 ISO 1101 | projection | product family LATCH-N-LOK |
| ltr | ecn no | dr | date | title 2X6 LNL VERTICAL PANEL MOUNT HEADER ASSEMBLY | |
| G | | | | INCH/MM | scale 1:1 |
| angles | | linear | | sheet 2 of 2 size | |
| 0'±2' | | .XX±.01/XX±.03 .XXX±.006/XXX±.013 XXX±.0020/XXX±.005 | | A3 | |
| dr | M. CORNMAN | 6/20/90 | | dwg no 69983 | |
| engr | D. HORCHLER | 6/20/90 | | type Product Customer Drawing | |
| chr | D. HORCHLER | 6/20/90 | | | |
| appd | D. HORCHLER | 6/20/90 | | | |
| sheet index | revision sheet | | | | |