

YAZAKI PART NO.	COLOR
7183-4000	NATURAL
7183-4000-30	BLACK
7183-4000-60	GREEN
7183-4000-90	BLUE

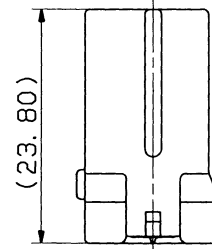
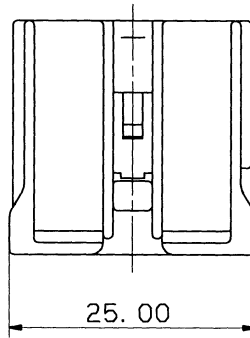
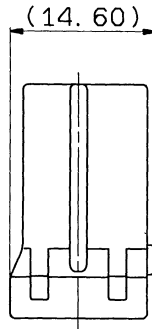
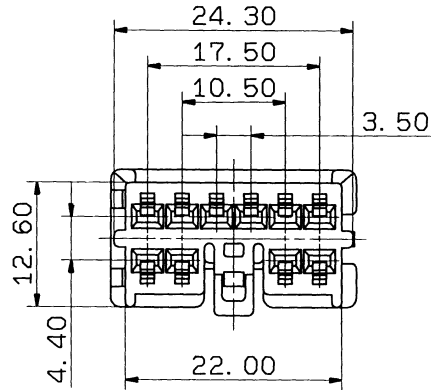

注 記

1. 嵌合相手品番 : 7182-4000 ETC., 7122-8307 ETC.
2. 適用ターミナル品番 : 7116-1486-02, 7116-1486-08  
7116-1487-02
3. 適用リヤホルダー品番 : 7157-4588-10

NOTES

1. MATING PART NO. : 7182-4000 ETC., 7122-8307 ETC.
2. APPLICABLE TERMINAL NO. : 7116-1486-02, 7116-1486-08  
7116-1487-02
3. APPLICABLE REAR HOLDER NO. : 7157-4588-10

△ 93.03.29		CHANGED TERMINAL PART NO. & R/H COLOR NUMBER	C93-6401	T. M	CUSTOMER		MATL. SPEC. PBT		TREAT. & FIN.					
92.02.10		NEW	C92-6189	C. M	CUSTOMER PART NO.		CUSTOMER DWG NO.		NAME					
LET	DATE	REVISION RECORD	NO.	CHKD	OFFICE		TRIAL PART NO.		SDL II CONNECTOR HOUSING					
GENERAL TOLERANCE				VENDOR		VENDOR NO.		10P FEMALE		ISSUE MARK				
	10MAX	50MAX	100MAX	250MAX	250OVR	ANGLE	ECCENT	DWG TYPE	DWG SOURCE	DWG DATE	UNIT	SCL	ANGLE	PART NO.
A	±0.15	±0.2	±0.3	±0.5	±0.75	±30'	0.1	R	NEW	92.02.10	mm	2/1	3	7183-4000 ETC.
B	±0.2	±0.3	±0.55	±0.95	±1.4	±30'	0.1	APPROVED	CHECKED	CHECKED	DESIGN	DRAWN		DWG NO.
©	±0.3	±0.5	±0.8	±1.4	±2	±30'	0.15	吉井	格井	秋山	M. ABE	Tony Mahon		7183-4000:R
SPECIFIED				MASS		g		92.407		93.04.06	93.04.06	91.06.20	93.03.29	YAZAKI CORPORATION

1

2

3