

# Double Stack

## Manual Assist Brackets

SBE®320 / SBX®350 • DIN A & E 320



Anderson Power Products® New Double Stacked Manual Assist Brackets provide a safe and cost effective solution enabling higher charging amperage levels by facilitating parallel connections. The new brackets use industry standard connectors that accept less expensive and smaller diameter flexible wires. The robust frames ensure connector alignment and provide the ability to mount the truck/charger bracket assembly. The brackets include an ergonomic handle that reduces the operator effort required for mating and unmating the connectors. This ensures complete engagement of mated pairs reducing the possibility of shorts or disconnects.

### FEATURES

- Allows higher amperage using parallel connections
- Uses SBE®320 & SBX®350 and DIN E320 & A Series Connectors
- Ensures correct alignment and provides mounting plate for truck/charger connection
- Reduces operator effort in mating/unmating connectors
- Assures connectors are completely mated in operation
- UL/CUR recognition

### ORDERING INFORMATION

Part Numbers	Safety Agency Ratings
993G5 – SBE®320 & SBX®350 Double Stack Battery Bracket	*SBE®320 & SBX®350 – UL 700 amps / CSA 450 amps
994G5 – SBE®320 & SBX®350 Double Stack Truck Charger Bracket	*SBE®320 & SBX®350 – UL 700 amps / CSA 450 amps
993G6 – Din 320 (A/E) Double Stack Battery Bracket Series	** E Series – UL 800 / CSA 500 A Series – UL 650 amps / CSA 500 amps
994G6 – Din 320 (A/E) Double Stack Truck Charger Bracket Series	** E Series – UL 800 / CSA 500 A Series – UL 650 amps / CSA 500 amps

\* Ratings with four connectors assembled using Double Stack Brackets and 4/0 wire

\*\* Ratings with four connectors assembled using Double Stack Brackets and 95mm<sup>2</sup> wire



# ASSEMBLY IMAGES

## SBE®320 & SBX®350 Charger/Truck Side

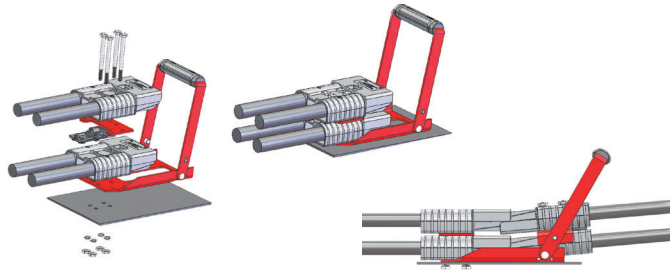

## SBE®320 & SBX®350 Battery Side

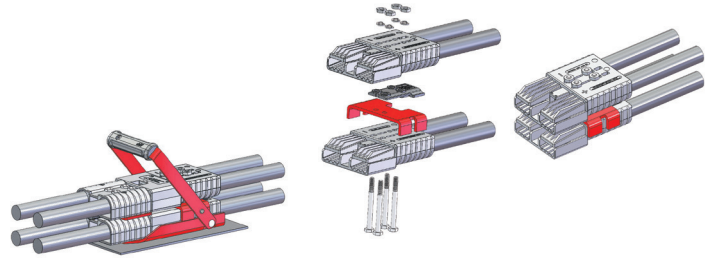

## E320/A320 Charger/Truck Side

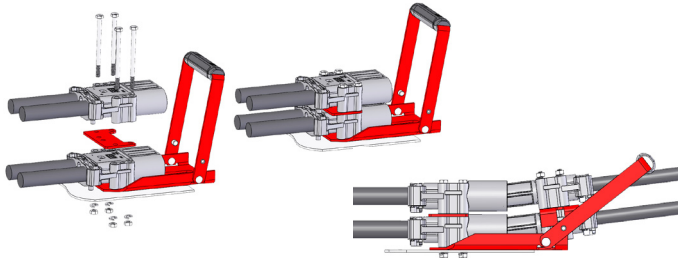

## E320/A320 Battery Side

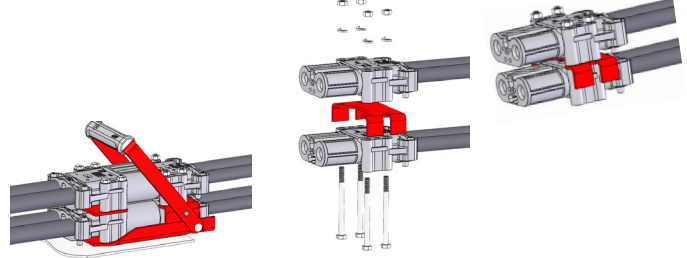

See Assembly Instruction for Double Sided Brackets. Din 1S6830 and SBE® & SBX® 1S6827.  
See Technical Paper for Recommendations for Double Stacked Applications – Document 1S6832A.

# TEMPERATURE CHARTS

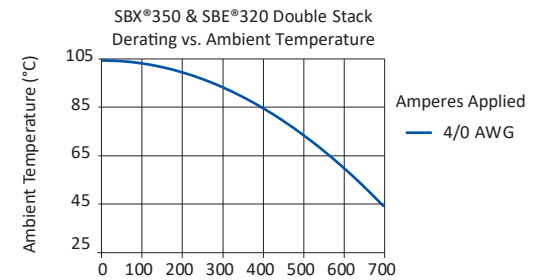
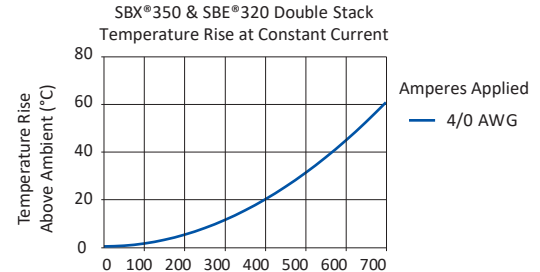
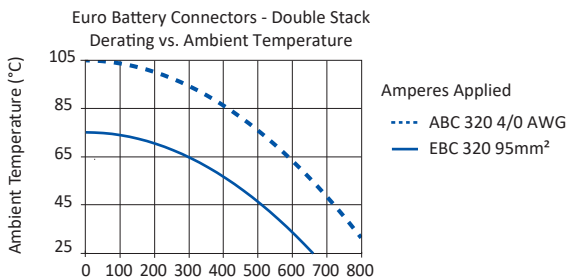
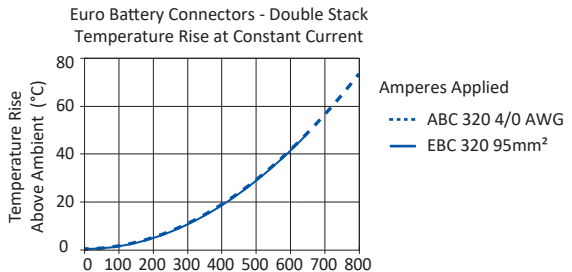

All Data Subject to Change Without Notice DS-STACK 2023-0043 REV 1 Your Best Connection™

Anderson™ will use reasonable efforts to include accurate and up-to-date content in the data sheet. All product information contained in the data sheet including ordering information, illustrations, specifications, and dimensions, are believed to be reliable as of the date of publishing, but is subject to change without notice. Anderson™ makes no warranty or representation as to its accuracy. Content in the data sheet may contain technical inaccuracies, typographical errors and may be changed or updated without notice. Anderson™ may also make improvements and/or changes to the products and/or to the programs described in the content at any time without notice. Current sales drawings and specifications are available upon request.

© 2023 Anderson Power Products, Inc. All rights reserved. APP®, A®, Anderson Power Products®, SBE®, SBX®, and the APP Logo are registered trademarks of Anderson Power Products, Inc. Anderson™ and Your Best Connection™ are trademarks of Anderson Power Products, Inc.



**HEADQUARTERS:** Anderson Power Products®, 13 Pratts Junction Road, Sterling, MA 01564-2305 USA T: +1 978-422-3800 F: +1 978-422-0128 • **EUROPE:** Anderson Power Products® Ltd., Unit 3, Europa Court, Europa Boulevard, Westbrook, Warrington, Cheshire, WA5 7TN United Kingdom T: +44 (0) 1925 428390 F: +44 (0) 1925 520203 • **GERMANY:** IDEAL® Industries Germany GmbH, Esslinger Strasse 7, D – 70771 Leinfelden-Echterdingen, T: +49 (0) 711 – 997606666 • **ASIA / PACIFIC:** IDEAL® Anderson Asia Pacific Ltd., Unit 922-928 Topsail Plaza, 11 On Sum Street, Shatin N.T., Hong Kong T: +(852) 2636 0836 F: +(852) 2635 9036 • **INDIA:** IDEAL® INDUSTRIES India Private Limited, 229-230, SPAZEDGE, Tower B, Sector 47, Sohna Road, Gurgaon – 122018, Haryana, India T: +(91) 956-0075905 T: +(91) 124-4495101 • **CHINA:** IDEAL® Anderson Technologies (Shenzhen) Ltd., Block A8 Tantou Western Industrial Park, Songgang Baoan District, Shenzhen, PR. China 518105 T: +(86) 755 2768 2118 F: +(86) 755 2768 2218 • [www.ideal-industries.in](http://www.ideal-industries.in) • [www.andersonpower.com](http://www.andersonpower.com)