

ABAS16-HF

Reverse Voltage: 75 Volts

Forward Current: 150 mA

RoHS Device

Halogen Free

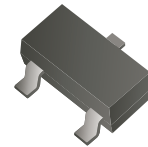

Features

- Epoxy meets UL-94 V-0 flammability rating.
- Moisture sensitivity Level 1.
- AEC-Q101 Qualified.

Mechanical data

- Case: SOT-23, molded plastic.
- Terminals: Tin plated leads, solderable per J-STD-002 and JESD22-B102.

Circuit Diagram

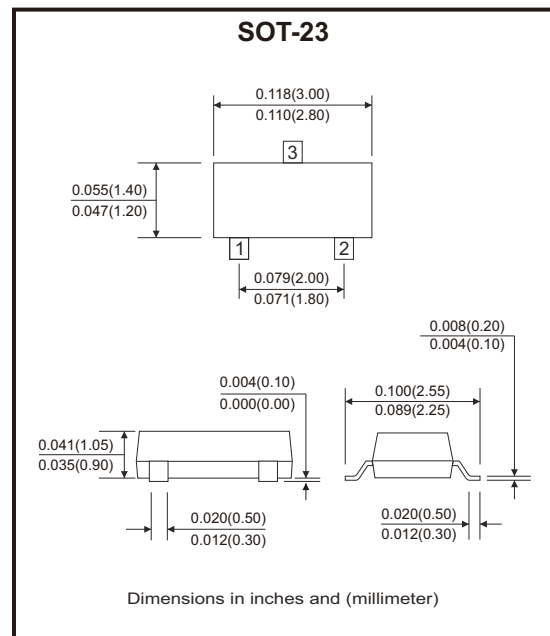
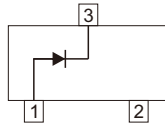

Maximum Rating (at Ta=25°C unless otherwise noted)

Parameter	Symbol	Value	Unit
Reverse voltage	V _R	75	V
Repetitive peak reverse voltage	V _{RRM}	100	V
Average forward current	I _{FAV}	150	mA
Repetitive peak forward current	I _{FRM}	300	mA
Peak forward surge current	I _{FSM}	2 1	A
		Pulse width =1μs Pulse width =1s	
Power dissipation	P _{tot}	350	mW
Thermal resistance junction to ambient	R _{θJA}	357	K/W
Maximum junction temperature range	T _J	-55 to +150	°C
Storage temperature range	T _{STG}	-55 to +150	°C

Electrical Characteristics (at Ta=25°C unless otherwise noted)

Parameter	Symbol	Conditions	Value	Unit
Forward voltage	V _{F1}	I _F =1mA	0.715	V
	V _{F2}	I _F =10mA	0.855	
	V _{F3}	I _F =50mA	1.0	
	V _{F4}	I _F =150mA	1.25	
Reverse current	I _R	V _R =75V	1.0	μA
Breakdown voltage	V _R	I _R =10μA	75	V
Diode capacitance	C _D	V _R =V _F =0V, f=1MHz	4	pF
Reverse recovery time	t _{rr}	I _F =10mA, I _{rr} =0.1I _R , R _L =100Ω	4	nS

Rating and Characteristic Curves (ABAS16-HF)

Fig.1 - P_D — T_A

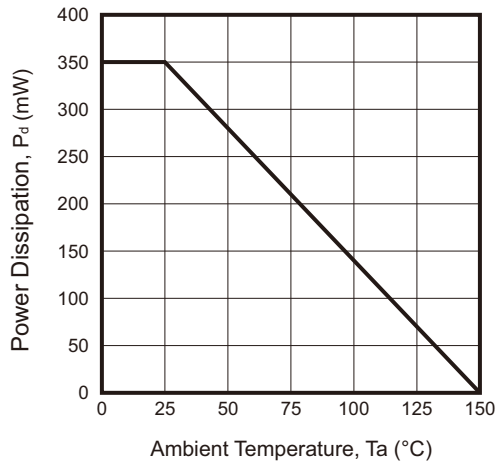

Fig.2 - C_d — V_R

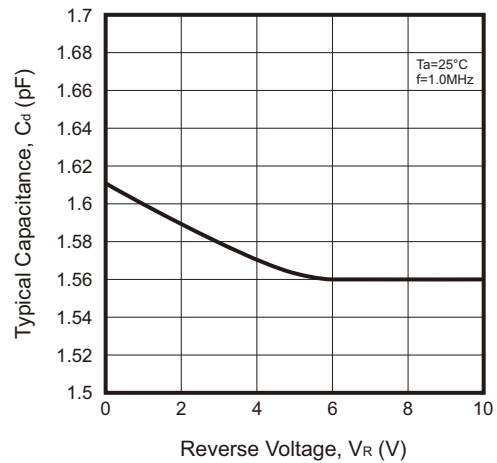

Fig.3 - Forward Characteristics

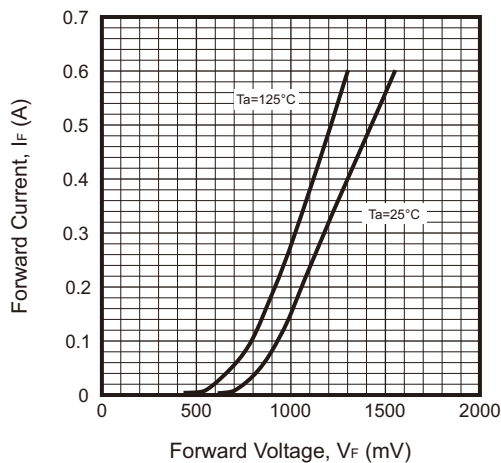
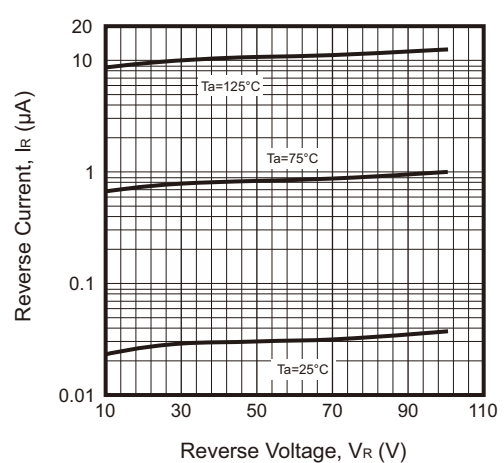

Fig.4 - Reverse Characteristics



Company reserves the right to improve product design, functions and reliability without notice.

REV:A

Reel Taping Specification

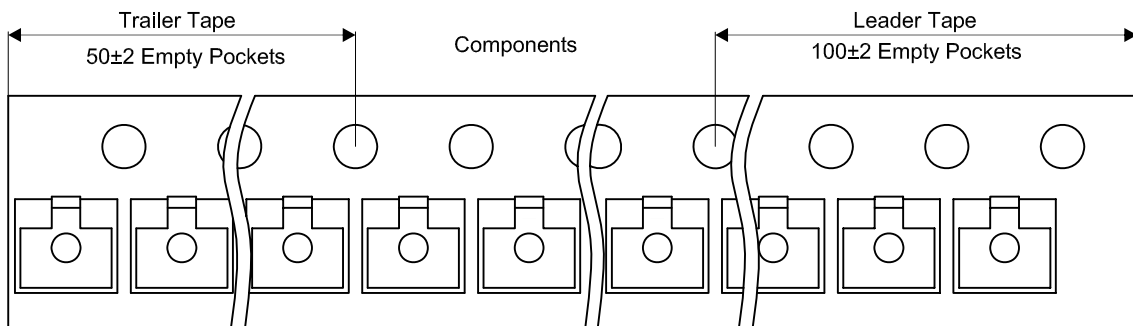
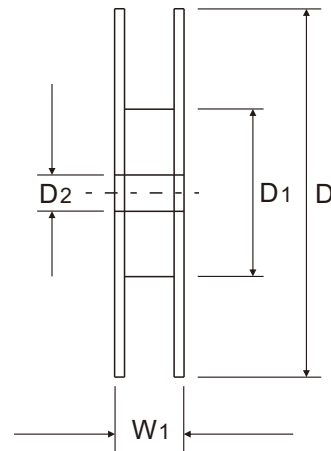
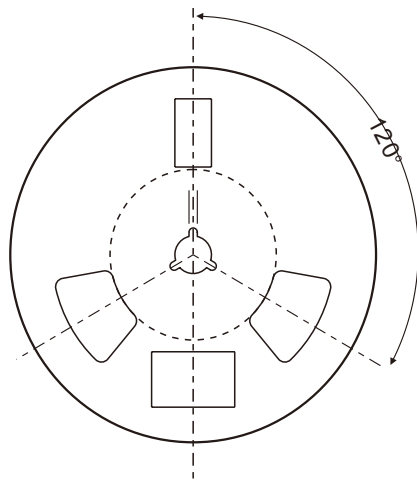
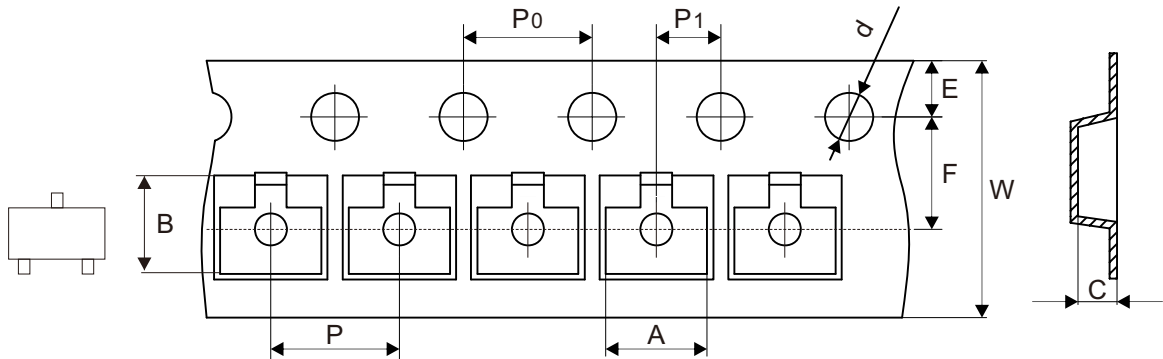

SOT-23	SYMBOL	A	B	C	d	D	D1	D2
	(mm)	3.15 ± 0.10	2.77 ± 0.10	1.22 ± 0.10	1.50 + 0.10 - 0.00	178.00 ± 1.00	54.60 ± 1.00	13.30 ± 1.00
	(inch)	0.124 ± 0.004	0.109 ± 0.004	0.048 ± 0.004	0.059 + 0.004 - 0.000	7.008 ± 0.039	2.150 ± 0.039	0.524 ± 0.039

SOT-23	SYMBOL	E	F	P	P0	P1	W	W1
	(mm)	1.75 ± 0.10	3.50 ± 0.05	4.00 ± 0.10	4.00 ± 0.10	2.00 ± 0.05	8.00 + 0.30 - 0.10	11.10 ± 0.20
	(inch)	0.069 ± 0.004	0.138 ± 0.002	0.157 ± 0.004	0.157 ± 0.004	0.079 ± 0.002	0.315 + 0.012 - 0.004	0.437 ± 0.008

Company reserves the right to improve product design, functions and reliability without notice.

REV:A