

SMA Female Jack to BMA Male Plug

Model Number

ADT-2769-SF-BMM-02

SPECIFICATIONS

Frequency: DC - 18.0 GHz

VSWR: 1.05 + .005 f (GHz)

Impedance: 50 Ohms

Finish: Passivated Stainless Steel

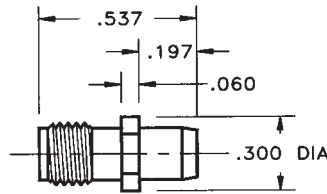

SMA Female Jack to BMA Male Plug - Bulkhead Mount

Model Number

ADT-2797-SF-BMM-02

SPECIFICATIONS

Frequency: DC - 18.0 GHz

VSWR: 1.05 + .005 f (GHz)

Impedance: 50 Ohms

Finish: Passivated Stainless Steel

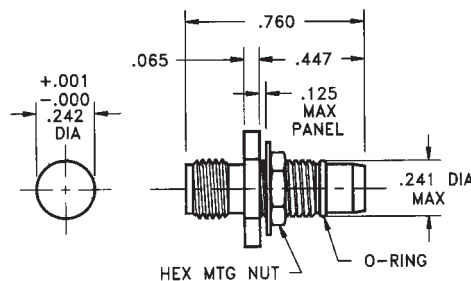

SMA Male Plug to BMA Male Plug

Model Number

ADT-2770-SM-BMM-02

SPECIFICATIONS

Frequency: DC - 18.0 GHz

VSWR: 1.05 + .005 f (GHz)

Impedance: 50 Ohms

Finish: Passivated Stainless Steel

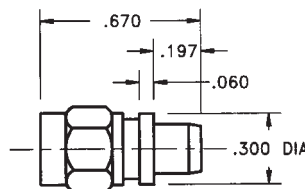

SMA Male Plug to BMA Male Plug - Bulkhead Mount

Model Number

ADT-2798-SM-BMM-02

SPECIFICATIONS

Frequency: DC - 18.0 GHz

VSWR: 1.05 + .005 f (GHz)

Impedance: 50 Ohms

Finish: Passivated Stainless Steel

