

1. SPECIFICATIONS

AMB-O40J38-1CWH-IP67

01	Sensitivity	-38±3dB (0dB=1V/Pa,1KHz)
02	Standard Operation Voltage	2.0 V
03	Output Impedance	2.2 KΩ
04	Directivity	Omni directional
05	Frequency Range	100 - 10K Hz
06	Max. Operation Voltage	10V
07	Current Consumption	Max.0.5mA
08	Sensitivity Reduction	Within -3dB 0dB=1V/Pa,1KHz Vs=2.0to 1.5V
09	S/N Ratio	≥58dB
10	Sound Pressure Level	110 dB
11	Operating Temperature	-20~+60°C
12	Storage Temperature	-30~+70°C

Waterproof (White, IP67)

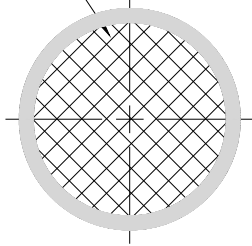

WIRE:UL1571 32# AWG
Connector : Equivalent to Molex 51021-0200
Holder:DD-EQ-JTA49-07

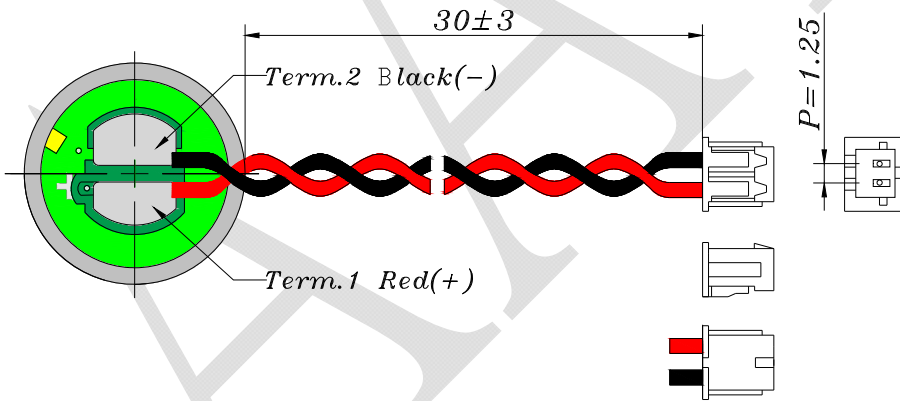
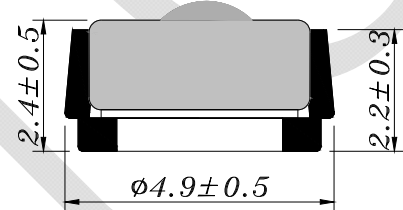
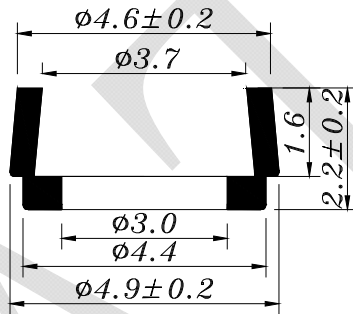
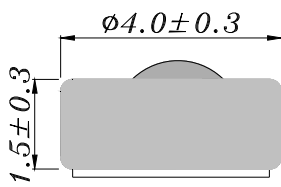

RoHS

TITLE: MICROPHONE		DRAWN: <i>Zack</i>	2019/04/09	SCALE: 5:1	SHEET: 1 of 1
PART NO. AMB-040J38-1CWH-IP67		DESIGNED: R & D OF AAT		UNITS: mm	
DWG NO. T4015AL-SMN-D33-M 11009	2 REV	CHECKED:		TOLERANCE ± 0.3	
		APPROVAL:		UNLESS OTHERWISE SPECIFIED:	
		MATERIAL: *****		ONE PLACE DECIMAL ± ***	
				TWO PLACE DECIMAL ± ***	
				THREE PLACE DECIMAL ± ***	



ADVANCED ACOUSTIC TECHNOLOGY CORPORATION