

THIS IS A C.A.D. GENERATED DRAWING
DO NOT MAKE MANUAL REVISIONS TO MASTER.

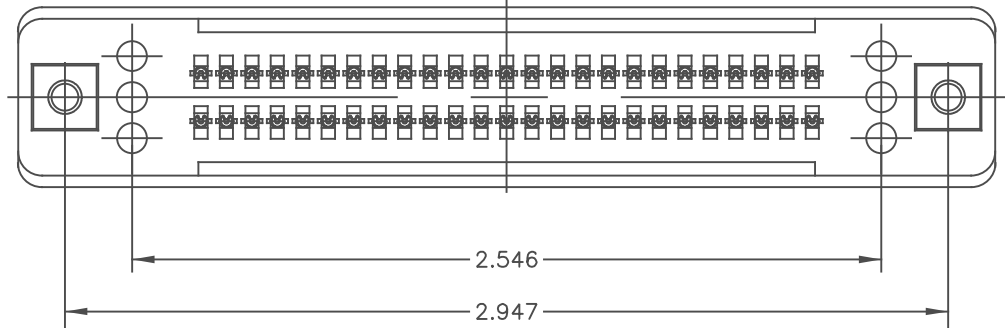

ISSUE NUMBER

ORIGINAL	①
DIM. 3.328 WAS 3.262 AND LEAD IS REMOVED FROM TIN/LEAD PLATING F.BRIONES AUG.10/05	
	②
TIN/LEAD PLATING WAS TIN PLATING; REF TO RoHS EXEMPT ADDED. R.BLAKELY FEB.8/06	
	③
DIM.165 WAS.170 F.BRIONES MAR.6/06	
	④
PAGE 2 ADDED R.Esmaili MAY.1/19	
	⑤

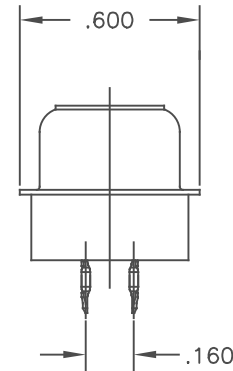
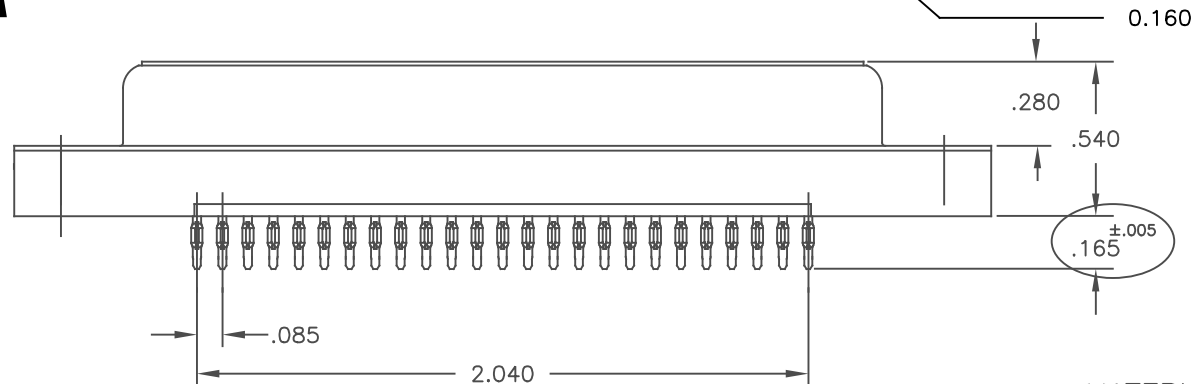
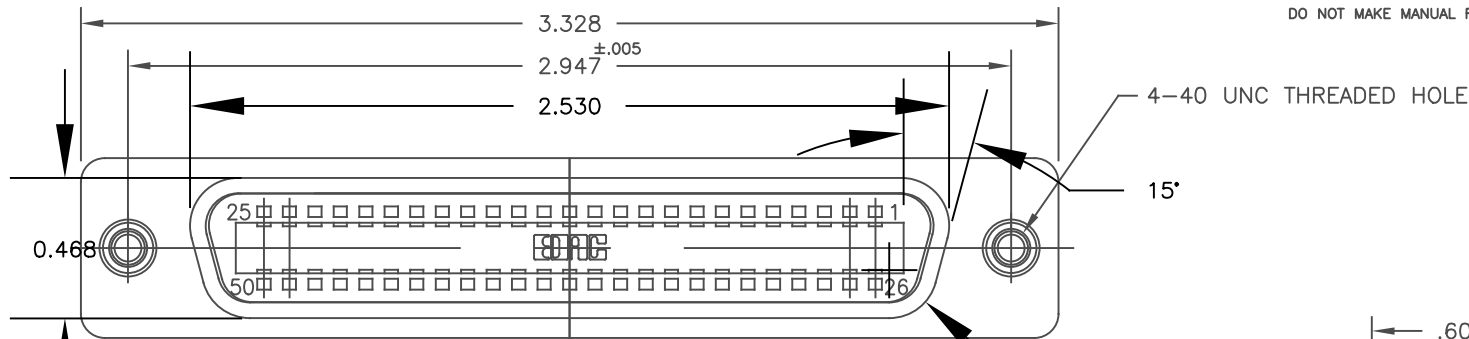

MATERIALS:

- INSULATOR : THERMOPLASTIC POLYESTER COLOR BLUE
- SHELL: STEEL, NICKEL PLATED
- CONTACTS: PHOSPHOR BRONZE 30 MICROINCHES OF GOLD ON ON CONTACT AREA TIN ON COMPLIANT SECTION OVER NICKEL
- THREADED INSERTS: BRASS, NICKEL PLATED

CONNECTOR PART NO. B57-050-620-202

50 POSITION MINIATURE RIBBON RECEPTACLE
COMPLIANT PIN (PRESS FIT)

ACAD REFERENCE NO. B57-050-620-202

DRAWN: F.BRIONES DATE: AUG.28/00

CHECKED: DATE:

SCALE: IN C.A.D. 1:1 SHEET 1 OF 2

DRAWING NUMBER B57-050-620-202 ISSUE 5



THIS PRODUCT CONFORMS TO THE EUROPEAN UNION DIRECTIVES 2002/95/EC AND 2002/96/EC FOR RoHS COMPLIANCY WITH EXEMPTION #11: LEAD USED IN COMPLIANT PIN CONNECTOR SYSTEMS.



EDAC INC
TORONTO, ONTARIO
CANADA

YOUR CONNECTION TO QUALITY & SERVICE

THESE DRAWINGS AND SPECIFICATIONS ARE THE PROPERTY OF EDAC INC., AND SHALL NOT BE REPRODUCED, OR COPIED OR USED AS THE BASIS FOR THE MANUFACTURE OR SALE OF APPARATUS WITHOUT WRITTEN PERMISSION.

THIS IS A C.A.D. GENERATED DRAWING
DO NOT MAKE MANUAL REVISIONS TO MASTER.



ISSUE NUMBER	
ORIGINAL	①
DIM. 3.328 WAS 3.262 AND LEAD IS REMOVED FROM TIN/LEAD PLATING F.BRIONES AUG.10/05	
	②
TIN/LEAD PLATING WAS TIN PLATING; REF TO RoHS EXEMPT ADDED. R.BLAKELY FEB.8/06	
	③
DIM.165 WAS.170 F.BRIONES MAR.6/06	
	④
PAGE 2 ADDED R.Esmaeili MAY.1/19	
	⑤

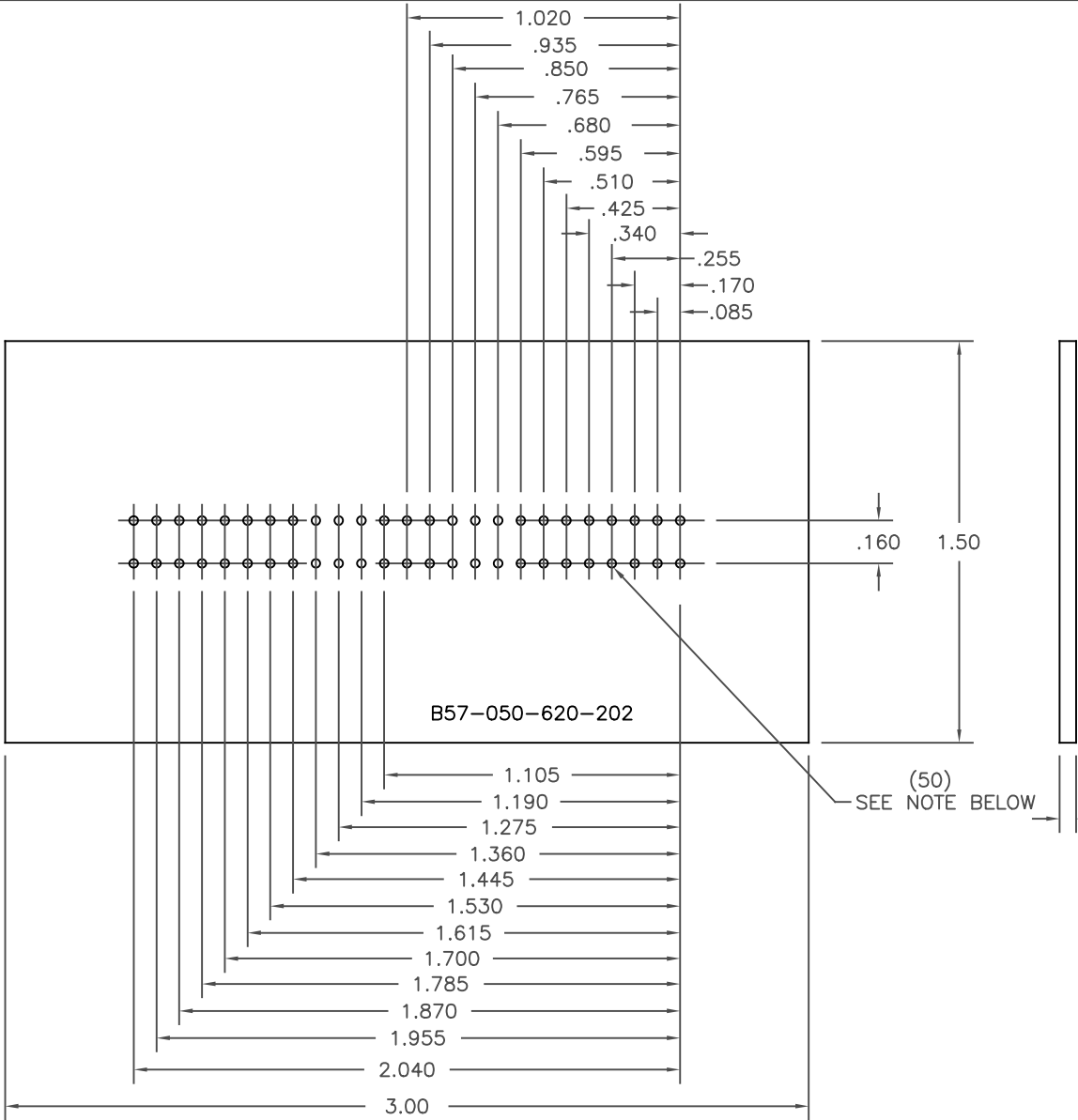

NOTE:
TO OBTAIN OPTIMUM COMPLIANT SECTION PERFORMANCE,
DRILL HOLES $.038 \pm .001$ DIAMETER
COPPER PLATE, $.001$ MINIMUM THICKNESS FOLLOWED BY
TIN PLATE TO PROVIDE FINISHED HOLES $.030/.035$ DIAMETER



THIS PRODUCT CONFORMS TO THE EUROPEAN UNION DIRECTIVES 2002/95/EC AND 2002/96/EC FOR RoHS COMPLIANCY WITH EXEMPTION #11: LEAD USED IN COMPLIANT PIN CONNECTOR SYSTEMS.

CONNECTOR PART NO. B57-050-620-202

50 POSITION MINIATURE RIBBON RECEPTACLE COMPLIANT PIN (PRESS FIT)



EDAC INC
TORONTO, ONTARIO
CANADA

YOUR CONNECTION TO QUALITY & SERVICE

THESE DRAWINGS AND SPECIFICATIONS ARE THE PROPERTY OF EDAC INC., AND SHALL NOT BE REPRODUCED, OR COPIED OR USED AS THE BASIS FOR THE MANUFACTURE OR SALE OF APPARATUS WITHOUT WRITTEN PERMISSION.

ACAD REFERENCE NO. B57-050-620-202	
DRAWN: F.BRIONES	DATE: AUG.28/00
CHECKED:	DATE:
SCALE: IN C.A.D. 1:1	SHEET 2 OF 2
DRAWING NUMBER B57-050-620-202	ISSUE 5