



COAXIAL

DC Block

BLK-18W-S+

50Ω 0.01 to 18 GHz SMA Female to SMA Male

FEATURES

- Broadband performance
- Low Insertion loss
- Rugged unibody construction
- Off-the-shelf availability



Generic photo used for illustration purposes only

APPLICATIONS

- Test and Measurement Instrumentation
- Communication Systems
- Defense Systems

Model No.	BLK-18W-S+
Case Style	DJ2668
Connectors	SMA F-SMA M

+RoHS Compliant
 The +Suffix identifies RoHS Compliance.
 See our website for methodologies and qualifications

ELECTRICAL SPECIFICATIONS AT 25°C

Parameter	Frequency (GHz)	Min.	Typ.	Max.	Units
Frequency Range		0.01		18	GHz
Insertion Loss	0.01-18	—	0.41	0.75	dB
Return Loss	0.01-18	16.5	23	—	dB

ABSOLUTE MAXIMUM RATINGS

Parameter	Ratings
Operating Case Temperature	-55 °C to +125 °C
Storage Temperature	-55 °C to +125 °C
DC Input Voltage	200 V
Input Power	33 dBm

Permanent damage may occur if any of these limits are exceeded.

ELECTRICAL SCHEMATIC

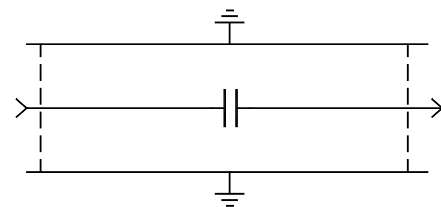



COAXIAL

DC Block

BLK-18W-S+

Mini-Circuits

50Ω 0.01 to 18 GHz SMA Female to SMA Male

COAXIAL CONNECTIONS

Port 1	SMA - Female
Port 2	SMA -Male

OUTLINE DRAWING

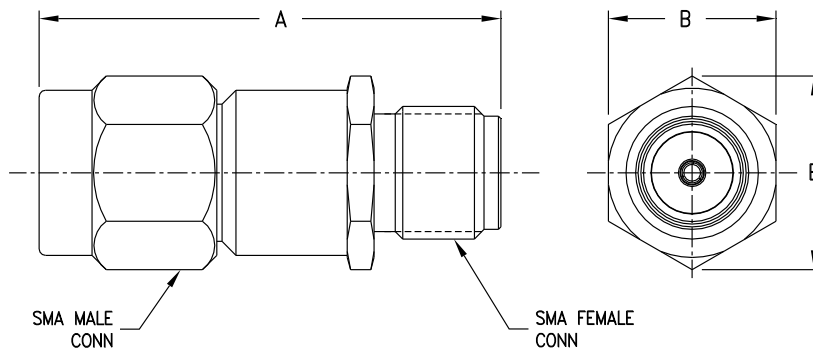

OUTLINE DIMENSIONS (Inches) mm

	A	B	E	Weight Grams
inches	0.86	0.31	.36	
mm	21.84	8.00	9.14	5.0