

RUGGED MULTI-CHANNEL RS-422 CONCENTRATOR & EXTENDER (CF-020010-61X)

PDS-283



DESCRIPTION

Amphenol High Speed Solutions is pleased to introduce a new multi-channel RS-422 data concentrator and extender. This is a stand-alone unit with 13-32VDC power interface to the system. Its 6X bi-directional channels of RS-422 are electro-optically isolated from system interfaces and concentrated onto a single channel of 850nm multi-mode fiber optics at 1Gbps. Two units can be connected for seamless plug and play extension of the RS-422 interfaces. A separate RS-422 interface from the unit gives built-in-test and diagnostics information.



CF-020010-61X



DIMENSIONS

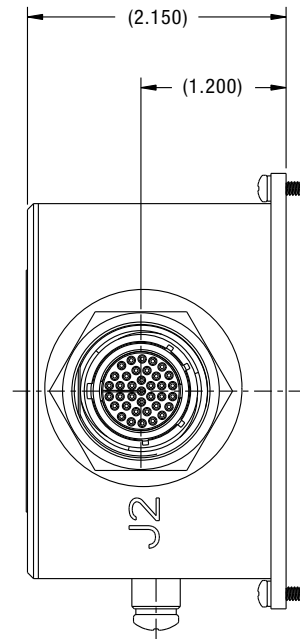
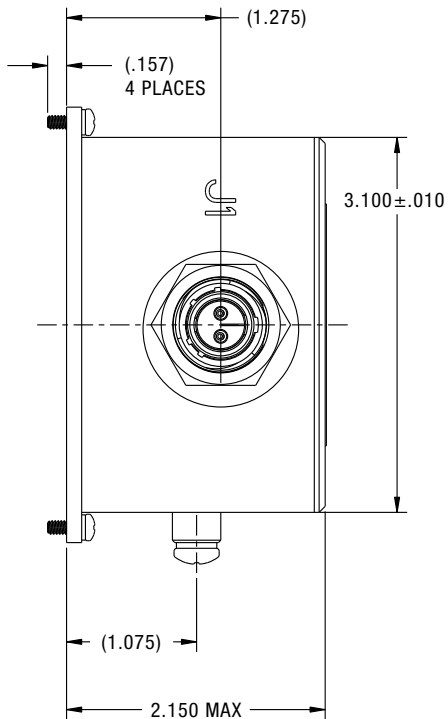
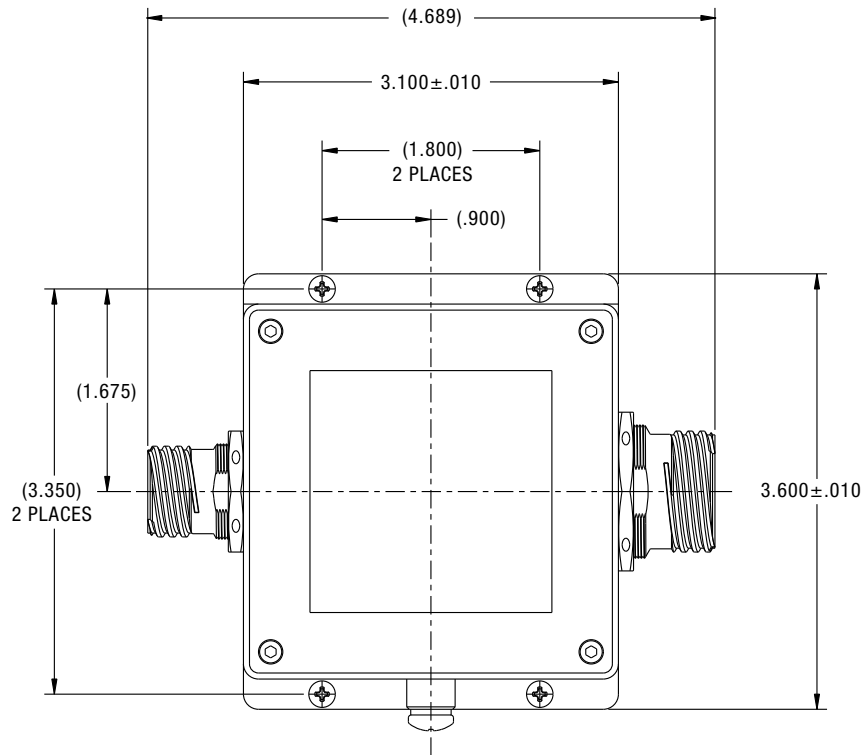

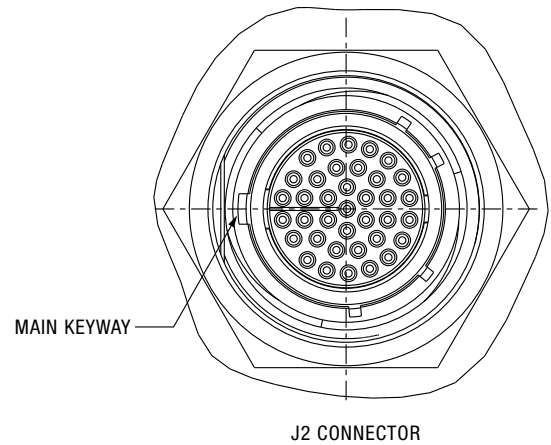
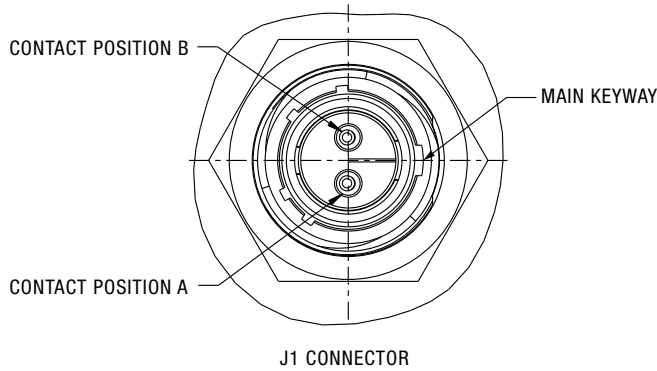

| Electrical Interconnection List | | |
|---------------------------------|-----|--|
| Connector | Pin | Comments |
| J1 | A | Fiber Optic Transmitter, 850nm 1.25 Gbps |
| J1 | B | Fiber Optic Reciever 850nm 1.25 Gbps |
| J2 | 1 | Port 1 out P , RS422 Port 1 Tx Pos |
| J2 | 2 | Port 1 out N , RS422 Port 1 Tx Neg |
| J2 | 3 | Port 1 in P , RS422 Port 1 Rx Pos |
| J2 | 4 | Port 1 in N , RS422 Port 1 Rx Neg |
| J2 | 5 | Not Connected |
| J2 | 6 | Port 2 out P , RS422 Port 2 Tx Pos |
| J2 | 7 | Port 2 out N , RS422 Port 2 Tx Neg |
| J2 | 8 | Port 2 in P , RS422 Port 2 Rx Pos |
| J2 | 9 | Port 2 in N , RS422 Port 2 Rx Neg |
| J2 | 10 | Not Connected |
| J2 | 11 | Port 3 out P , RS422 Port 3 Tx Pos |
| J2 | 12 | Port 3 out N , RS422 Port 3 Tx Neg |
| J2 | 13 | Port 3 in P , RS422 Port 3 Rx Pos |
| J2 | 14 | Port 3 in N , RS422 Port 3 Rx Neg |
| J2 | 15 | Not Connected |
| J2 | 16 | Port 4 out P , RS422 Port 4 Tx Pos |
| J2 | 17 | Port 4 out N , RS422 Port 4 Tx Neg |
| J2 | 18 | Port 4 in P , RS422 Port 4 Rx Pos |
| J2 | 19 | Port 4 in N , RS422 Port 4 Rx Neg |
| J2 | 20 | Not Connected |

| | | |
|----|----|------------------------------------|
| J2 | 21 | Port 5 out P , RS422 Port 5 Tx Pos |
| J2 | 22 | Port 5 out N , RS422 Port 5 Tx Neg |
| J2 | 23 | Port 5 in P , RS422 Port 5 Rx Pos |
| J2 | 24 | Port 5 in N , RS422 Port 5 Rx Neg |
| J2 | 25 | Not Connected |
| J2 | 26 | Port 6 out P , RS422 Port 6 Tx Pos |
| J2 | 27 | Port 6 out N , RS422 Port 6 Tx Neg |
| J2 | 28 | Port 6 in P , RS422 Port 6 Rx Pos |
| J2 | 29 | Port 6 in N , RS422 Port 6 Rx Neg |
| J2 | 30 | Bit out P , RS422 Bit Output |
| J2 | 31 | Bit out N , RS422 Bit Output |
| J2 | 32 | Bit_Led_An, Bit Led Output Anode |
| J2 | 33 | Bit_Led_Ca, Bit Led Output Cathode |
| J2 | 34 | Power, 13-32VDC Power Input |
| J2 | 35 | Power_RTN, 13-32VDC Power Input |
| J2 | 36 | Not Connected |
| J2 | 37 | Not Connected |

BLOCK DIAGRAMS

A.

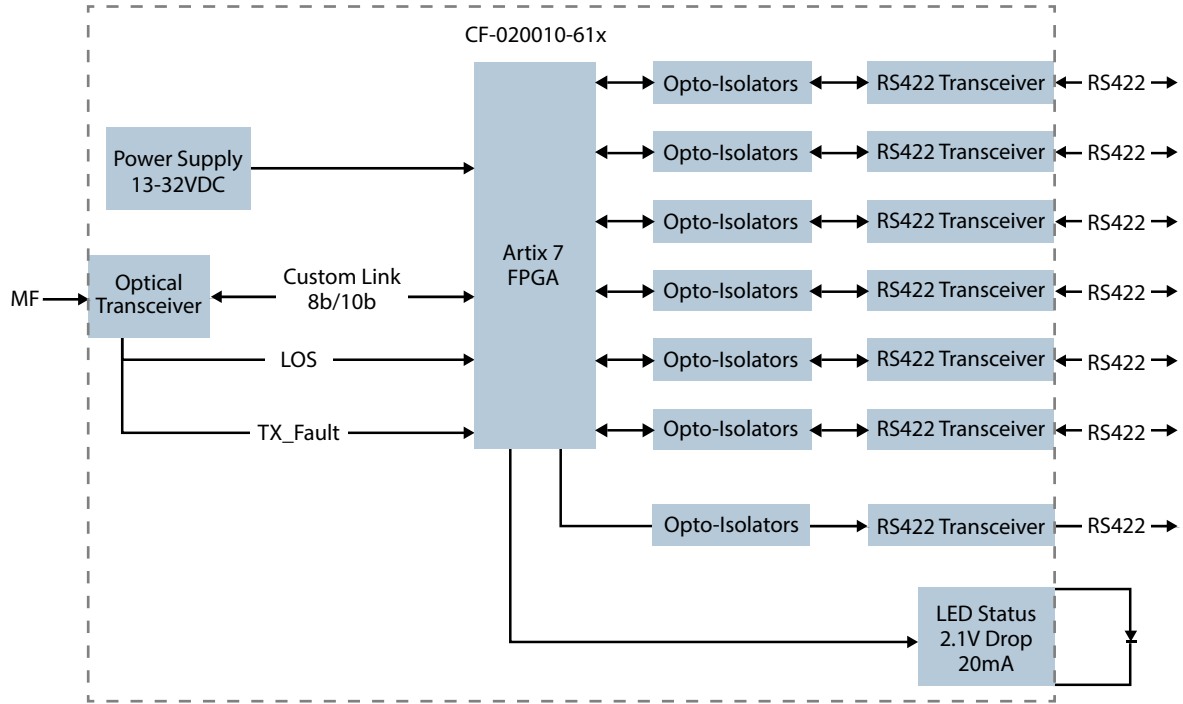

B.

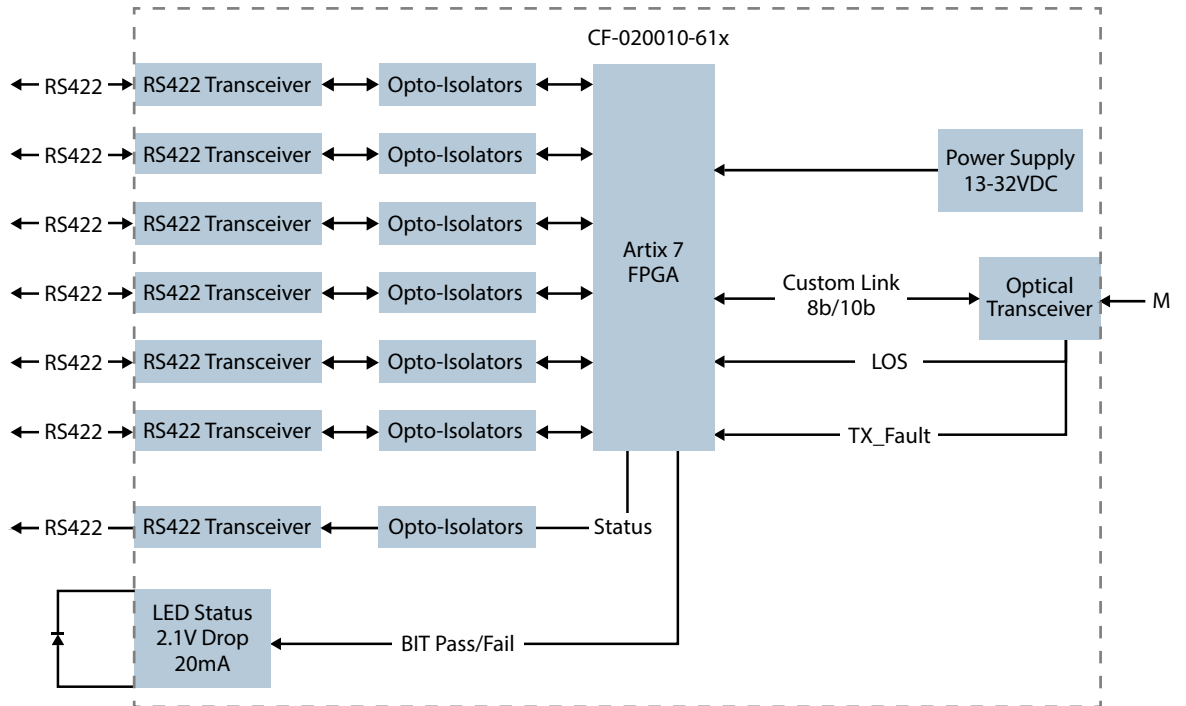

SYSTEM BLOCK DIAGRAM

