

# Commercial Grade Terminations

2.4mm and 2.92mm

## Features

- Best combination of price and performance
- For all commercial use
- 40 GHz operation for 2.92mm models
- 50 GHz operation for 2.4mm models
- Passivated stainless-steel construction
- Male and Female versions available

## Applications

- Active antenna systems
- 5G network hardware
- Test setups
- Lab use

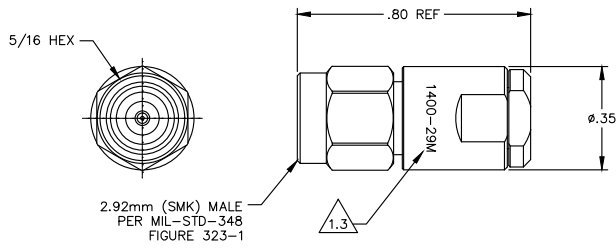
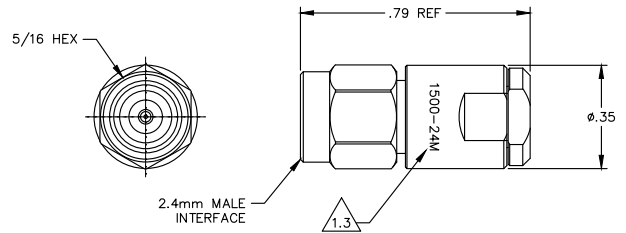
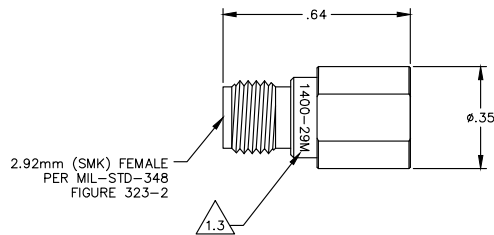
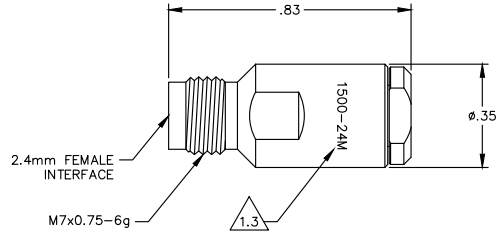

Part Number	Termination Type	Frequency
CGT-1400-F0-29M-02	2.92mm Female	40GHz
CGT-1400-M0-29M-02	2.92mm Male	40GHz
CGT-1500-F0-24M-02	2.4mm Female	50GHz
CGT-1500-M0-24M-02	2.4mm Male	50GHz

**CGT-1400-M0-29M-02**

**CGT-1500-M0-24M-02**

**CGT-1400-F0-29M-02**

**CGT-1500-F0-24M-02**

## Commercial Grade 2.4mm and 2.92mm Terminations

### Materials

<b>Housing</b>	Passivated stainless steel
<b>Coupling nut</b>	Passivated stainless steel
<b>Male Center Contact</b>	Gold plated beryllium copper
<b>Female Center Contact</b>	Gold plated beryllium copper

### Environmental

<b>Thermal Shock</b>	MIL-STD-202G Method 107, Test Condition B
<b>Vibration</b>	MIL-STD-202G Method 204, Test Condition D
<b>Shock</b>	MIL-STD-202G Method 213, Test Condition I
<b>Humidity</b>	MIL-STD-202G Method 106
<b>Salt Spray</b>	MIL-STD-202G Method 101, Test Condition B
<b>Operating Temperature</b>	-55°C to 125°C

### Electrical

	2.92mm models	2.4mm models
<b>Frequency of Operation</b>	DC-40GHz	DC-50GHz
<b>Impedance</b>	50Ω (Nominal)	50Ω (Nominal)
<b>VSWR</b>	1.2:1 (max.)	1.22:1 (max.)
<b>Input Power (at 25°C)</b>	0.25W (CW)	0.25W (CW)

### Mechanical

<b>Mating Torque</b>	7-10 inch-pounds
<b>Durability</b>	500 cycles (min.)