

THIS COPY IS PROVIDED ON A RESTRICTED BASIS AND IS NOT TO BE USED IN ANY WAY DETRIMENTAL TO THE INTERESTS OF PANDUIT CORP.

PANDUIT PART#	WEIGHT
CMHDMI**	.04 LB/EACH PC (17.44 g/EACH PC)

NOTES:

1. SEE CURRENT CATALOG FOR ADDITIONAL PART NUMBER SUFFIXES TO INDICATE COLOR AND OR PACKAGE QUANTITY.
2. SEE CATALOG FOR COMPLETE LIST OF PARTS APPLICABLE FOR USE WITH THIS PART.
3. DIMENSIONS IN [] ARE METRIC.

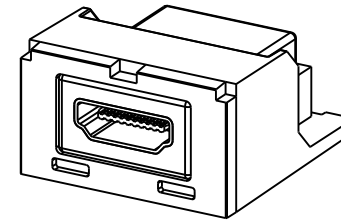
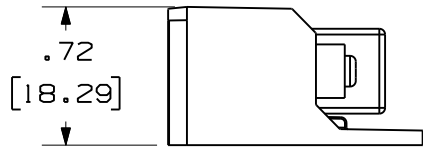
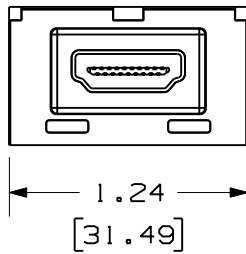
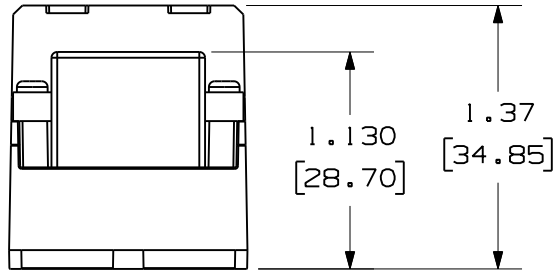

MODEL FILENAME	M03195AD/00	SIZE	A
DRAWING FILENAME	M03195AD_DC11/00A		
MINI-COM HDMI 1.3 TYPE A FEMALE TO FEMALE CATEGORY 2 COUPLER CUSTOMER DRAWING			
	PANDUIT ® CORP. TINLEY PARK, IL 60477	I.I. NUMBER	N/A
		PRODUCT SPEC	N/A
	THIRD ANGLE PROJECTION	WORK INSTRUCTION	N/A
	ALL DIMENSIONS ARE GIVEN IN INCHES, UNLESS OTHERWISE SPECIFIED. DIMENSIONAL TOLERANCES ARE: (.X) ±.03 (.XXX) ±.005 (.XX) ±.01 ANGLES ± 1°	SCALE	1:1
DRAWN BY	MDJr	MATERIALS:	PART NO.
DATE	8-27-09	CONNECTOR SHELL: BRASS/TIN-LEAD PLATED OVER COPPER	CMHDMI**
CHK'D		CONNECTOR HOUSING: PBT	DRAWING NO.
		CONNECTOR CONTACT: COPPER ALLOY	03195-11
		HOUSING: ABS	

REV	DATE	BY	CHK	DESCRIPTION	ECN	R	CUST	SUP	OTH
R	9-17-09	MDJr		RELEASED TO PRODUCTION	03195-11				