

## DATASHEET

### CMMCXJ044 • CONNECTOR



## Description

- MMCX (F) Jack Straight Connector
- PCB Through Hole Mount
- Dimensions: 6.4mm x 3.7mm

# Contents

1. Introduction	2
2. General data	2
3. Part number	3
4. Drawing	3
5. Hazardous Material Regulation Conformance	4

## 1. Features

PCB mounted MMCX jack straight connector  
 Maximum PCB thickness is 1.6mm  
 MMCX Female straight RF connector  
 Gold plated for high reliability

## 2. General data

ELECTRICAL	
IMPEDANCE	50Ω
FREQUENCY RANGE	DC ~ 6GHz
WORKING VOLTAGE	Max ≤ 335 Vrms
DIELECTRIC WITHSTANDING VOLTAGE	750 Vrms
INSULATION RESISTANCE	≥ 1000MΩ
CENTER CONTACT RESISTANCE	≤ 10mΩ
OUTER CONTACT RESISTANCE	≤ 5mΩ
VSWR	≤ 1.3
DURABILITY	> 500 cycles
MECHANICAL	
CONNECTOR DIMENSIONS	6.4mm * 3.7mm
CONNECTOR PIN DIMENSION	0.7mm
CONNECTOR TYPE	MMCX Jack Straight
ENVIRONMENTAL	
HAZARDOUS MATERIAL REGULATION	RoHS compliant
OPERATING TEMPERATURE	-40°C to +90°C

### 3. Part number

Part Number – CMMCXJ044

### 4. Drawing

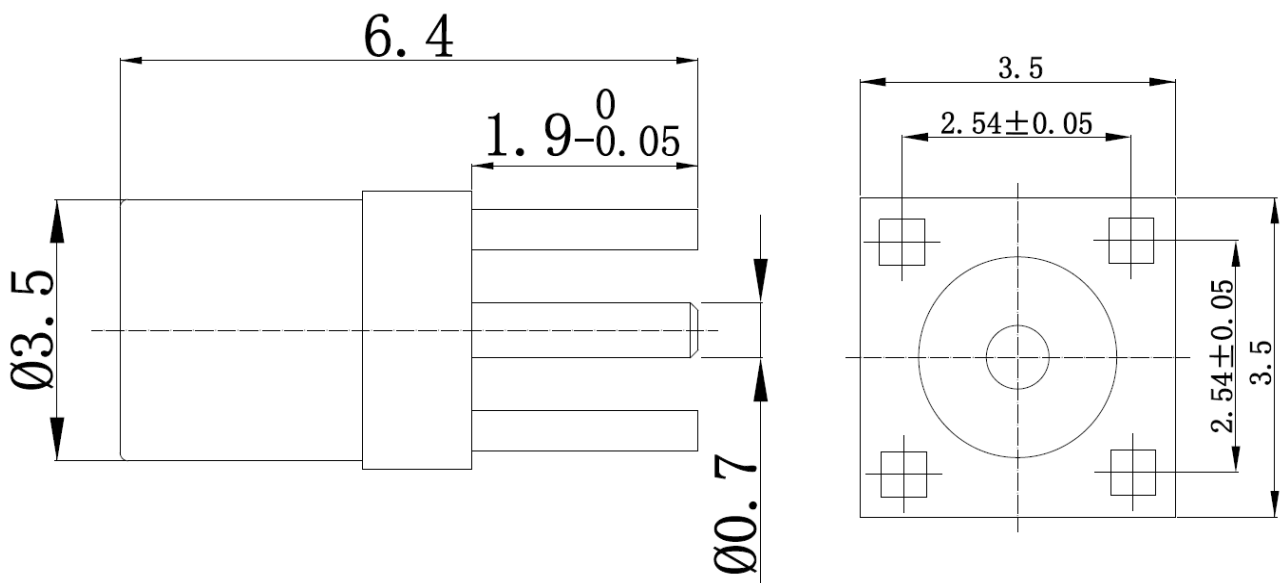

		MATERIAL	FINISH	QTY
1	Body	Brass	Gold	1
2	Insulator	PTFE	White	1
3	Contact Pin	Beryllium Copper	Gold	1

## 5. Hazardous Material Regulation Conformance

---

The connector has been tested to conform to RoHS requirements.

A certification of conformance is available from Antenova's website.

### Quality statements

Antenova's products conform to REACH and RoHS legislation. For our statements regarding these and other quality standards, please see [antenova.com](http://antenova.com).



Antenova reserves all rights to the contents of this document. Antenova gives no warranties based solely on the accuracy or completeness of the contents of this document and reserves the right to make changes to the specifications of the products described herein at any time and without notice.

Datasheet version

1.01 release Mar 15 2023