

NOTES:

- ROHS COMPLIANT
- MATERIAL:
 PANEL CONNECTOR SOCKET - POLYPROPYLENE, UL RATING 94-HB
 HEADER CONNECTOR - POLYESTER, UL RATING 94-V0
 TERMINALS - PHOSPHOR BRONZE, TIN PLATE
 WIRE - 24 AWG 1007/ 1569
- MOUNTING: HOLE SIZE - 9/32" (7.14mm)
- PANEL THICKNESS: .030" (.762mm) MIN - .125" (3.175mm) MAX
 FOR PANEL THICKNESS .030" (.762mm) - .045" (1.143mm) USE 2 SPC 060 SPACERS
 FOR PANEL THICKNESS .050" (1.27mm) - .100" (2.54mm) USE 1 SPC 060 SPACER
 FOR PANEL THICKNESS .105" (2.67mm) - .125" (3.175mm) NO SPACER REQUIRED
- LED LEAD LENGTH: FOR CMC 285 - .350" ± .01" (8.89mm ± 0.254mm)
 FOR CMC 313, CMC 321, CMC 323, AND CMS 322 - .250" ± 0.01" (6.35mm ± 0.254)
- U.S. & FOREIGN PATENT ISSUED AND PENDING

| REVISIONS | | | | |
|-----------|-----|----------------------------|----------|----------|
| ECN # | REV | DESCRIPTION | DATE | INITIALS |
| | 001 | REVISED PER ECR 111009AZ01 | 11/26/10 | KH |

LED/ SPACER
(ORDER SEPARATELY)



5MM LED



SPC 060

CABLE ORDERING CODE EXAMPLE:

CNX C E 4 1 12

| TERMINATION * | |
|---------------|---------------------------|
| X = | STRIPPED END |
| E = | SINGLE ROW LOCKING HEADER |
| G = | SINGLE ROW PLAIN HEADER |

| WIRE SIZE * | |
|-------------|--------|
| 4 | 24 AWG |

| WIRE COLOR * | |
|--------------|---------------|
| 1 | WHITE - BLACK |
| 2 | RED - BLACK |

| WIRE LENGTH * | |
|---------------|---------------------|
| 04 | 4 INCHES (101.6mm) |
| 06 | 6 INCHES (152.4mm) |
| 08 | 8 INCHES (203.2mm) |
| 12 | 12 INCHES (304.8mm) |
| 18 | 18 INCHES (457.2mm) |
| 24 | 24 INCHES (609.6mm) |

* CALL
FACTORY FOR
ADDITIONAL
OPTIONS

LENS/ PANEL MOUNT
(ORDER SEPARATELY)

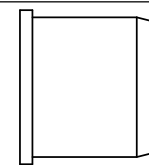

CMC 285

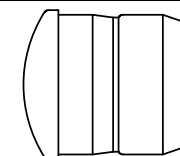

CMC 313
CMC 321
CMC 323

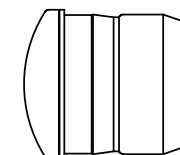

CMS 322

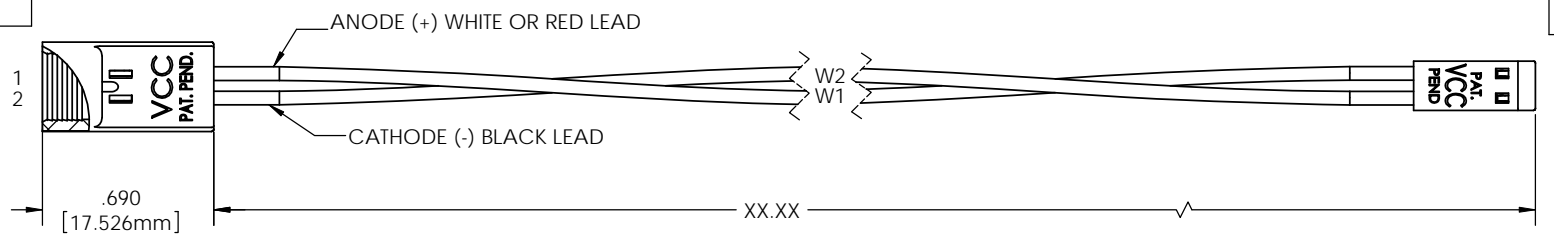

| | | | |
|--|------------------------------|--|-------------------------------|
| DIMENSION STYLE: INCHES / MM GENERAL TOLERANCES UNLESS OTHERWISE SPECIFIED: INCHES ± .500 MM ± 12.7 THIRD ANGLE PROJECTION PROPRIETARY AND CONFIDENTIAL THE INFORMATION CONTAINED IN THIS DRAWING IS THE SOLE PROPERTY OF VISUAL COMMUNICATIONS COMPANY, INC. ANY REPRODUCTION IN PART OR AS A WHOLE WITHOUT THE WRITTEN PERMISSION OF VISUAL COMMUNICATIONS COMPANY, INC IS PROHIBITED. | MATERIAL SEE NOTES | VCG OPTOELECTRONICS 190 BOSSTICK BLVD. SUITE 101 SAN MARCOS, CA 92069 U.S.A. PHONE: (760) 560-1300, FAX: (760) 560-1301 EMAIL: vc csales@vcc-lite.com | |
| | FINISH SEE NOTES | TITLE: CNX C CABLE ASSEMBLY | |
| APPROVAL DRAWN K.Howard CHECKED DPZ DO NOT SCALE DRAWING | DATE 11/26/10 11/26/10 | SIZE B | DWG. NO. CNX C ASSY |
| | | REV 001 | SHEET 1 OF 1 |