

D1FJ8

Schottky Barrier Diodes 80V, 2A

Feature

- Small SMD
- High Recovery Speed
- Available for automotive use
- Pb free terminal
- RoHS:Yes

OUTLINE

Package (House Name): 1F
Package (JEDEC Code): DO-214AC



Equivalent circuit

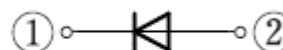

Absolute Maximum Ratings (unless otherwise specified : Tl=25°C)

| Item | Symbol | Conditions | Ratings | Unit |
|---------------------------------|--------------------|---|------------|------|
| Storage temperature | T _{stg} | | -55 to 150 | °C |
| Junction temperature | T _j | | 150 | °C |
| Repetitive peak reverse voltage | V _{RRM} | | 80 | V |
| Average forward current | I _{F(AV)} | 50Hz sine wave, Resistance load, T _c =110°C | 2 | A |
| Average forward current | I _{F(AV)} | 50Hz sine wave, Resistance load, On glass-epoxy substrate, T _a =25°C ※ | 1.7 | A |
| Surge forward current | I _{FSM} | 50Hz sine wave, Non-repetitive, 1 cycle, Peak value, T _j =25°C | 30 | A |

※ :See the original Specifications

Electrical Characteristics (unless otherwise specified : Tl=25°C)

| Item | Symbol | Conditions | Ratings | | | Unit |
|--------------------|---------------|---|---------|-----|------|------|
| | | | MIN | TYP | MAX | |
| Forward voltage | V_F | $I_F=1.5A$, Pulse measurement | | | 0.74 | V |
| Reverse current | I_R | $V_R=80V$, Pulse measurement | | | 0.2 | mA |
| Total capacitance | C_t | $f=1MHz$, $V_R=10V$ | | 40 | | pF |
| Thermal resistance | $R_{th(j-c)}$ | Junction to case | | | 16 | °C/W |
| Thermal resistance | $R_{th(j-a)}$ | Junction to ambient, On glass-epoxy substrate ※ | | | 65 | °C/W |

※ :See the original Specifications

CHARACTERISTIC DIAGRAMS

Forward Voltage

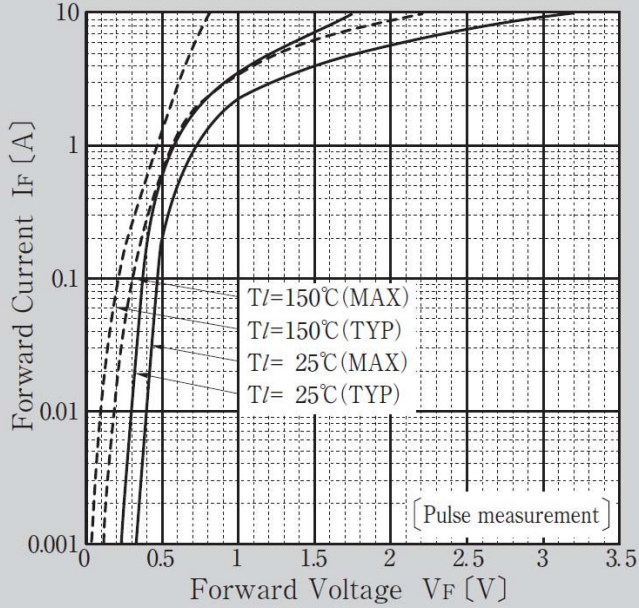

Reverse Current

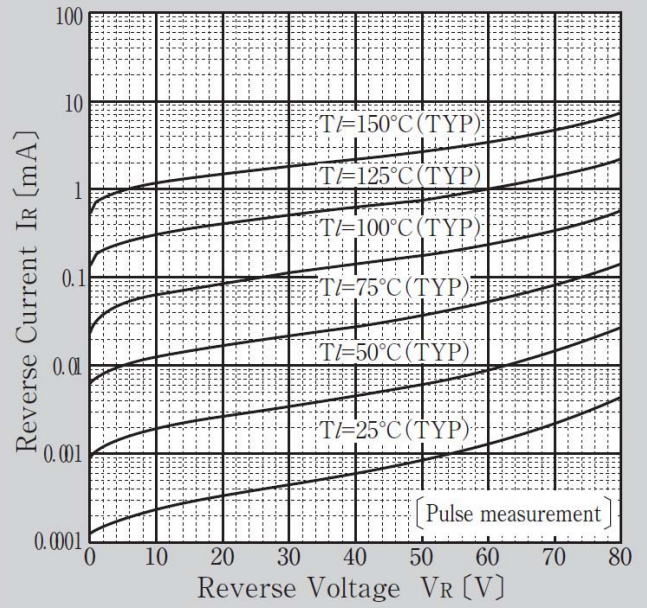

Forward Power Dissipation

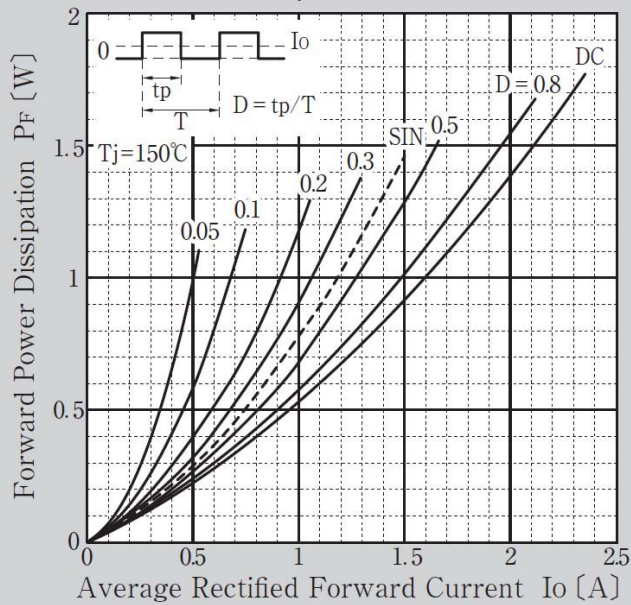

Reverse Power Dissipation

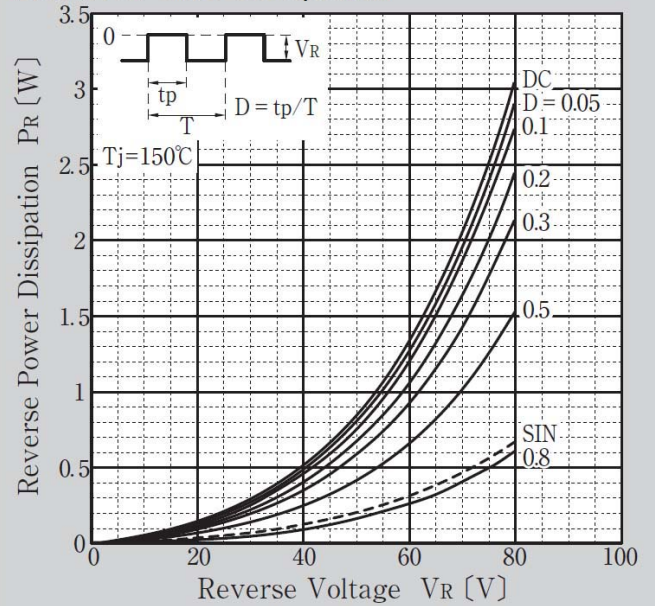

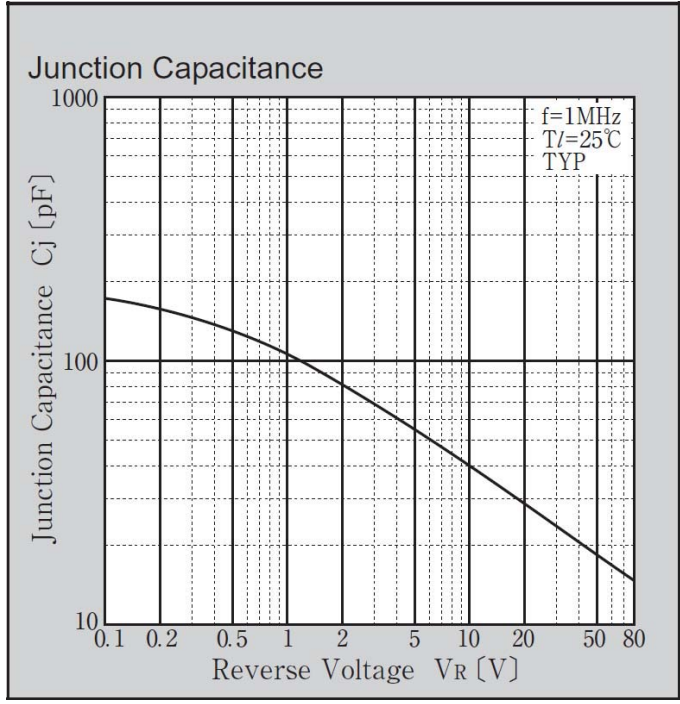
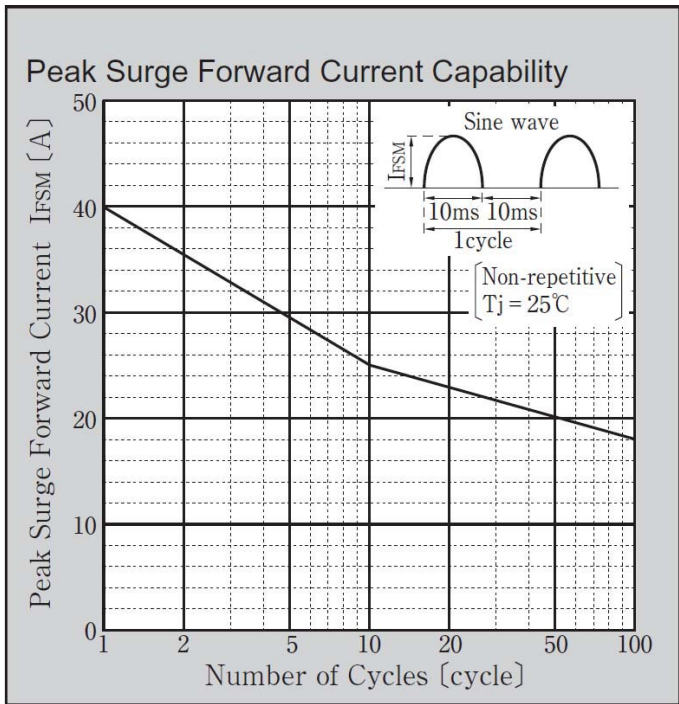
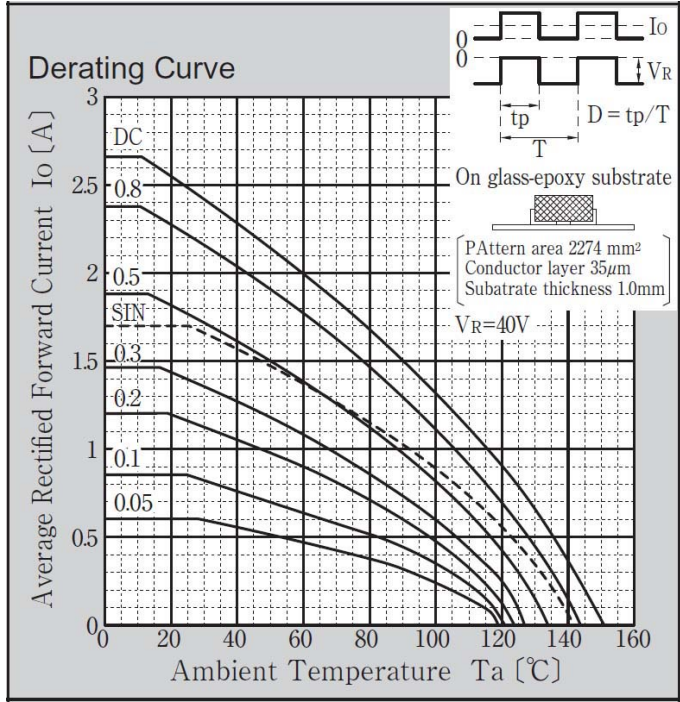
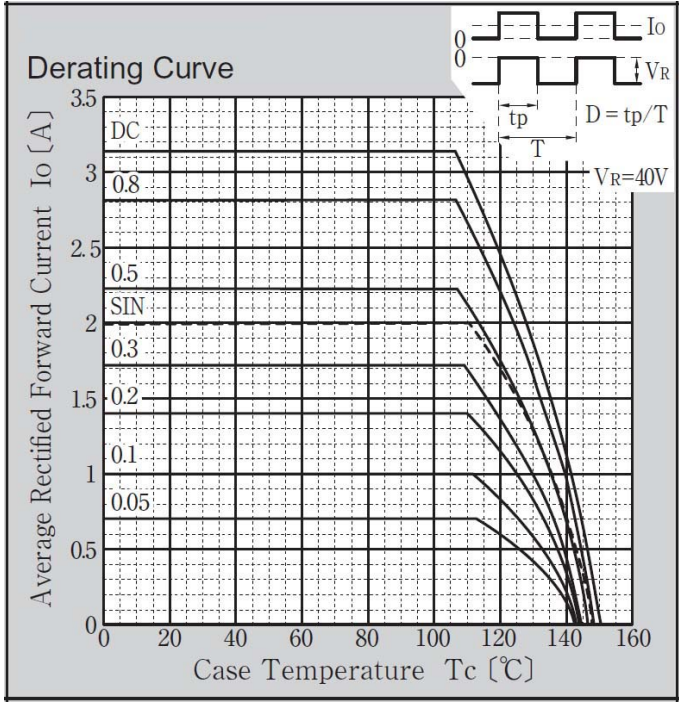

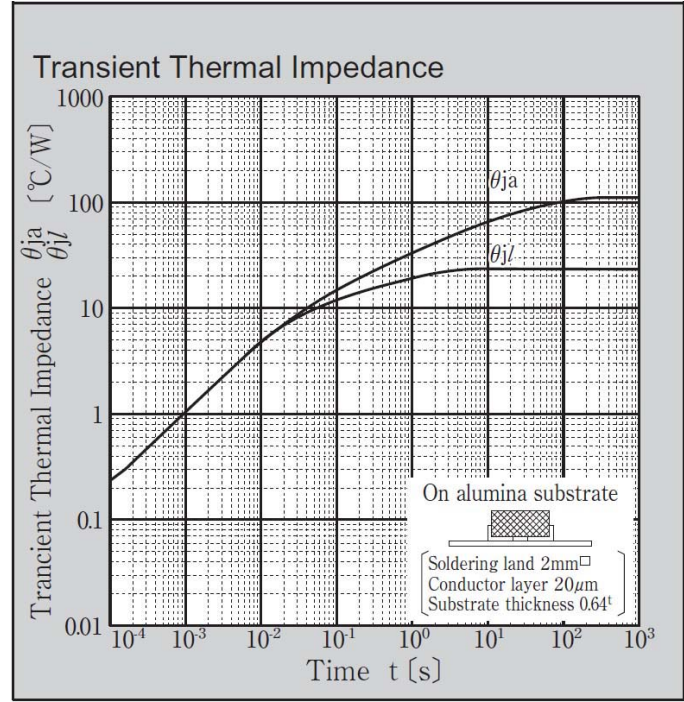
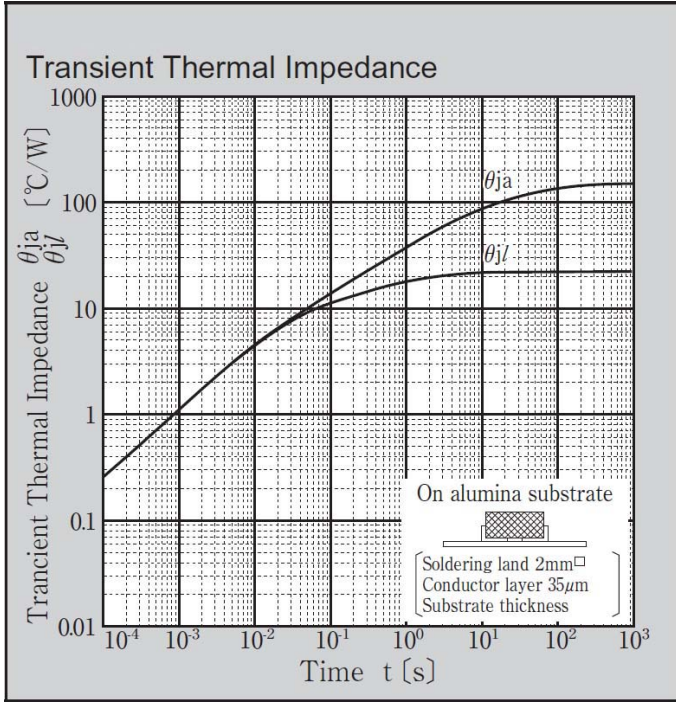

B3

| | |
|------------|----------|
| JEDEC Code | DO-214AC |
| JEITA Code | - |
| House Name | 1F, CF |

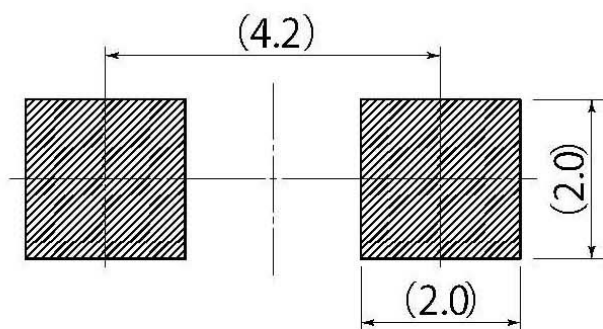
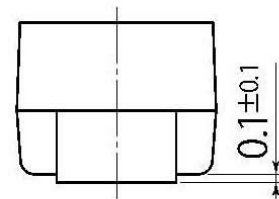
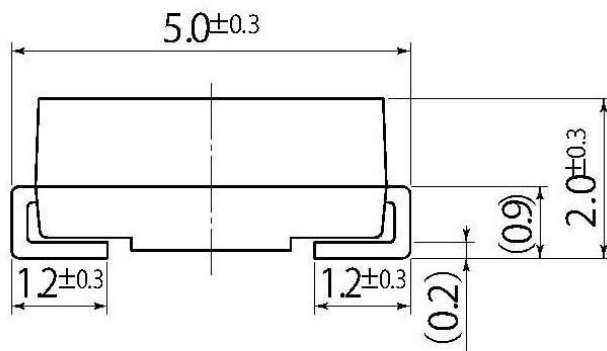
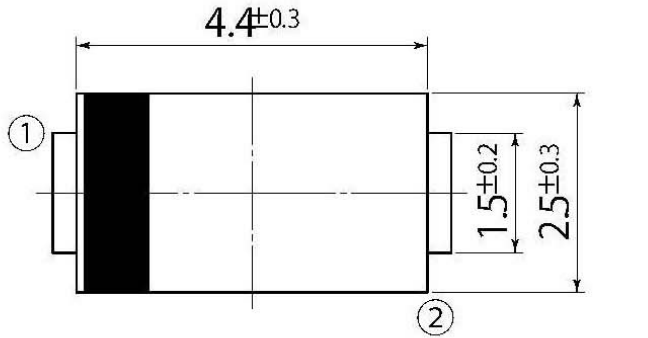

Referential Soldering Pad

• Optimize soldering pad to the board design and soldering condition.