

# Technical Data Sheet

# Rosenberger

Rosenberger  
HSD®

RIGHT ANGLE PLUG  
FOR PCB

## D4S20G-400A5-Y

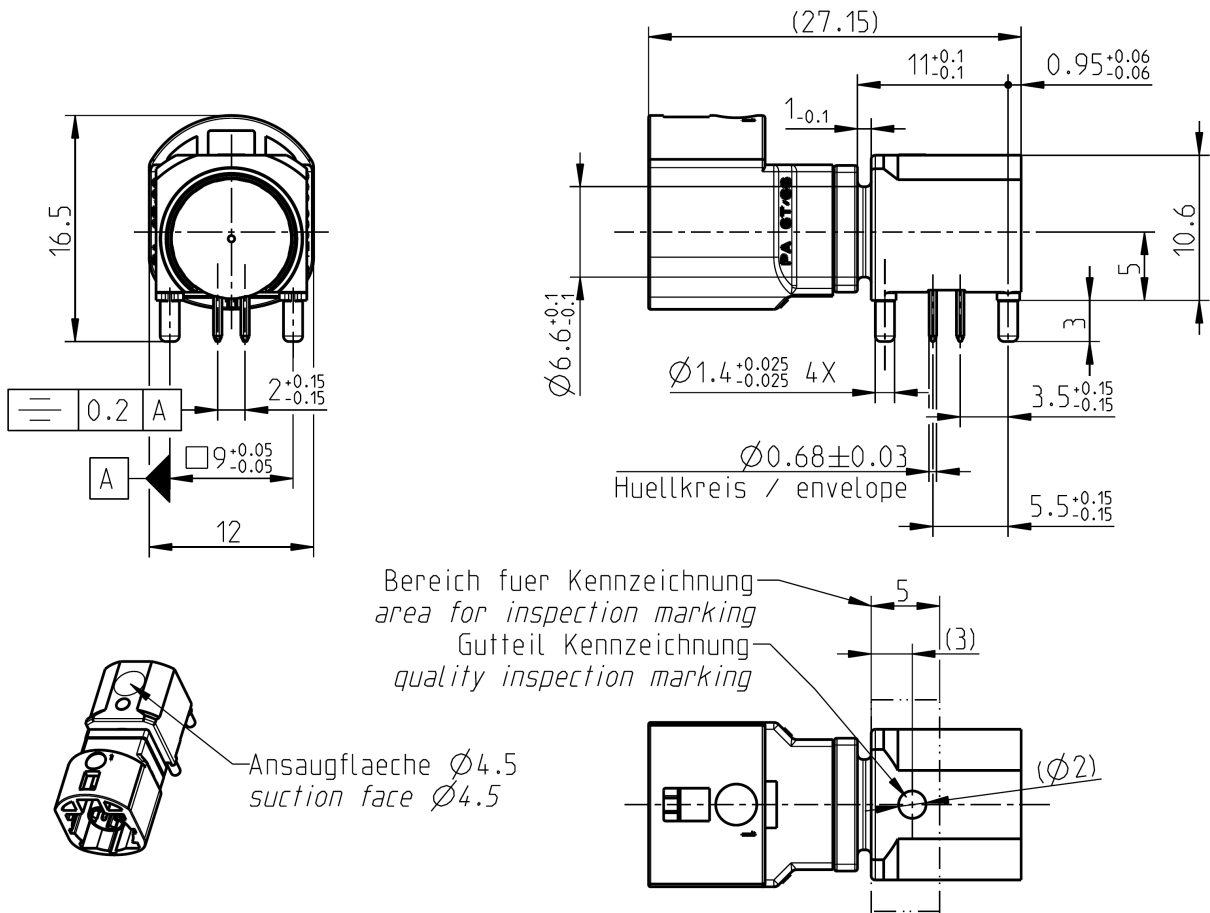

All dimensions are in mm; tolerances according to ISO 2768 m-H  
EMC-screening must be assured by chassis compartment. Control box manufacturer is responsible for EMC-screening.

### Interface

According to RN 059-01

### Documents

Assembly instruction	D4V013
Panel piercing	MB_261
Pinning instruction	RN 053-01
Test specification	RN 061-01

### Material and plating

#### Connector parts

Center contact

Outer contact 1 (Interface)

Outer contact 2 (PCB)

Cover

Dielectric

Housing

#### Material

Spring bronze

Brass

Zinc Alloy

Alpaca

LCP

PA 6T/66

#### Plating

Gold, 0.15  $\mu\text{m}$  (Interface)

Tin, 0.5-2  $\mu\text{m}$  (PCB)

Nickel, 3-6  $\mu\text{m}$

Tin, 2-5  $\mu\text{m}$  over Nickel 1-5 $\mu\text{m}$

©

**Electrical data**

Impedance, differential mode	100 Ω differential signalling, for one pair or quad cable shielded
Frequency	DC to 2.0 GHz
Return loss	≥ 20 dB to 1 GHz ≥ 17 dB to 2 GHz
Insertion loss	≤ 0.1 dB @ 1.0 GHz
Skew (between signal contacts)	≤ 5 psec.
Nearend-Crosstalk	≤ 30 dB
Farend-Crosstalk	≤ 35 dB
Insulation resistance	≥ 1x10 <sup>3</sup> MΩ
Signal contact resistance	≤ 10 mΩ
Outer contact resistance	≤ 7.5 mΩ
Test voltage	250 V rms
Working voltage	100 V rms
Power current	≤ 1.5 A DC
RF-leakage ( shielding effectiveness )	≥ 75 dB up to 1 GHz (IEC 62153-4-7) ≥ 65 dB up to 2 GHz (IEC 62153-4-7)

**Mechanical data**

Mating cycles	≥ 25
Engagement force	≤ 30 N
Disengagement force	≥ 5 N
Retention force latch	≥ 110 N
Coding efficiency	≥ 80 N

**Environmental data**

Temperature range	-40°C to +105°C
Thermal shock	DIN IEC 60068-2-14 Test NA
Temperature and humidity	USCar 2 – 4 5.6.2
Vibration (Random)	DIN IEC 60068-2-64
Mechanical shock	DIN IEC 60068-2-27
High-Temp. Exposure	DIN IEC 60068-2-2
Soldering profile	acc. to IEC 60068-2-58; Group 3&4
RoHS	compliant <span style="border: 1px solid black; border-radius: 50%; padding: 0 2px;">c</span>

**Tooling**

N/A

**Suitable cables**

N/A

**Packing**

Standard	175 pcs on tape & reel 1050 pcs in box (6 x 175 pcs/reel) <span style="border: 1px solid black; border-radius: 50%; padding: 0 2px;">d</span> <span style="border: 1px solid black; border-radius: 50%; padding: 0 2px;">e</span>
Weight	8,6 g/pce

Dieses Dokument ist urheberrechtlich geschützt • This document is protected by copyright • Rosenberger Hochfrequenztechnik GmbH & Co. KG

RF\_35/05:10/6.0