

SOLENOID PRODUCT SPECIFICATION

PART No.	VOLTAGE	DUTY CYCLE	POWER (W)	CURRENT (A)	DCR (Ω) *
DSTL-0840-24	24 VDC	100%	7.4	0.31	77.4
DSTL-0840-18	18 VDC	100%	7.2	0.4	45
DSTL-0840-12	12 VDC	100%	7.6	0.63	19
DSTL-0840-09	9.4 VDC	100%	7.0	0.75	12.5
DSTL-0840-05	5 VDC	100%	7.6	1.52	3.3

* OPERATION: POWER TO PULL

* DCR VALUES ARE ±10% AT 25°C

* WEIGHT ARE 96 GRAMS ±10%

1. MECHANICAL DIMENSIONS :

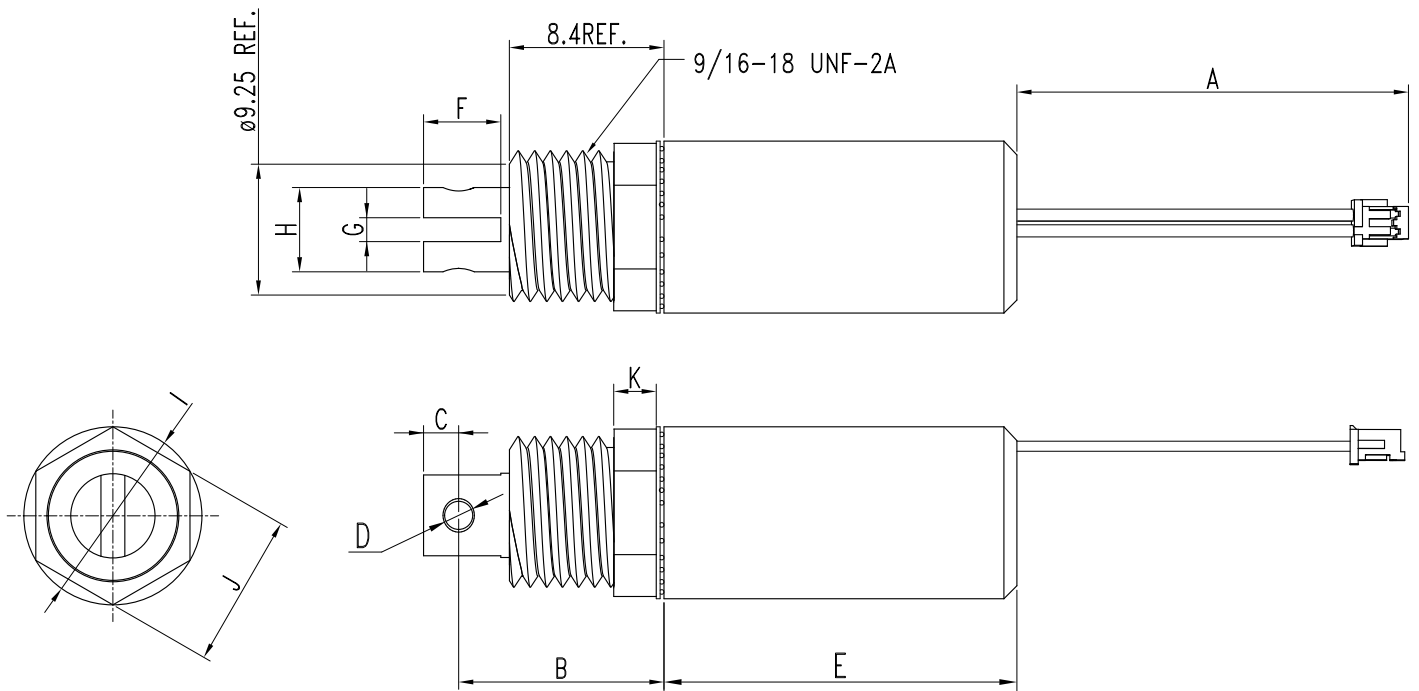

Connector : TYCO
 HOUSING : AMP 179228-2
 CONTACT PIN : AMP 179227-1
 CABLE : AWG 24 UL 1007

UNIT : mm.

- A = 100±10
- B = 19.05±0.5
- C = 4.76±0.25
- D = 2.4±0.05
- E = 40.0 MAX.
- F = 9.52±0.3
- G = 2.5±0.3
- H = ϕ 7.82±0.1
- I = 19.6 MAX.
- J = 17.50 REF.
- K = 3.30±0.25

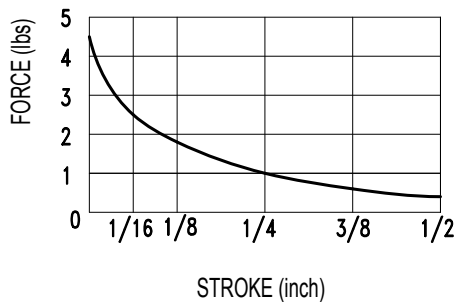

INSULATION MATERIALS: UL CONSTRUCTION, CLASS B 130°C
 LIFE EXPECTANCY: 100K CYCLES OPERATIONS

LAYER TEST	IR. @500 Vdc.	HI-POT
(S-F) : 2KVp. MIN.	COIL TO CASE	@50/60Hz.,2mA
TEST ONLY COIL	30 MOHM MIN.	COIL TO CASE
		1000Vac.,60s