

Rotary Encoder

Model EN16 Series



Features:

- 16 mm
- 2 bits gray code
- Incremental/contacting type
- Metal bushing/shaft



Model Styles Available

| | |
|-----------------------|--------|
| Top Adjust, PCB pins | EN16-H |
| Side Adjust, PCB pins | EN16-V |

Electrical

| | |
|-----------------------------------|------------------------|
| Pulses (Per Revolution) | 12 & 24 |
| Closed Circuit Resistance, Ohms | 3 Ohms, max. |
| Contact Rating | 0.5mA/ 5Vdc |
| Operating Current, Maximum | 0.5mA |
| Dielectric Strength | 50Vac/ 1mA, 1 minute |
| Insulation Resistance, Minimum | 10M ohms at 50Vdc/ 1mA |
| Sliding Noise (at 60 RPM) | 2.0ms max. |
| Contact Bounce (at 15 RPM) | 5.0ms max. |
| Operating speed (RPM) | 100 RPM max. |
| Actual Electrical Travel, Nominal | Continuous |

Mechanical

| | |
|--------------------------------------|------------|
| Total Mechanical Travel | Continuous |
| Detents (per Revolution) | 0,12, 24 |
| Rotational Torque of Detent, Maximum | 2.5 oz-in |

Environmental

| | |
|-----------------------------|----------------|
| Operating Temperature Range | -30°C to +85°C |
| Rotational Life | 30,000 cycles |

General Note
TT Electronics reserves the right to make changes in product specification without notice or liability. All information is subject to TT Electronics' own data and is considered accurate at time of going to print.

TT Electronics | BI Technologies
Circulo de la Amistad #102 PIMSA IV Mexicali B.C. Mexico C.P 21210
Ph: +1 714 447 2345
www.ttelectronics.com/bi-technologies

Ordering

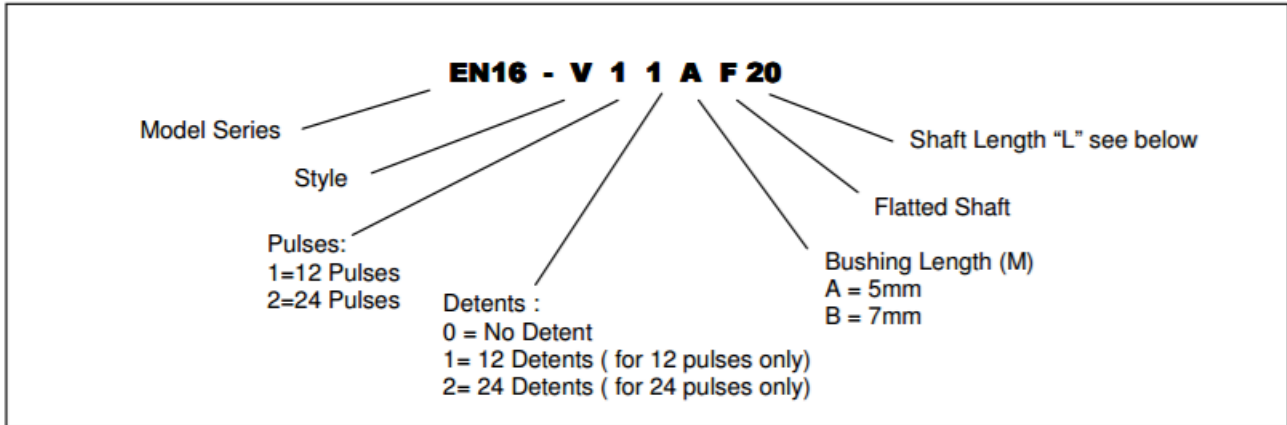

Shaft Length options

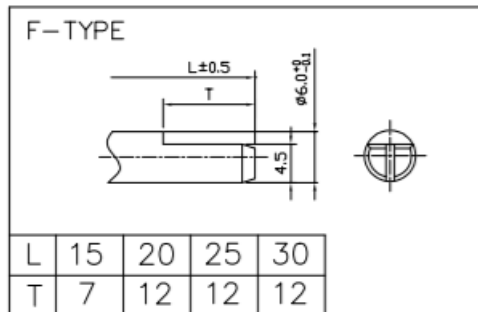

Circuit Diagram

