



Series
EPXA

Environmental insert
With 14 cavities for size 20 socket contacts.

Issue:
April 17, 2002

Page
1 / 1

Mating face

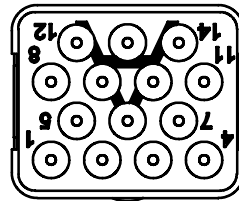
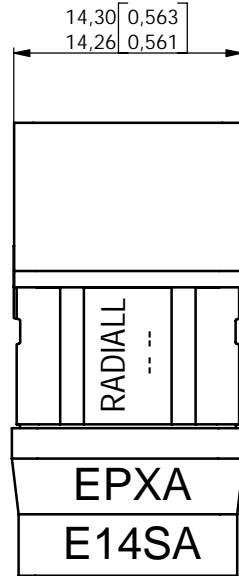
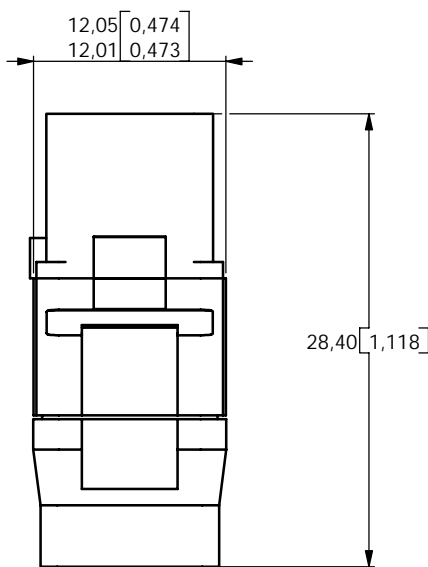
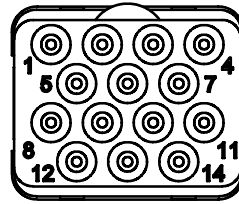

Materials :

- Insert : Thermosetting fiberglass filled per ASTM D 5948-96, with metallic retention clips per ASTM-B-194
- Rear grommet : Fluorosilicone elastomer per MIL-R-25988 B except 4.6.6.1

Temperature range : -65°C +175°C (-85°F +347°F)

DIMENSIONS : mm (inch) -

This information is given as an indication. In the continual goal to improve our products, we reserve the right to make any modifications judged necessary.

4112_9311

| | | | | |
|-------------------|-----------|------|----------|--|
| CREATION | | | | |
| PEN: | | | | |
| NOM: LAHERA | | | | |
| DATE: Apr 17 2002 | | | | |
| APPR.: G.Motteau | | | | |
| Issue | Revisions | Name | Approved | |

