

REV.	DATE	ECR NO.	DESCRIPTION
NC	05/23/12	XXXXXX	INITIAL RELEASE

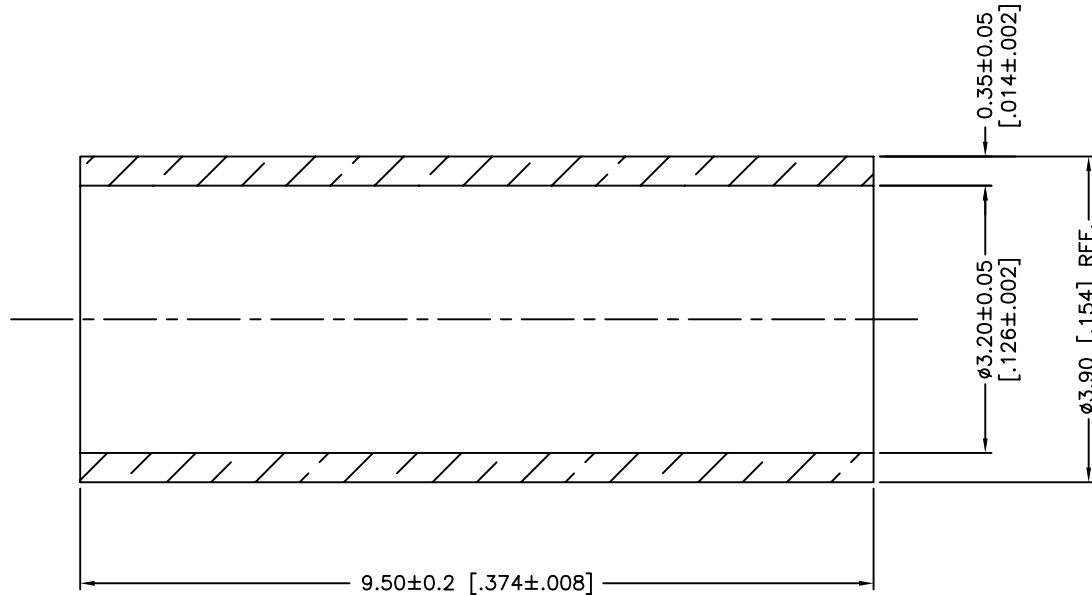
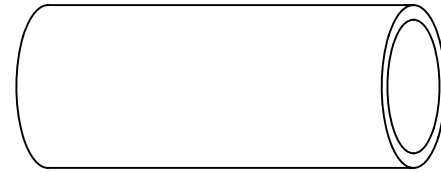

NOTE: ROCKWELL HARDNESS OF
65 MAX. ON 15-T SCALE
(HEAT TREAT FOR 45 MIN.
AT 1100°F BEFORE PLATING)

<small>UNLESS OTHERWISE SPECIFIED DIMENSIONS ARE IN MILLIMETERS. DIMENSIONS IN [] ARE IN INCHES AND FOR CUSTOMER REFERENCE ONLY.</small> <small>UNLESS OTHERWISE SPECIFIED TOLERANCES FOR MILLIMETERS ARE: 0.5 - 8mm ± 0.20mm 8 - 30mm ± 0.40mm 30 - 120mm ± 0.50mm</small> <small>UNLESS OTHERWISE SPECIFIED TOLERANCES FOR INCHES ARE: .020 - .315 = ± 0.007" .315 - 1.180 = ± 0.015" 1.180 - 4.724 = ± 0.020"</small> <small>DO NOT SCALE DRAWING</small>	APPROVALS	DATE	
	DRAWN	M.ZHANG	05/23/12
	CHECKED		
	ISSUED		
	SHEET	1 OF 1	
CAD FILE	C:/CONNEX/FERRULE-174NEX .DWG		

Amphenol Connex

PART DESCRIPTION			
FERRULE (FOR RG-174/U,188A/U,316/U CABLE)			
PART NO.			
FERRULE-174NEX			
DWG. NO.	FERRULE-174NEX .DWG	REV.	NC
SIZE	A	SCALE	NA

1	FERRULE	BRASS	NEXCOTE	1
	DESCRIPTION	MATERIAL	FINISH	QTY